



## ENCROACHMENT PERMIT

WESTERN RIVERSIDE COUNTY REGIONAL WASTEWATER AUTHORITY, the owner, hereby requests permission to construct and maintain a nonreclaimable wastewater sewerline ("NWS") as depicted on plans prepared by Black and Veatch, Project No. 23068 in the public right of way of Pierce and Buchanan Streets, and Magnolia and Sampson Avenues, located in the City of Riverside. The attached drawings show the locations of the requested encroachment. Upon issuance of this permit, I agree to comply with the attached terms and conditions.

Dated 3/17/97

*Michael G. Wright*  
Michael G. Wright  
Acting General Manager

## ENCROACHMENT PERMIT APPROVAL

This encroachment permit shall become effective upon the approval of the Departments listed below. Issuance of this permit shall not be construed as a waiver of any other applicable permit or requirement, but is only revocable permission to use the land for the purpose above described.

- Park and Recreation
- Planning
- Public Utilities Electric
- Public Utilities Water
- Public Works - Streets
- Public Works - Traffic Engineering
- Riverside County Flood Control District

*Tony Nelson*

*Bill Mairand* 3-19-97

*B. Simpson* 3/19/97

*F. Colwell* 3/20/97

*Manager*

*Mark H. Wills for VLD*

Upon obtaining the above signatures, return this permit to Public Works Department for final approval.

Dated 3/20/97

*Barry Paul*  
Public Works Director

## TERMS AND CONDITIONS

The following indicated terms and conditions apply to Encroachment Permit No. **E - 1392**

1. Permittee acknowledges that the area of encroachment is owned or controlled by the City of Riverside.
2. Permittee acknowledges that the described public streets could be needed for a proposed or planned public improvement and the City may revoke this permit. Upon written notice of revocation, the Permittee shall, within the time prescribed by the City, remove or relocate all improvements placed, constructed or maintained. If the Permittee fails to abide by the removal or relocation order of the City, the City shall have the right to relocate, remove and destroy the improvements without reimbursement to the Permittee. The cost of such relocation or removal shall be paid by the Permittee and shall constitute a debt owed to the City.
3. The Permittee agrees to insure that construction of their improvements will not interfere in any way with existing City or other utility facilities. The existing facilities will require future maintenance, reconstruction and revisions and facilities may be added, any of which may result in removal or alteration of the Permittee's improvements without reimbursement to the Permittee. Prior to construction, Permittee shall contact **UNDERGROUND SERVICE ALERT** to field locate existing utility lines. Any conflicts discovered will void the permit until acceptable revisions are made.
4. Permittee waives the right of claim, loss, damage or action against the City resulting from revocation, termination, removal or relocation of improvements or any action of the City, its officers, agents or employees taken in accordance with the terms herein.
5. If the City Council of the City of Riverside finds that the Permittee is in default of the terms of this permit, that shall be cause for revocation.
6. Permittee agrees to indemnify, defend and hold harmless the City of Riverside, its officers, agents and employees, from and against all claims, demands, expenses, losses, damages, injuries, actions for damages and/or injuries, and liability including reasonable attorney's fees arising out of the acts or omissions of Permittee, its agents, servants, contractors or subcontractors, during or as a result of encroachment, construction and/or maintenance or other work performed in the City's public rights-of-way, except to the extent the damages claimed are caused by the acts or omissions of the City.
7. Prior to any construction taking place on City controlled property, Permittee's shall obtain a **Street Opening Permit** from the City Public Works Department.

8. As a condition of obtaining the street opening permit, Permittee's contractor:

a. Agrees to indemnify, defend and hold harmless the City of Riverside, its officers and employees, from and against all claims, damages, losses and expenses including attorney's fees arising out of the acts or omissions of the contractor, its agents, servants, or subcontractors, during or as a result of work performed in the City's public rights-of-way, except to the extent the damages are caused by the acts or omissions of the City of Riverside.

b. Shall comply with the City's insurance requirements by either providing a general liability insurance policy with a combined single limit of at least \$1,000,000 or a certificate evidencing permissive self-insurance of at least \$1,000,000.

9. Prior to the issuance of this encroachment permit and subsequent street opening permit, Permittee, Permittee's Engineer or Contractor shall submit and obtain approval from the City's Traffic Engineer of a traffic control plan which will accommodate public traffic during construction of the NWS.

10. PERMITTEE AGREES TO HOLD CITY OF RIVERSIDE HARMLESS FROM ANY DAMAGE THAT MAY OCCUR TO PERMITTEE'S IMPROVEMENTS RESULTING FROM NATURAL GROWTH OF STREET TREES, OR FROM ANY POSSIBLE DAMAGE RESULTING FROM MAINTENANCE OR REMOVAL OF ANY STREET TREES.

Attachment - Drawings depicting location of NWS

10/21/96 10:18:32 VPL  
10/21/96 08:24:06 ATSY

# WESTERN RIVERSIDE COUNTY REGIONAL WASTEWATER AUTHORITY

## MEMBER AGENCIES

SANTA ANA WATERSHED PROJECT AUTHORITY (SAWPA)  
HOME GARDENS SANITARY DISTRICT (HGSD)  
JURUPA COMMUNITY SERVICES DISTRICT (JCSD)  
CITY OF NORCO (NORCO)  
WESTERN MUNICIPAL WATER DISTRICT OF RIVERSIDE COUNTY (WMWD)

# WESTERN RIVERSIDE COUNTY REGIONAL WASTEWATER SYSTEM SOUTH REGIONAL COLLECTION SYSTEM CONTRACT NO. 2 NONRECLAIMABLE WASTEWATER SEWER

1996

PREPARED BY

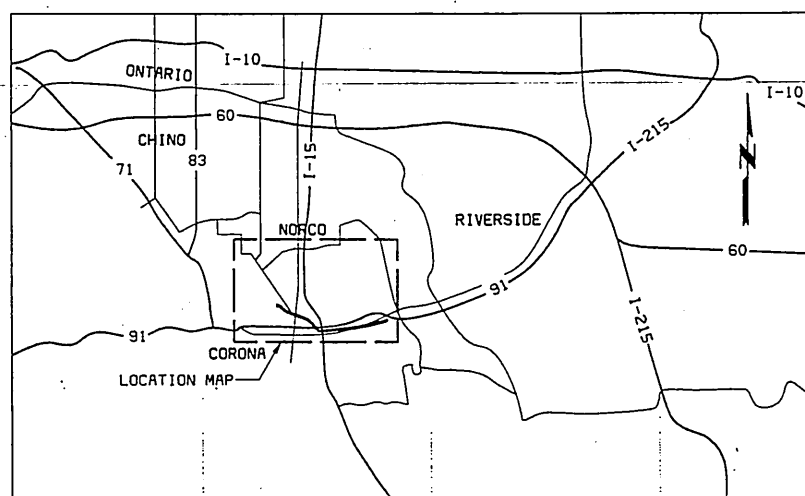

VICINITY MAP  
NTS

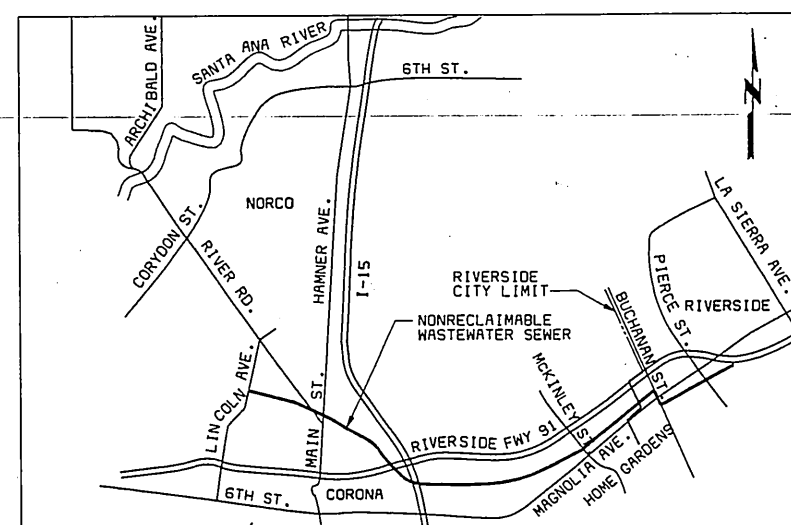

LOCATION MAP  
NTS

NO.	DATE	REVISIONS AND RECORD OF ISSUE	NO.	BY	CK	APP

DESIGNED: JTG  
 DETAILED: CND  
 CHECKED: GMC  
 APPROVED: DJV  
 DATE: 6-28-96



PROJECT NO. 23068  
 SCALE= NO SCALE

WESTERN RIVERSIDE COUNTY  
 REGIONAL WASTEWATER SYSTEM  
 SOUTH REGIONAL COLLECTION SYSTEM  
 NONRECLAIMABLE WASTEWATER SEWER  
 TITLE SHEET

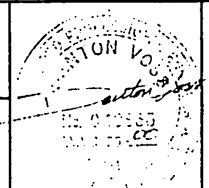

G-1  
 SHEET 1 OF 55

11/11/96 11:58:02 VPL  
11/11/96 11:56:31 A15  
1  
2  
3  
4  
5  
6  
7  
8  
9  
10  
11  
12  
13  
14  
15  
16  
17  
18  
19  
20  
21  
22  
23  
24  
25  
26  
27  
28  
29  
30  
31  
32  
33  
34  
35  
36  
37  
38  
39  
40  
41  
42  
43  
44  
45  
46  
47  
48  
49  
50  
51  
52  
53  
54  
55  
A  
B  
C  
D  
E  
F

# INDEX OF DRAWINGS

1	G-1	NONRECLAIMABLE WASTEWATER SEWER TITLE SHEET
2	G-2	NONRECLAIMABLE WASTEWATER SEWER INDEX OF DRAWINGS AND GENERAL NOTES
3	G-3	NONRECLAIMABLE WASTEWATER SEWER LEGEND AND ABBREVIATIONS
4	G-4	NONRECLAIMABLE WASTEWATER SEWER KEY PLAN
5	G-5	NONRECLAIMABLE WASTEWATER SEWER PROJECT CONTROL POINTS
6	C-1	NONRECLAIMABLE WASTEWATER SEWER PLAN & PROFILE
7	C-2	NONRECLAIMABLE WASTEWATER SEWER PLAN & PROFILE
8	C-3	NONRECLAIMABLE WASTEWATER SEWER PLAN & PROFILE
9	C-4	NONRECLAIMABLE WASTEWATER SEWER PLAN & PROFILE
10	C-5	NONRECLAIMABLE WASTEWATER SEWER PLAN & PROFILE
11	C-6	NONRECLAIMABLE WASTEWATER SEWER PLAN & PROFILE
12	C-7	NONRECLAIMABLE WASTEWATER SEWER PLAN & PROFILE
13	C-8	NONRECLAIMABLE WASTEWATER SEWER PLAN & PROFILE
14	C-9	NONRECLAIMABLE WASTEWATER SEWER PLAN & PROFILE
15	C-10	NONRECLAIMABLE WASTEWATER SEWER PLAN & PROFILE
16	C-11	NONRECLAIMABLE WASTEWATER SEWER PLAN & PROFILE
17	C-12	NONRECLAIMABLE WASTEWATER SEWER PLAN & PROFILE
18	C-13	NONRECLAIMABLE WASTEWATER SEWER PLAN & PROFILE
19	C-14	NONRECLAIMABLE WASTEWATER SEWER PLAN & PROFILE
20	C-15	NONRECLAIMABLE WASTEWATER SEWER PLAN & PROFILE
21	C-16	NONRECLAIMABLE WASTEWATER SEWER PLAN & PROFILE
22	C-17	NONRECLAIMABLE WASTEWATER SEWER PLAN & PROFILE
23	C-18	NONRECLAIMABLE WASTEWATER SEWER PLAN & PROFILE
24	C-19	NONRECLAIMABLE WASTEWATER SEWER PLAN & PROFILE
25	C-20	NONRECLAIMABLE WASTEWATER SEWER PLAN & PROFILE
26	C-21	NONRECLAIMABLE WASTEWATER SEWER PLAN & PROFILE
27	C-22	NONRECLAIMABLE WASTEWATER SEWER PLAN & PROFILE
28	C-23	NONRECLAIMABLE WASTEWATER SEWER PLAN & PROFILE
29	C-24	NONRECLAIMABLE WASTEWATER SEWER PLAN & PROFILE
30	C-25	NONRECLAIMABLE WASTEWATER SEWER PLAN & PROFILE
31	C-26	NONRECLAIMABLE WASTEWATER SEWER PLAN & PROFILE
32	C-27	NONRECLAIMABLE WASTEWATER SEWER PLAN & PROFILE
33	C-28	NONRECLAIMABLE WASTEWATER SEWER PLAN & PROFILE
34	C-29	NONRECLAIMABLE WASTEWATER SEWER PLAN & PROFILE
35	C-30	NONRECLAIMABLE WASTEWATER SEWER PLAN & PROFILE
36	C-31	NONRECLAIMABLE WASTEWATER SEWER PLAN & PROFILE
37	C-32	NONRECLAIMABLE WASTEWATER SEWER PLAN & PROFILE
38	C-33	NONRECLAIMABLE WASTEWATER SEWER PLAN & PROFILE
39	C-34	NONRECLAIMABLE WASTEWATER SEWER PLAN & PROFILE
40	C-35	NONRECLAIMABLE WASTEWATER SEWER PLAN & PROFILE
41	C-36	NONRECLAIMABLE WASTEWATER SEWER PLAN & PROFILE
42	C-37	NONRECLAIMABLE WASTEWATER SEWER MANHOLE DETAILS
43	C-38	NONRECLAIMABLE WASTEWATER SEWER MISCELLANEOUS DETAILS
44	C-39	NONRECLAIMABLE WASTEWATER SEWER MISCELLANEOUS DETAILS
45	C-40	NONRECLAIMABLE WASTEWATER SEWER MISCELLANEOUS DETAILS
46	C-41	NONRECLAIMABLE WASTEWATER SEWER MISCELLANEOUS DETAILS
47	TC-1	NONRECLAIMABLE WASTEWATER SEWER TRAFFIC CONTROL PLANS
48	TC-2	NONRECLAIMABLE WASTEWATER SEWER TRAFFIC CONTROL PLANS
49	TC-3	NONRECLAIMABLE WASTEWATER SEWER TRAFFIC CONTROL PLANS
50	TC-4	NONRECLAIMABLE WASTEWATER SEWER TRAFFIC CONTROL PLANS
51	TC-5	NONRECLAIMABLE WASTEWATER SEWER TRAFFIC CONTROL PLANS
52	TC-6	NONRECLAIMABLE WASTEWATER SEWER TRAFFIC CONTROL PLANS
53	TC-7	NONRECLAIMABLE WASTEWATER SEWER TRAFFIC CONTROL PLANS
54	TC-8	NONRECLAIMABLE WASTEWATER SEWER TRAFFIC CONTROL PLANS
55	TC-9	NONRECLAIMABLE WASTEWATER SEWER TRAFFIC CONTROL PLANS

THE CONTRACTOR SHALL NOTIFY THE FOLLOWING ENTITIES PRIOR TO BEGINNING CONSTRUCTION THAT WILL AFFECT THEIR FACILITIES OR PROPERTY.

ENTITY	CONTACT PERSON	TELEPHONE
CITY OF CORONA		
PUBLIC UTILITIES	DON WILLIAMS	(909) 736-2232
PUBLIC WORKS	JOE PALENCIA	(909) 736-2264
CITY OF RIVERSIDE		
PUBLIC WORKS	BILL KRAIOSKY	(909) 782-5341
PARKS & RECREATION	STREET TREE INSPECTOR	(909) 782-6126
RIVERSIDE COUNTY FLOOD CONTROL	VICTOR DeCASTRO	(909) 275-1266
CALTRANS		
PACIFIC BELL	MAX BLACKWELL	(909) 359-2180
SOUTHERN CALIFORNIA EDISON	JIM HAYS	(909) 930-8435
SOUTHERN CALIFORNIA GAS	DON BOWEN	(909) 335-7607
ARCO PIPELINE	DAVE ANDERSON	(310) 428-9454
UNDERGROUND SERVICE ALERT		(800) 422-4133
CITY OF RIVERSIDE P.U. WATER DEPT.	INSPECTION	(909) 782-5449

## GENERAL NOTES

- THE CONTRACTOR SHALL BE RESPONSIBLE FOR THE TEMPORARY AND/OR PERMANENT RELOCATION OF ALL OBSTRUCTIONS TO THE CONSTRUCTION OF SEWER LINE, INCLUDING UTILITIES. ALL COSTS ASSOCIATED WITH TEMPORARY RELOCATIONS REQUIRED BECAUSE OF THE CONFLICTS WITH THE WORK CONTAINED HEREIN SHALL BE CONSIDERED A SUBSIDIARY OBLIGATION OF CONTRACTOR AND SHALL BE INCLUDED IN THE UNIT AND LUMP SUM PRICES BID.
- THE CONTRACTOR IS REQUIRED TO TAKE PRECAUTIONARY MEASURES TO PROTECT FROM DAMAGE ANY UTILITY LINES SHOWN AND ANY OTHER LINES NOT OF RECORD OR NOT SHOWN ON THESE PLANS.
- THE CONTRACTOR SHALL NOTIFY UNDERGROUND SERVICE ALERT (1-800-422-4133) TWO FULL WORKING DAYS (48 HOURS MINIMUM) IN ADVANCE OF ANY CONSTRUCTION ACTIVITIES.
- THE CONTRACTOR SHALL NOTIFY ALL AFFECTED UTILITY COMPANIES AND MUNICIPAL UTILITY DEPARTMENTS AT LEAST TWO FULL WORKING DAYS (48 HOURS MINIMUM) PRIOR TO BEGINNING ANY CONSTRUCTION IN THE VICINITY OF THEIR FACILITIES.
- REPLACEMENT OF PAVEMENT, CURBS, GUTTERS AND SIDEWALKS SHALL BE IN ACCORDANCE WITH THE GOVERNING MUNICIPALITY'S STANDARD PLANS.
- THE CONTRACTOR IS REQUIRED TO PROVIDE TRAFFIC CONTROL IN CONFORMANCE WITH THE TRAFFIC CONTROL PLANS AND THE MOST RECENT EDITION OF THE WORK AREA TRAFFIC CONTROL HANDBOOK (W.A.T.C.H.).
- THE LOCATION OF EXISTING UTILITIES HAVE BEEN NOTED ON THE DRAWINGS TO THE EXTENT THAT INFORMATION WAS AVAILABLE FROM EXISTING UTILITY PLATS AND DRAWINGS. UTILITIES THAT WERE LOCATED BY POT HOLING DURING DESIGN ARE DESIGNATED AS "POT HOLED" ON THE PROFILES. THE CONTRACTOR SHALL BE RESPONSIBLE FOR VERIFYING THE LOCATION AND ELEVATION OF ALL UTILITIES AFFECTING ANY REACH OF PIPELINE AT LEAST 1000 FEET IN ADVANCE OF THE TRENCH EXCAVATION. SERVICE LATERALS AND CONNECTIONS ARE NOT SHOWN. THE CONTRACTOR SHALL BE RESPONSIBLE TO LOCATE AND PROTECT ALL LATERALS AND CONNECTIONS ENCOUNTERED DURING THE PROGRESS OF THE WORK.
- ALL PAVEMENT MARKINGS, SIGNS, BARRICADES, SIGNAL SYSTEMS AND ALL OTHER TRAFFIC CONTROL DEVICES WHICH ARE REMOVED OR DISTURBED AS A RESULT OF THE CONTRACTOR'S ACTIVITIES SHALL BE REPLACED AT THE CONTRACTOR'S EXPENSE IN COMPLIANCE WITH THE GOVERNING MUNICIPALITY'S STANDARDS AND REQUIREMENTS.
- A MAJOR PORTION OF THIS PROJECT PARALLELS THE TEMESCAL CREEK, ARLINGTON, AND LA SIERRA CHANNELS. THE CONTRACTOR SHALL TAKE SPECIAL NOTE OF THE EXISTING IMPROVEMENTS WHICH MAY BE NECESSARY TO REMOVE AND REPLACE, INCLUDING BUT NOT LIMITED TO PAVING, FENCING, CABLE BARRIERS, REFLECTOR POSTS, AND METAL BEAM RAILINGS. THE CONTRACTOR SHALL PROVIDE TEMPORARY FENCING NEXT TO THE CHANNEL WALL IN THE AREA OF CONSTRUCTION WHERE THE EXISTING FENCE AND CABLE BARRIER HAVE BEEN REMOVED AND SHALL ALSO PROVIDE SUITABLE TEMPORARY TRAFFIC BARRIER AT THE LOCATION OF THE EXISTING CABLE BARRIER. FENCE AND CABLE BARRIER SHALL BE REPLACED AS CONSTRUCTION PROCEEDS. THE CONTRACTOR SHALL ACCEPT TOTAL RESPONSIBILITY FOR DESIGN AND CONSTRUCTION OF TEMPORARY FENCE AND TRAFFIC BARRIERS AND ACCEPT TOTAL LIABILITY FOR ANY DAMAGES OR CLAIMS AS A RESULT OF INADEQUATE TEMPORARY FENCING AND TRAFFIC BARRIER AND SHALL HOLD THE OWNER, ENGINEER, CITY OF CORONA, CITY OF RIVERSIDE, AND THE RIVERSIDE COUNTY FLOOD CONTROL AND WATER CONSERVATION DISTRICT (RCFC&WCD) HARMLESS FROM SUCH DAMAGES OR CLAIMS.
- THE CONTRACTOR IS REFERRED TO RIVERSIDE COUNTY FLOOD CONTROL AND WATER CONSERVATION DISTRICT DRAWINGS FOR DETAILS OF THE EXISTING CHANNEL CONSTRUCTION. CONTRACTOR SHALL OBTAIN THE FOLLOWING DRAWING SETS PRIOR TO THE START OF CONSTRUCTION.  
 TEMESCAL CREEK CHANNEL: PROJECT 2-0-050, DRAWING 2-186  
 ARLINGTON CHANNEL: PROJECT 1-0-020, DRAWINGS 1-294 AND 1-391  
 LA SIERRA CHANNEL: DRAWING 1-151
- PORTIONS OF THE LINE ARE LOCATED IN GRANITE. CONTRACTOR SHALL REFER TO THE SOILS REPORT AS A GUIDELINE ONLY. BLASTING WILL NOT BE PERMITTED.
- PROJECT SURVEY CONTROL:  
 A. HORIZONTAL DATA IS BASED ON THE NORTH-AMERICAN DATUM OF 1983 (NAD83) AS DEFINED BY THE NATIONAL GEODETIC SURVEY'S (NGS) PUBLISHED POSITION ON STATIONS: "WEIRICK 1975" AND "TARKIO 1975."  
 B. ALL COORDINATES ARE CALIFORNIA COORDINATE SYSTEM ZONE 6 AND ARE IN U.S. SURVEY FEET.  
 C. THE COORDINATE VALUES LISTED HEREIN ARE GRID VALUES. TO OBTAIN GROUND DISTANCES BETWEEN POINTS, DIVIDE THE GRID DISTANCE BY THE COMBINATION FACTOR AS FOLLOWS:  
 (1) BETWEEN DESALTER AND INTERSECTION OF SAMPSON AVE. AND RICH CT. 0.999968368  
 (2) BETWEEN INTERSECTION OF SAMPSON AVE. AND RICH CT. AND INTERSECTION OF LINCOLN AVE. AND TEMESCAL CREEK CHANNEL 0.999971875  
 D. THE FIELD CONTROL SURVEY AND SETTING OF TEMPORARY BENCHMARKS WAS PERFORMED DURING FEBRUARY 1993.  
 E. AERIAL PHOTOGRAPHS SHOWN HEREIN WERE TAKEN DURING MARCH 1993.  
 F. ALL STATIONS ARE GRID DISTANCE AND SHOULD BE MULTIPLIED BY THE COMBINATION FACTORS LISTED ABOVE TO EQUAL GROUND DISTANCE.  
 G. STATIONING IS ON CENTERLINE OF PIPE.
- THE NWS SHALL BE INSTALLED IN ACCORDANCE WITH THE STATE OF CALIFORNIA DEPARTMENT OF HEALTH SERVICES SEPARATION STANDARDS AS SHOWN IN DETAILS E AND F ON SHEET C-38.
- CONTRACTOR SHALL PROTECT ALL STREET LIGHTS IN PLACE.
- DUE TO THE STRUCTURAL QUALITIES OF ASBESTOS CONCRETE PIPE (ACP), ALL ACP WITHIN THE CITY OF CORONA THAT IS EXPOSED OR UNDERMINED DURING THE PROPOSED CONSTRUCTION SHALL BE REPLACED WITH EITHER DUCTILE IRON PIPE OR PVC PIPE. ENGINEERING DETAILS FOR REPLACEMENT SHALL BE SUBMITTED TO THE CITY ENGINEER OF CORONA FOR APPROVAL PRIOR TO ANY RECONSTRUCTION OF CORONA'S FACILITIES. AT THE DISCRETION OF THE CITY ENGINEER, DISRUPTIONS TO SERVICE MAY BE LIMITED TO NIGHT TIME SHUT DOWNS IN SOME AREAS.
- THE CONTRACTOR SHALL SUBMIT TO THE CITY OF CORONA A CERTIFICATE OF INSURANCE WITH A MINIMUM LIABILITY OF \$1,000,000 NAMING THE CITY OF CORONA AS AN ADDITIONAL INSURED.
- NO STREET CONSTRUCTION OF STREET CLOSURES WILL BE PERMITTED FOR STREETS, WHICH ARE CLASSIFIED BY THE CITY OF CORONA AS AFFECTING COMMERCIAL AREAS, BETWEEN THANKSGIVING DAY AND NEW YEARS DAY.
- WITHIN CITY OF CORONA STREETS THE CONTRACTOR SHALL PLACE PIPE EMBEDMENT, BACKFILL ALL TRENCHES AND MAKE ROADWAY REPAIRS IN ACCORDANCE WITH CORONA STANDARD PLAN 108-1. ALL OTHER PIPE EMBEDMENT AND TRENCH BACKFILL SHALL CONFORM TO SECTION 02200 OF THE SPECIFICATIONS.
- LENGTHS OF RESTRAINED JOINT PIPING ON EACH SIDE OF FITTINGS SHALL CONFORM TO DETAIL B ON SHEET C-39. LOCATIONS OF RESTRAINED JOINT PIPING ARE CALLED OUT ON THE PLAN & PROFILE SHEETS.

### CITY OF RIVERSIDE PUBLIC WORKS DEPARTMENT

CITY OF RIVERSIDE WATER SYSTEM	APPROVED BY	DATE	BY	APPROVED BY
<i>Richard D. Duda</i>	2-27-97			
APPROVED	DATE			
NO. 916 YEAR FROM THIS DATE				
PRINCIPAL ENGINEER				
PARK DEPARTMENT				
TRAFFIC DIVISION				
CHIEF P. ENGINEER				
PUBLIC UTIL. ENGR.				
				PUBLIC WORKS DIRECTOR
				DATE

WESTERN RIVERSIDE COUNTY REGIONAL WASTEWATER SYSTEM SOUTH REGIONAL COLLECTION SYSTEM		G-2
NONRECLAIMABLE WASTEWATER SEWER INDEX OF DRAWINGS AND GENERAL NOTES		SHEET 2 OF

DESIGNED	JTC	PROJECT NO.	23068
DETAILED	CND/SSH	SCALE	NO SCALE
CHECKED	GMC		
APPROVED	DJV		
DATE	6-26-96		



CGC DWG. NO: 23068-301-359-0102

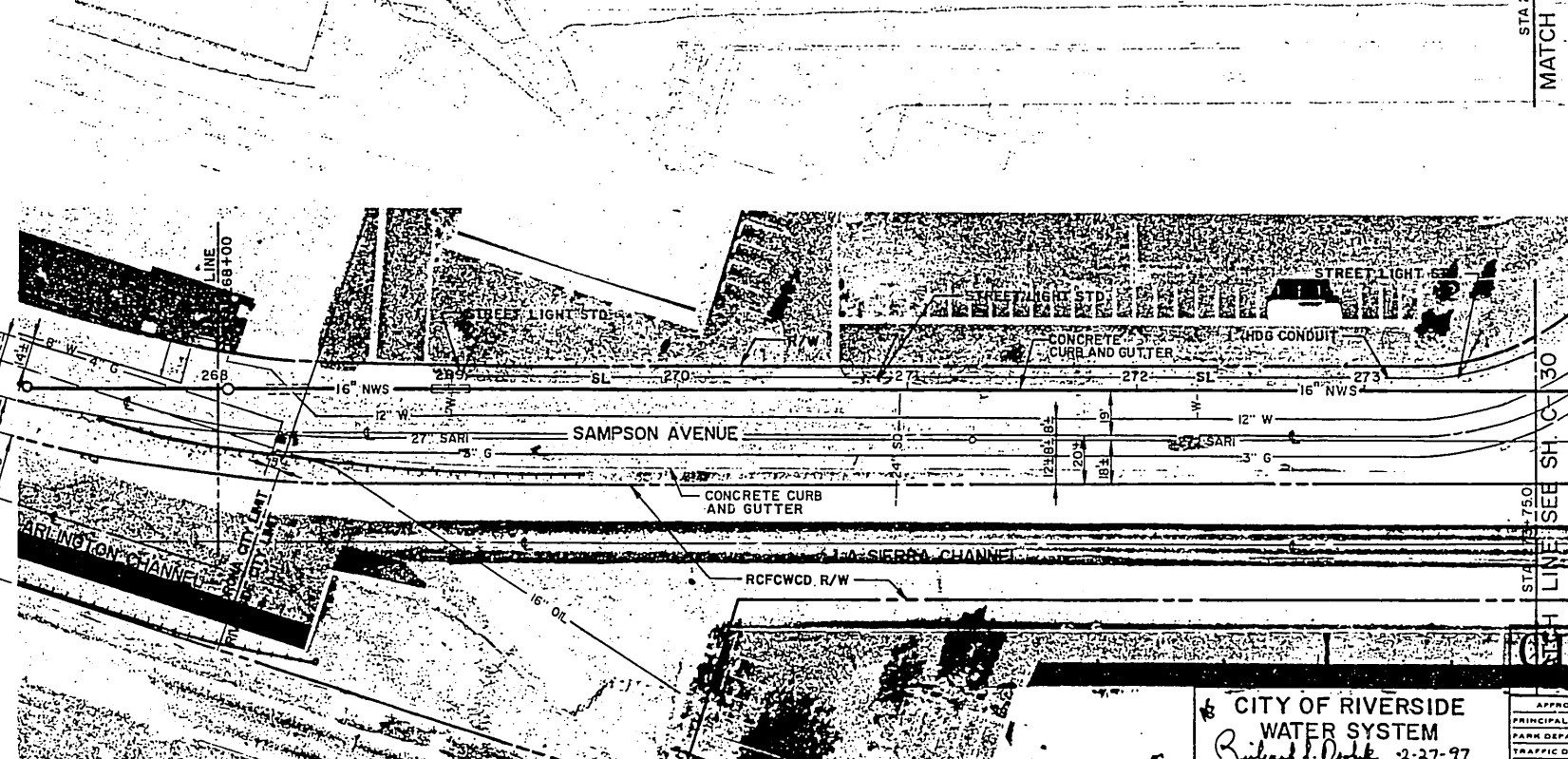
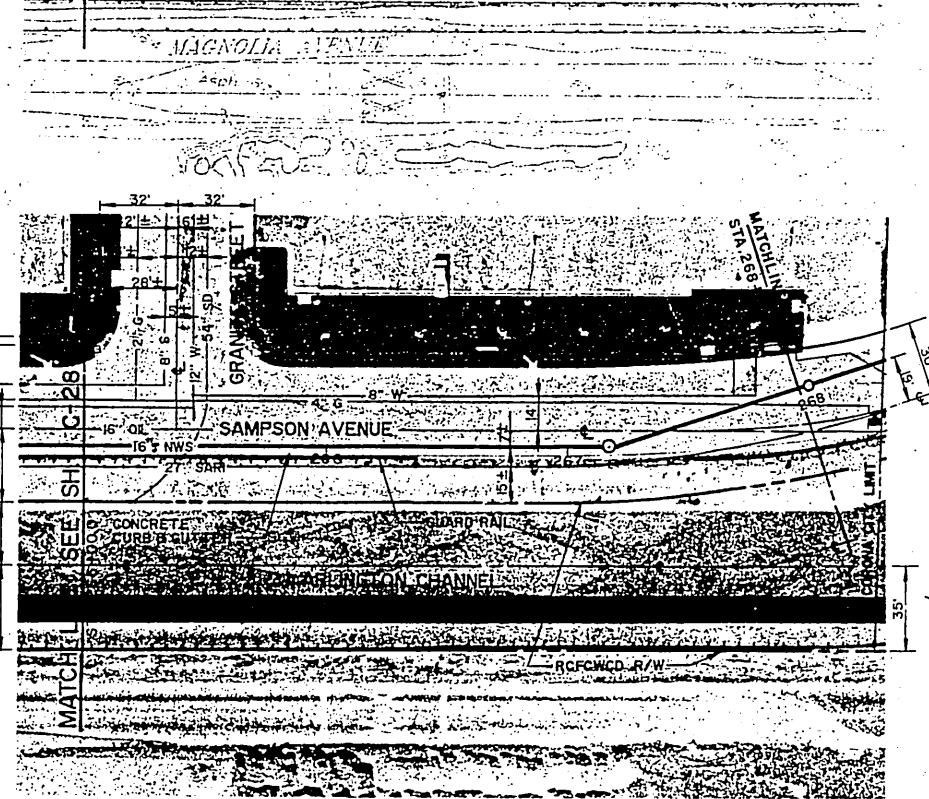
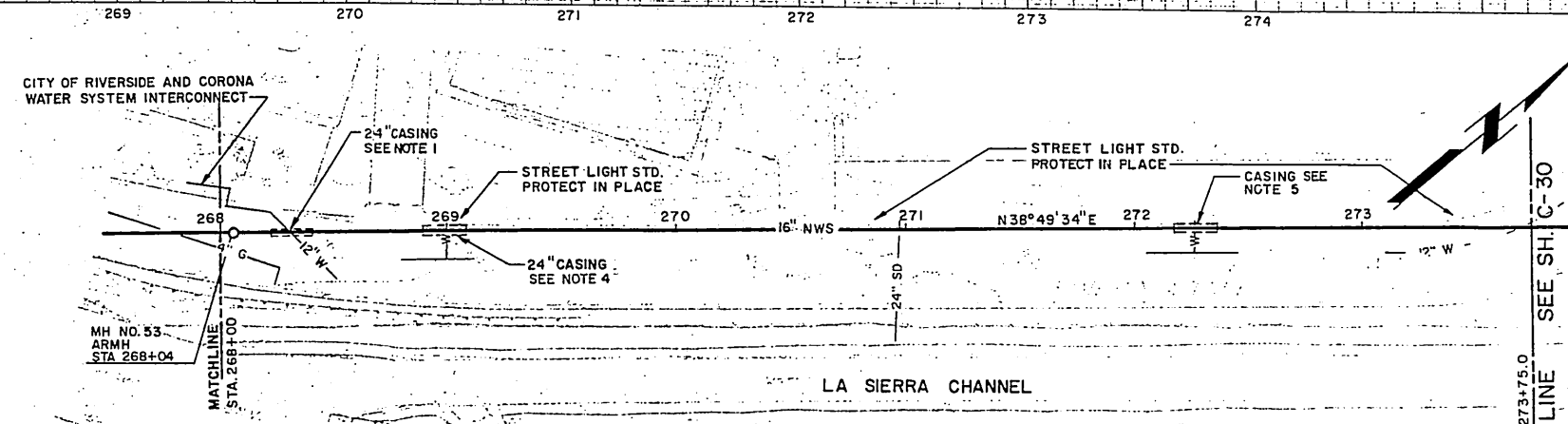
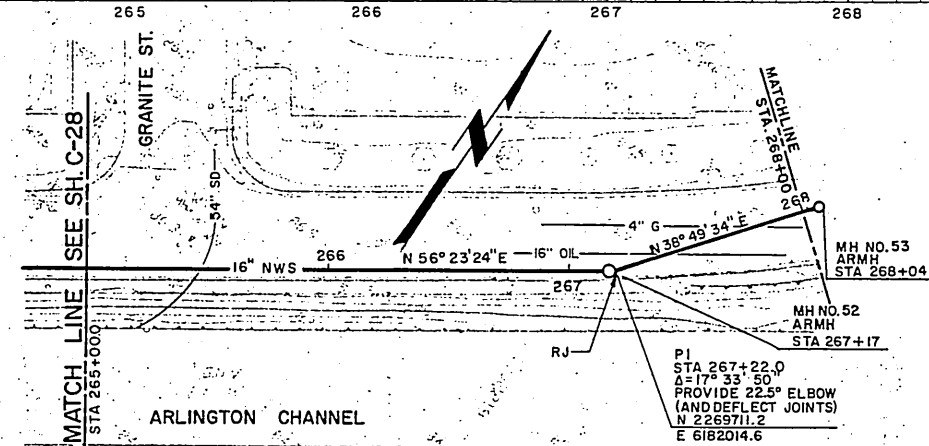
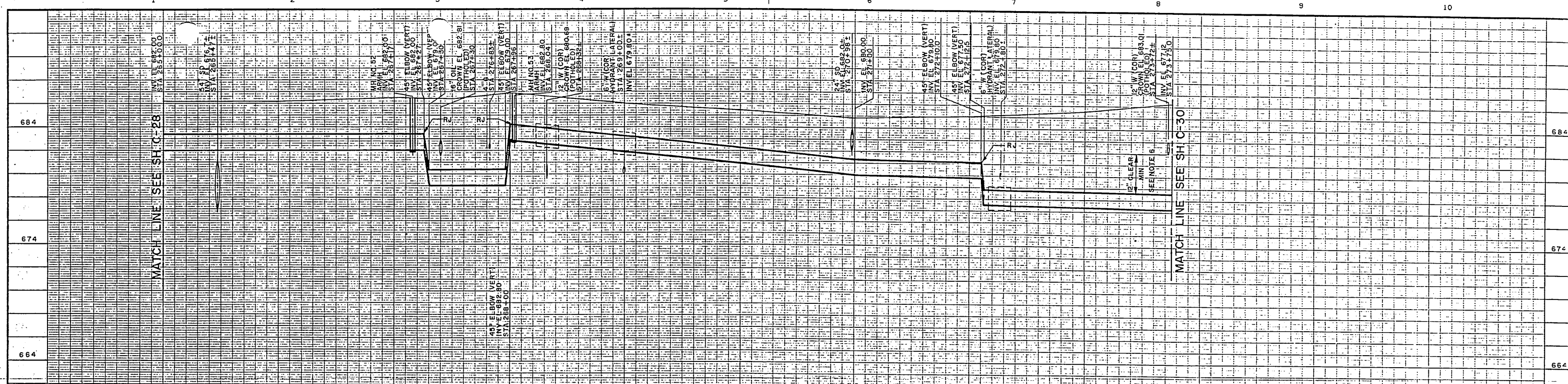

- NOTES**
1. STA 268+22 +/- TO STA 268+42 +/- SPECIAL CONSTRUCTION REQUIRED FOR 10 FEET BEYOND WATER LINE CROSSING ON BOTH SIDES OF WATER LINE. CONTRACTOR CAN ENCASE OR PROVIDE OTHER MEANS PER DETAIL E ON SHEET C-38.
  2. CONTRACTOR SHALL OBTAIN A STREET OPENING PERMIT FROM THE CITY OF RIVERSIDE PUBLIC WORKS DEPARTMENT PRIOR TO PERFORMING ANY CONSTRUCTION IN CITY STREETS.
  3. CONTRACTOR SHALL PROTECT ALL STREET LIGHTS IN PLACE.
  4. STA 268 +90 +/- TO STA 268 + 104 +/- SPECIAL CONSTRUCTION REQUIRED FOR 10 FEET BEYOND WATER LINE CROSSING ON BOTH SIDES OF WATER LINE. CONTRACTOR CAN ENCASE OR PROVIDE OTHER MEANS PER DETAIL E ON SHEET C-38.
  5. CASING PER DETAIL E, SHEET C-38.
  6. PROVIDE A MINIMUM OF 12 INCHES VERTICAL CLEARANCE BETWEEN THE NWS AND ALL WATER LINES WITHIN THE CITY OF RIVERSIDE.
  7. ALL STREET TREES IN THE CITY OF RIVERSIDE WHICH ARE REMOVED, DISTURBED, DAMAGED OR RELOCATED AS A RESULT OF THE CONTRACTOR'S ACTIVITIES SHALL BE REPLACED AT THE CONTRACTOR'S EXPENSE. ALL RELOCATED TREE PLANTING / PALM TREE RELOCATION WORK SHALL CONFORM TO THE CITY OF RIVERSIDE PARKS AND RECREATION DEPARTMENT STANDARDS AND THE CITY OF RIVERSIDE STREET TREE POLICIES. THE CONTRACTOR SHALL BE RESPONSIBLE TO ACCEPTABLY MAINTAIN ALL PLANTINGS FOR A MINIMUM PERIOD OF ONE YEAR.
  8. REPAIR AND/OR REPLACEMENT OF FIRE HYDRANTS AT STA 269+00 AND STA 272+80 SHALL INCLUDE THE REPAIR OR REPLACEMENT OF CONCRETE BLOCKING.

**CITY OF RIVERSIDE**  
PUBLIC WORKS DEPARTMENT

CITY OF RIVERSIDE  
WATER SYSTEM  
APPROVED DATE 2-27-97

APPROVED BY	DATE	BY	APPROVED BY
PRINCIPAL ENGINEER	3-4-97	[Signature]	PUBLIC WORKS DIRECTOR
PLANNING DEPARTMENT	3-3-97	[Signature]	
TRAFFIC DIVISION	3-3-97	[Signature]	
CHIEF W. ENGINEER	3-3-97	[Signature]	
PUBLIC UTIL. ELEZ	3/3/97	[Signature]	

**WESTERN RIVERSIDE COUNTY**  
REGIONAL WASTEWATER SYSTEM  
SOUTH REGIONAL COLLECTION SYSTEM  
NONRECLAIMABLE WASTEWATER SEWER  
PLAN AND PROFILE

PROJECT NO. 23068  
SCALE = HORIZ: 1" = 40' VERT: 1" = 4'

C-29  
SHEET 34 OF

DESIGNED J.G., P.K.  
DETAILED J.V., K.T.  
CHECKED G.M.C.  
APPROVED J.V.  
DATE 6-26-96

**Black & Veatch**  
Irvine, California

DATE	REVISIONS AND RECORD OF ISSUE	NO.	BY	CK	APP

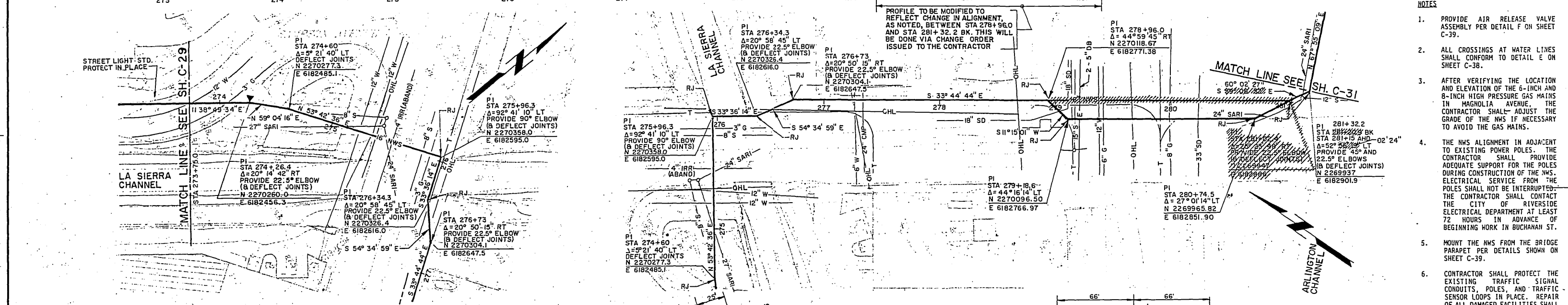
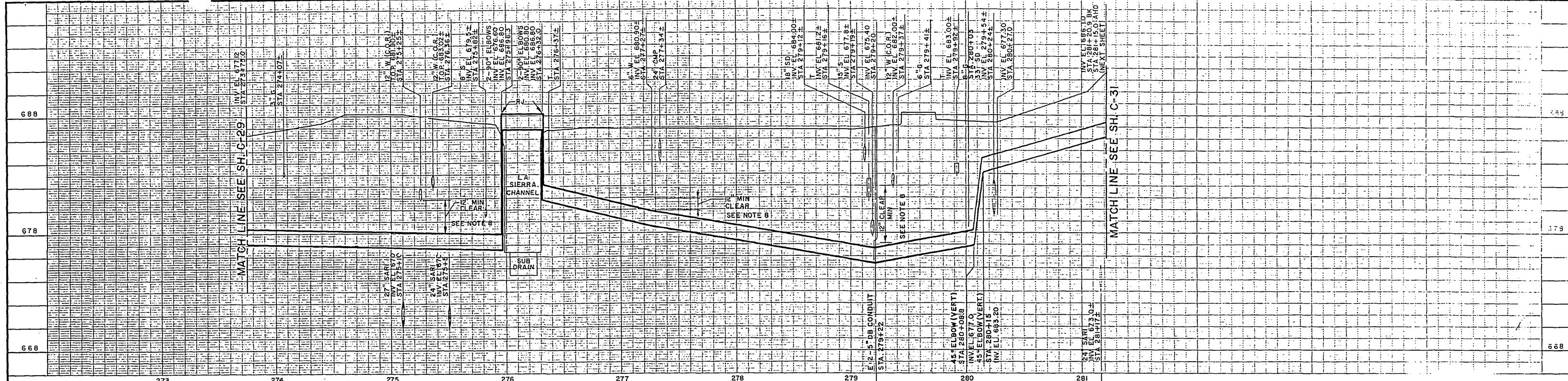

- NOTES**
1. PROVIDE AIR RELEASE VALVE ASSEMBLY PER DETAIL F ON SHEET C-39.
  2. ALL CROSSINGS AT WATER LINES SHALL CONFORM TO DETAIL E ON SHEET C-38.
  3. AFTER VERIFYING THE LOCATION AND ELEVATION OF THE 6-INCH AND 8-INCH HIGH PRESSURE GAS MAINS IN MAGNOLIA AVENUE, THE CONTRACTOR SHALL ADJUST THE GRADE OF THE NWS IF NECESSARY TO AVOID THE GAS MAINS.
  4. THE NWS ALIGNMENT IN ADJACENT TO EXISTING POWER POLES. THE CONTRACTOR SHALL PROVIDE ADEQUATE SUPPORT FOR THE POLES DURING CONSTRUCTION OF THE NWS. ELECTRICAL SERVICE FROM THE POLES SHALL NOT BE INTERRUPTED. THE CONTRACTOR SHALL CONTACT THE CITY OF RIVERSIDE ELECTRICAL DEPARTMENT AT LEAST 72 HOURS IN ADVANCE OF BEGINNING WORK IN BUCHANAN ST.
  5. MOUNT THE NWS FROM THE BRIDGE PARAPET PER DETAILS SHOWN ON SHEET C-39.
  6. CONTRACTOR SHALL PROTECT THE EXISTING TRAFFIC SIGNAL CONDUITS, POLES, AND TRAFFIC SENSOR LOOPS IN PLACE. REPAIR OF ALL DAMAGED FACILITIES SHALL BE PERFORMED AT THE CONTRACTOR'S EXPENSE AND SHALL CONFORM TO CITY OF RIVERSIDE RECORD PLAN X-459.
  7. CONTRACTOR SHALL OBTAIN A STREET OPENING PERMIT FROM THE CITY OF RIVERSIDE PUBLIC WORKS DEPARTMENT PRIOR TO PERFORMING ANY CONSTRUCTION IN CITY STREETS PER ENCROACHMENT PERMIT E-1 ISSUED TO WESTERN RIVERSIDE COUNTY REGIONAL WASTEWATER AUTHORITY.
  8. PROVIDE A MINIMUM OF 12 INCHES VERTICAL CLEARANCE BETWEEN THE NWS AND ALL WATER LINES WITHIN THE CITY OF RIVERSIDE.
  9. DIMENSIONS NOT SHOWN FOR EASEMENT NOS. APN 142-160-015, APN 142-160-006, AND APN 135-220-035 ARE PROVIDED IN SECTION 01500 OF THE SPECIFICATIONS.

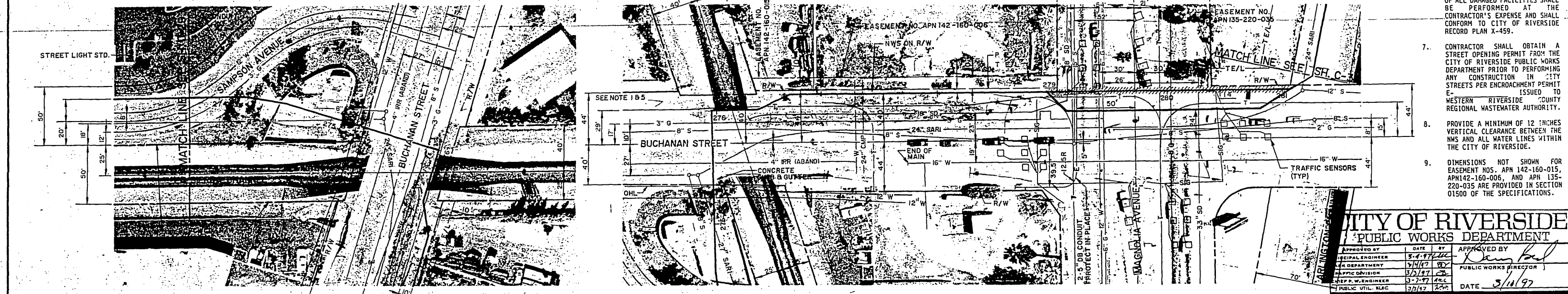

<b>CITY OF RIVERSIDE</b> PUBLIC WORKS DEPARTMENT APPROVED BY: [Signature] DATE: 3/10/97 PUBLIC WORKS DIRECTOR		<b>WESTERN RIVERSIDE COUNTY</b> REGIONAL WASTEWATER SYSTEM SOUTH REGIONAL COLLECTION SYSTEM NONRECLAIMABLE WASTEWATER SEWER PLAN AND PROFILE		<b>C-30</b> SHEET 35 OF
DESIGNED: J.G., P.K. DETAILED: K.T., S.W. CHECKED: G.M.C. APPROVED: [Signature] DATE: 6-26-96		PROJECT NO.: 23068 SCALE: HORIZ. 1"=40' VERT. 1"=4'		
DATE: _____ REVISIONS AND RECORD OF ISSUE: _____ NO. BY CK APP		CITY OF RIVERSIDE WATER SYSTEM APPROVED: [Signature] DATE: 2-27-97		

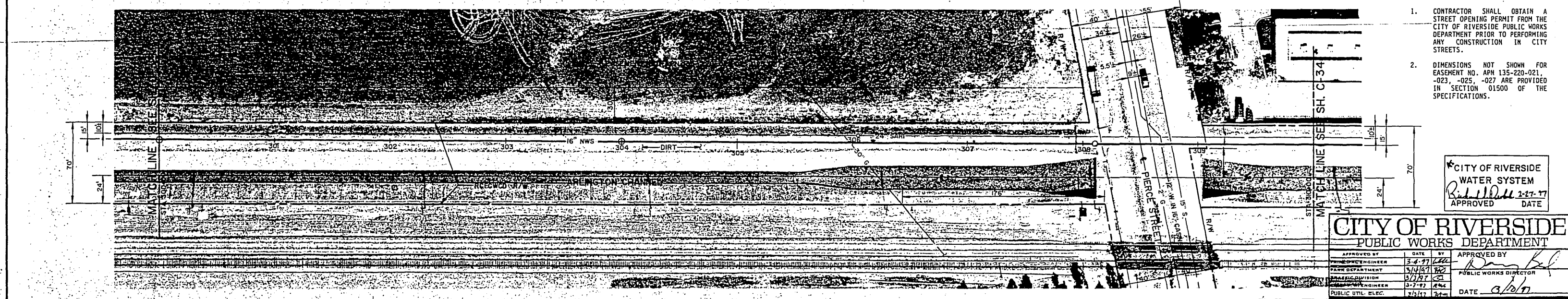
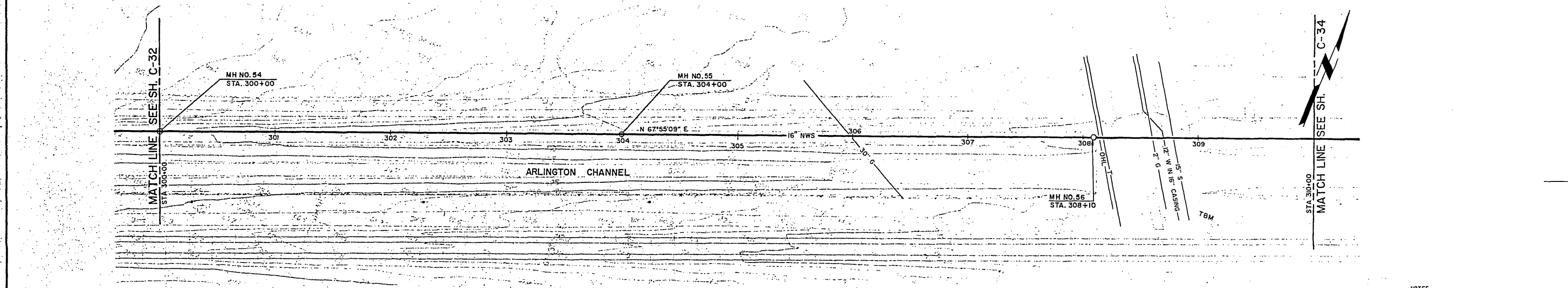
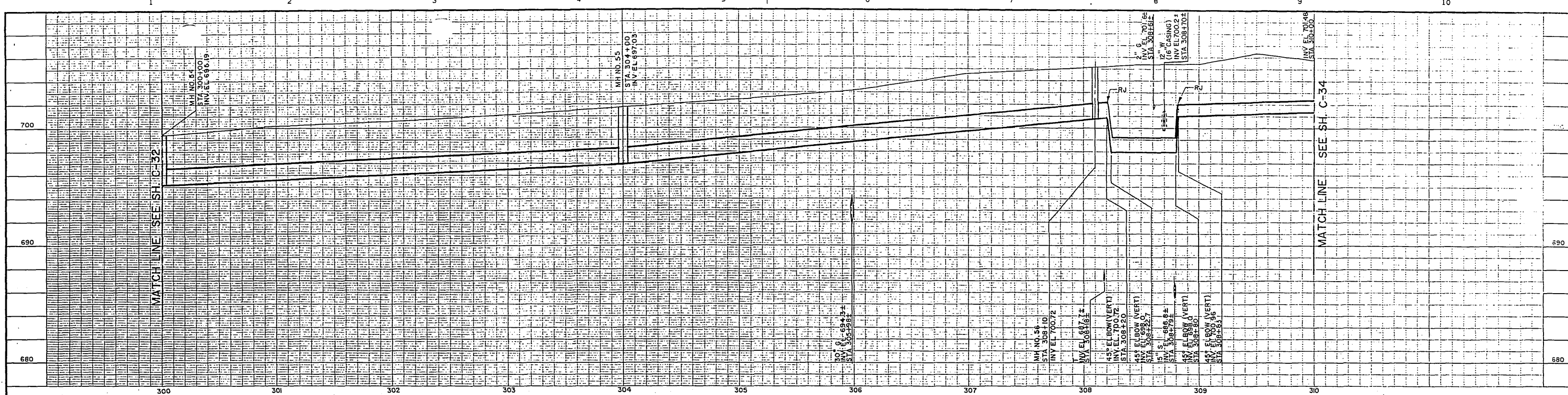

- NOTES
- CONTRACTOR SHALL OBTAIN A STREET OPENING PERMIT FROM THE CITY OF RIVERSIDE PUBLIC WORKS DEPARTMENT PRIOR TO PERFORMING ANY CONSTRUCTION IN CITY STREETS.
  - DIMENSIONS NOT SHOWN FOR EASEMENT NO. APN 135-220-021, -023, -025, -027 ARE PROVIDED IN SECTION 01500 OF THE SPECIFICATIONS.

CITY OF RIVERSIDE  
WATER SYSTEM  
*R. J. [Signature]* 2-27-77  
APPROVED DATE

CITY OF RIVERSIDE PUBLIC WORKS DEPARTMENT	
APPROVED BY	DATE
DESIGNED	3-2-77
DETAILS	3/1/77
CHECKED	3/1/77
APPROVED	3-7-77
PUBLIC UTIL. ELEC.	2/5/77

WESTERN RIVERSIDE COUNTY  
REGIONAL WASTEWATER SYSTEM  
SOUTH REGIONAL COLLECTION SYSTEM  
NONRECLAIMABLE WASTEWATER SEWER  
PLAN AND PROFILE

PROJECT NO. 23068  
SCALE= HORIZ: 1"=40'  
VERT: 1"=4'

C-33  
SHEET 38 OF

DATE	REVISIONS AND RECORD OF ISSUE	NO.	BY	CK	APP

DESIGNED J.G., P.K.  
 DETAILED S.G.  
 CHECKED GMC  
 APPROVED [Signature]  
 DATE 6-26-90

**Black & Veatch**  
Irvine, California



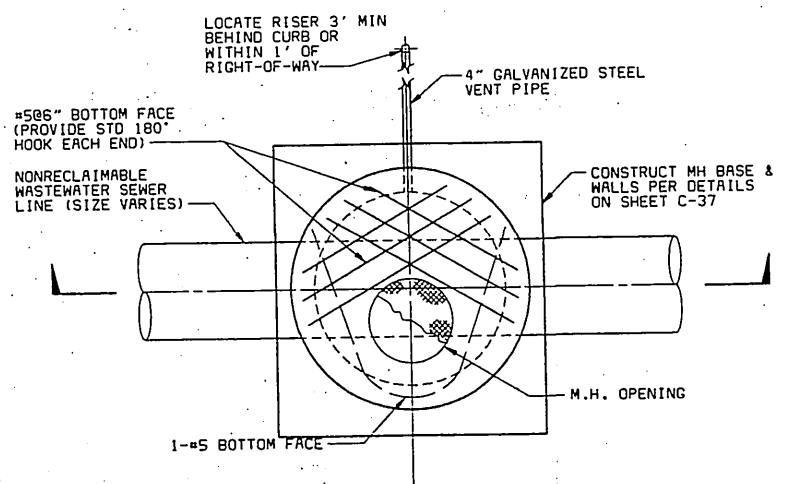

PLAN

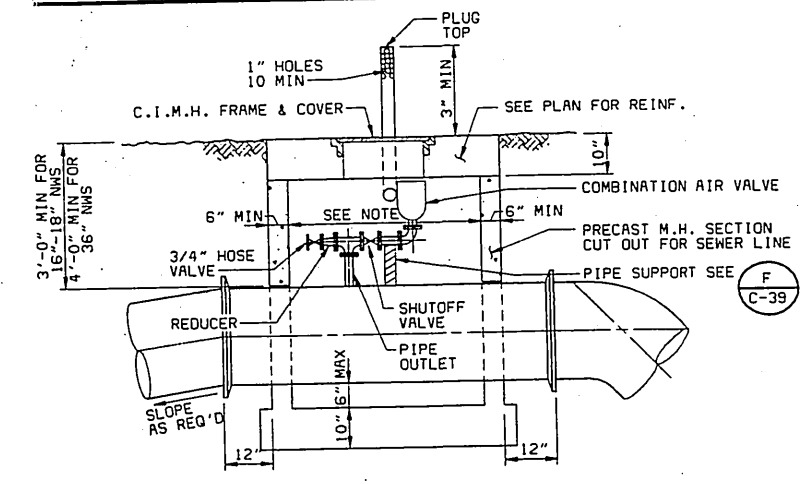

SECTION

NOTE:  
MANHOLE DIAMETER IS 4'-0" FOR 16"  
AND 18" NWS, 5'-0" FOR 36" NWS.

AIR RELEASE VALVE MANHOLE DETAIL A  
NO SCALE

AIR RELEASE VALVE ASSEMBLY SIZING			
NWS PIPE SIZE	COMBINATION AIR VALVE SIZE	SHUTOFF VALVE SIZE	ASSEMBLY PIPE SIZE
16"	1"	1"	1"
18"	1 1/2"	1 1/2"	1 1/2"
36"	4"	4"	4"

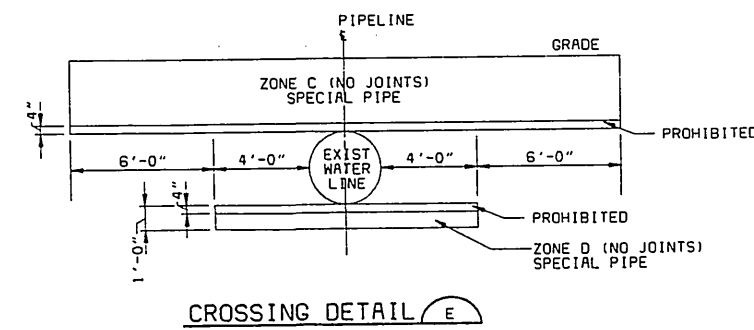

CROSSING DETAIL E

PLACEMENT OF A NEW SEWER CROSSING AN EXISTING WATER LINE MUST COMPLY WITH THE SPECIAL CONSTRUCTION REQUIREMENTS LISTED BELOW (AS REQUIRED BY THE CALIFORNIA DEPARTMENT OF HEALTH SERVICES).

ZONE C SPECIAL CONSTRUCTION REQUIRED FOR SEWER

1. DUCTILE IRON PIPE WITH HOT DIP BITUMINOUS COATING AND MECHANICAL JOINTS.
2. A CONTINUOUS SECTION OF CLASS 200 (DR 14 PER AWWA C900 OR C905) PLASTIC PIPE OR EQUIVALENT, CENTERED OVER THE PIPE BEING CROSSED.
3. A CONTINUOUS SECTION OF REINFORCED CONCRETE PRESSURE PIPE (PER AWWA C302-74) CENTERED OVER THE PIPE BEING CROSSED.
4. ANY SEWER PIPE WITHIN A CONTINUOUS SLEEVE.

ZONE D SPECIAL CONSTRUCTION REQUIRED FOR SEWER

1. A CONTINUOUS SECTION OF DUCTILE IRON PIPE WITH HOT DIP BITUMINOUS COATING.
2. A CONTINUOUS SECTION OF CLASS 200 (DR 14 PER AWWA C900 OR C905) PLASTIC PIPE OR EQUIVALENT, CENTERED ON THE PIPE BEING CROSSED.
3. A CONTINUOUS SECTION OF REINFORCED CONCRETE PRESSURE PIPE (PER AWWA C302-74) CENTERED ON THE PIPE BEING CROSSED.
4. ANY SEWER PIPE WITHIN A CONTINUOUS SLEEVE.
5. ANY SEWER PIPE SEPARATED BY A TEN-FOOT BY TEN-FOOT, FOUR-INCH THICK REINFORCED CONCRETE SLAB.

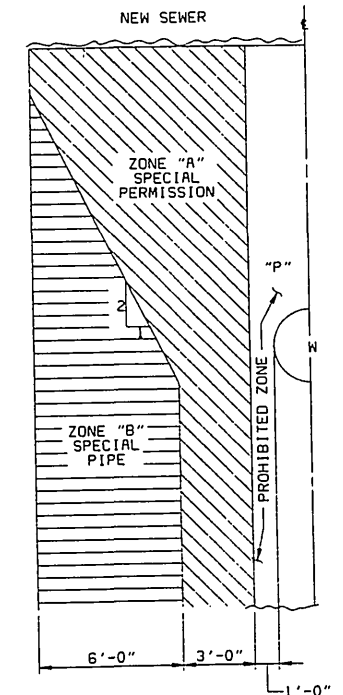

NOTE:  
ZONES IDENTICAL ON EITHER SIDE OF CENTER LINE.  
ZONE "P" IS A PROHIBITED ZONE, SECTION 64630  
(E)(2) CALIFORNIA ADMINISTRATIVE CODE, TITLE 22

PARALLEL CONSTRUCTION DETAIL F

PLACEMENT OF A NEW SEWER PARALLEL TO AND WITHIN 10 FEET OF AN EXISTING WATER LINE MUST COMPLY WITH THE SPECIAL CONSTRUCTION REQUIREMENTS LISTED BELOW (AS REQUIRED BY THE CALIFORNIA DEPARTMENT OF HEALTH SERVICES).

ZONE A SPECIAL CONSTRUCTION REQUIRED FOR SEWER

SEWER LINES PARALLEL TO WATER MAINS SHALL NOT BE PERMITTED IN THIS ZONE WITHOUT APPROVAL FROM THE RESPONSIBLE HEALTH AGENCY AND WATER SUPPLIER.

ZONE B SPECIAL CONSTRUCTION REQUIRED FOR SEWER

1. EXTRA STRENGTH VITRIFIED CLAY PIPE WITH COMPRESSION JOINTS.
2. CLASS 4000, TYPE II, ASBESTOS-CEMENT PIPE WITH RUBBER GASKET JOINTS.
3. PLASTIC SEWER PIPE WITH RUBBER RING JOINTS (PER ASTM D3034) OR EQUIVALENT.
4. CAST OR DUCTILE IRON PIPE WITH COMPRESSION JOINTS.
5. REINFORCED CONCRETE PRESSURE PIPE WITH COMPRESSION JOINTS (PER AWWA C302-74).

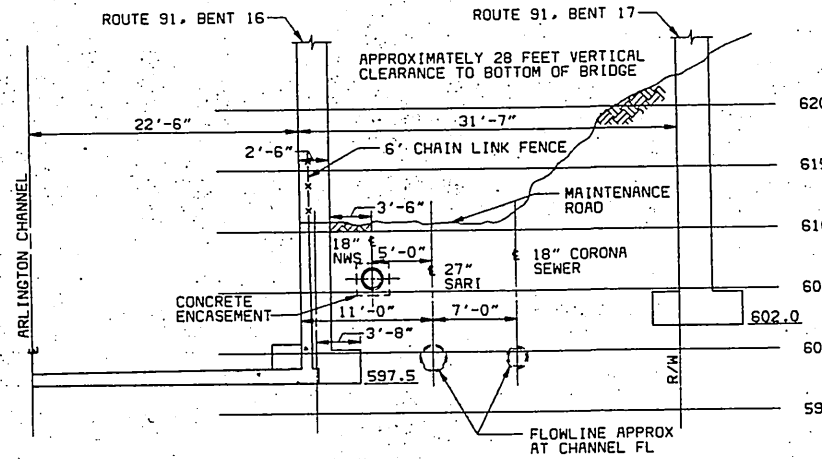

SECTION AT 91 FREEWAY C  
1/8"=1'-0"  
(CALTRANS-TEMESCAL WASH BRIDGE) C-11.12

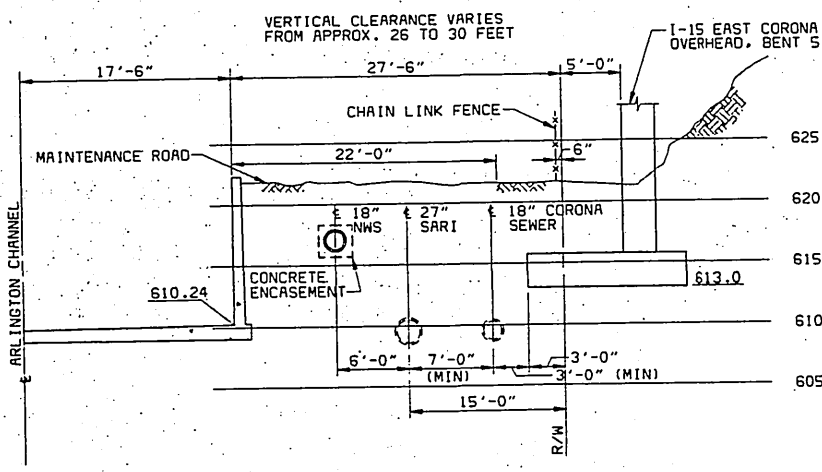

SECTION AT I-15 FREEWAY D  
1/8"=1'-0"  
(CALTRANS-EAST CORONA OVERHEAD) C-13,14

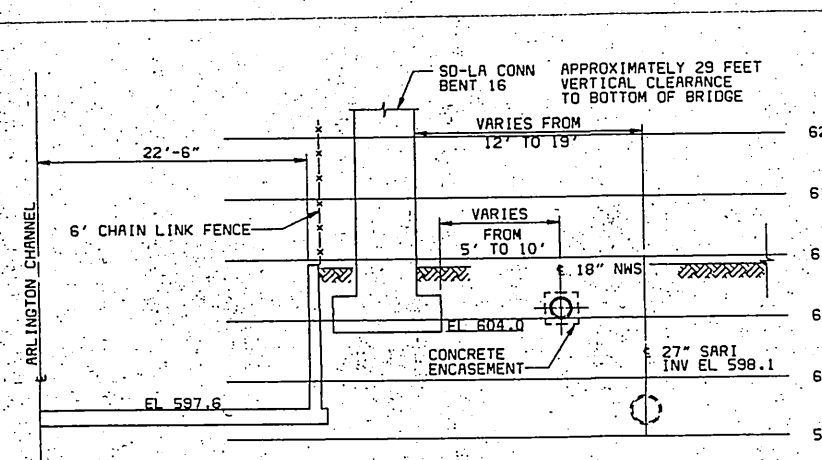

SECTION AT 91 FREEWAY G  
1/8"=1'-0"  
(I-15 TO 91 TRANSITION)  
(CALTRANS-TEMESCAL WASH BRIDGE, SD-LA CONN) C-11

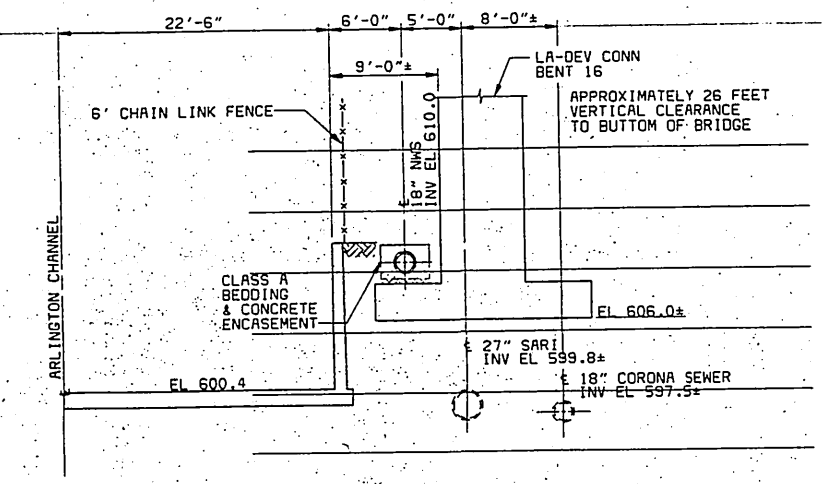

SECTION AT 91 FREEWAY H  
1/8"=1'-0"  
(91 FWY TO I-15 TRANSITION)  
(CALTRANS-TEMESCAL WASH BRIDGE, LA-DEV CONN) C-12

CITY OF RIVERSIDE  
WATER SYSTEM  
APPROVED BY: *Richard J. Deibel* 2-27-97  
DATE

CITY OF RIVERSIDE PUBLIC WORKS DEPARTMENT	
APPROVED BY	DATE
PRINCIPAL ENGINEER	
TRAFFIC DIVISION	
CHIEF P.W. ENGINEER	
PUBLIC UTIL. ELEC.	
PUBLIC WORKS DIRECTOR	
	DATE

WESTERN RIVERSIDE COUNTY  
REGIONAL WASTEWATER SYSTEM  
SOUTH REGIONAL COLLECTION SYSTEM  
NONRECLAIMABLE WASTEWATER SEWER  
MISCELLANEOUS DETAILS

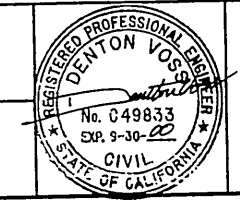

C-38  
SHEET  
43 OF

NO.	BY	CK	APP	DATE	REVISIONS AND RECORD OF ISSUE

DESIGNED: JTG  
DETAILED: SSH/CND  
CHECKED: GMC  
APPROVED: DJV  
DATE: 6-26-96



PROJECT NO.  
23068  
SCALE=  
AS NOTED

CALTRANS STANDARDS  
PLAN LIST



INFORMATIONAL BARRICADE

TYPE III BARRICADE  
W/C-16  
2N-3 MARKERS  
2 LIGHTS

THIS SIGN SHALL BE USED ON ALL LIMITED ACCESS LOCATIONS IN CONJUNCTION WITH FLAGGER USE.

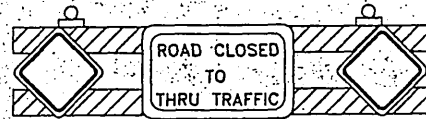

INFORMATIONAL BARRICADE

TYPE III BARRICADE-10'  
W/C-3A  
C-SRT OR C-SLT (PER PLAN)  
2N-3 MARKERS  
3 LIGHTS

LEGEND

- 36 INCH PORTABLE TRAFFIC DELINEATOR
- I TYPE II BARRICADE
- F TYPE III BARRICADE
- o SIGN ON TEMPORARY POST
- FLAGMAN
- ▬ ARROW BOARD
- EDGE OF PAVEMENT
- RIGHT-OF-WAY
- CURB AND GUTTER

SIGN LEGEND

- C1 DETOUR
- C2 ROAD CLOSED
- C5 DETOUR (LEFT) OR (RIGHT)
- C7 END DETOUR
- C9A FLAGGER SYMBOL
- C13 END CONSTRUCTION
- C16 ONE LANE ROAD AHEAD
- C17 SPEED LIMIT
- C18 ROAD CONSTRUCTION AHEAD
- C19 ROAD CLOSED AHEAD
- C20 RT. CENTER, OR LT. LANE CLOSED
- C21 SINGLE LANE AHEAD
- C24 SHOULDER WORK AHEAD
- C30 LANE CLOSED
- C36 PREPARE TO STOP
- W2 REVERSE TURN
- W6 ADVISORY SPEED PLATE
- W56 DOUBLE HEAD ARROW
- W57 SINGLE HEAD ARROW
- W74 THRU TRAFFIC MERGE LEFT OR RIGHT
- R10A ONE WAY
- R16 NO RIGHT TURN
- R17 NO LEFT TURN
- R18 RIGHT LANE MUST TURN RT.
- R41 RIGHT TURN ONLY

GENERAL NOTES

1. TRAFFIC SIGNS, MARKINGS, TRAFFIC SIGNALS AND HIGHWAY LIGHTING SYSTEMS PER CALTRANS STANDARD PLANS, STANDARD SPECIFICATIONS AND TRAFFIC SIGN SPECIFICATIONS DATED JULY 1992. SIGNS AND BARRICADES MAY BE RELOCATED AND REUSED FOR SUCCESSIVE CONSTRUCTION PHASES, HOWEVER SIGNS AND BARRICADES SHALL NOT BE RELOCATED UNTIL THEY ARE NO LONGER NECESSARY FOR THE CONSTRUCTION PHASE WHERE THEY WERE ORIGINALLY REQUIRED.
2. THE CONTRACTOR SHALL MAINTAIN ON A 24-HOUR BASIS ALL SIGNS, DELINEATORS, BARRICADES, ETC., TO ENSURE PROPER FLOW AND SAFETY OF TRAFFIC. ALL TRAFFIC CONTROL DEVICES MUST BE IN PLACE AND IN PROPER WORKING ORDER BEFORE THE START OF WORK EACH DAY. IF IT IS FOUND THAT TRAFFIC CONTROL DEVICES ARE OUT OF PLACE OR INOPERATIVE, WORK WILL BE HALTED UNTIL THE NECESSARY CORRECTIONS ARE MADE.
3. THE CONTRACTOR SHALL COORDINATE THE TRAFFIC SIGNAL OPERATIONAL MODIFICATIONS WITH THE AGENCY HAVING JURISDICTION.
4. CONTRACTOR SHALL OBTAIN APPROVAL FOR EXACT EQUIPMENT LOCATION PRIOR TO FINAL PLACEMENT.
5. TRAFFIC CONTROL AT INTERSECTIONS SHALL BE ADJUSTED TO ALLOW TRAFFIC ACCESS TO THE INTERSECTION IMMEDIATELY AFTER CONSTRUCTION IS COMPLETE ENOUGH TO ALLOW SAFE USE OF THE ROADWAY.
6. LANE OR ROAD CLOSURES SHALL BE LIMITED TO WEEKDAYS BETWEEN 8:30 A.M. AND 3:30 P.M., AND ONLY WHILE CONSTRUCTION IS IN PROGRESS.
7. ALL LANE CLOSURE SIGNS SHALL BE REMOVED OR COVERED WHEN LANES ARE OPEN.
8. ALL EXCAVATIONS SHALL BE COMPLETELY BACKFILLED AND TEMPORARILY PAVED AT THE END OF EACH WORKING DAY.
9. CONTRACTOR SHALL RESTORE ALL STRIPING AND MARKINGS TO THEIR ORIGINAL LOCATIONS AT THE COMPLETION OF ALL WORK.
10. ANY REVISION TO THESE DRAWINGS SHALL BE APPROVED IN WRITING BY THE ENGINEER OF RECORD AND THE AGENCY HAVING JURISDICTION.
11. SIGNING MAY BE MOUNTED ON WOODEN POSTS OR PORTABLE SUPPORTS UNLESS OTHERWISE INDICATED ON THE PLAN.
12. ALL STREET CROSSINGS SHALL BE CUT IN HALF-STREET SECTIONS TO FACILITATE TRAFFIC FLOW, UNLESS OTHERWISE INDICATED ON THESE
13. CONTRACTOR SHALL REPLACE DAMAGED SIGNAL DETECTOR LOOPS PER AGENCY'S SPECIFICATIONS.
14. ALL TRAFFIC CONTROL MARKINGS SHALL BE TEMPORARY MARKINGS PER CALTRANS STANDARD SPECIFICATIONS AND/OR AS DIRECTED BY THE AGENCY'S TRAFFIC ENGINEER.
15. PARKING WITHIN THE AREAS OF IMPROVEMENT MAY BE RESTRICTED DURING CONSTRUCTION OPERATIONS. TEMPORARY "NO PARKING" SIGNS SHALL BE PROVIDED AND POSTED BY THE CONTRACTOR TWO (2) WORKING DAYS IN ADVANCE OF CONSTRUCTION. THE "NO PARKING" SIGNS SHALL CLEARLY STATE THE DATE AND HOURS DURING WHICH THE RESTRICTION IS EFFECTIVE. PERMISSION AND REQUIREMENTS SHALL BE OBTAINED FROM THE TRAFFIC ENGINEER OF THE AGENCY HAVING JURISDICTION FOR ANY "NO PARKING" SIGNS TO BE POSTED ON EXISTING TREES, UTILITY POLES, AND TRAFFIC SIGNS.
16. ALL ADJACENT BUSINESSES AND RESIDENCES SHALL BE DULY NOTIFIED BY THE CONTRACTOR, IN WRITING, OF HIS PROPOSED OPERATION. NOTICE SHALL BE DELIVERED AT LEAST TWO (2) WORKING DAYS PRIOR TO START OF CONSTRUCTION. THE CONTRACTOR SHALL BE RESPONSIBLE FOR REPRODUCTION OF THE LETTERS. REMOVAL OF THE LETTERS WILL BE REQUIRED IF THE CONTRACTOR'S SCHEDULE IS ALTERED, OR OTHER DELAYS OCCUR WHICH AFFECT THE PROJECT'S SCHEDULE.
17. THE CONTRACTOR SHALL OBTAIN AND PAY FOR ALL NECESSARY PERMITS FROM AGENCIES HAVING JURISDICTION FOR ANY TYPE OF STREET CLOSURE FULL OR PARTIAL. IF IN THE DETERMINATION OF THE TRAFFIC ENGINEER, A FULL CLOSURE IS REQUIRED, SUCH A PERMIT SHALL BE APPLIED FOR AT LEAST FIVE (5) WORKING DAYS PRIOR TO THE START OF WORK. PERMITS FOR PARTIAL STREET CLOSURES SHALL BE APPLIED FOR AT LEAST TWO (2) WORKING DAYS PRIOR TO THE START OF WORK. THE CONTRACTOR SHALL NOTIFY THE TRAFFIC ENGINEER TWO (2) WORKING DAYS PRIOR TO ANY CHANGE IN THE APPROVED CLOSURE. IN CASE OF FULL CLOSURE, THE CONTRACTOR SHALL PROVIDE BARRICADES AND REFLECTORIZED "ROAD CLOSED TO THROUGH TRAFFIC" SIGNS AT THE INTERSECTIONS IMMEDIATELY IN ADVANCE OF ALL SUCH CLOSURES AT ENTRANCES TO THE CLOSURE. AND ALL DETOUR ROUTE SIGNING, ACCESS TO LOCAL RESIDENCES AND BUSINESSES SHALL BE MAINTAINED AT ALL TIMES AS WELL AS ACCESS FOR EMERGENCY AND OTHER SERVICE VEHICLES. DETOUR SIGNS SHALL BE POSTED ON WOOD OR METAL POSTS. SIGNS SHALL NOT BE POSTED ON ANY TREE, UTILITY POLE, OR TRAFFIC SIGN.
18. AT LEAST ONE DRIVEWAY MUST REMAIN OPEN TO COMMERCIAL ESTABLISHMENTS AT ALL TIMES. ACCESS TO ALL DRIVEWAYS IN THE AREA OF CONSTRUCTION SHALL BE OPEN AND ACCESSIBLE DURING NONWORKING HOURS. THE CONTRACTOR SHALL KEEP OPEN ALL DRIVEWAYS EXCEPT FOR SHORT PERIODS OF TIME AS OUTLINED IN SPECIFICATION SECTION 7.03 "TRAFFIC CONTROL". ADEQUATE PROVISIONS FOR PEDESTRIAN ACCESS SHALL BE THE RESPONSIBILITY OF THE CONTRACTOR AT ALL LOCATIONS.
19. THE CONTRACTOR SHALL APPOINT A PERSON RESPONSIBLE TO DRIVE, OBSERVE, AND MAINTAIN THE JOB SITE AT LEAST ONCE A DAY DURING WEEKENDS AND HOLIDAYS TO ENSURE THAT THE SAFETY OF THE PUBLIC, BOTH MOTORING AND PEDESTRIAN, IS PRESERVED. THE NAME AND TELEPHONE NUMBER OF THE PERSON APPOINTED BY THE CONTRACTOR TO DRIVE AND MAINTAIN THE SITE DURING WEEKENDS AND HOLIDAYS SHALL BE SUPPLIED TO THE PROJECT ENGINEER AND CITIES OF CORONA AND RIVERSIDE PRIOR TO START OF ANY WORK.

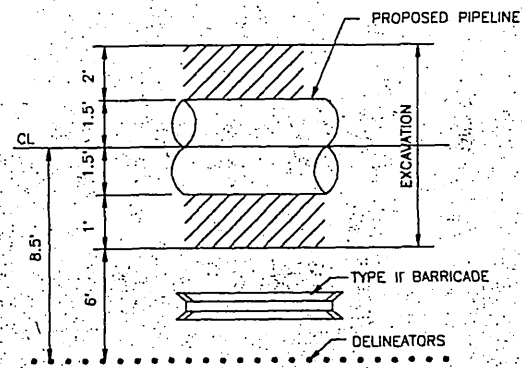

TYPICAL WORK AREA CROSS SECTION  
N.T.S.

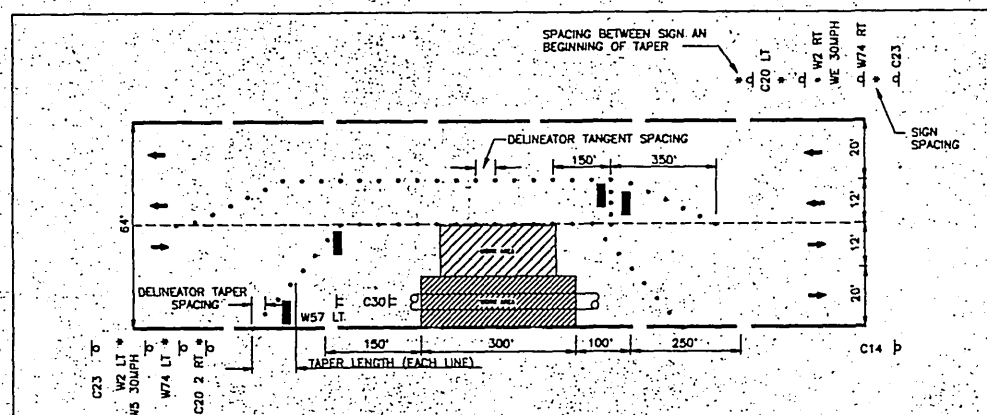

—CHART A—  
MINIMUM RECOMMENDED DELINEATOR AND SIGN PLACEMENT

TRAFFIC SPEED	TAPER LENGTH (EACH LANE)	DELINATOR (TAPER)	SPACING (TANGENT)	SIGN SPACING (ADVANCE OF TAPER & BETWEEN SIGNS)
25 MPH	150 FT.	25 FT.	50 FT.	150 FT.
30 MPH	200 FT.	30 FT.	60 FT.	200 FT.
35 MPH	250 FT.	35 FT.	70 FT.	250 FT.
40 MPH	300 FT.	40 FT.	80 FT.	300 FT.
45 MPH	350 FT.	45 FT.	90 FT.	350 FT.
50 MPH	400 FT.	50 FT.	100 FT.	400 FT.
55 MPH	450 FT.	55 FT.	110 FT.	450 FT.

MINIMUM RECOMMENDED DELINEATOR AND SIGN PLACEMENT

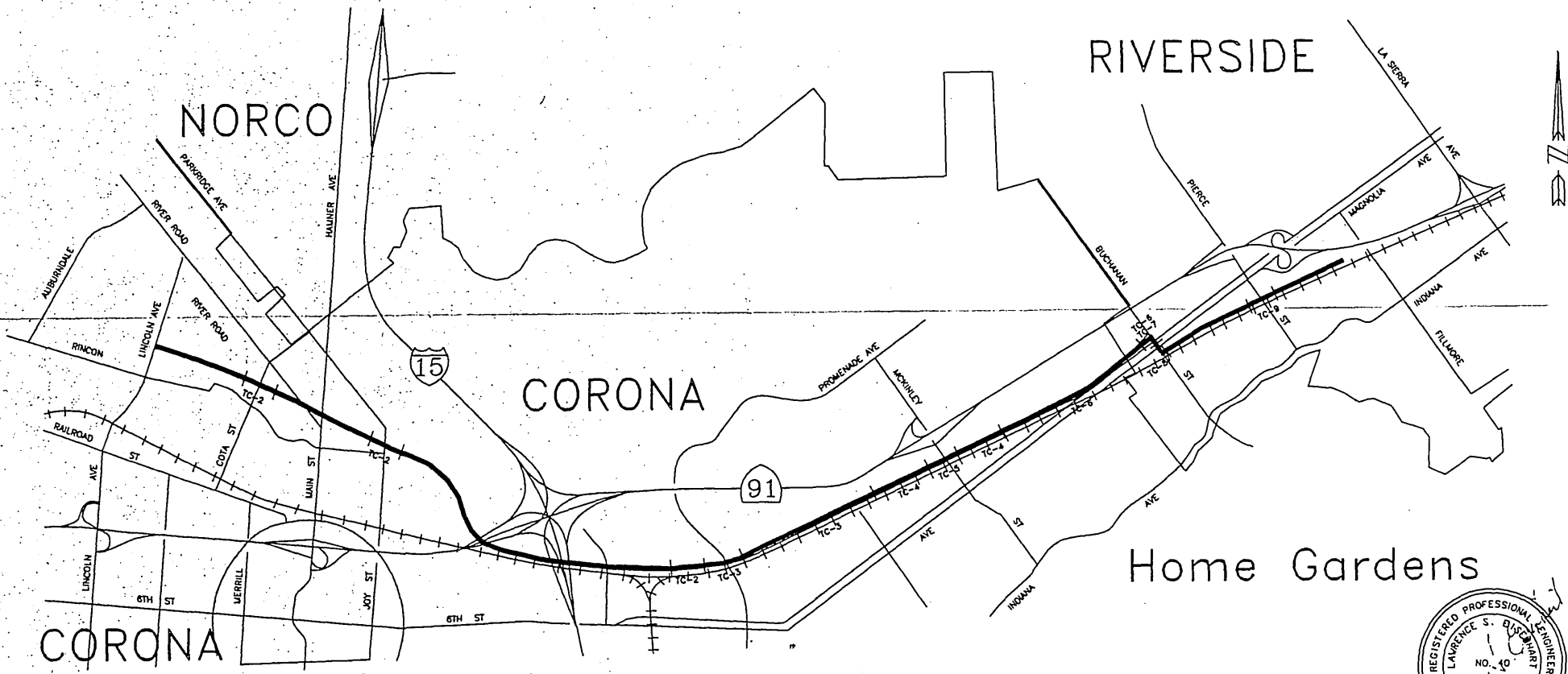

KEY PLAN  
N.T.S.

APPROVED BY:  
CITY OF RIVERSIDE  
PUBLIC WORKS DEPARTMENT  
*[Signature]*  
TRAFFIC ENGINEER

APPROVED BY:  
CITY OF CORONA  
PUBLIC WORKS DEPARTMENT  
*[Signature]*  
CITY ENGINEER/TRAFFIC ENGINEER

ALBERTA  
**WEBB**  
ASSOCIATES  
CONSULTANTS  
3788 McCRAY STREET RIVERSIDE, CA.  
(951) 586-1070

DESIGNED W.T.M.  
DETAILED R.L.P.  
CHECKED M.E.W.  
APPROVED L.S.E.  
DATE 6/96



PROJECT NO.  
96-142  
SCALE=  
N.T.S.

WESTERN RIVERSIDE COUNTY  
REGIONAL WASTEWATER SYSTEM  
SOUTH REGIONAL COLLECTION SYSTEM  
NONRECLAIMABLE WASTEWATER SEWER  
TRAFFIC CONTROL PLANS

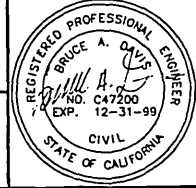

TC-1  
SHEET  
47 OF 55

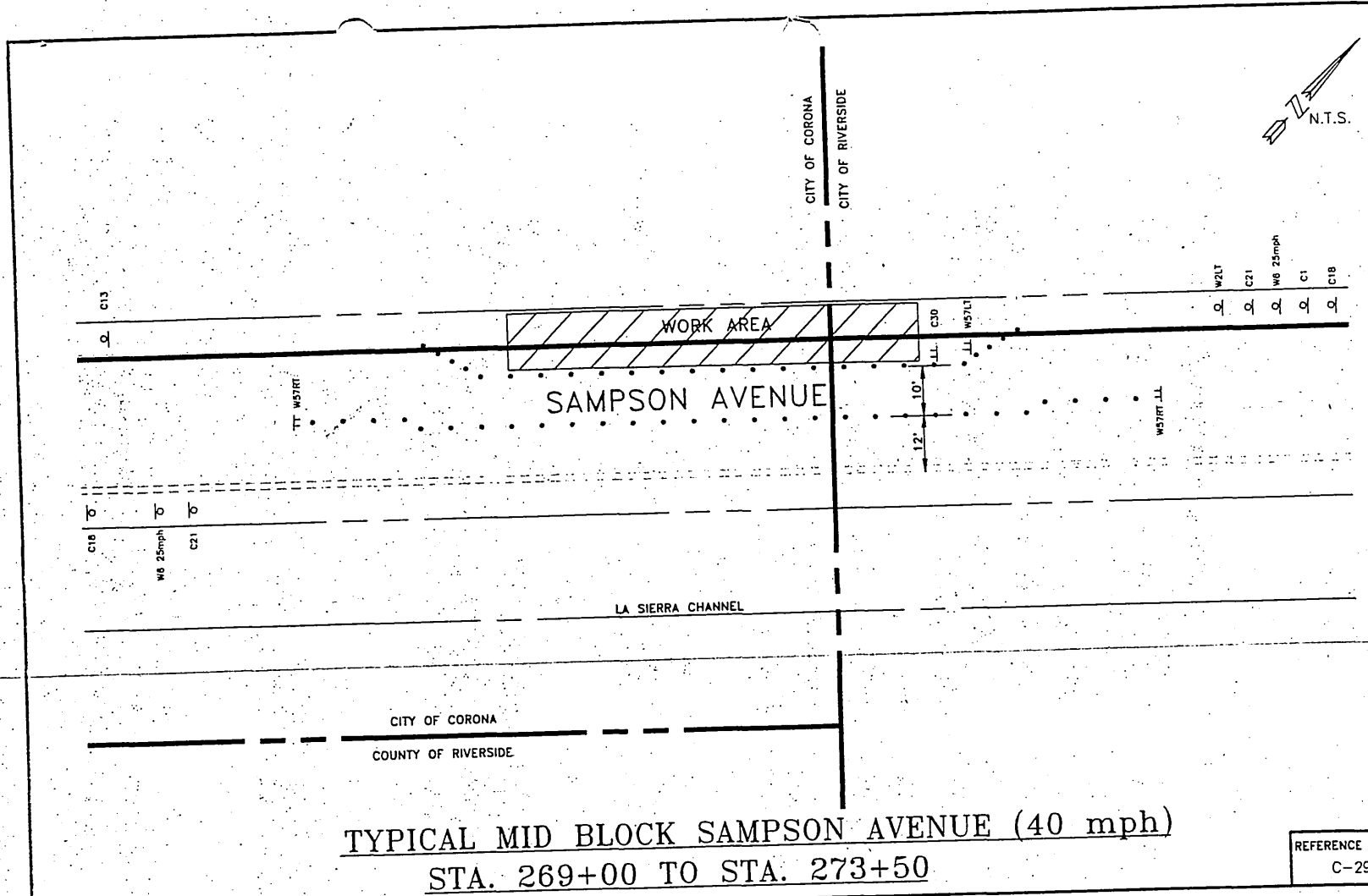

TYPICAL MID BLOCK SAMPSON AVENUE (40 mph)  
STA. 269+00 TO STA. 273+50

REFERENCE SHEET  
C-29

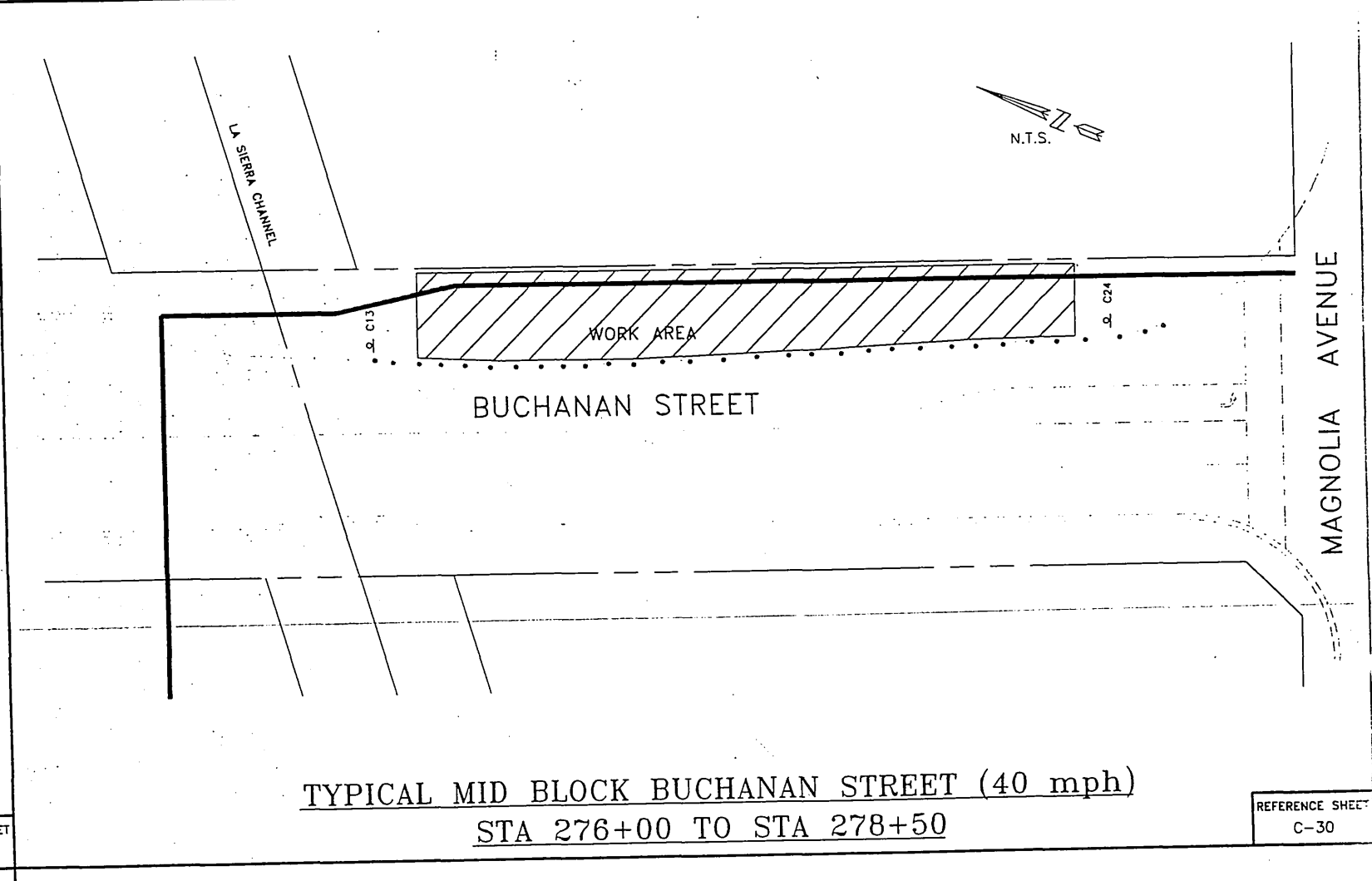

TYPICAL MID BLOCK BUCHANAN STREET (40 mph)  
STA 276+00 TO STA 278+50

REFERENCE SHEET  
C-30

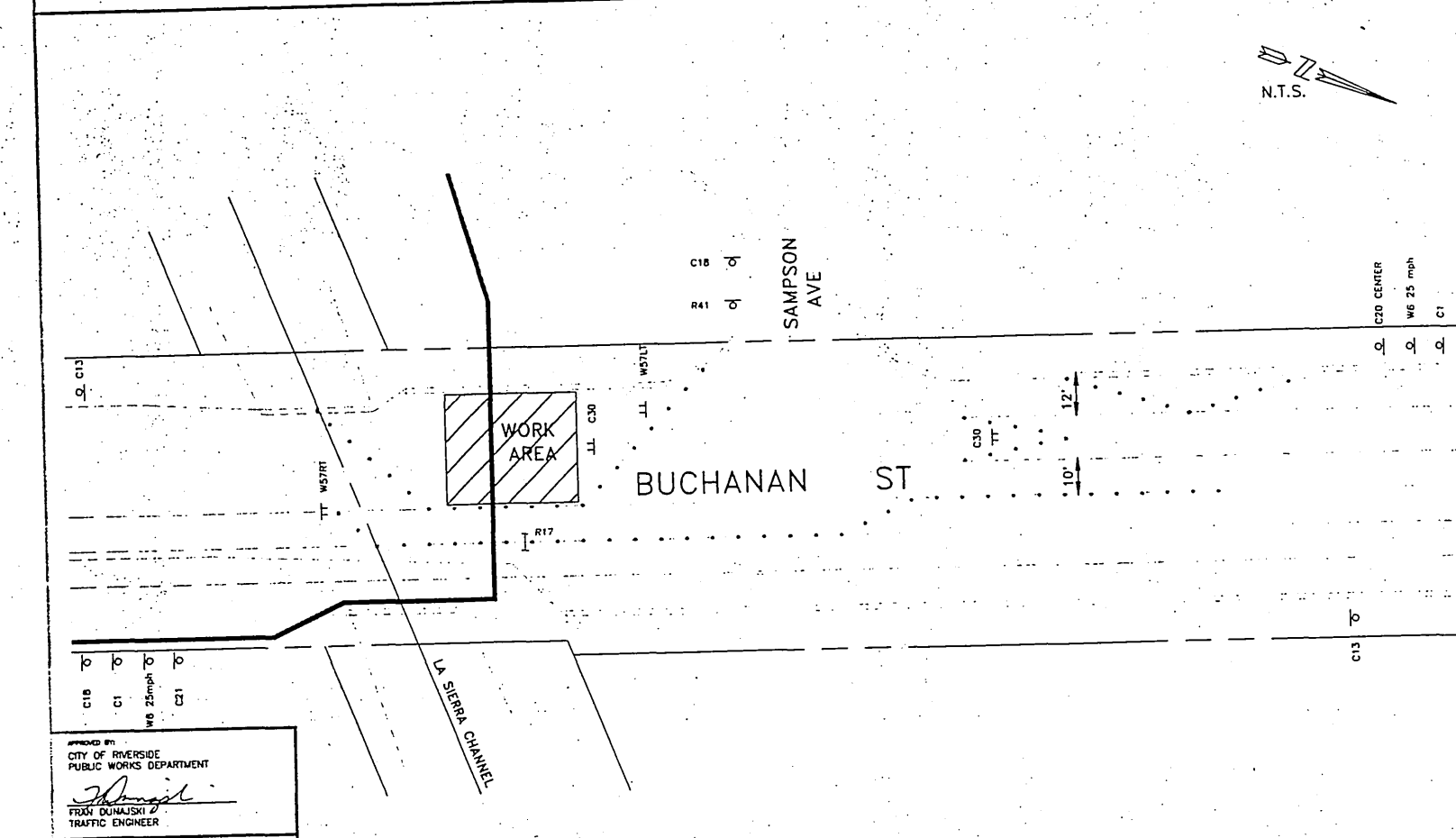

BUCHANAN STREET CROSSING (40 mph) PHASE I

REFERENCE SHEET  
C-30

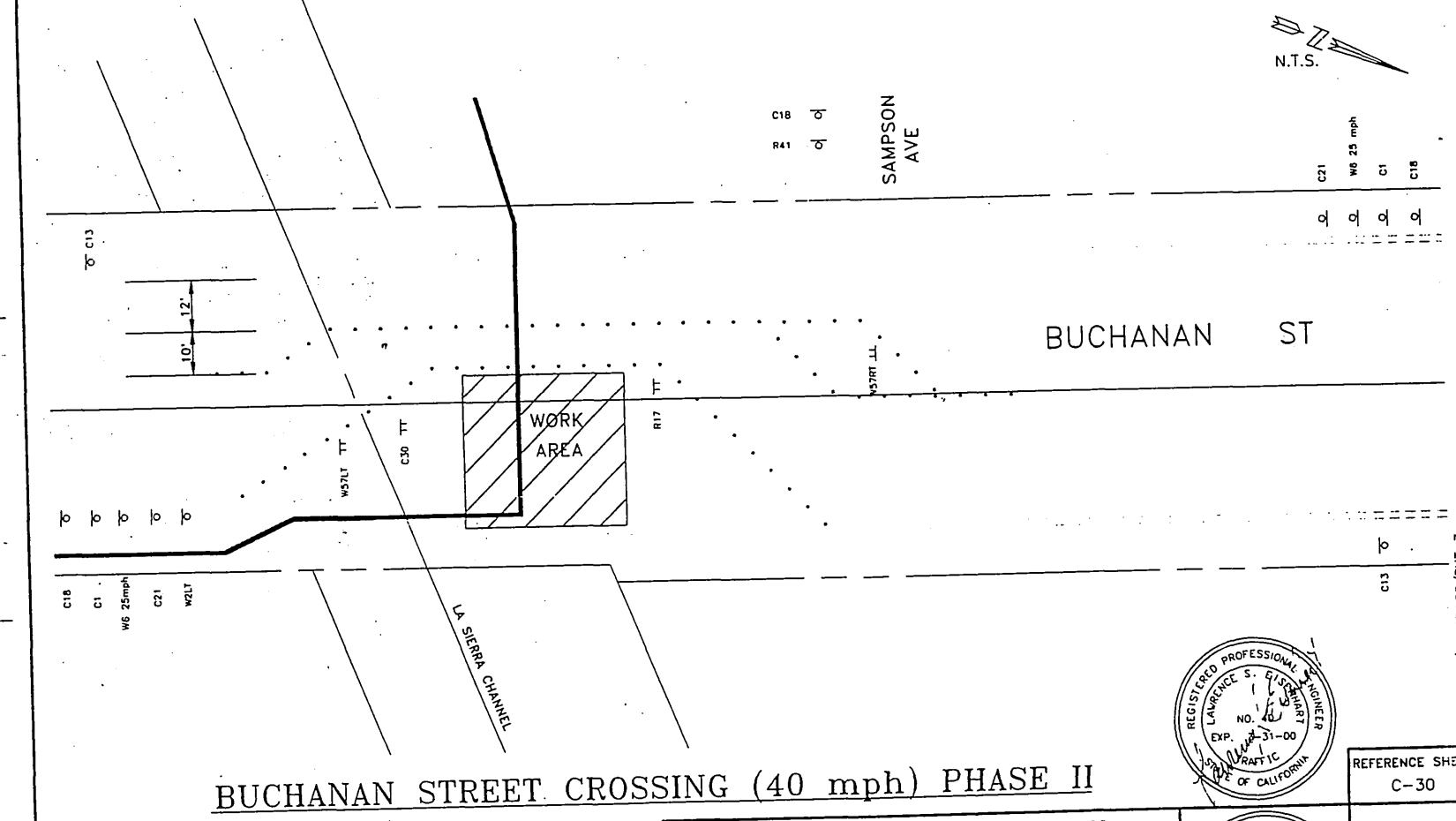

BUCHANAN STREET CROSSING (40 mph) PHASE II

REFERENCE SHEET  
C-30

APPROVED BY:  
CITY OF RIVERSIDE  
PUBLIC WORKS DEPARTMENT  
*[Signature]*  
FRAN DUMASIS  
TRAFFIC ENGINEER

APPROVED BY:  
CITY OF CORONA  
PUBLIC WORKS DEPARTMENT  
*[Signature]*  
JOE PAJENICA  
CITY ENGINEER/TRAFFIC ENGINEER

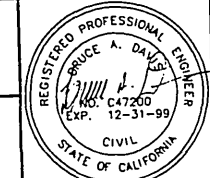

ALBERT A. WEBB ASSOCIATES  
3788 MCCRAY STREET RIVERSIDE, CA (909) 686-1070

DESIGNED: B.A.D.  
CHECKED: R.L.P.  
APPROVED: M.E.W.  
DATE: L.S.E. 6/96



PROJECT NO. 96-142  
SCALE: AS NOTED

WESTERN RIVERSIDE COUNTY  
REGIONAL WASTEWATER SYSTEM  
SOUTH REGIONAL COLLECTION SYSTEM  
NONRECLAIMABLE WASTEWATER SEWER  
TRAFFIC CONTROL PLANS

TC-7  
SHEET  
53 OF 55

WASTEWATER 96-097T

NO.	DATE	REVISIONS AND RECORD OF ISSUE	NO.	BY	CK	APP

96-0142/CONTRACT/SHT-7

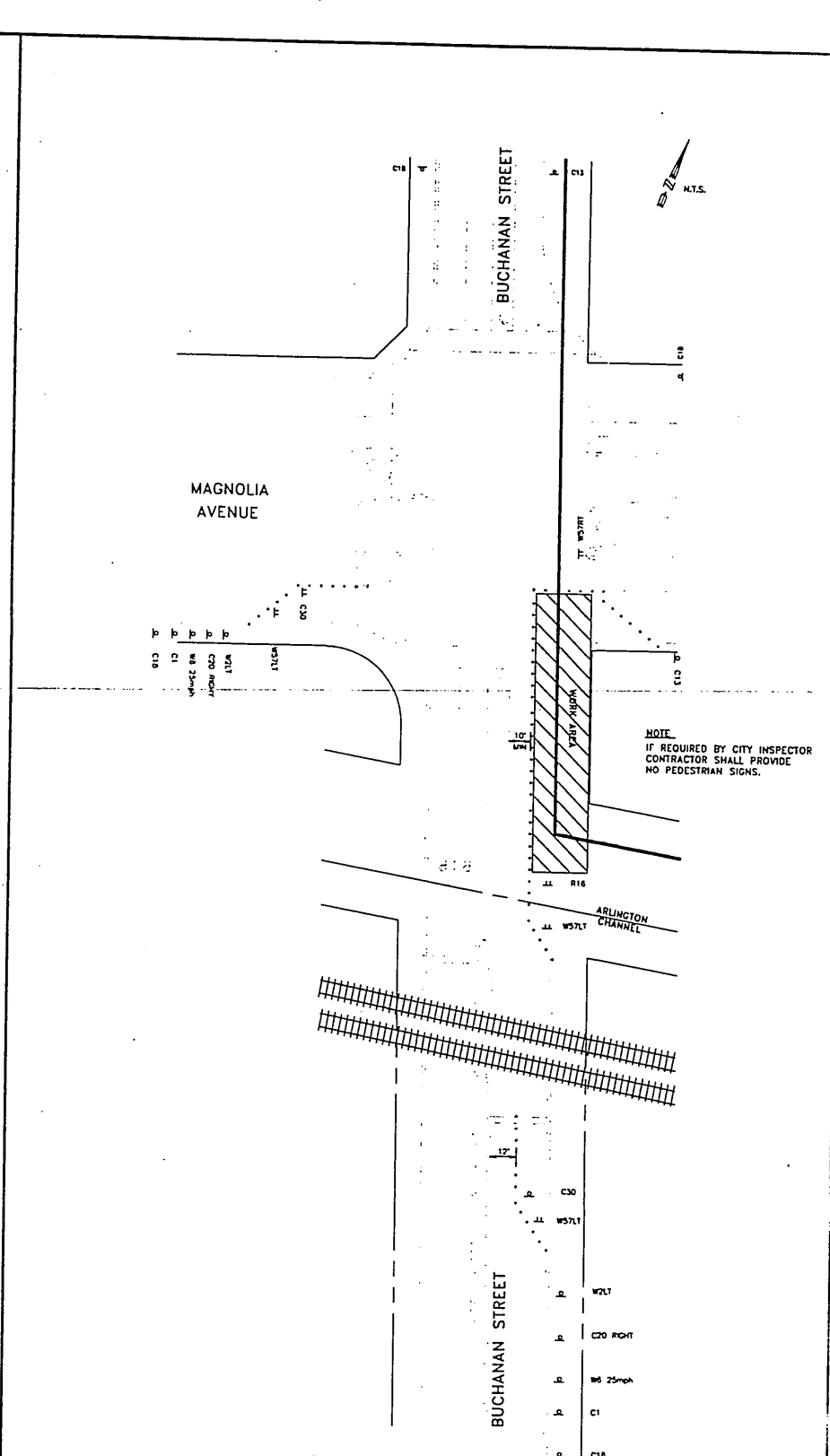
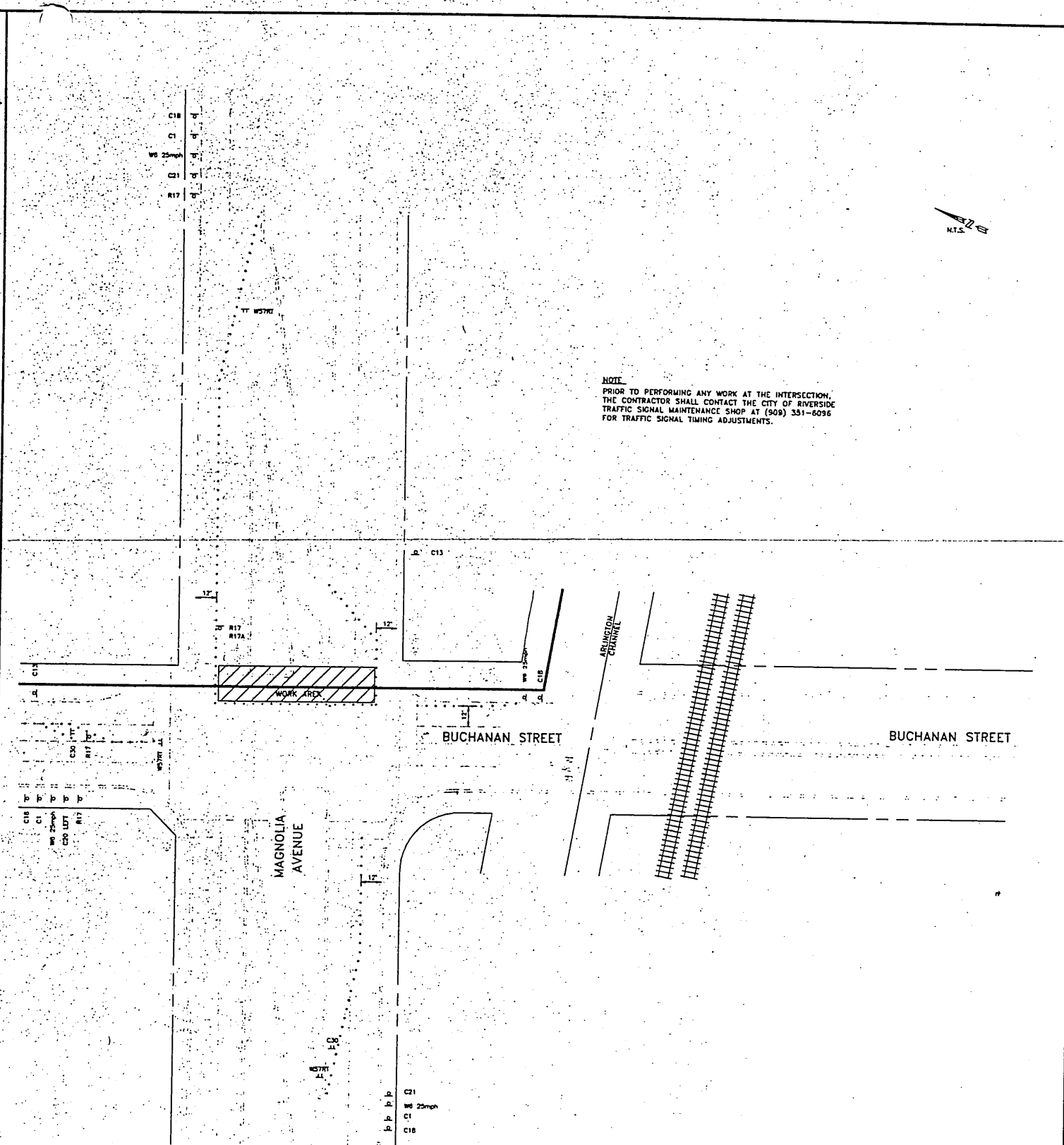
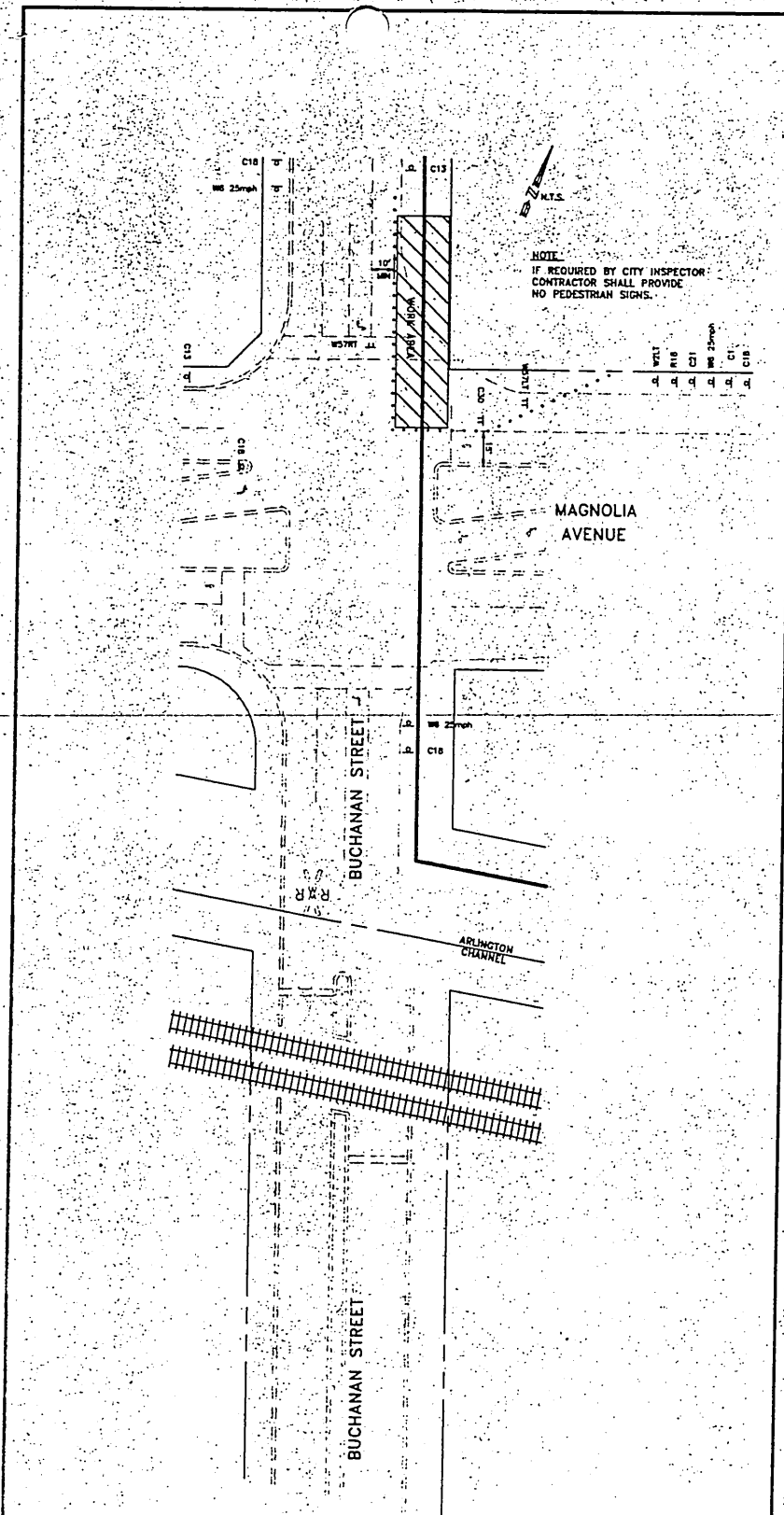

**INTERSECTION MAGNOLIA AVE (50 mph)  
and BUCHANAN STREET - PHASE I**

**INTERSECTION MAGNOLIA AVE (50 mph)  
and BUCHANAN STREET - PHASE II**

**INTERSECTION MAGNOLIA AVE (50 mph)  
and BUCHANAN STREET - PHASE III**

APPROVED BY:  
CITY OF RIVERSIDE  
PUBLIC WORKS DEPARTMENT  
*[Signature]*  
FRAN DUNAJSKI  
TRAFFIC ENGINEER

REFERENCE SHEET  
C-30

NO.	BY	CK	APP	DATE	REVISIONS AND RECORD OF ISSUE

**ALBERT A. WEBB ASSOCIATES**  
ENGINEERING CONSULTANTS  
3788 McCRAY STREET (909) 686-1070 RIVERSIDE, CA

DESIGNED: W.T.M.  
DETAILED: R.L.P.  
CHECKED: M.E.W.  
APPROVED: L.S.E.  
DATE: 6/96



REFERENCE SHEET  
C-30  
PROJECT NO.  
96-142  
SCALE:  
AS NOTED

**WESTERN RIVERSIDE COUNTY  
REGIONAL WASTEWATER SYSTEM  
SOUTH REGIONAL COLLECTION SYSTEM**  
**NONRECLAIMABLE WASTEWATER SEWER  
TRAFFIC CONTROL PLANS**

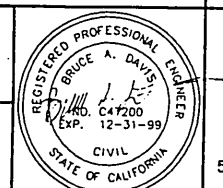
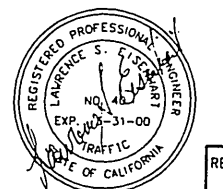

REFERENCE SHEET  
C-30  
**TC-8**  
SHEET  
54 OF 55

96-0142/CONTRACT/5HT-B