

ENCROACHMENT PERMIT
(to be completed by applicant)

TEXACO REFINING & MARKETING INC., the Owner Lessee of the property located at 3494 CENTRAL AVE in the City of Riverside, Assessors Parcel No. 225-263-016 hereby requests permission to CONSTRUCT AND MAINTAIN ONE FUEL STATION CANOPY, LANDSCAPE PLANTERS AND A PRIVATE ADVERTISING SIGN

in the public right of way of CENTRAL & RIVERSIDE AVE S. or the _____ easement at the _____ rear/_____ side/_____ front of said property. The attached drawing shows the requested encroachment. Upon issuance of this permit, I agree to comply with the attached terms and conditions.

Date _____ D.C. Watkins

D.C. Watkins, For Texaco Refining and Marketing Inc.

.....
ENCROACHMENT PERMIT APPROVAL
(to be completed by City)

This permit shall become effective upon the approval of the Departments listed below. Issuance of this permit shall not be construed as a waiver of any other applicable permit or requirement, but is only revocable permission to use the land for the purpose described.

- Public Utilities Water B. Simpson 3/26/97
- Public Utilities Electric Bill Ammerter 3.26.97
- Planning David Rivera
- Parks and Recreation De [Signature] 4/8/97
- _____ (other) _____
- _____ (other) _____

Upon obtaining the above signatures, return this permit to the Public Works Department for final approval.

Date 4/10/97 [Signature]
Public Works Director

Encroachment Permit No. 1393

TERMS AND CONDITIONS

The following indicated terms and conditions apply to encroachment permit no. 1393.

1. Permittee acknowledges that the area of encroachment is owned or controlled by the City of Riverside.
2. Permittee acknowledges that the described property could be needed for a proposed or planned public improvement and the City may revoke this permit. Upon written notice of revocation, the permittee shall, within the time prescribed by the City, remove all improvements placed, constructed or maintained. If the permittee fails to abide by the removal order of the City, the City shall have the right to remove and destroy the improvements without reimbursement to the permittee. The cost of such removal shall be paid by the permittee to the City and shall constitute a debt owed to the City.
3. Permittee waives the right of claim, loss, damage or action against the City resulting from revocation, termination, removal of improvements or any action of the City, its officers, agents or employees taken in accordance with the terms herein.
4. If the City Council of the City of Riverside finds that the permittee is in default of the terms of this permit, that shall be cause for revocation.
5. Permittee herewith agrees to hold the City of Riverside harmless from and against all claims demands, costs, losses, damages, injuries, actions for damages and/or injuries, and liability in connection with the construction, encroachment, and/or maintenance to be done by permittee within the described property.
6. Prior to any construction taking place on City controlled property, permittee shall obtain a Construction Permit or Street Opening Permit from the City Public Works Department.
7. The permittee agrees to insure that construction of their improvements will not interfere in any way with existing City or utility facilities. The existing facilities will require future maintenance, reconstruction and revisions and facilities may be added, any of which may result in removal or alteration of the permittee's improvements without

reimbursement to the permittee. Prior to construction, Permittee shall contact Underground Service Alert to field locate existing utility lines. Any conflicts discovered will void the permit until acceptable revisions are made.

8. Other _____

DECKERS

PROPOSED ENCROACHMENT

3498 CENTRAL AVENUE

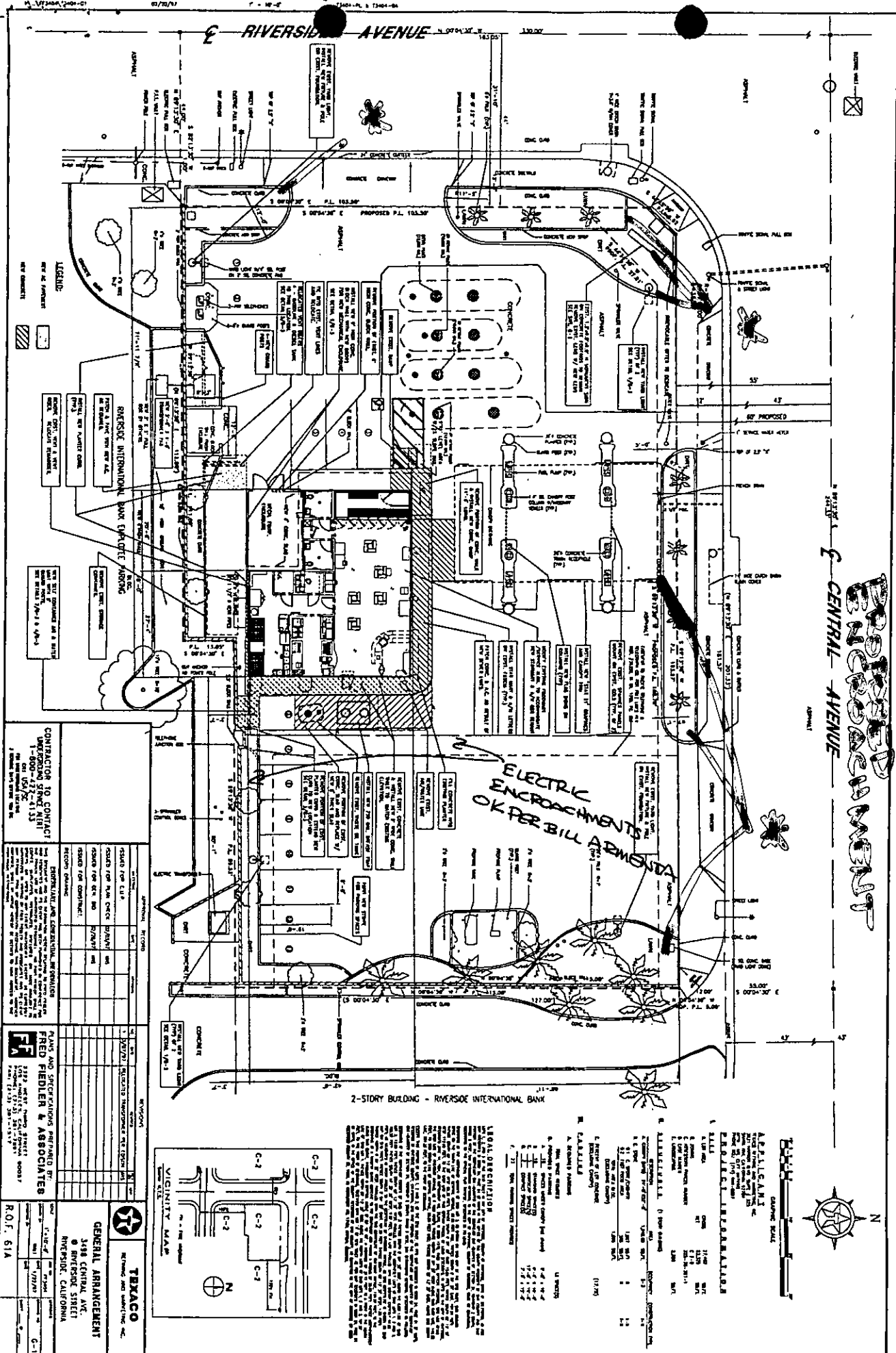

ELECTRIC ENCROACHMENTS OK PER BILL AB 680

2-STORY BUILDING - RIVERSIDE INTERNATIONAL BANK

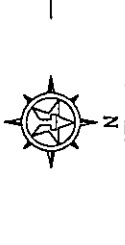

APPLICANT: DECKERS

PROJECT: PROPOSED ENCROACHMENT

ADDRESS: 3498 CENTRAL AVENUE, RIVERSIDE, CALIFORNIA

DATE: 11/11/77

SCALE: 1/4" = 1'-0"

PROJECT NO.: 111-11-11

REVISIONS:

NO.	DESCRIPTION	DATE
1	ISSUED FOR PERMITS	11/11/77
2	REVISIONS TO PERMITS	11/11/77
3	REVISIONS TO PERMITS	11/11/77
4	REVISIONS TO PERMITS	11/11/77
5	REVISIONS TO PERMITS	11/11/77
6	REVISIONS TO PERMITS	11/11/77
7	REVISIONS TO PERMITS	11/11/77
8	REVISIONS TO PERMITS	11/11/77
9	REVISIONS TO PERMITS	11/11/77
10	REVISIONS TO PERMITS	11/11/77

LEGAL DESCRIPTION:

LOT 1, TRACT 1, RIVERSIDE INTERNATIONAL BANK, RIVERSIDE, CALIFORNIA

LEGAL NOTES:

1. THE ENCROACHMENT IS PROPOSED TO BE CONSTRUCTED ON THE UNIMPAVED PORTION OF THE LOT.

2. THE ENCROACHMENT SHALL BE CONSTRUCTED IN ACCORDANCE WITH THE CITY OF RIVERSIDE ORDINANCES.

3. THE ENCROACHMENT SHALL BE CONSTRUCTED WITHIN THE SPECIFIED SETBACKS.

4. THE ENCROACHMENT SHALL BE CONSTRUCTED WITHIN THE SPECIFIED HEIGHTS.

5. THE ENCROACHMENT SHALL BE CONSTRUCTED WITHIN THE SPECIFIED AREAS.

6. THE ENCROACHMENT SHALL BE CONSTRUCTED WITHIN THE SPECIFIED PERCENTAGES.

7. THE ENCROACHMENT SHALL BE CONSTRUCTED WITHIN THE SPECIFIED DISTANCES.

8. THE ENCROACHMENT SHALL BE CONSTRUCTED WITHIN THE SPECIFIED ANGLES.

9. THE ENCROACHMENT SHALL BE CONSTRUCTED WITHIN THE SPECIFIED CURVES.

10. THE ENCROACHMENT SHALL BE CONSTRUCTED WITHIN THE SPECIFIED TOLERANCES.

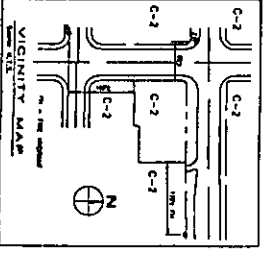

CONTRACTOR TO CONTACT: WINDSONG ARCHITECTS AND ENGINEERS, INC. 1-800-477-4133

RECORDING: RECORDING FEE \$150.00

PLANS AND SPECIFICATIONS PREPARED BY: FRED FIEDLER & ASSOCIATES, INC. 1549 1/2 WEST 15TH AVENUE, DENVER, COLORADO 80202

TEXACO

GENERAL ARRANGEMENT: 3498 CENTRAL AVENUE, RIVERSIDE, CALIFORNIA

ROF. 614