



ENCROACHMENT PERMIT
Storm Drain Connection
 City of Riverside - Public Works Dept.
 951-826-5341

Issuance of this permit shall not be construed as a waiver of any other applicable permit or requirement, and is only revocable permission to use the land for the purpose described.

Owner: A.H.D. Limited Partnership
Location: 2225 Orange Street, Riverside
A.P.N.: 209-092-005

Encroachment: Storm Drain Encroachment Permit. Attach Private Storm Drain to City Storm Drain

The above-described encroachment being shown on Exhibit A attached hereto.

Upon issuance of this permit, I agree to comply with the attached terms and conditions.

Date: 3-12-19

By: [Signature]

Date: _____

By: _____

Applicant
 A.H.D. Limited Partnership
 Ed Haddad
 422 Weir Road, Front Office
 San Bernardino, CA 92408

Contractor/Developer

ENCROACHMENT PERMIT APPROVAL

This permit has been reviewed and approved by the Departments listed below provided the attached terms and conditions are adhered to:

P/W ENGINEERING

FINAL APPROVAL

Date: 3/12/2019

[Signature]
 City Engineer

THIS PERMIT IS NOT VALID UNTIL ISSUED AND POSTED IN CITY RECORDS

Issued by: DBWML
DOUG WEBBER

Dated: 3/12/2019

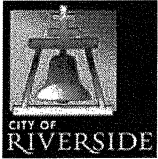

City of Riverside

1. The following are requirements that need to be met for your permit #PW19-0213.
2. Permittee acknowledges that the area of encroachment is owned or controlled by the City of Riverside.
3. Permittee acknowledges that the described property could be needed for a proposed or planned public improvement and the City may revoke this permit. Upon written notice of revocation, the permittee shall, within the time prescribed by the City, remove all improvements placed, constructed or maintained. If the permittee fails to abide by the removal order of the City, the City shall have the right to remove and destroy the improvements without reimbursement to the permittee. The cost of such removal shall be paid by the permittee to the City and shall constitute a debt owed to the City.
4. Permittee waives the right of claim, loss, damage or action against the City resulting from revocation, termination, removal of improvements or any action of the City, its officers, agents or employees taken in accordance with the terms herein.
5. If the Public Works Director of the City of Riverside finds that the permittee is in default of the terms of this permit, that shall be cause for revocation.
6. Permittee herewith agrees to hold the City of Riverside harmless from and against all claims demands, costs, losses, damages, injuries, actions for damages and/or injuries, and liability in connection with the construction, encroachment, and/or maintenance to be done by permittee within the described property.
7. Prior to any construction taking place on City controlled property, permittee shall obtain a Construction Permit or Street Opening Permit from the City Public Works Department.
8. The permittee agrees to insure that construction of their improvements will not interfere in any way with any existing City or utility facilities.
9. Permittee acknowledges that existing city or utility facilities will require future maintenance, reconstruction, and revisions and that facilities may be added, any of which may result in removal or alteration of the permittee's improvements without reimbursement to the permittee.
10. Prior to construction, permittee shall contact Underground Service Alert to field locate existing utility lines. Any conflicts discovered will void the permit until acceptable revisions are made. It shall be Permittee's responsibility to determine the location and required clearances from all public and private utility, sewer and drainage facilities prior to drilling and shall only drill in compliance with such clearance requirements.
11. Permittee is required to obtain all necessary permits and approvals from all City Departments and/or Agencies, City or otherwise, prior to constructing the improvements specified in this Encroachment Permit and to comply with all codes, laws, ordinances and regulations.

12. All on-site catch basins and inlets must have a properly installed and maintained drainage water filtration system to Public Works Specifications.
13. Permittee acknowledges that there are existing public works and public utility facilities that may interfere with the proposed improvement. All existing utilities, sewers and storm drains must be field located (pot-holed) prior to installation of the proposed facilities.
14. Permittee acknowledges that all maintenance of the drain line between its connection with the line in the street and the right of way line is the responsibility of the permittee.

Initial EIH

SR-60 FREEWAY EB ON-RAMP

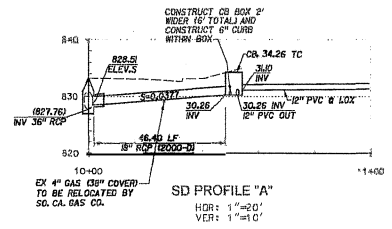

- CONSTRUCTION NOTES**
- 1) CONSTRUCT 6" THICK PCC PAVEMENT OVER COMPACTED NATIVE SOIL WITH #4 REBAR AT 18" O.C. (PER SOILS REPORT)
 - 2) CONSTRUCT 6" PCC CURB & GUTTER PER CITY STD NO. 200 TYPE 1
 - 3) CONSTRUCT 6" PCC CURB ONLY PER CITY STD NO. 200 TYPE 11
 - 4) CONSTRUCT PCC SIDEWALK PER CITY STD NO. 325
 - 5) CONSTRUCT TRASH ENCLOSURE PER ARCHITECT'S PLANS
 - 6) CONSTRUCT DRIVE APPROACH PER CITY STD NO. 302
 - 7) CONSTRUCT 3-FOOT WIDE PCC CROSS GUTTER PER CITY STD NO. 220
 - 8) CONSTRUCT RETAINING WALL PER DETAILS ON STRUCTURAL PLANS
 - 9) DECORATIVE PCC PAVING PER ARCHITECT'S PLANS
 - 10) CONSTRUCT PCC CURB RAMP, CASE D TYPE 1 PER APMA STD 111-4 (SEE SHEET 5)
 - 11) INSTALL RIP-RAP ROCK PROTECTION
 - 12) INSTALL 12" PVC DRAIN PIPE (HOLE ALT.)
 - 13) CONSTRUCT CATCH BASIN WITH FILTER INSERTS (AS FLEXSTONE PURE PERMANENT INLET PROTECTION, SEE DETAILS SHEET 7), PER CITY STD NO. 405 (W PER PLAN)
 - 14) CONSTRUCT 12" SG DRAINAGE INLET (JENSEN 011212), SEE SHEET 5)
 - 15) CONSTRUCT SD MANHOLE PER CITY STD NO. 430
 - 16) INSTALL 18" RCP (D-LOAD 2000)
 - 17) INSTALL PERVIOUS PAVERS PER DETAIL ON SHEET 3
 - 18) INSTALL 12" PERFORATED PIPE IN INFILTRATION TRENCH
 - 19) CONSTRUCT PCC CURB RAMP, CASE B TYPE 1 PER APMA STD 111-6 (SEE SHEET 5)
 - 20) CONSTRUCT INFILTRATION TRENCH PER DETAIL ON SHEET 6

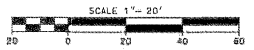
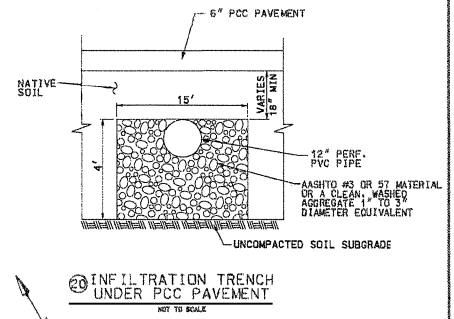

MAIN STREET

ORANGE ST

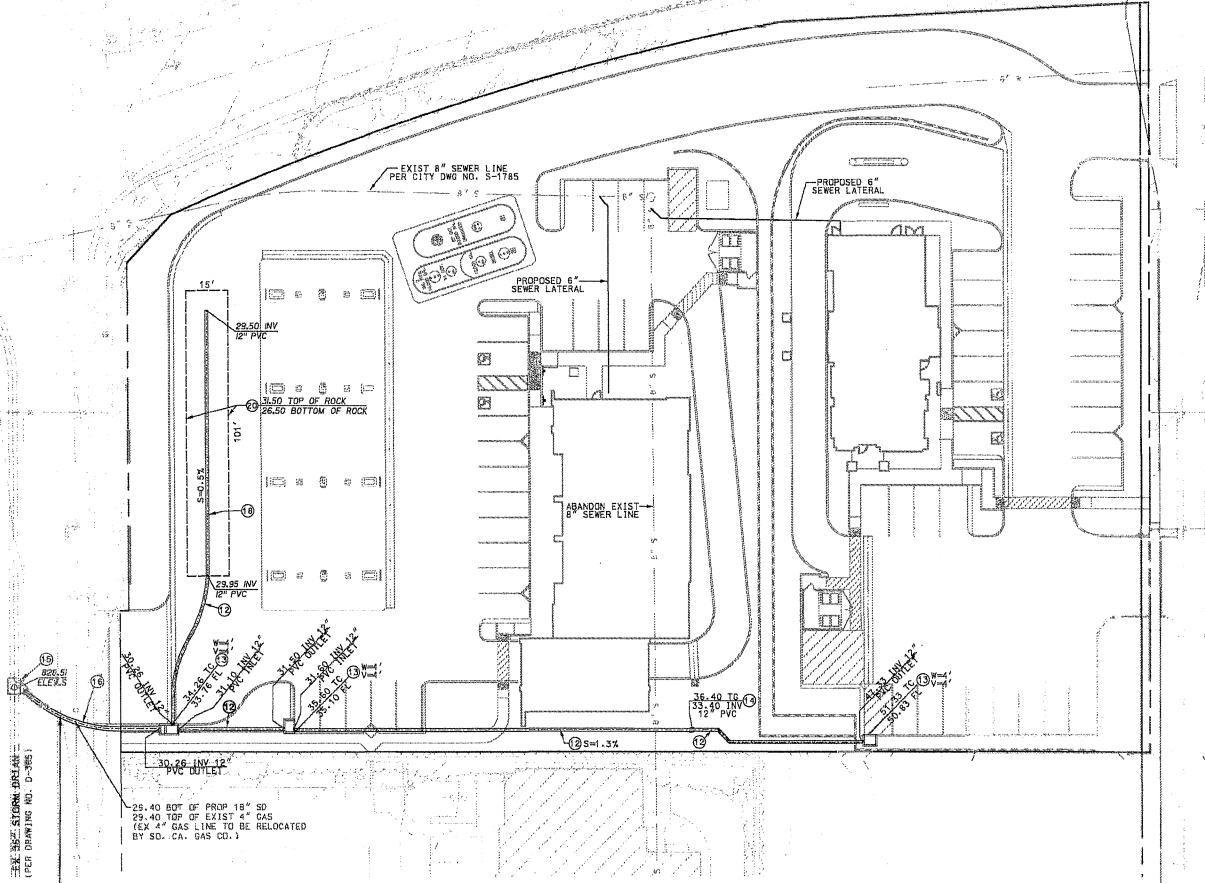

18" RCP FOR OVERFLOW ONLY. SEE PROFILE 'A' THIS SHEET

SEE ENCROACHMENT PERMIT FOR PRIVATE STORM DRAIN CONNECTION TO PUBLIC STORM DRAIN SYSTEM

E19_0213.4

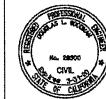
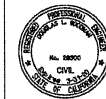
 Call: TOLL FREE 1-800-221-2600	 2079 SKY VIEW DRIVE COLTON, CA 92324 (909) 924-2775	11/8/2018 DATE	PLANNING DIVISION	CITY OF RIVERSIDE PRECISE GRADING PLAN PRIVATE STORM DRAIN PLAN MAIN PLAZA DEVELOPMENT 2222 MAIN STREET, RIVERSIDE, CA 92501	SHEET <h2 style="font-size: 2em;">6</h2> OF 10 SHEETS
 DOUGLAS L. GOODMAN RCE 28500, 3-31-2020	DESIGNED BY DRAWN BY CHECKED BY APPROVED BY	REVISIONS APP. DATE	DATE 11/28/18	DATE	DATE

