

ENCROACHMENT PERMIT

Pursuant to Resolution No. 11065 of the City of Riverside, permission is hereby granted to Richard L. Ashe and  
Yvonne W. Ashe  
2844 Kathleen Street  
Riverside, CA 92506

                     heirs and assigns, hereinafter referred to as "Permittee" to use and occupy the following described property; the southwesterly 10 feet of Lot 37 being 10' Public Utilities Easement of Tract No. 2564, per Map Book 47, Page 74, records of Riverside County.

in accordance with the terms hereof.

1. Permittee shall use and occupy the described property only in the manner and for the purposes as follows: For construction and maintenance of a swimming pool encroaching 3 feet into said existing 10 foot Public Utilities Easement, as shown by Exhibit "A" attached hereto and made a part of this document.

1A. The Public Utilities Department shall not be held responsible for the nuisance caused by birds on overhead wires, if any.

2. Permittee, by acceptance of the benefits hereunder, acknowledges title to the property to be in the City of Riverside and waives any right to contest the validity of the dedication or grant.

3. Permittee acknowledges that the described property is the site of a proposed or planned public improvement and that, accordingly, all rights and privileges of use permitted shall cease and expire upon notice of revocation by the City. Upon the expiration or revocation, Permittee shall, within the time prescribed by the City, remove all improvements or obstructions placed, constructed or maintained by the Permittee. If the Permittee fails to abide by the removal order of the City within the time prescribed, the City shall have the right to remove and destroy the improvements without reimbursement to the Permittee and the cost of such removal shall be paid by the Permittee to the City of Riverside and shall constitute a debt owed to the City of Riverside.

4. Permittee, by acceptance hereof, waives the right of claim, loss, damage or action against the City of Riverside arising out of or resulting from revocation, termination, removal of the improvements or any action of the City of Riverside, its officers, agents or employees taken in accordance with the terms hereof.

5. Finding and determination by the City Council of the City of Riverside that the Permittee, or his heirs and assigns or successors in interest, are in default of the terms hereunder shall be cause for revocation.

6. Permittee herewith agrees to hold the City of Riverside harmless from and against all claims, demands, costs, losses, damages, injuries, action for damages and/or injuries, and liability growing or arising out of or in connection with the construction, encroachment, and/or maintenance to be done by Permittee or his agents, employees or contractors within the described property.

DATED: March 21, 1977

CITY OF RIVERSIDE, a municipal corporation

By [Signature] Mayor

Attest Alice A. Hase City Clerk

The foregoing is accepted by:

Richard L. Ashe Jr.  
(Signature(s) of Permittee)  
[Signature]  
\_\_\_\_\_  
\_\_\_\_\_  
\_\_\_\_\_

APPROVED AS TO CONTENT  
[Signature] 3/8/77  
Department Head

APPROVED AS TO FORM  
[Signature]  
City Attorney

CITY MANAGER APPROVAL  
[Signature]  
City Manager

MR RICHARD ASHE  
BUYER/OWNER'S

ASHE

2844 KATHLEEN  
ADDRESS

Rivercity  
CITY

684-9854  
RES. PHONE

3-1-77  
CONTRACT DATE

MAP 800-5411

LEGAL DESCRIPTION - LOT

TRACT

JOB PHONE

Owner and Contractor acknowledge that they are responsible for the following:

Contractor Owner

Fence Removal by	
Fence Replacement by	
Tree Removal by	
Tree Hauling by	
Decking by	
Mastic by	
Expansion Joints by	
Gas Line & Valves by	
Heater Location by	
Electric Meter by	
Bonding by	
Pl. Tar & Grout by	

SALESMAN MUST INDICATE LOCATION ON THIS SCALE DRAWING OF ALL ITEMS LISTED BELOW AND THE FOLLOWING MUST BE ACKNOWLEDGED BY OWNER'S INITIALS.

Shape of Pool	
Length of Pool	
Depth of Pool	
Filter Location	
Board Location	
Light Location	
Ladder Location	
Diving Board Location	
Slide Location	
Heater Location	
Decking Location	
Coping Location	
Summer Location	
Step Location	
Shape of Steps	
Width - Maximum	
Width - Minimum	
Length - Maximum	
Length - Minimum	
Depth - Maximum	
Depth - Minimum	
Truck Load Point	

LOCATE THE FOLLOWING ON DRAWING:

Pool Shape & Dimensions	
Cross Section Dimensions	
Access Dimensions	
Tops & Tops of Slopes	
Retaining Walls	
Truck Load Point	
Covered Patio	
Electric Box	
Gas Meter	
Hose Bib	
Distance Pool from House & Prop. Lines	
Overhead Utility Lines	
Public Utility Enclosures	
Existing Structure or Proposed Structure on Prop	

ACCESS DAMAGE OR UNDERGROUND OBSTRUCTIONS:

CONTRACTOR cannot assume responsibility for damage to curbs, sidewalks, driveways, concrete slabs, sewers, walls, trees, fences, retaining walls, enclosures, telephone lines, electric, gas lines or shrubs. When access is made through a neighbor's property it is understood that you, the contractor, have that neighbor's permission and assume full responsibility.

BUYER APPROVES PLAN AND SPECIFICATIONS AS OUTLINED HEREIN, AND HAS RECEIVED A COPY OF THIS PLAN.

Pool 17' x 40'  
3" TO 8' DEEP  
1/4 PER 680

REMOVE CEMENT + HAUL

TILE VS 808

WHITE COPING

SMBWP #036 CHO 1HP

FILL LINE

2 RETURNS

500 WT LIGHT

ARNESON POOL SWEEP

CLEANING TOOLS

CONDITIONER

LOVE SEAT

ELECT

GAS

1360 DECK ROCKS AHT  
WHT CAP, MASTIC

McCollum Pools

2419 HAMNER

NORCO 91760

688-6884

CITY LIC # 003189

STATE LIC # 286140 CSS

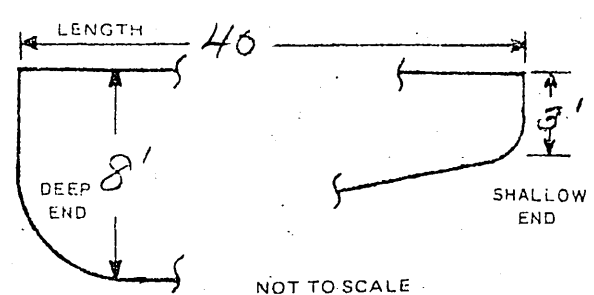
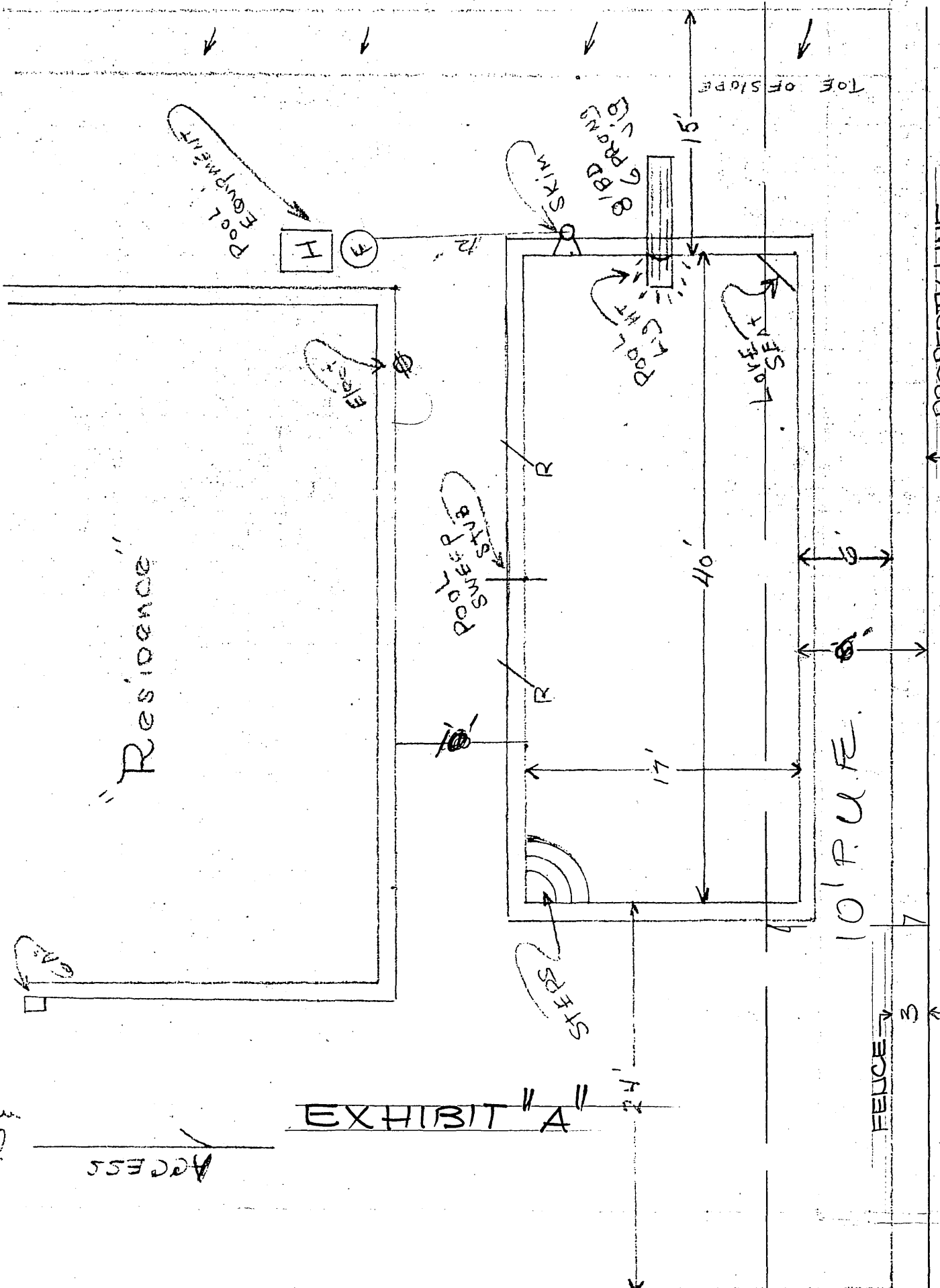

3-1-77

Thank You  
See you all

ACCESS

EXHIBIT "A"

- P PLUMB
- F FILTER
- H HEATER
- G GAS METER
- M METER
- S SKIMMER
- L LADDER
- L LIGHT