

ENCROACHMENT PERMIT

Pursuant to Resolution No. 11065 of the City of Riverside, permission is hereby granted to THE RIVERSIDE POLICE OFFICERS ASSOCIATION

its heirs and assigns, hereinafter referred to as "Permittee" to use and occupy the following described property.

That portion of Eleventh Street, a public right of way adjacent to the northeasterly line of Block 11, Range 5 of the Town of Riverside, as shown by map on file in Book 7 of Maps at Page 17 thereof, records of San Bernardino County California,

in accordance with the terms hereof.

1. Permittee shall use and occupy the described property only in the manner and for the purposes as follows:

To construct and maintain a police memorial encroaching into said public right of way a maximum of 33.00 feet as shown by Exhibit "A" attached and made a part hereof by this reference.

2. Permittee, by acceptance of the benefits hereunder, acknowledges title to the property to be in the City of Riverside and waives any right to contest the validity of the dedication or grant.

3. Permittee acknowledges that the described property is the site of a proposed or planned public improvement and that, accordingly, all rights and privileges of use permitted shall cease and expire upon notice of revocation by the City. Upon the expiration or revocation, Permittee shall, within the time prescribed by the City, remove all improvements or obstructions placed, constructed or maintained by the Permittee. If the Permittee fails to abide by the removal order of the City within the time prescribed, the City shall have the right to remove and destroy the improvements without reimbursement to the Permittee and the cost of such removal shall be paid by the Permittee to the City of Riverside and shall constitute a debt owed to the City of Riverside.

4. Permittee, by acceptance hereof, waives the right of claim, loss, damage or action against the City of Riverside arising out of or resulting from revocation, termination, removal of the improvements or any action of the City of Riverside, its officers, agents or employees taken in accordance with the terms hereof.

5. Finding and determination by the City Council of the City of Riverside that the Permittee, or his heirs and assigns or successors in interest, are in default of the terms hereunder shall be cause for revocation.

6. Permittee herewith agrees to hold the City of Riverside harmless from and against all claims, demands, costs, losses, damages, injuries, action for damages and/or injuries, and liability growing or arising out of or in connection with the construction, encroachment, and/or maintenance to be done by Permittee or his agents, employees or contractors within the described property.

DATED: MAR 15 1983

CITY OF RIVERSIDE, a municipal corporation

By Ronald Lovelace Mayor
Pro Tempore
Attest Alicia A. Hare City Clerk

The foregoing is accepted by:

X Fred H. ... (Signature(s) of Permittee)
Chairman

APPROVED AS TO CONTENT

[Signature]
Department Head

[Signature]
Department Head

APPROVED AS TO FORM

John Woodhead
City Attorney

For [Signature]
Department Head

CITY MANAGER APPROVAL

for Robert E. Fenwick
City Manager

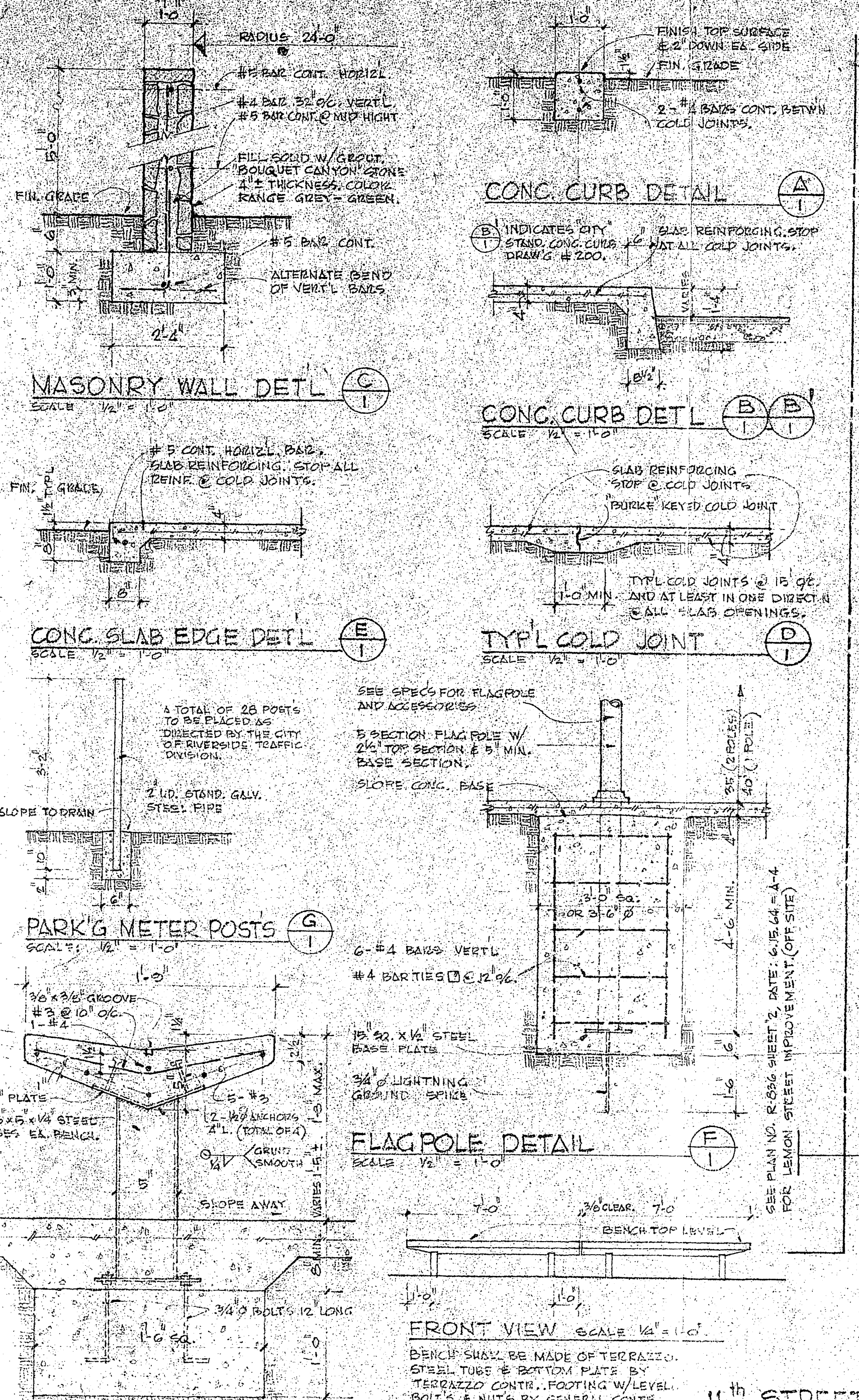

GENERAL NOTES

- OFF SITE WORK IS ALL WORK SHOWN ON DRAWINGS SHEETS A-3, A-4, A-5 & P-3 AND AS INDICATED IN THE SPECIFICATIONS.
- ON SITE WORK IS ALL WORK SHOWN ON DRAWINGS SHEETS A-1, A-2, P-1, P-2, P-4, E-1 & E-2 AND AS INDICATED IN THE SPECIFICATIONS.
- REMOVE EXIST. CONC. CURB & GUTTER, CONC. SIDEWALK, ASPHALT PAVING, WATER METERS, SPRINKLER SYSTEM, PARKING METERS & METER POSTS AND ALL UNSUITABLE MATERIAL FROM SITE. SEE SPECIFICATIONS FOR EXECUTION AND OR SALVAGE ETC.
- REMOVE EXIST. TREES (B CLASS 'C' & 4 CLASS 'B') AS INDICATED IN THE SPECIFICATION. (ON SITE)
- ALL CONC. PAVING SHOWN SHALL BE REINFORCED W/ 6"x6" #10 B.W. EXCEPT FOR WORK SHOWN ON OFF SITE DRAWINGS OR WHERE SPECIFICALLY MENTIONED. STOP SLAB REINFORC. AT ALL COLD JOINTS.
- EXIST. MAIL HOLE (SERVIC) TO BE ABANDONED. REMOVE COVER. FILL MH. W/GRADE. SEE SPECIFICATIONS.
- PROVIDE B'X HOLE IN CONC. SLAB FOR TELEPHONE BOOTH (TELEPH. BOOTH N.I.C.) SEE ELECTRICAL DRAW'G SHEET E-1 FOR SERVICE TO BE PROVIDED UNDER THIS CONTRACT.
- FLAG POLES: POLE NO. 1, SHALL HAVE AN EXPOSED HEIGHT OF 25'-0". THE TOP OF POLE NO. 2, SHALL BE 5'6" AT THE SAME TOP ELEVATION AS POLE NO. 1. HEIGHT OF POLE NO. 2, (CENTER) SHALL BE 5'-0" ABOVE POLES NO. 1 & 2.
- GRASSES SHOWN ON THIS SHEET (WHICH ARE IN CONFLICT WITH OFF SITE WORK) SHALL TAKE PRECEDENCE.
- CONTRACTOR TO COORDINATE IF POSSIBLE HIS WORK WITH THE POLICE BUILDING PROJECT.
- PROVIDE A TOTAL OF TEN (8) 1'-6" x 2'-6" x 4" THICK CONC. SLABS AROUND PARKING METER POSTS IN PLANTING AREA AS DIRECTED BY THE CITY OF RIVERSIDE TRAFFIC DIVISION.
- CONTRACTOR TO PROVIDE ACCESS TO THE COUNTY HEALTH & FINANCE BUILDING SOUTH SIDE 11th STREET DURING NORMAL BUSINESS HOURS.
- THE NOTE "ALL WORK INSIDE THIS AREA (N.I.C.)" DOES NOT RELIEVE CONTRACTOR FROM PERFORMING WORK SHOWN ON SHEETS A-2, P-1, P-4, E-1 & E-2 SUCH AS SPRINKLER SYSTEM, GRASSING, LANDSCAPE WORK & ELECTRICAL WORK AND AS INDICATED IN THE SPECIFICATION.

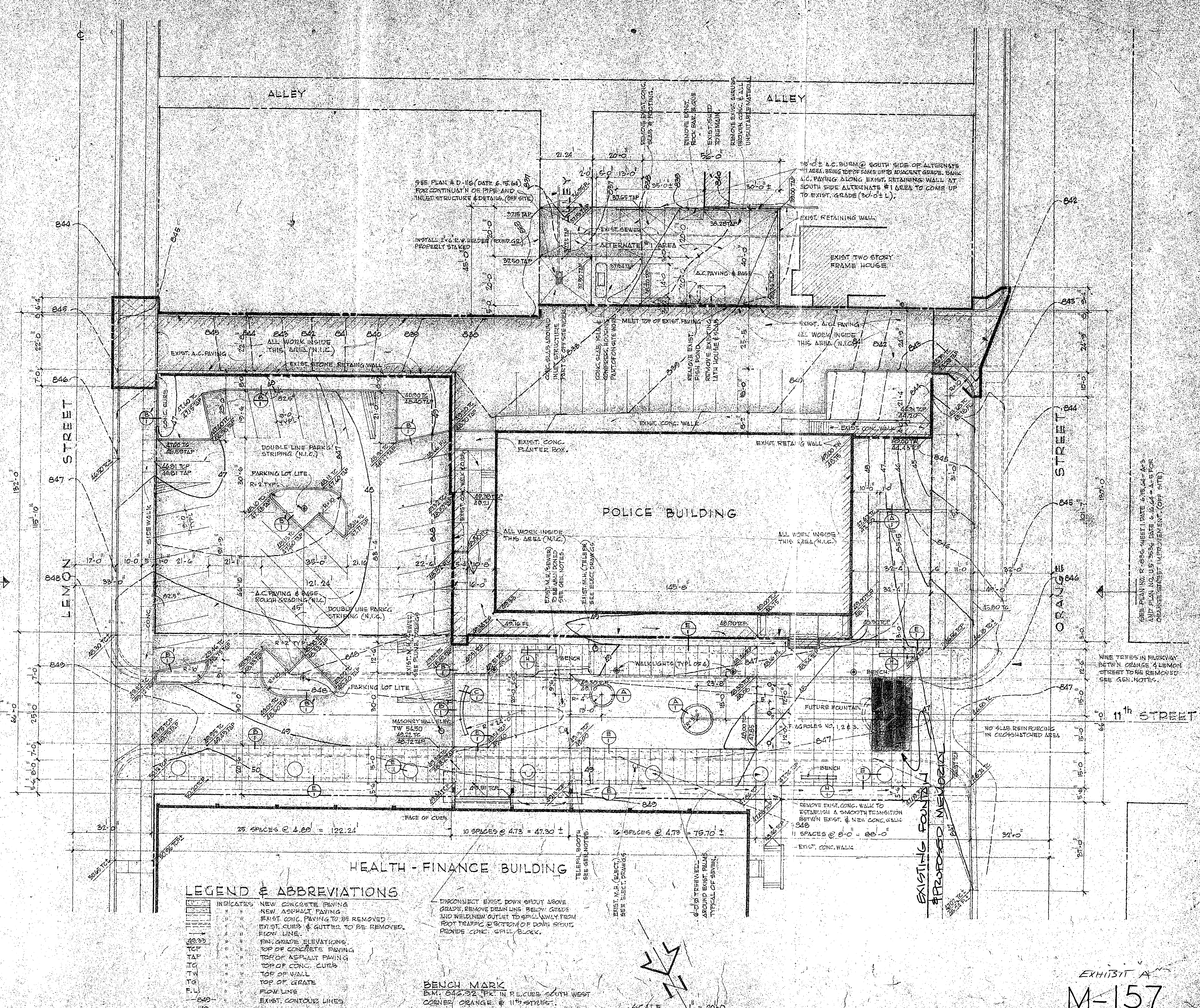

REVISIONS	DRAWN BY
	CHECKED BY
	DATE JULY 15, 64
COMMISSION NO. 5001-10	

CITY OF RIVERSIDE
RIVERSIDE

11th STREET MALL DEVELOPMENT
CALIFORNIA

RUHNAU · EVANS · BROWN & STEINMANN
architecture · engineering · planning

MISSION INN ROTUNDA, RIVERSIDE, CALIFORNIA

BRANDOW & JOHNSTON CONSULTING ENGINEERS

SITE PLAN & DETAILS

EXHIBIT A
M-157