

ENCROACHMENT PERMIT

Pursuant to Resolution No. 11065 of the City of Riverside, permission is hereby granted to Clare J. Taber  
1501 Seventh Street, Ste. "E"  
Riverside, CA 92507

his heirs and assigns, hereinafter referred to as "Permittee" to use and occupy the following described property. A portion of the Public Street right of way being the corner cutoff at the northwest corner of Seventh Street and Cranford Avenue

in accordance with the terms hereof.

1. Permittee shall use and occupy the described property only in the manner and for the purposes as follows: Construction and maintenance of a sign encroaching into the corner cut off completely, as shown on the attached Exhibit "A".

1a. Applicant shall obtain all other necessary approvals, including a sign permit and construction permit.

1b. This permit shall be valid for a period of 6 months, during which time the applicant shall apply for the vacation of the surplus area between the existing corner cutoff and the optional corner cut off shown in red on the attached Exhibit "A".

1c. Applicant shall contact the Public Utilities Department for the exact location of the Hi-Voltage U.G., shown on attached exhibit "A", prior to placement of sign in the Right of Way.

2. Permittee, by acceptance of the benefits hereunder, acknowledges title to the property to be in the City of Riverside and waives any right to contest the validity of the dedication or grant.

3. Permittee acknowledges that the described property is the site of a proposed or planned public improvement and that, accordingly, all rights and privileges of use permitted shall cease and expire upon notice of revocation by the City. Upon the expiration or revocation, Permittee shall, within the time prescribed by the City, remove all improvements or obstructions placed, constructed or maintained by the Permittee. If the Permittee fails to abide by the removal order of the City within the time prescribed, the City shall have the right to remove and destroy the improvements without reimbursement to the Permittee and the cost of such removal shall be paid by the Permittee to the City of Riverside and shall constitute a debt owed to the City of Riverside.

4. Permittee, by acceptance hereof, waives the right of claim, loss, damage or action against the City of Riverside arising out of or resulting from revocation, termination, removal of the improvements or any action of the City of Riverside, its officers, agents or employees taken in accordance with the terms hereof.

5. Finding and determination by the City Council of the City of Riverside that the Permittee, or his heirs and assigns or successors in interest, are in default of the terms hereunder shall be cause for revocation.

6. Permittee herewith agrees to hold the City of Riverside harmless from and against all claims, demands, costs, losses, damages, injuries, action for damages and/or injuries, and liability growing or arising out of or in connection with the construction, encroachment, and/or maintenance to be done by Permittee or his agents, employees or contractors within the described property.

DATED: Nov. 22, 1985

CITY OF RIVERSIDE, a municipal corporation

By [Signature] Mayor

Attest [Signature] City Clerk

The foregoing is accepted by:

[Signature]  
(Signature(s) of Permittee)

APPROVED AS TO CONTENT

[Signature]  
Department Head

Concurs With

[Signature]  
Planning Department

APPROVED AS TO FORM

[Signature]  
City Attorney

CITY MANAGER APPROVAL

[Signature]  
City Manager



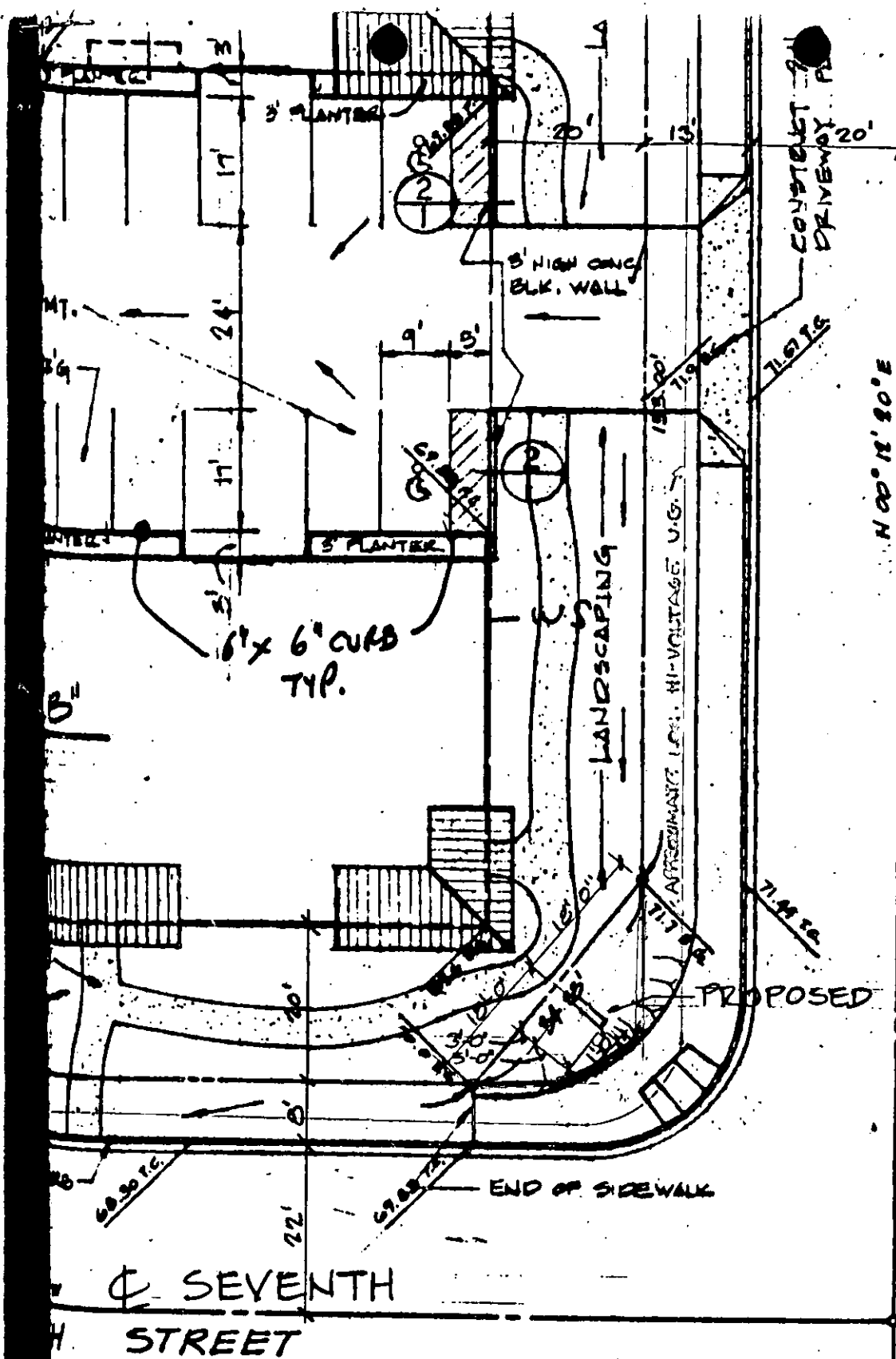

CRANFORD AVE.

SEVENTH STREET

REF: ROY G. PALMER ENG. INC.  
JOB # 0506 DATE 3/14/85



SCALE: 1" = 20'

EXHIBIT "A"  
Sht. 2 of 2

LOCATION OF PROPOSED  
BUILDING IDENTIFICATION  
SIGN: 150 SEVENTH ST.  
RIVERSIDE  
OWNER: CLARE J TABER  
1501 SEVENTH STE 'E'  
RIVERSIDE, CA. 92507  
714-683-8744

C-35161  
10-16-85  
58-00-85

Handwritten initials or signature.

12"

5'

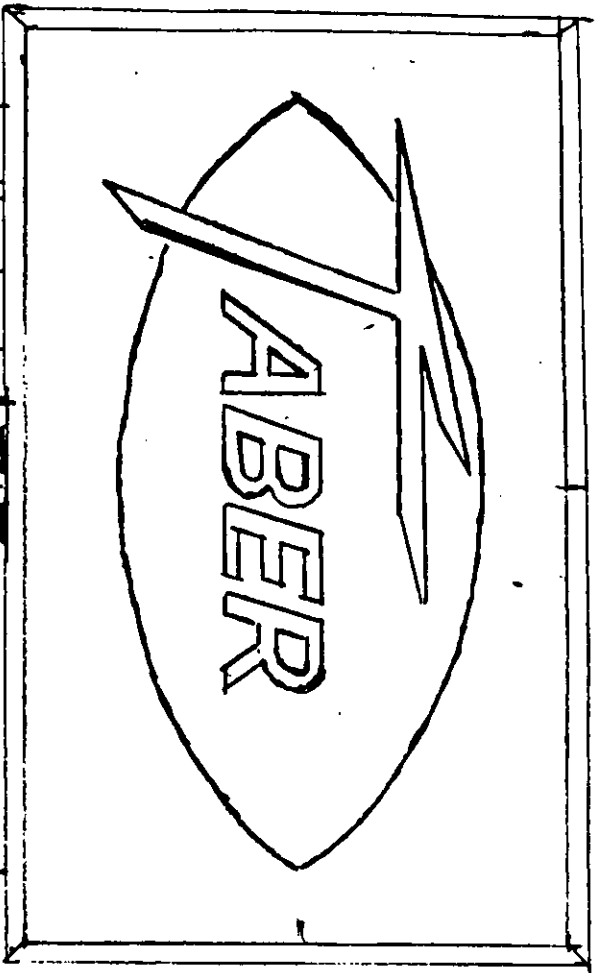
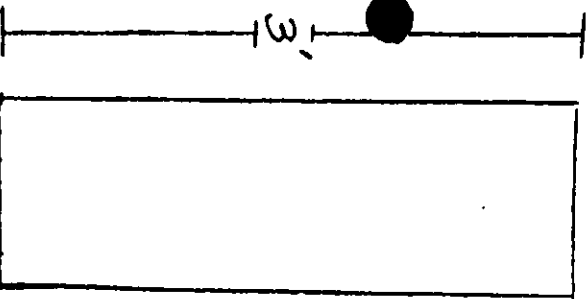

3'

12"

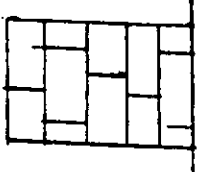

8"



7"

CITY OF

ABER

GRADE. 1 1/2"

110 VOLTS.  
1.9 AMPS.

3/16 PLEX

WHITE BACK G.  
GREEN # 2020

ALUMINUM  
EXTRUSION.  
CAN

1 FRANCE 368 BALLAST.  
3 60 TUBE C/LAMPS

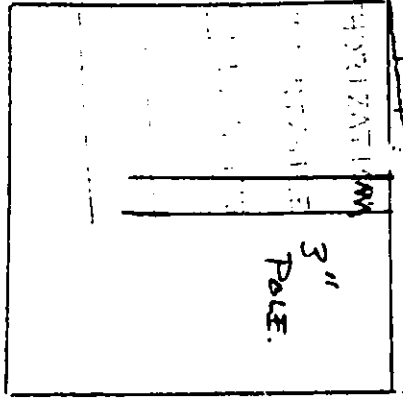

2'