

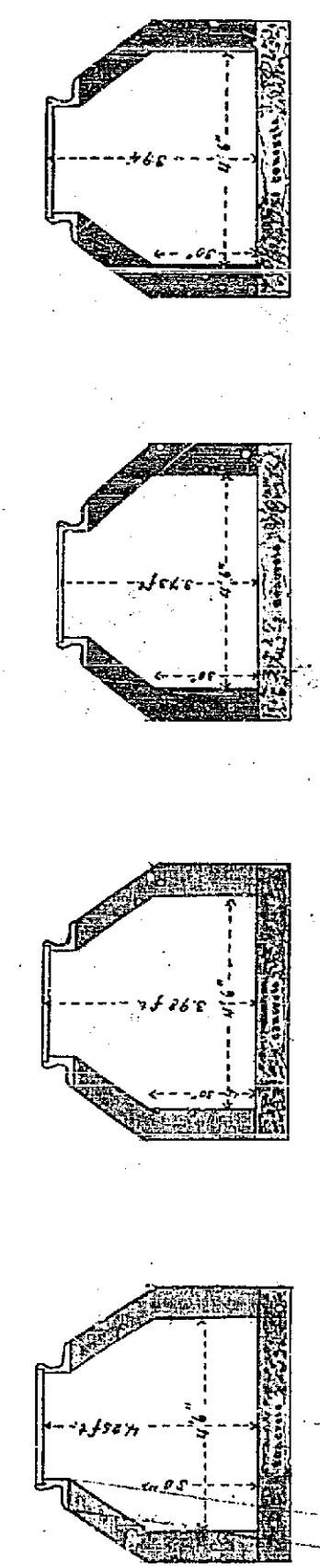

Surface El. 77.0
I-1 of M. H. ... El. 100.00
4/1/26

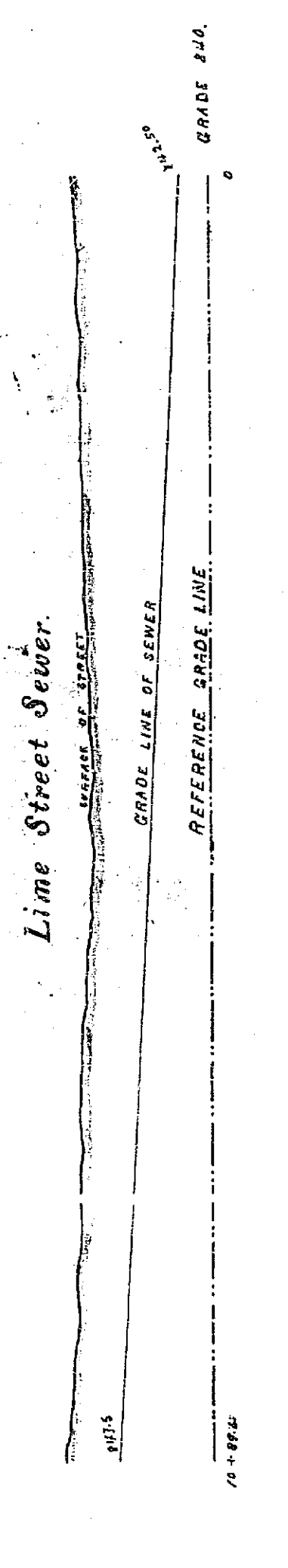
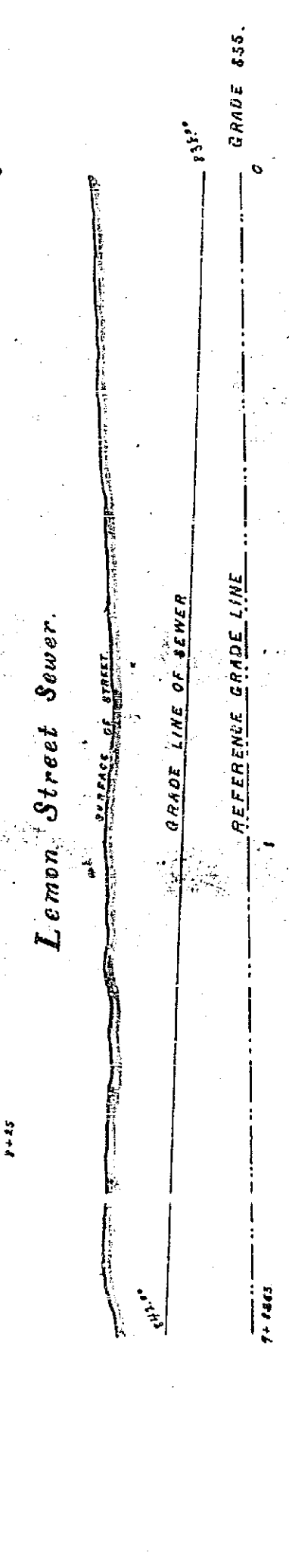
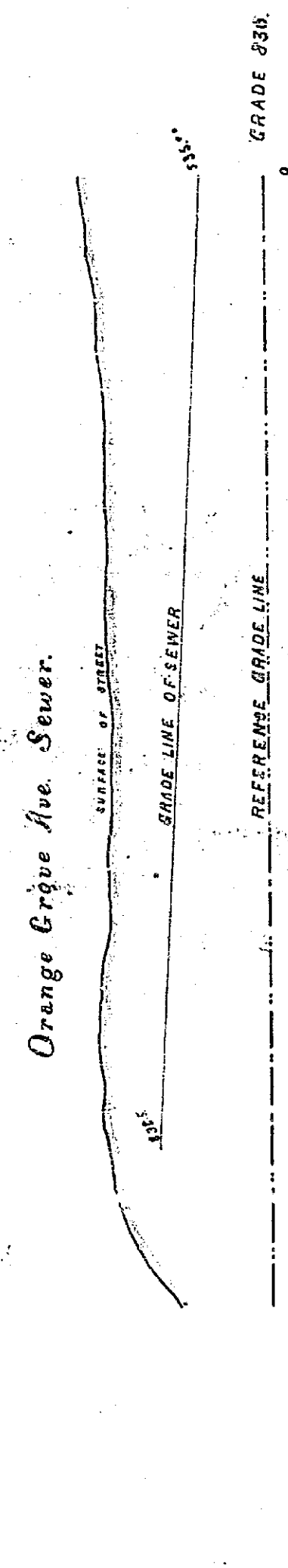
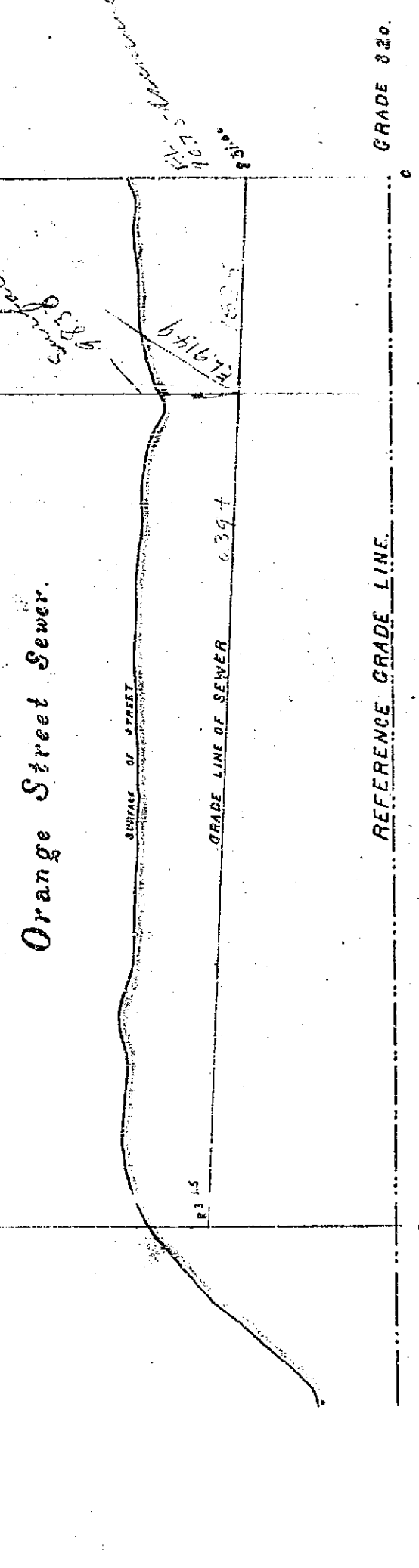

Orange St. Flush Tank
Orange Crève Ave. Flush Tank
Lemon St. Flush Tank
Lime St. Flush Tank
Map of Proposed Sewers
in Orange St., Orange Crève Ave., Lemon St. & Lime St.
showing Plans & Profiles

James Johnson
City Engineer

Adopted Unanimously
at a regular meeting
of the Board of Trustees
held June 9th, 1893
at Westchester
City Clerk