

149 148 147 146 145 144 143 142 141 140

# PLANS AND PROFILES OF THE PROPOSED STREET IMPROVEMENT OF MAGNOLIA AVENUE

BETWEEN JACKSON STREET AND FARNHAM PLACE

AND PORTIONS OF  
JACKSON STREET, DONALD STREET,  
EVEREST STREET AND MERICKEL ST.

ENGINEERING DEP'T. - CITY OF RIVERSIDE 193

PLANS PROFILES AND MAPS NUMBER  
CONSISTING OF 4 SHEETS

SHEET NUMBERED 1 STREET IMPROVEMENT OF MAGNOLIA AVENUE BETWEEN JACKSON STREET AND FARNHAM PLACE AND PORTIONS OF JACKSON STREET, DONALD STREET, EVEREST ST AND MERICKEL STREET.

SHEET NUMBERED 108 STANDARD DETAIL SHEET

SHEETS NUMBERED 219 220 MAP OF THE DISTRICT TO BE ASSESSED FOR THE IMPROVEMENTS

ELEVATIONS SHOWN HEREON ARE U.S.G.S. DATUM WHICH IS THE OFFICIAL RIVERSIDE CITY DATUM PLANE AS ESTABLISHED BY ORDINANCE NO. 551 NEW SERIES.

### FIELD BOOKS

- BOOK 232 PAGES 5 TO 7
- BOOK 239 PAGES 40 TO 58
- BOOK 240 PAGES 46 TO 79
- BOOK 241 PAGES 1 TO 15

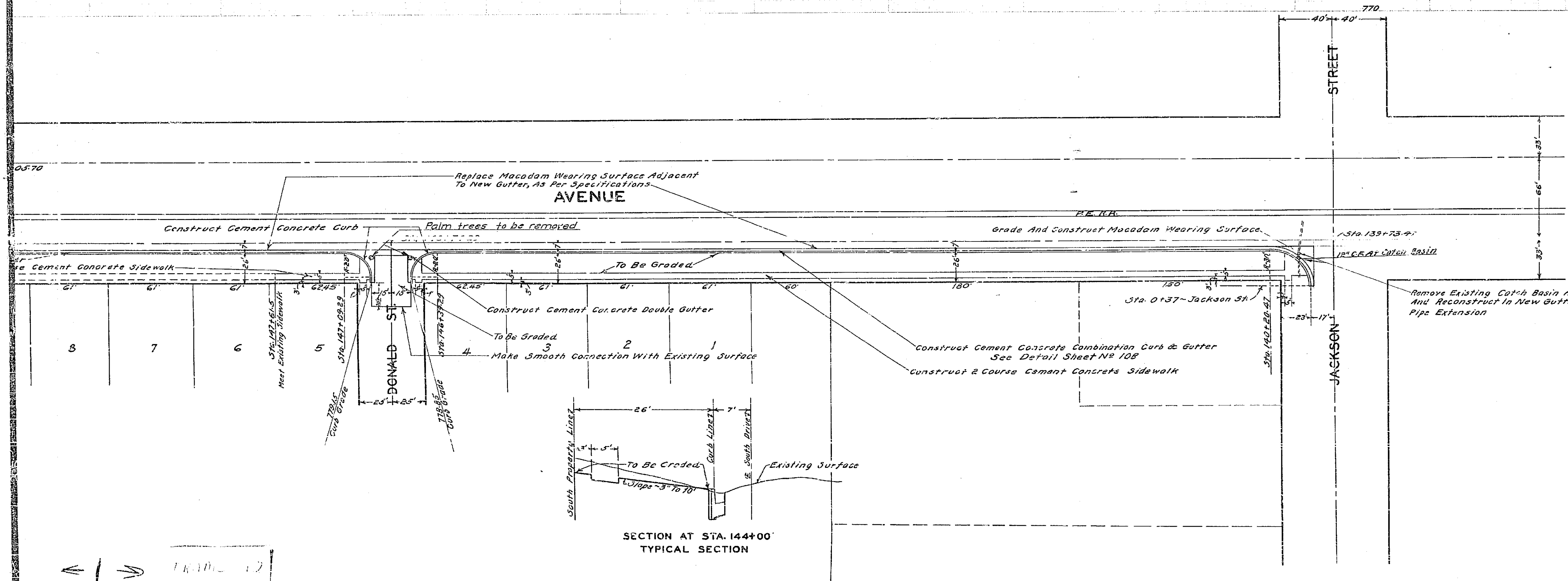
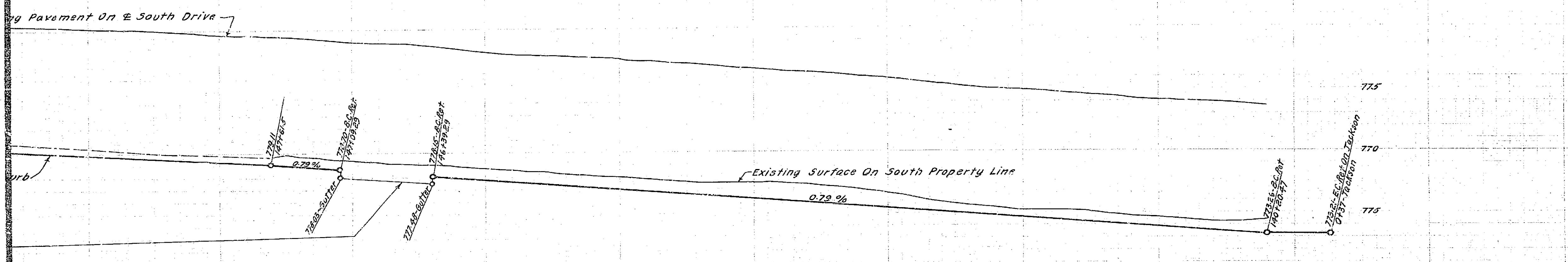

*Protected Cut*

ADOPTED BY THE MAYOR AND COUNCIL OF THE CITY OF RIVERSIDE  
THIS \_\_\_\_\_ DAY OF \_\_\_\_\_ 1931

CITY CLERK, CITY OF RIVERSIDE

1024

SHEET NO. 1

← | → 1024

161 160 159 158 157 156 155 154 153 152 151 150 149 148

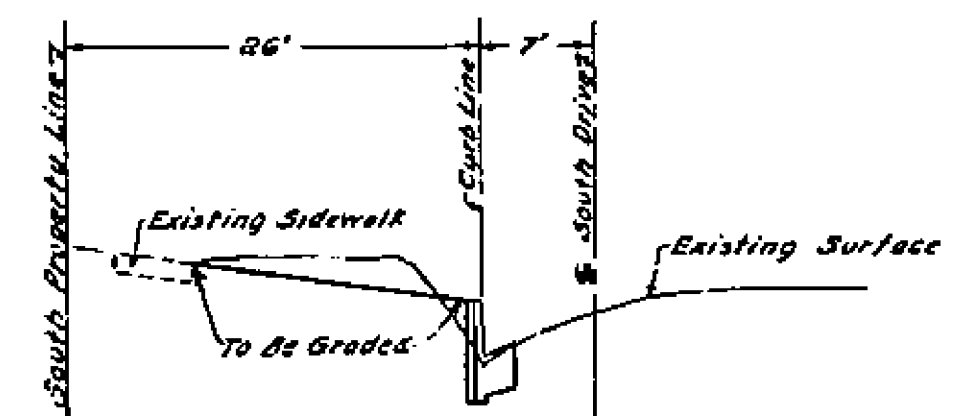
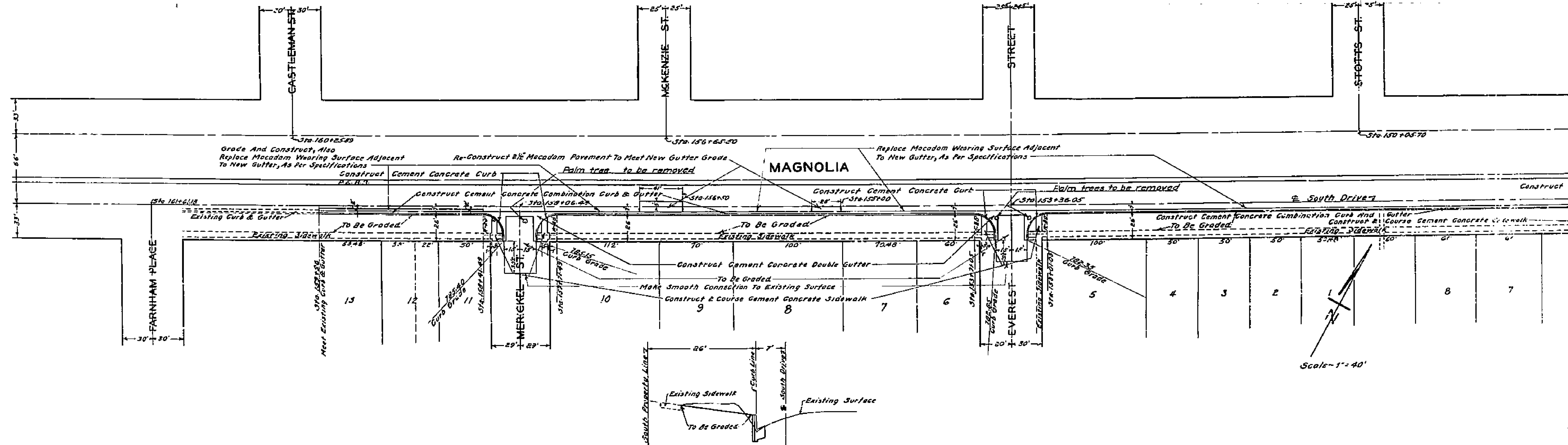
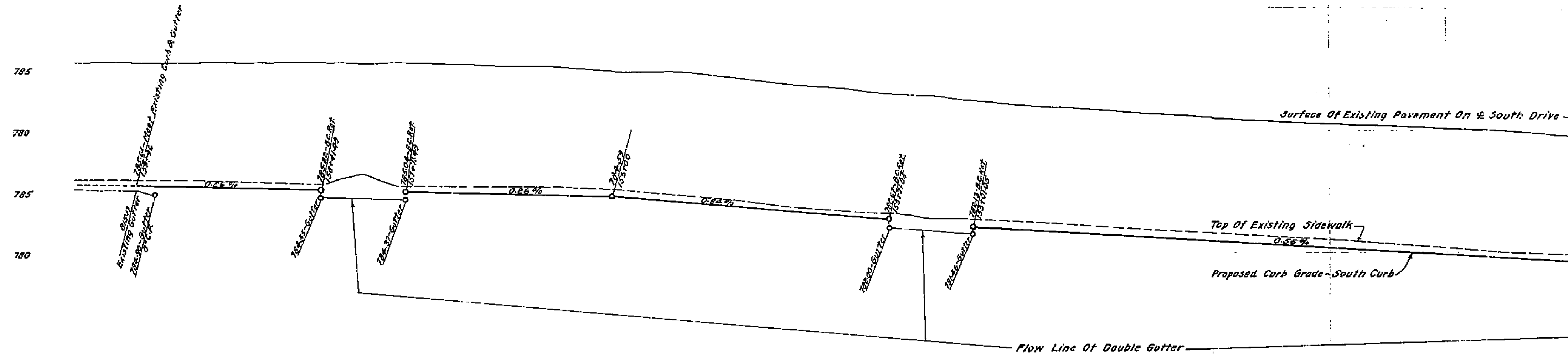

Scale - 1" = 40'