

Seventh St. Pachappa Ave. to Kansas Ave.			
Drawing Number	Sheet Number	Total Sheet	Field Book
1034	1	3	301
Drawn	Checked	Approved	

**PROFILE**  
SCALE: VER. 1"=4'  
HOR. 1"=40'

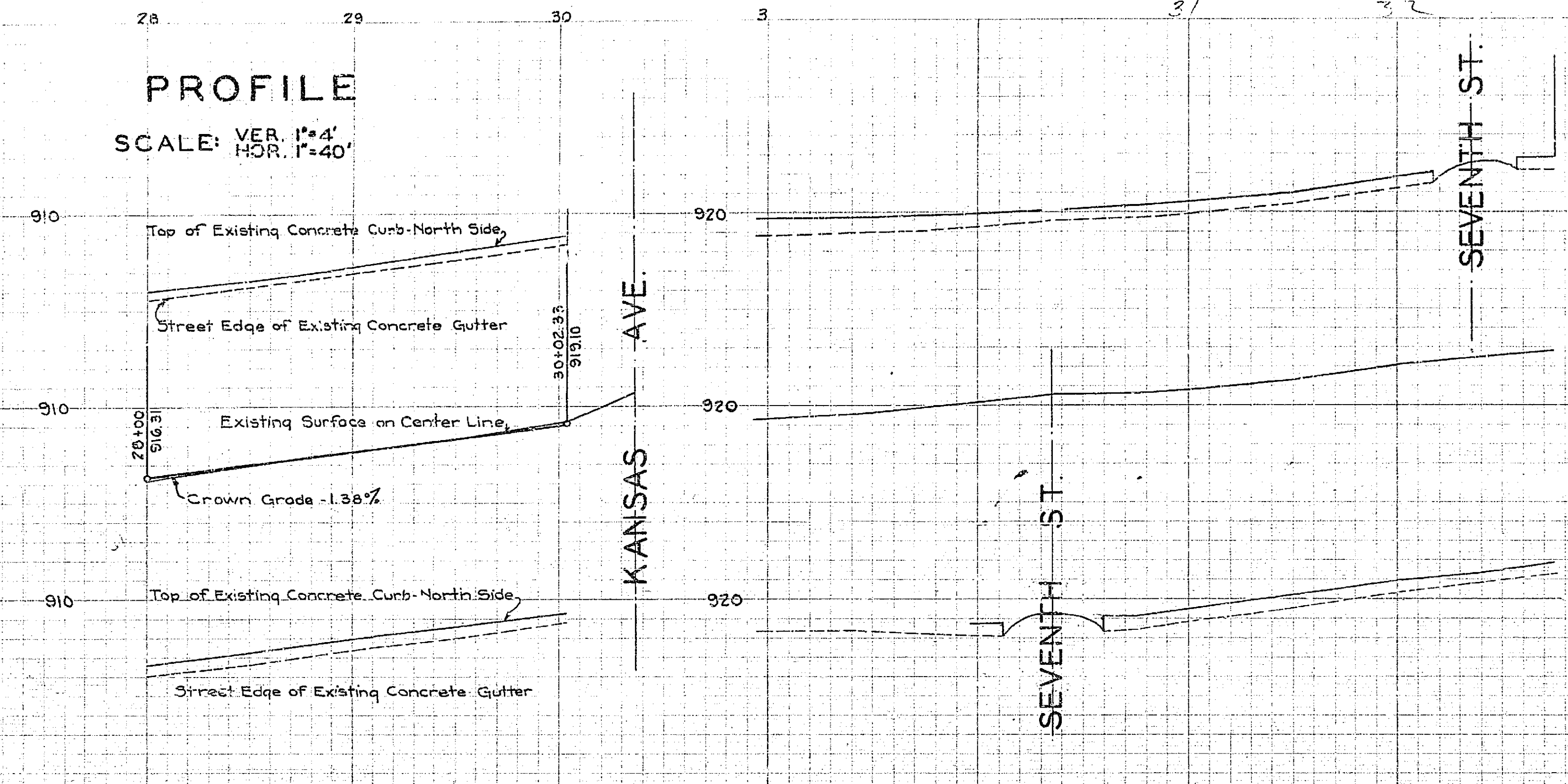

**PLAN**  
SCALE: 1"=40'

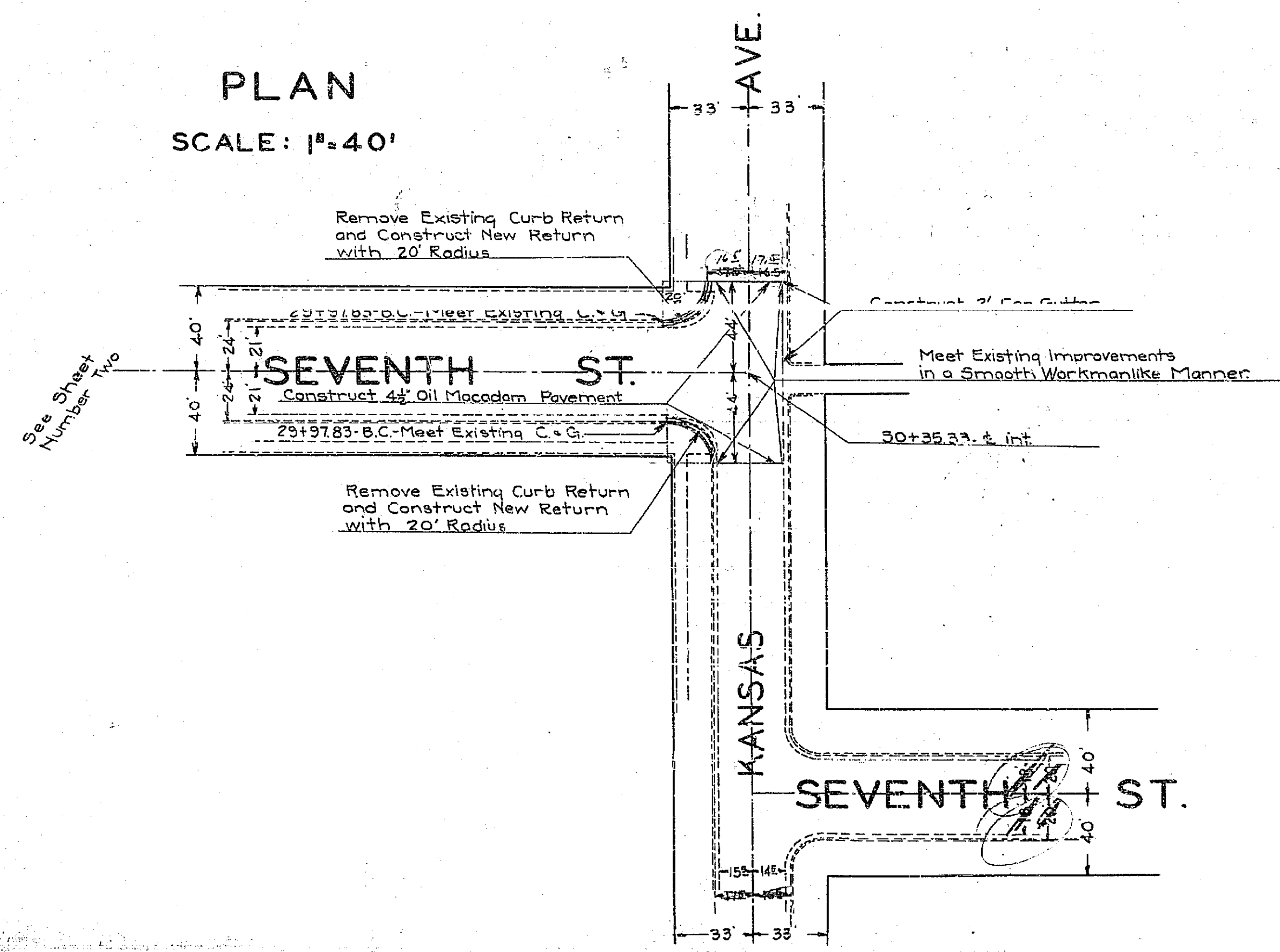

**PLAN AND PROFILE**  
OF THE PROPOSED STREET IMPROVEMENT OF  
**SEVENTH STREET**  
FROM  
**PACHAPPA AVENUE**  
TO  
**KANSAS AVENUE**  
BEING A  
STREET OF MAJOR IMPORTANCE  
ENGINEERING DEPT. CITY OF RIVERSIDE 1939  
APPROVED: *Lee Mahajan*  
CITY ENGINEER

APPROVED AND ADOPTED BY THE MAYOR AND CITY COUNCIL  
OF THE CITY OF RIVERSIDE THIS 11 DAY OF JULY 1939.  
*[Signature]*  
CITY CLERK

1034

Seventh St. Pachappa Ave. to Kansas Ave.			
Drawing Number	Sheet Number	Total Sheets	Field Book
1034	2	3	361
Drawn	Checked	Approved	

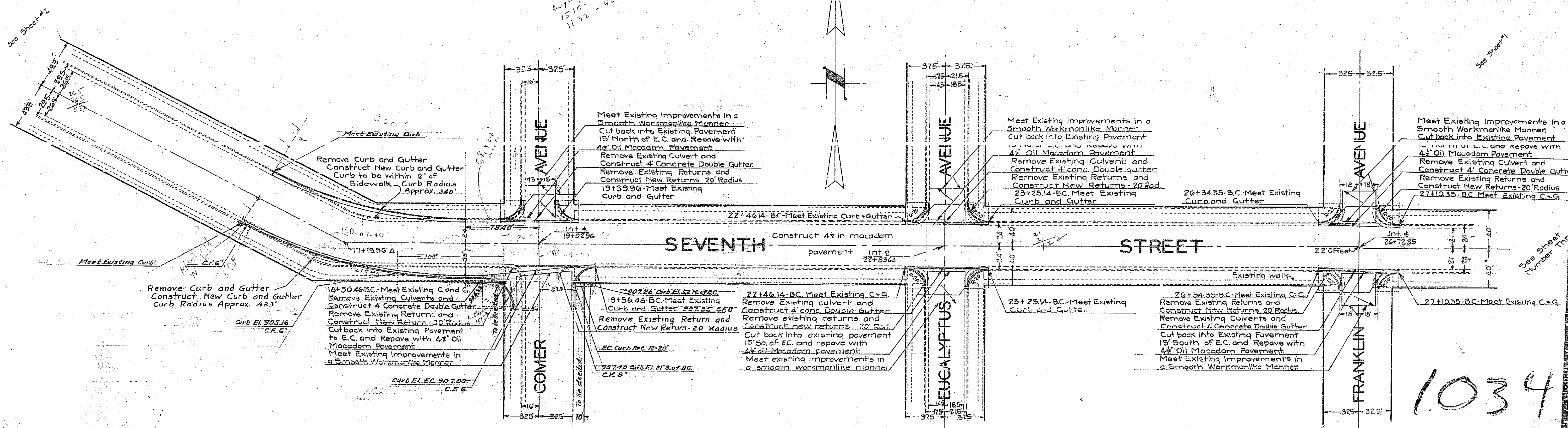
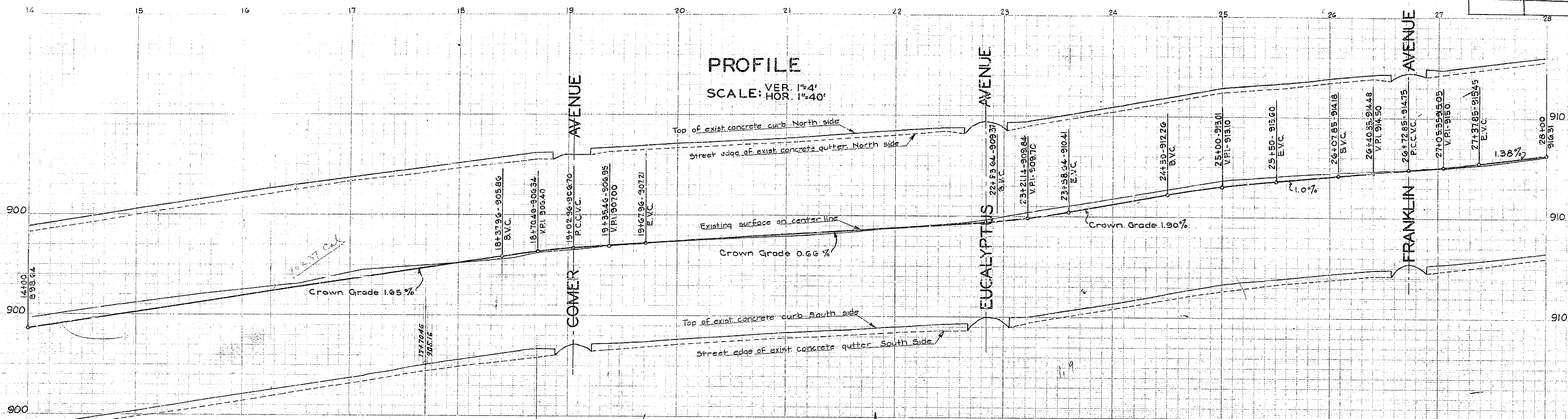

1034

Seventh St. Pachappa Ave. to Kansas Ave.			
Drawing Number	Sheet Number	Total Sheets	Field Books
1034	3	301	
Drawn	Checked	Approved	
Arthur N. Riley			
July 11, 1939			

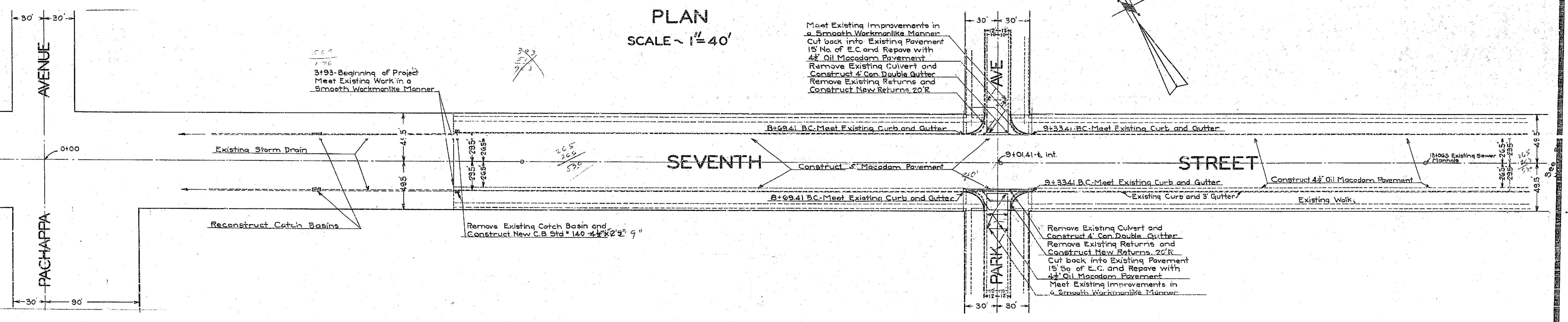
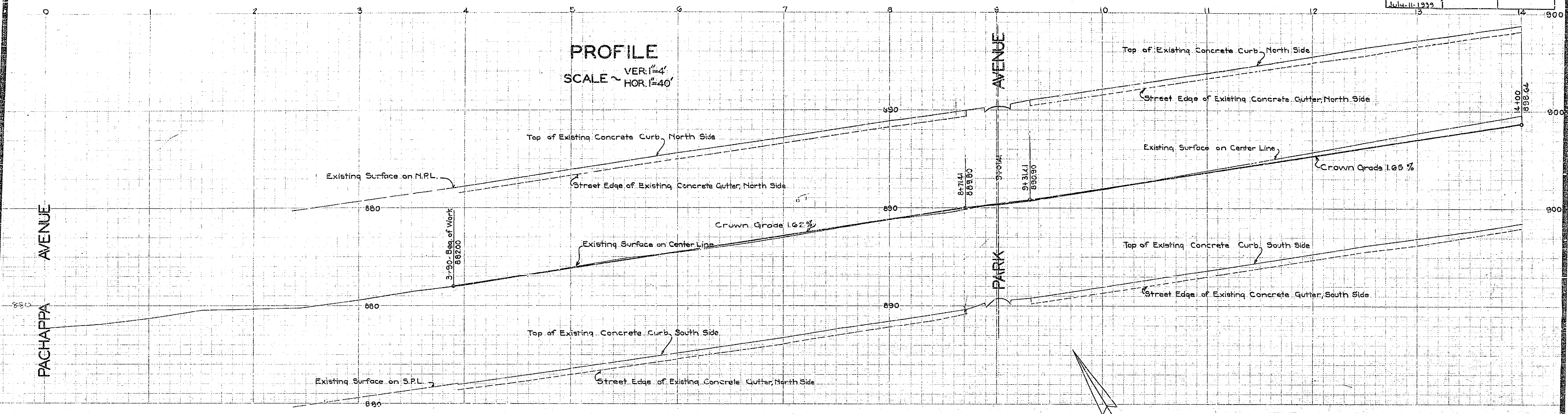

1034

301