

PLAN No. 104-D
 FOR PAVING ALLEY
 IN BL'K 4, R. 6
 RIVERSIDE, CALIFORNIA
 Oct. 1954

APPROVED: M.H. IRVINE - Reg. C.E. #3011
 CITY ENGINEER

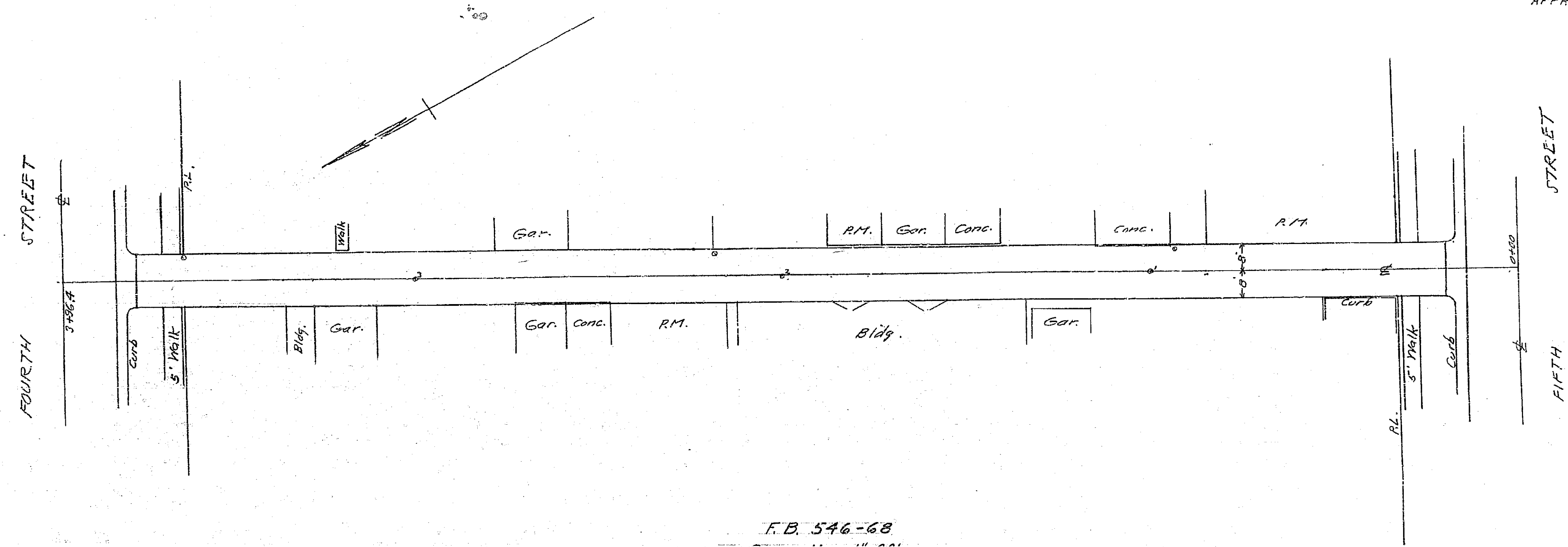

F.B. 546-68
 SCALE: HOR. 1"=20'
 VERT. 1"=4'

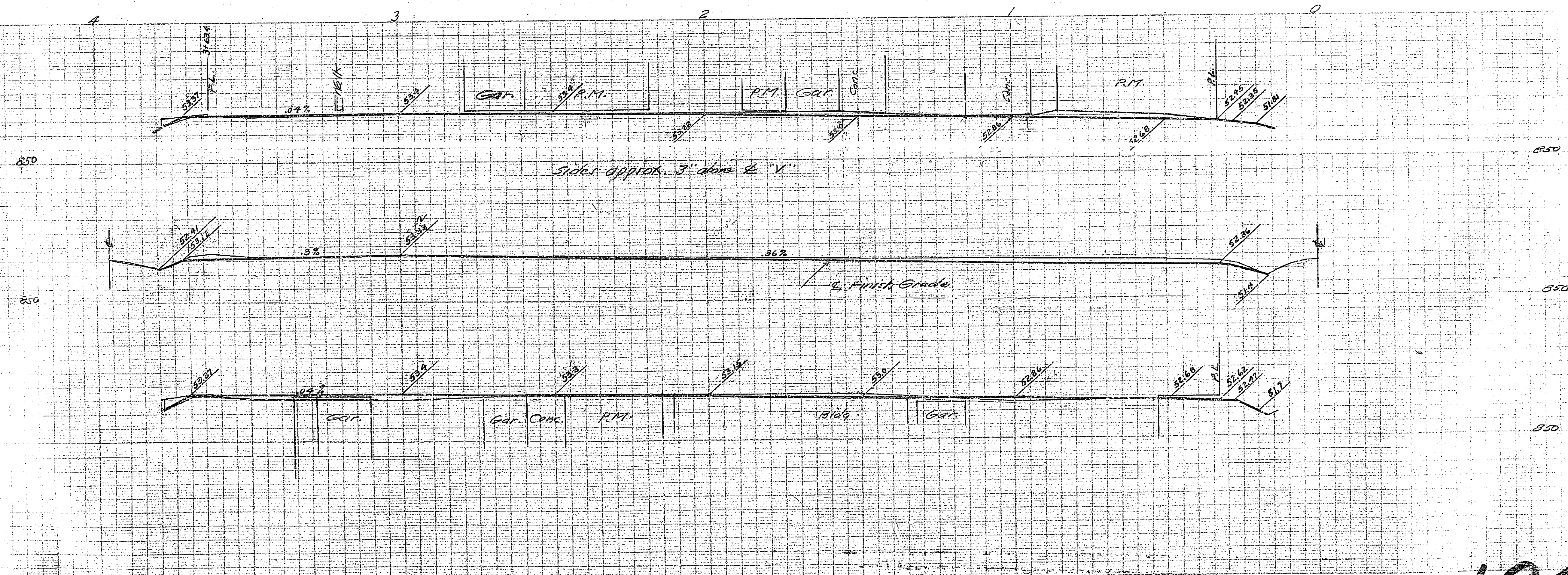

MADE IN U.S.A.
 CLEARING LAYER CO.
 CLEARING, PROFILE FROM PLATE A

104-D