

PROPERTY OF
CITY OF RIVERSIDE
CITY ENGINEERING DEPT.

PROPERTY OF
CITY OF RIVERSIDE
CITY ENGINEERING DEPT.

PLAN AND PROFILE
NO. 1076-B
FOR THE CONSTRUCTION OF
CURBS AND GUTTERS
ON ORANGE STREET
AT THE ELLIOTTA TRACT

SCALES HORIZ. 1" = 40 FT.
VERT. 1" = 4 FT.
R.B. 474-68

APPROVED: *M.H. Irvine*
M.H. IRVINE
CITY ENGINEER

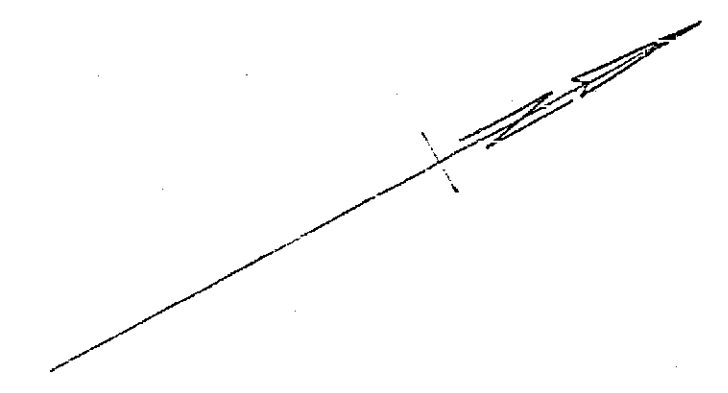
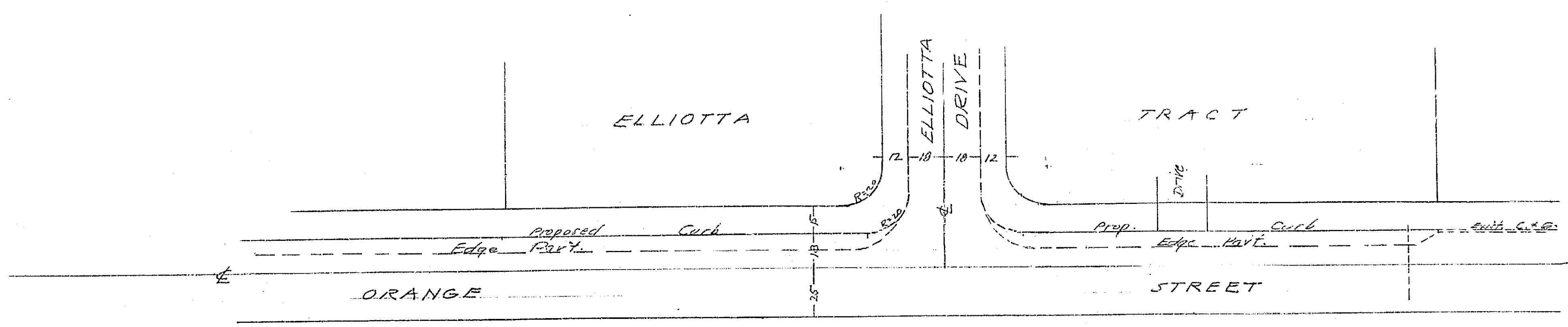

41 42 43 44 45 46 47

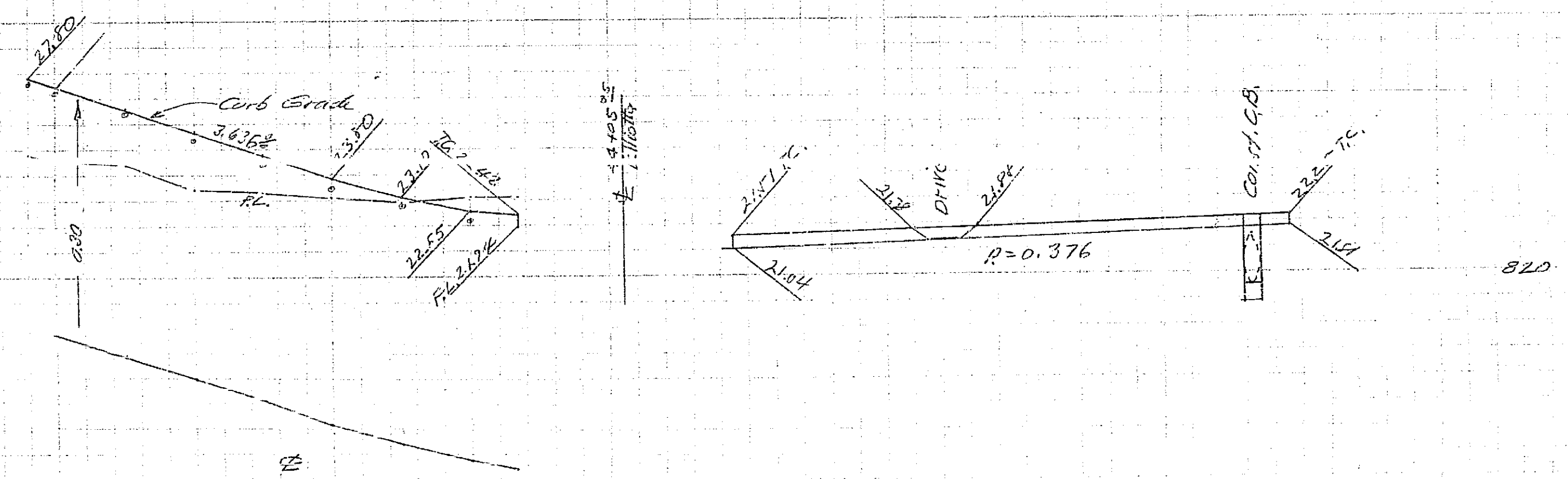

PROPERTY OF
CITY OF RIVERSIDE
CITY ENGINEERING DEPT.

PROPERTY OF
CITY OF RIVERSIDE
CITY ENGINEERING DEPT.

1076 B

A STATE ROAD ENGINEER
CITY OF RIVERSIDE
CITY ENGINEERING DEPT.