

**PLAN**  
SCALE: 1" = 40'

**CURB CURVES #1,2,3,4**  
 $\Delta = 40^\circ 32' 10"$   
 $R = 20$   
 $L = 14.15$

**CURB CURVES #5,6**  
 $\Delta = 61^\circ 04' 20"$   
 $R = 30$   
 $L = 22.45$

10' strip...  
 Warp edge of paving to provide drainage  
 Construct barricade at...  
 Pave to and across flow line of ditch  
 Warp edge of paving to provide drainage

ALBERT A. WEBB, A. SOC.  
 CIVIL ENGINEER  
 MAY 1952

APPROVED *M. K. ...*  
 CITY ENGINEER

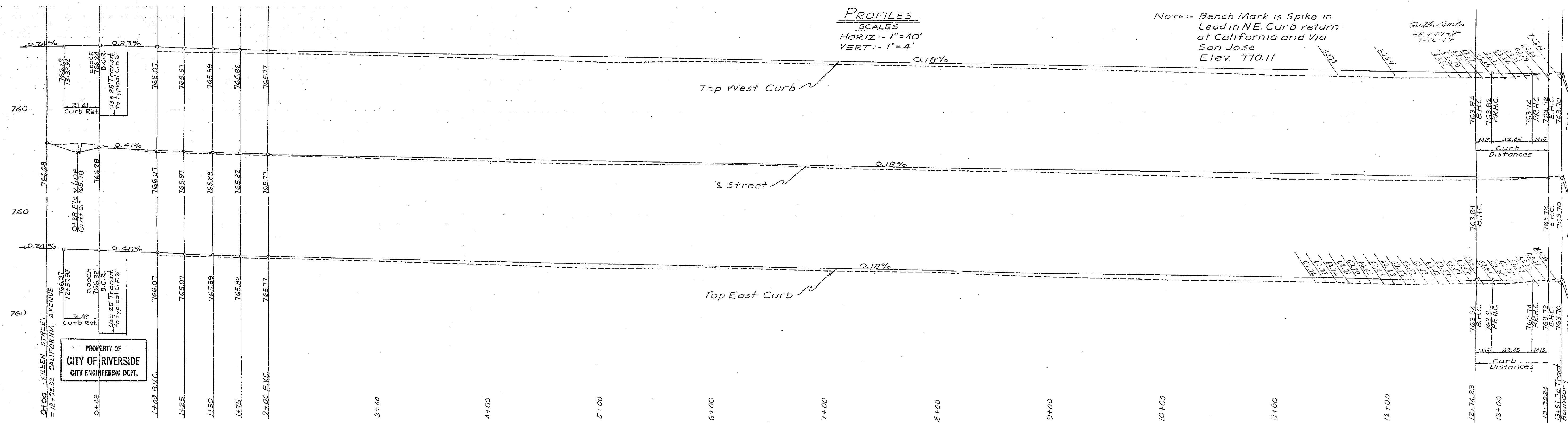

**PROFILES**  
 SCALES  
 HORIZ: 1" = 40'  
 VERT: 1" = 4'

NOTE: Bench Mark is Spike in Lead in NE Curb return of California and Via San Jose Elev. 770.11

PROPERTY OF  
 CITY OF RIVERSIDE  
 CITY ENGINEERING DEPT.

FB. 126  
 W.O. 52-56

1089



PROPERTY OF  
CITY OF RIVERSIDE  
CITY ENGINEERING DEPT.

1089

STREET PLAN AND PROFILE  
OF  
CALIFORNIA AVENUE  
BETWEEN  
CALIFORNIA SQUARE  
AND  
EDNA STREET

ALBERT A WEBB ASSOC.  
CIVIL ENGINEERS  
MAY 1952

PROPERTY OF  
CITY OF RIVERSIDE  
CITY ENGINEERING DEPT.

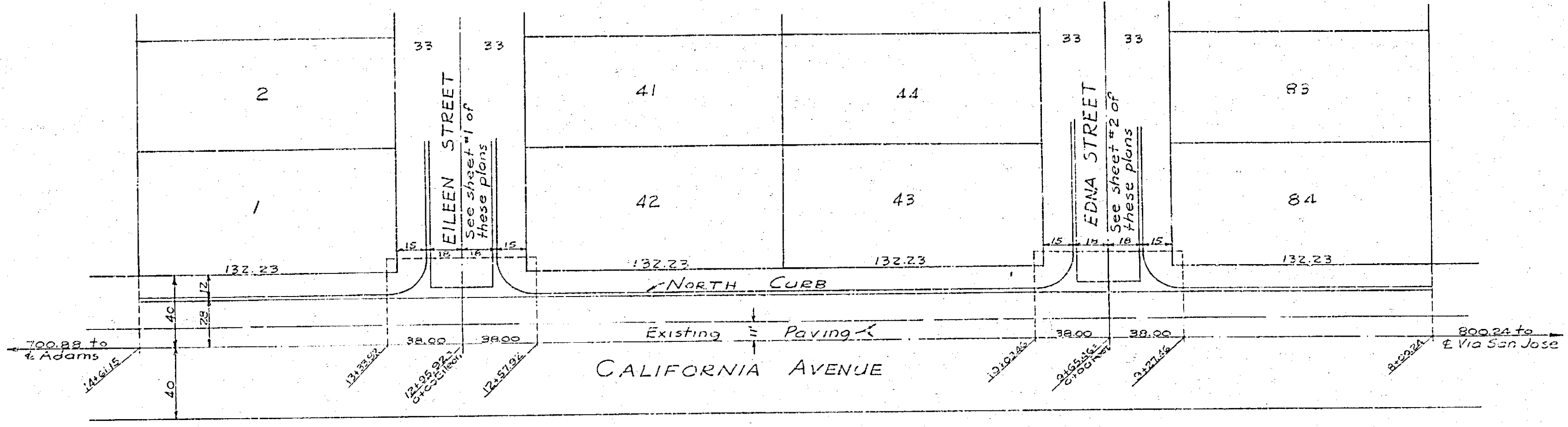
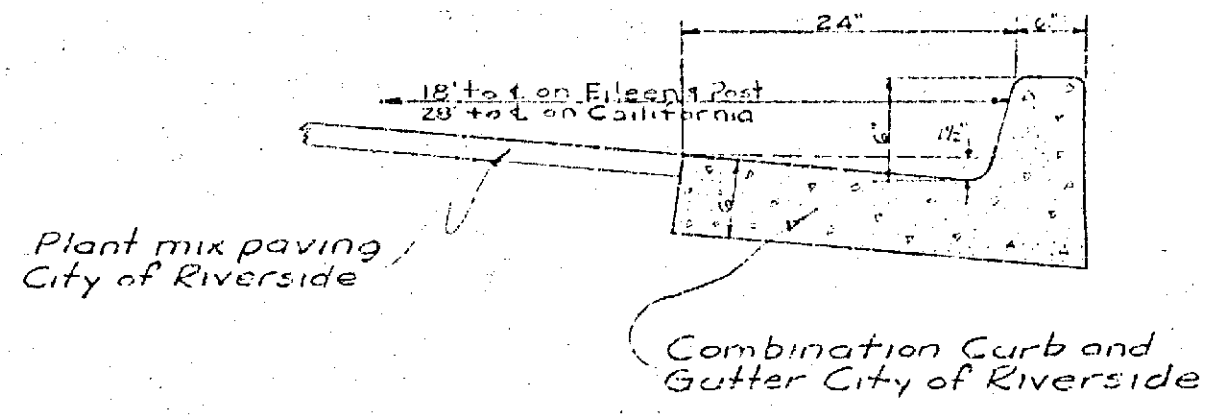

PLAN  
SCALE 1" = 40'

APPROVED M. V. Smith  
CITY ENGINEER

PROFILES  
SCALE  
HORIZ: 1" = 40'  
VERT: 1" = 4'

NOTE: Bench Mark is Spike in  
Lead in N.E. curb return  
at California and Via  
San Jose  
Elev. 770.11  
(F.B. 505, 19.73)

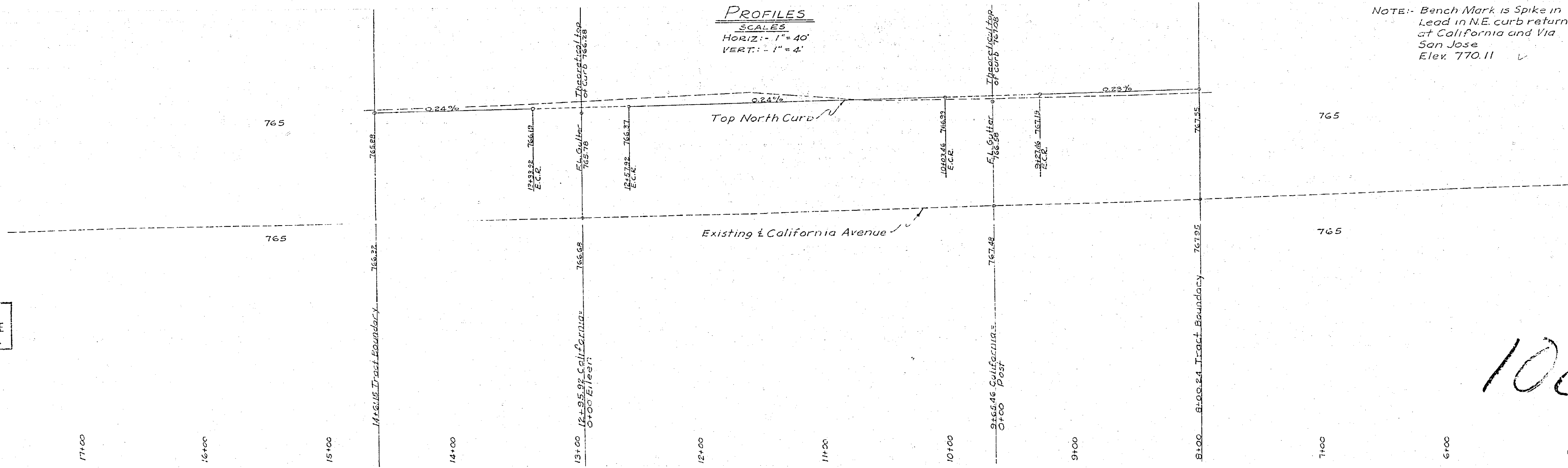

PROPERTY OF  
CITY OF RIVERSIDE  
CITY ENGINEERING DEPT.

PROPERTY OF  
CITY OF RIVERSIDE  
CITY ENGINEERING DEPT.

1089