

SCALE: 1" = 100'

PLAN NO. 1100-A  
SHOWING THE LANDS INCLUDED  
WITHIN THE ASSESSMENT DISTRICT  
TO BE BENEFITED BY THE CONSTRUCTION  
OF CONCRETE CURBS AND GUTTERS  
IN THE MATTER OF  
**DONALD AVENUE  
IMPROVEMENT DISTRICT**  
RIVERSIDE, CALIFORNIA

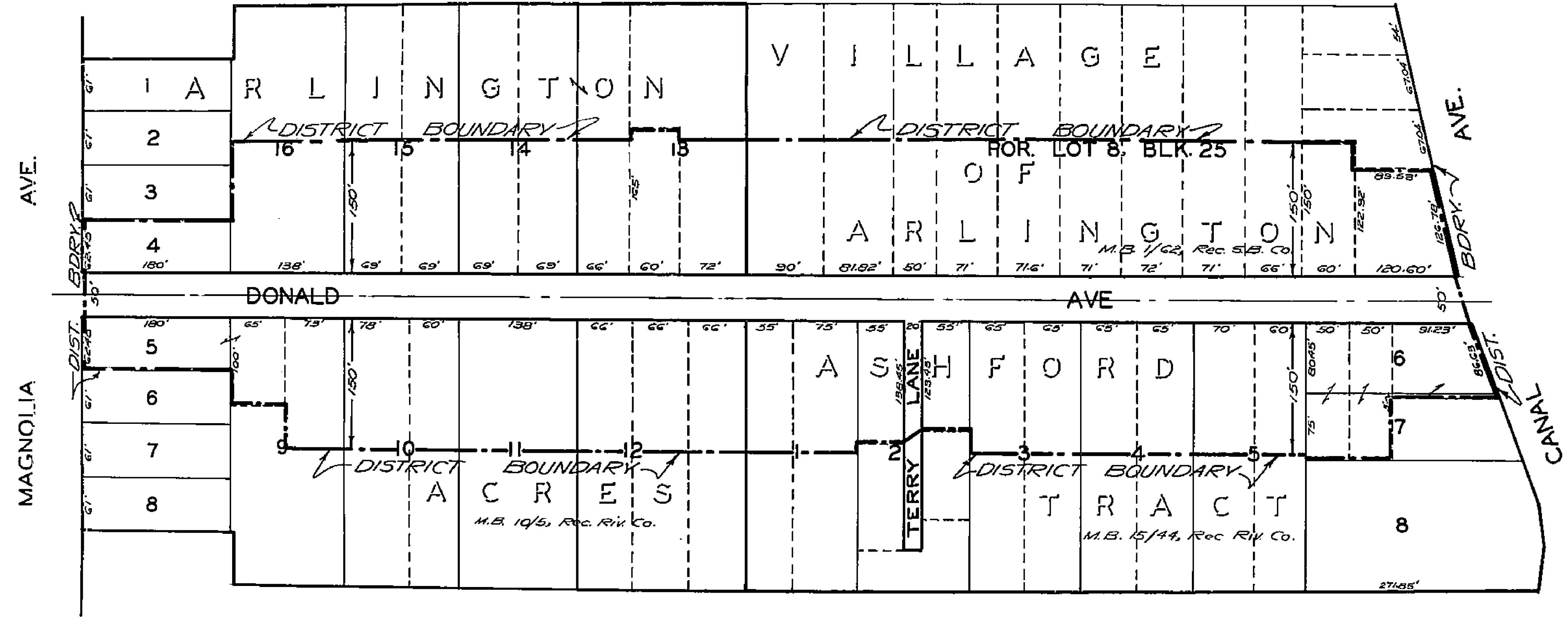

APPROVED: M.H. IRVINE, REG. C.E. NO. 3011  
CITY ENGINEER

THIS PLAN APPROVED AND ADOPTED  
BY THE MAYOR AND COUNCIL OF THE  
CITY OF RIVERSIDE STATE OF CALIFORNIA  
ON THIS \_\_\_\_ DAY OF \_\_\_\_ 1953

\_\_\_\_\_  
CITY CLERK

DISTRICT BOUNDARY SHOWN THUS 

1100A