

1000 FT = 1 INCH

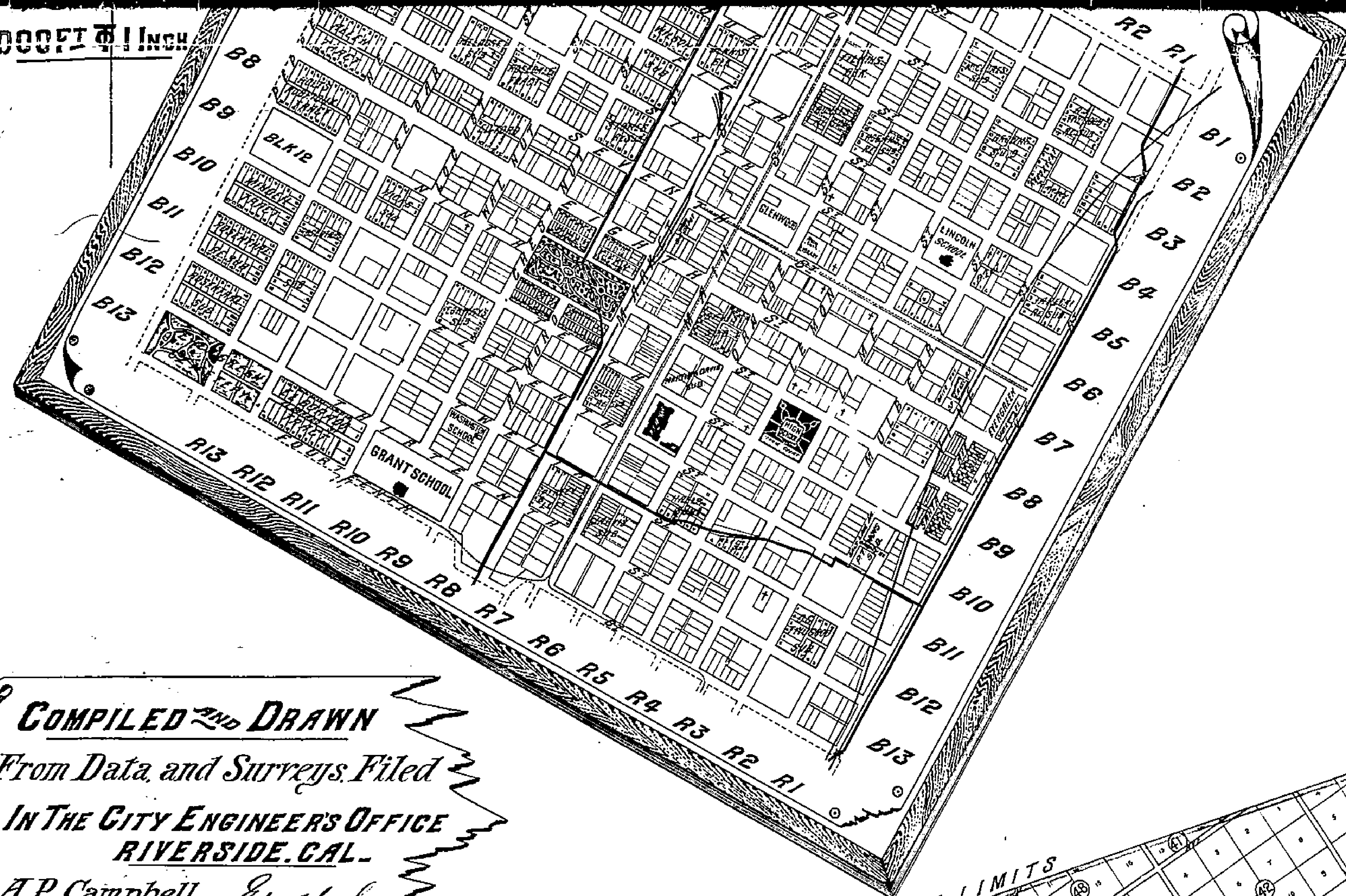

COMPILED AND DRAWN
From Data and Surveys Filed
IN THE CITY ENGINEER'S OFFICE
RIVERSIDE, CAL.
A.P. Campbell *Edw. Mowbray*
City Engineer *Draughtsman*

Corrected to [redacted]

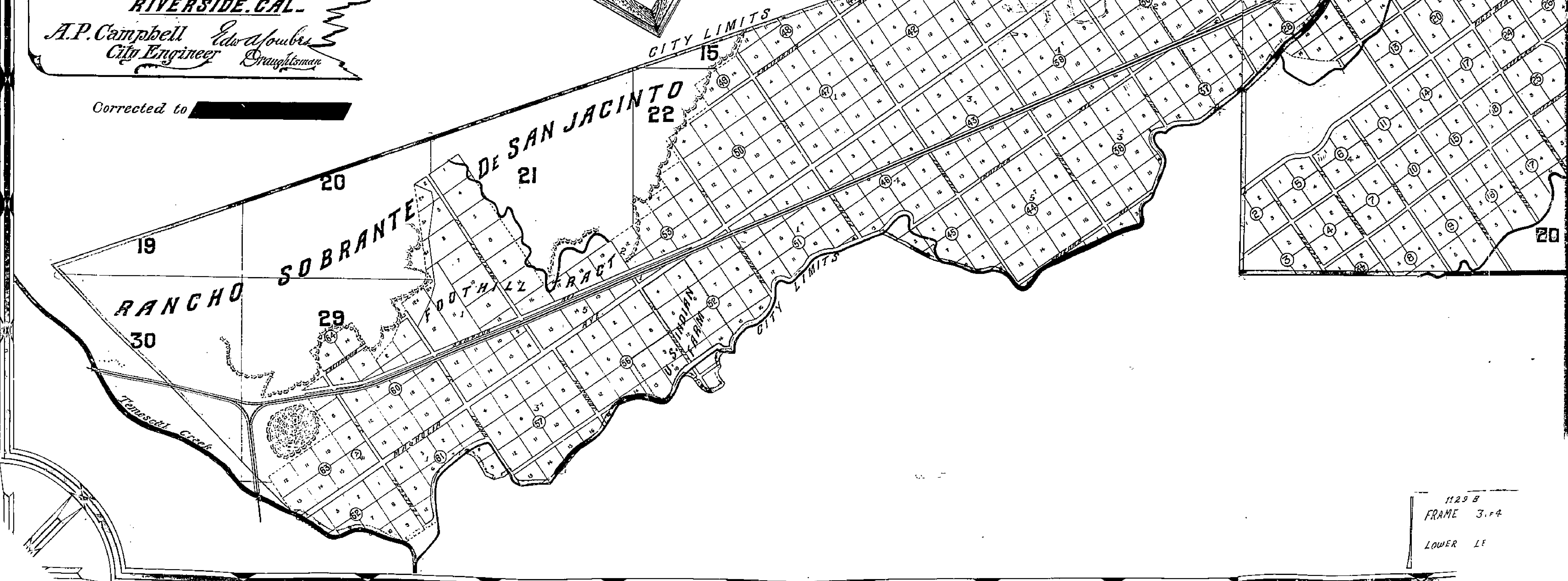

1125 B
 FRAME 3 of 4
 LOWER LF