

MAP of PROPOSED IMPROVEMENTS on
EAST EIGHTH ST.,
 Between the Southern Pacific R.R. and Kansas Ave.

Scale of Map
 1 in. = 60 ft.
 Scale of Profile
 1 in. = 10 ft.
 1 in. = 2 ft.

A.P. Campbell,
 Engineer.

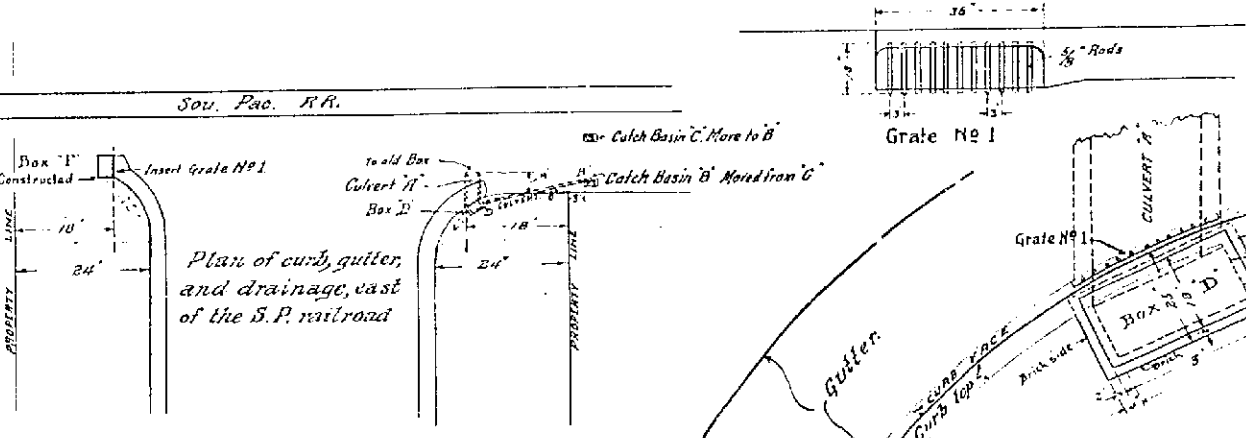
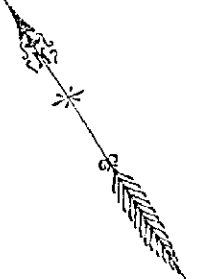
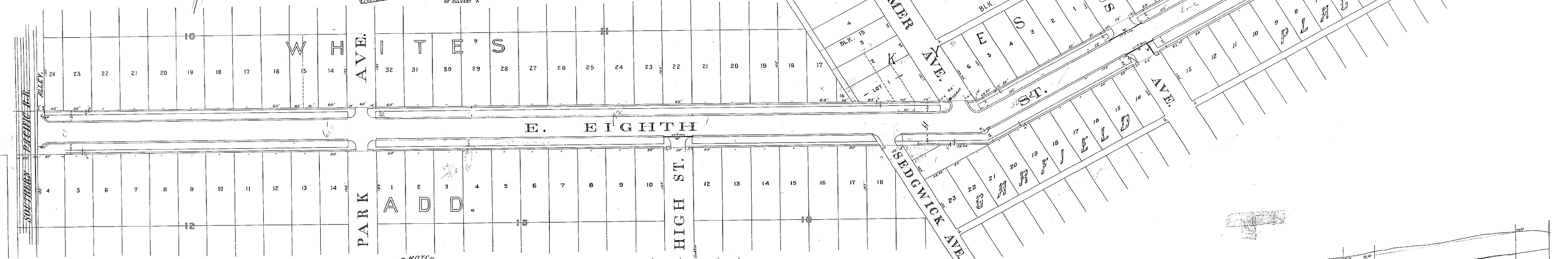
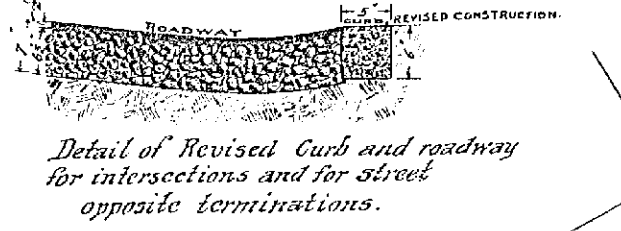
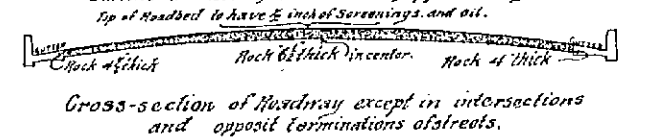
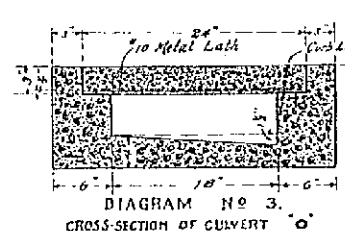
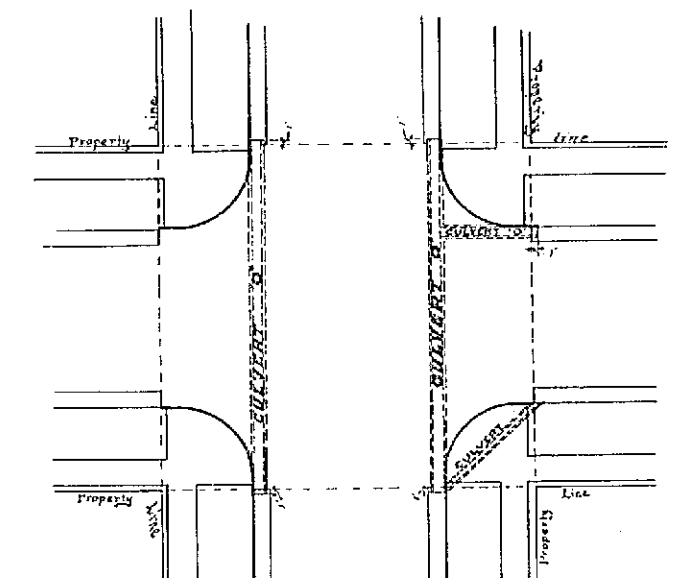
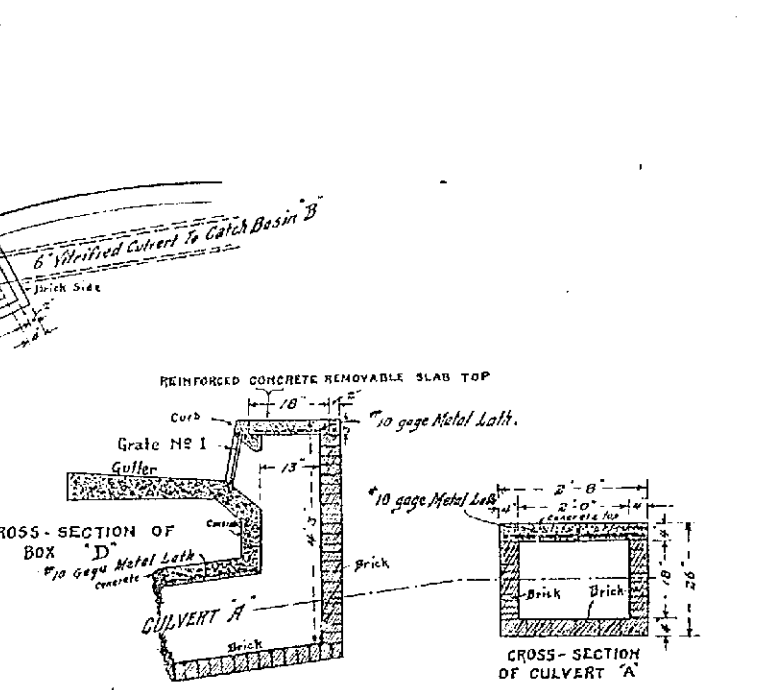
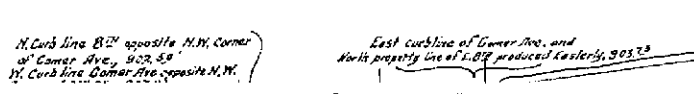
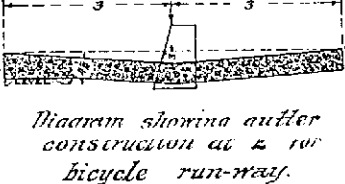
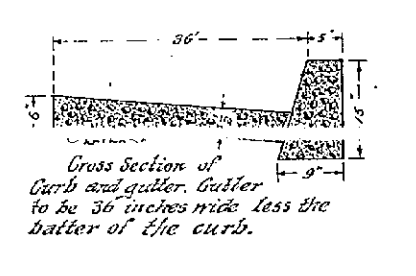

DIAGRAM No 1



NOTE
 IMPROVEMENTS TO BE MADE ARE SHOWN ON THE MAP AS FOLLOWS :-
 Cement sidewalk to be constructed in shown lines
 General curb to be constructed in shown lines
 Roadbed to be reconstructed in shown lines
 Catch basins, street lighting, etc., to be constructed as shown in Diagram No. 1 as shown there
 Catch basins to be moved from 'a' to 'b' according to Diagram No. 2, and reconstructed, and culvert to be built from 'a' to 'b' as shown there
 Catch basins to be moved from 'c' to 'd' according to Diagram No. 3 as shown there
 Concrete culverts to be built according to Diagram No. 4 as shown there
 Reinforced concrete flat top culverts to be constructed according to Diagram No. 5 as shown there



Scale of Profile
 1 in. = 10 ft.
 1 in. = 2 ft.
 Base Line Elevations:
 North Side, 860 ft.
 Center, 865 ft.
 South Side, 870 ft.

Adopted by the Mayor and Common Council of the City of Kansas, 1902.
 Attest, City Clerk.

1156A