

No 1169-B  
PLAN AND PROFILE  
SHOWING CURB GRADES ON  
SIERRA STREET  
FROM DAMON TO PALM AVENUE  
F.B. 546-24 FEB. 1954

HOR. 1"=40 FT.  
SCALE VERT. 1"=4 FT.

APPROVED *M. H. Irvine*  
CITY ENGINEER

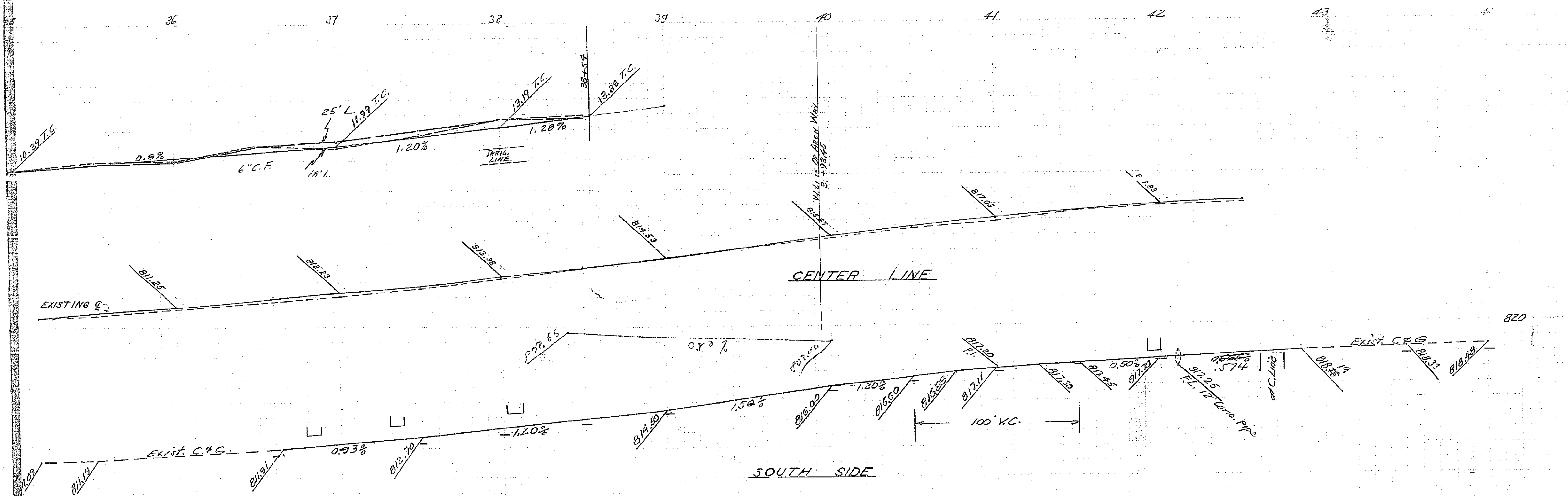

1169B