

Adopted by the Mayor
and Common Council of the
City of Riverside, May 2, 1908.
Attest: *[Signature]*
City Clerk.

#1181-B
dated
Nov. 10 1908
Original No 21

MAP SHOWING THE PROPOSED WASHINGTON ST. STORM DITCH, THE MONROE ST. STORM DITCH EXTENSION, AND THE DISTRICT BENEFITED THEREBY, CALLED THE WASHINGTON-MONROE STORM-DISTRICT

HEREIN THE PROPOSED STORM DITCHES ARE SHOWN BY A RED LINE THUS: ————
THE DISTRICT TO BE BENEFITED IS BOUNDED BY A GREEN LINE & ORANGE BAND THUS: ————

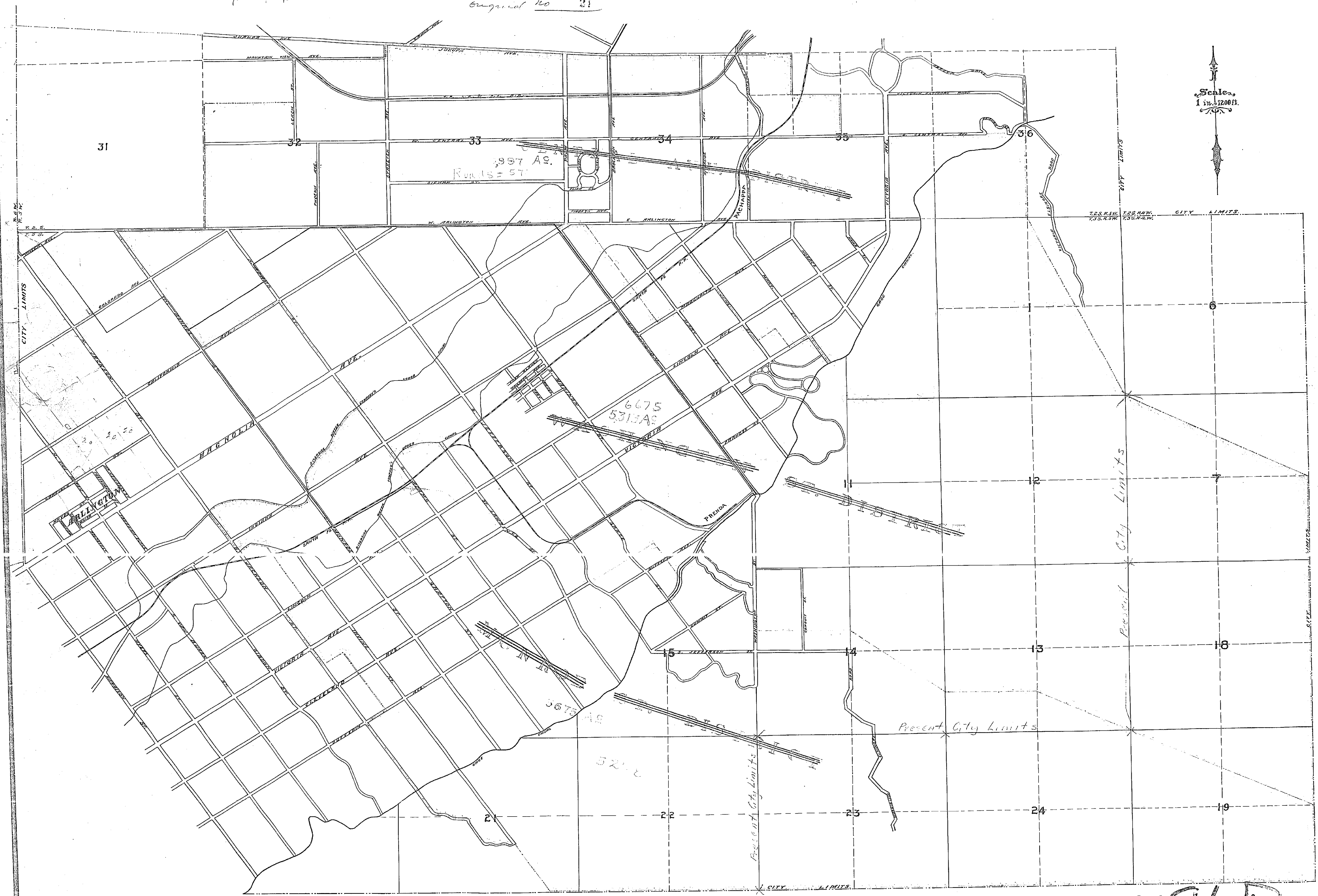

1181 B 21

MAP SHOWING THE PROPOSED WASHINGTON ST. STORM DITCH,
THE MONROE ST. STORM DITCH EXTENSION,
AND THE DISTRICT BENEFITED THEREBY,
CALLED THE WASHINGTON-MONROE STORM DISTRICT.

HEREIN THE PROPOSED STORM DITCHES ARE SHOWN BY A RED LINE THUS:—
THE DISTRICT TO BE BENEFITED IS BOUNDED BY A GREEN LINE & ORANGE BAND THUS:—

H. J. Campbell,
City Engineer

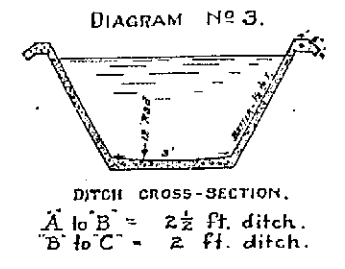
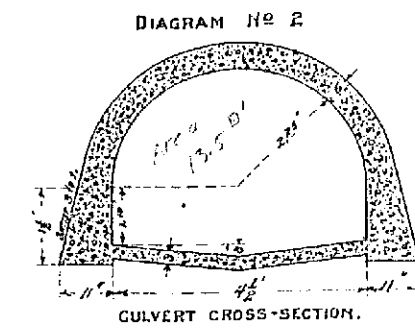
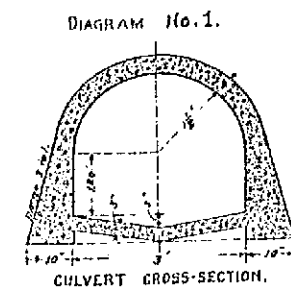
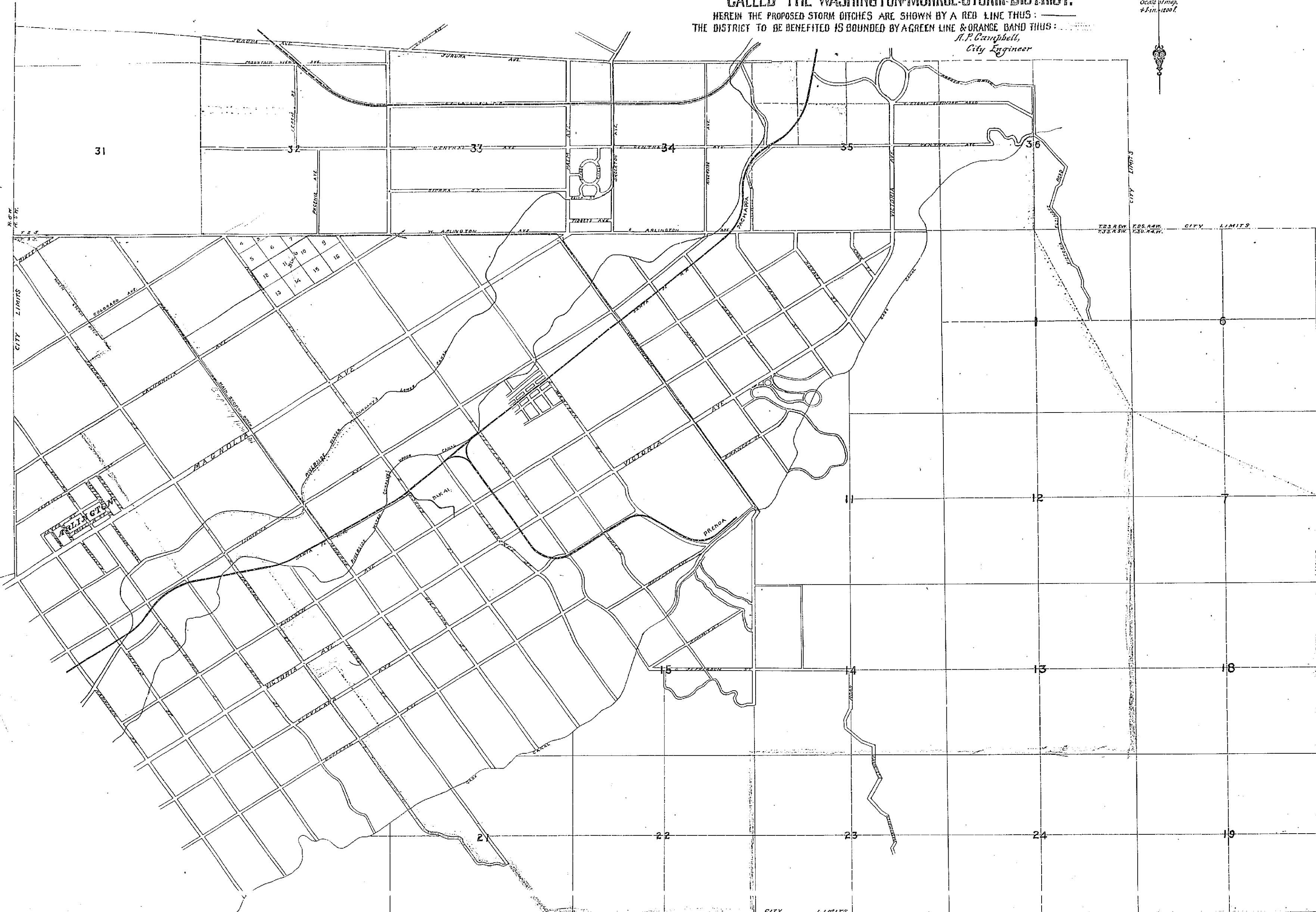

Handwritten note:
11/10/1908
C. J. B. B.
Capt. 11/10/1908

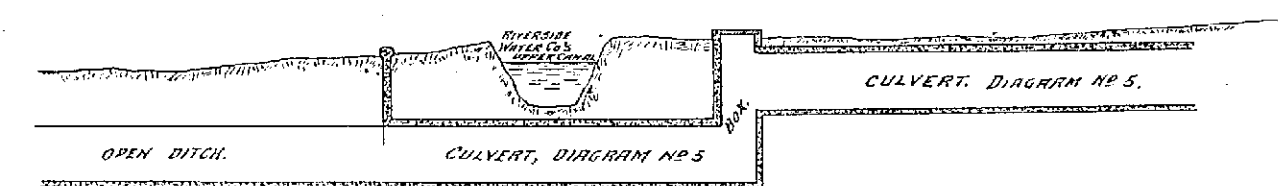
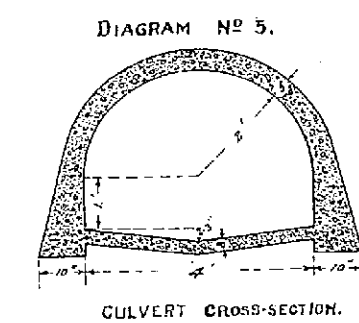
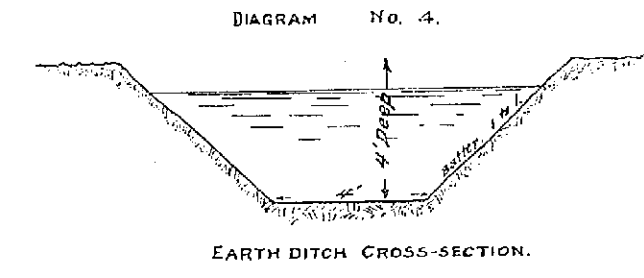

Profile of Culvert No. 2
Scale, 1 in 100 ft.

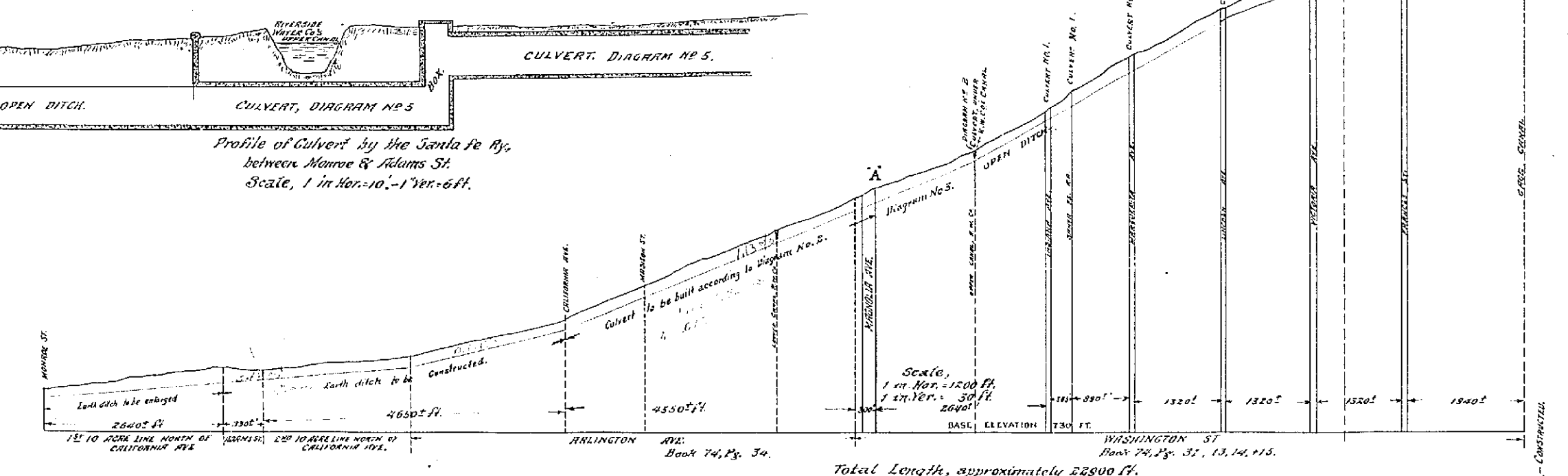

Total Length, approximately 22800 ft.

Adapted by the Mayor and
Common Council of the City of
Riverside, Cal., this 10th day of Nov., 1908.
Attest: J. C. ...
City Clerk

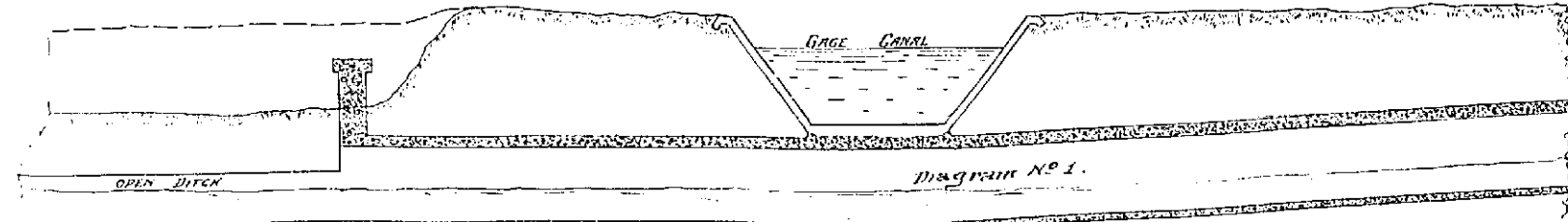

Profile of Culvert No. 3
Scale, 1 in 100 ft.

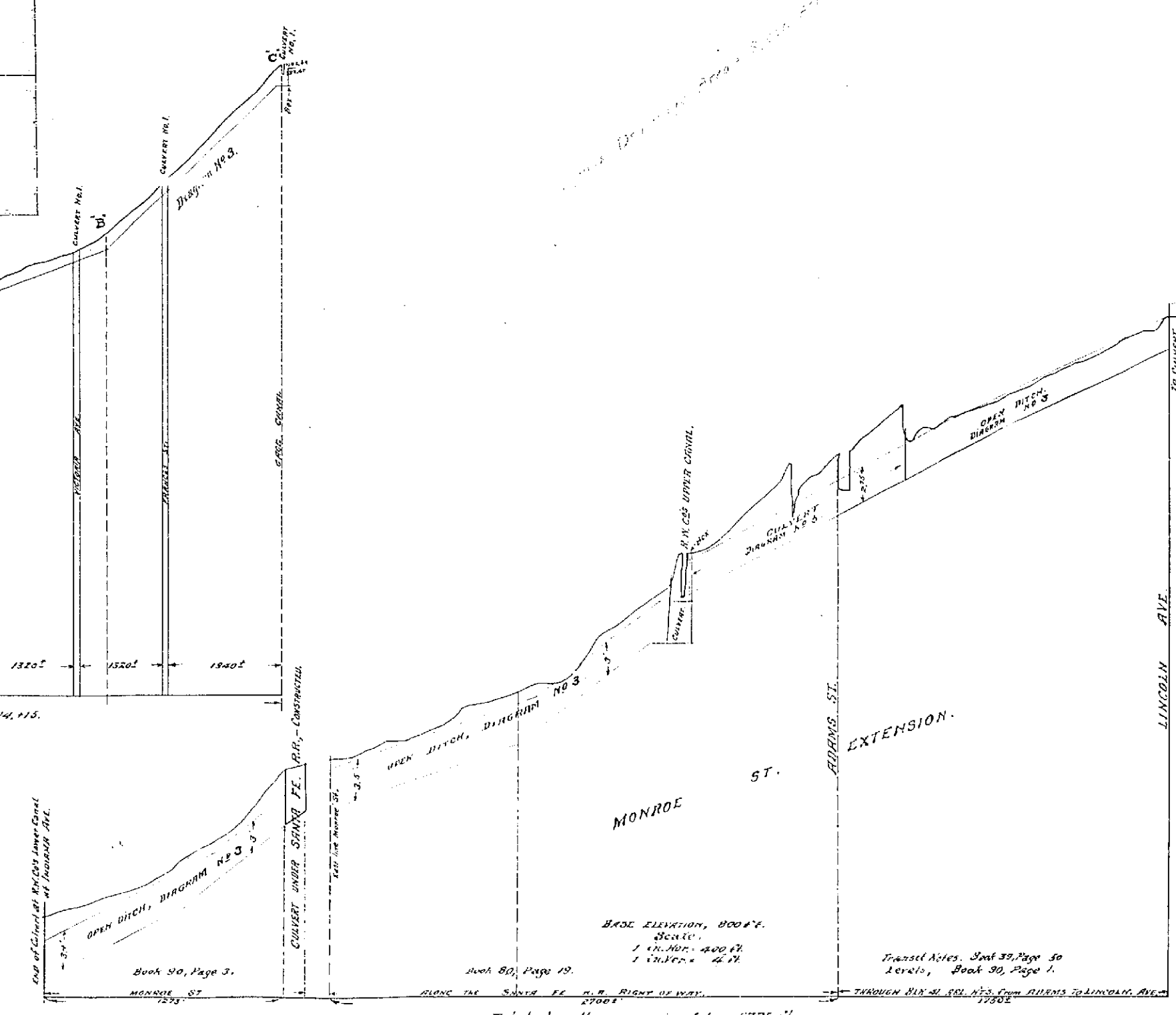

Total Length, approximately 5725 ft.

1181 B