

PLAN AND PROFILE  
NO. 1185  
FOR THE CONSTRUCTION SANITARY SEWER  
IN  
**MASSACHUSETTS AVENUE**  
BETWEEN KANSAS AVE. AND CHICAGO AVE.  
RIVERSIDE, CALIFORNIA

Approved *M.H. Irvine*  
City Engineer

SCALES: HORIZ. 1" = 50'  
VERT. 1" = 5'

FB. 536/63 - TOPO.  
FB. 541/63 - PROFILE

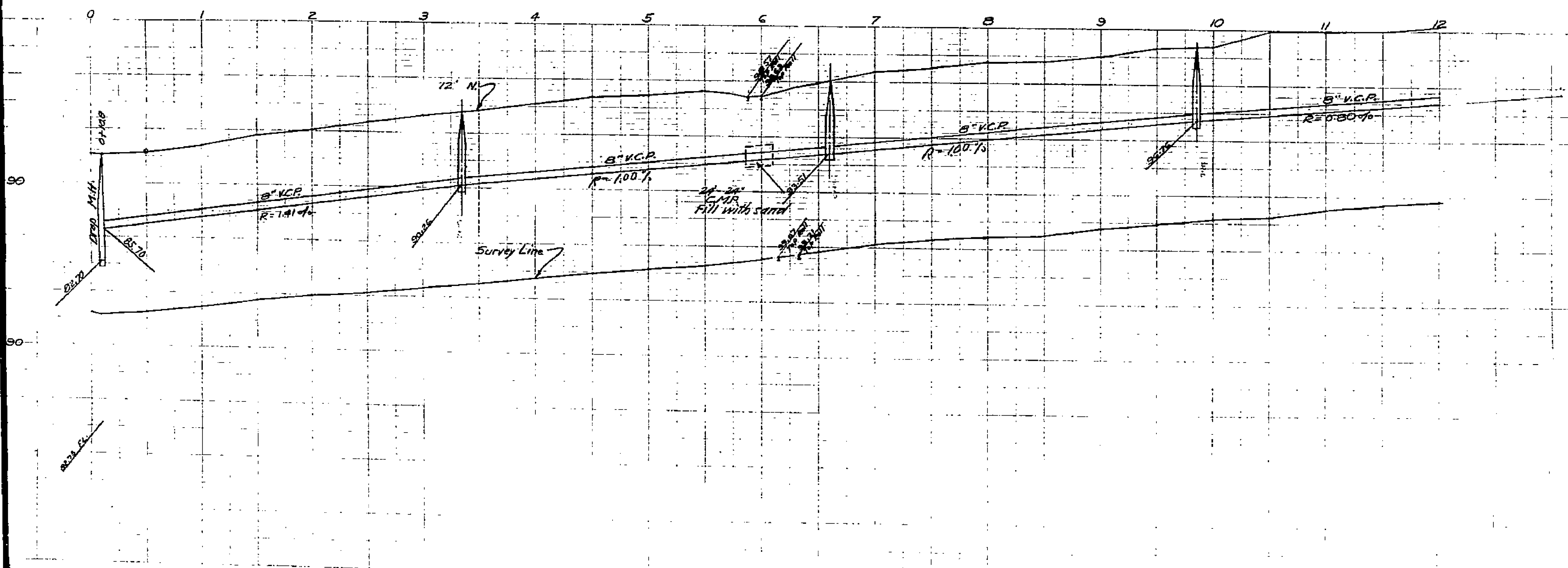
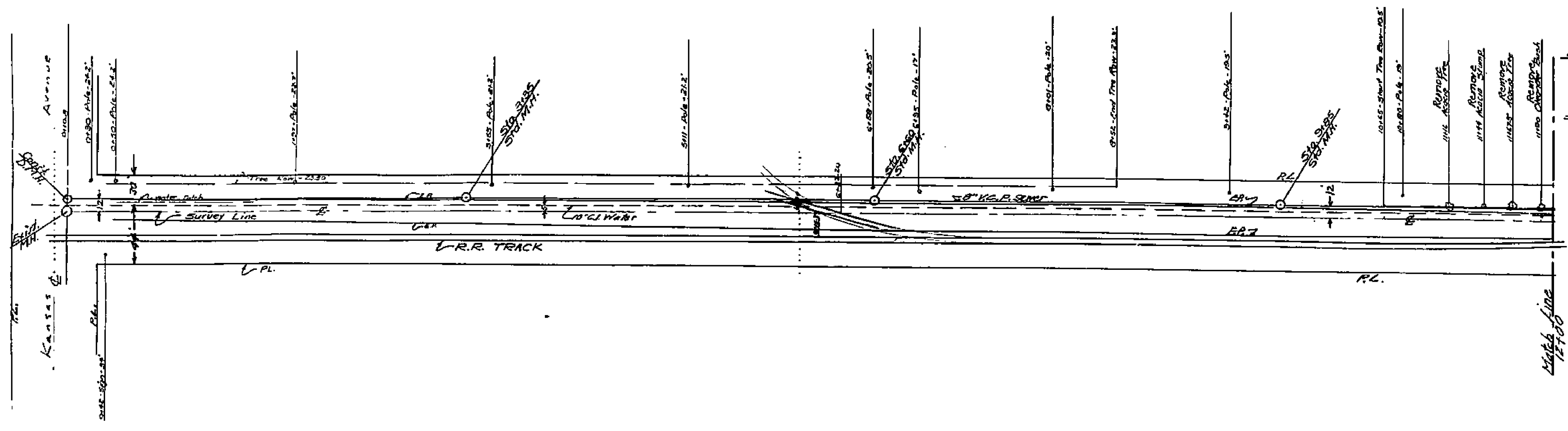

1185

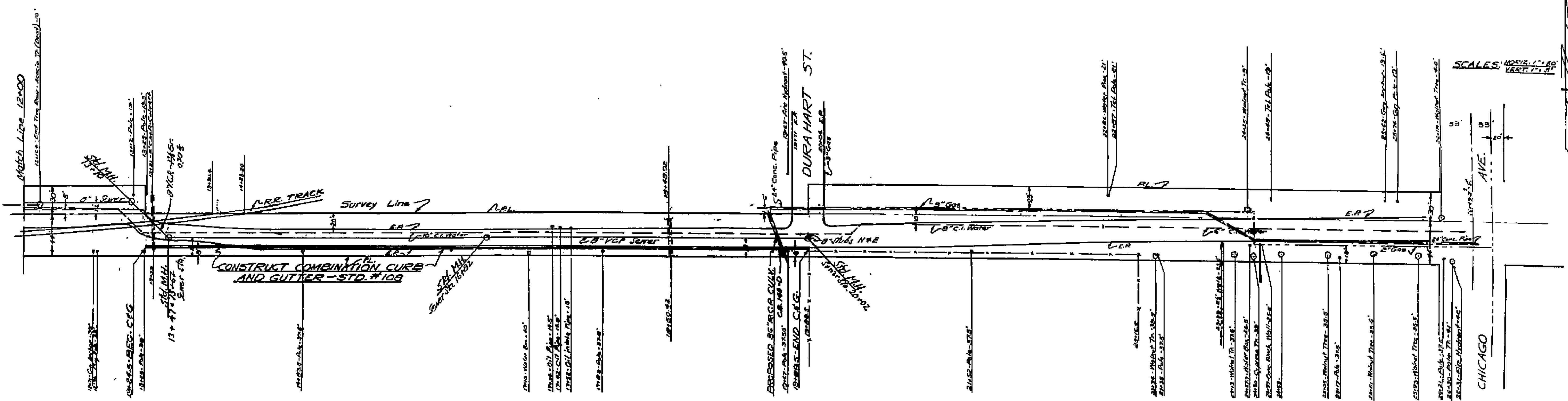

SCALES: HORIZ. 1" = 40' VERT. 1" = 5'

CHICAGO

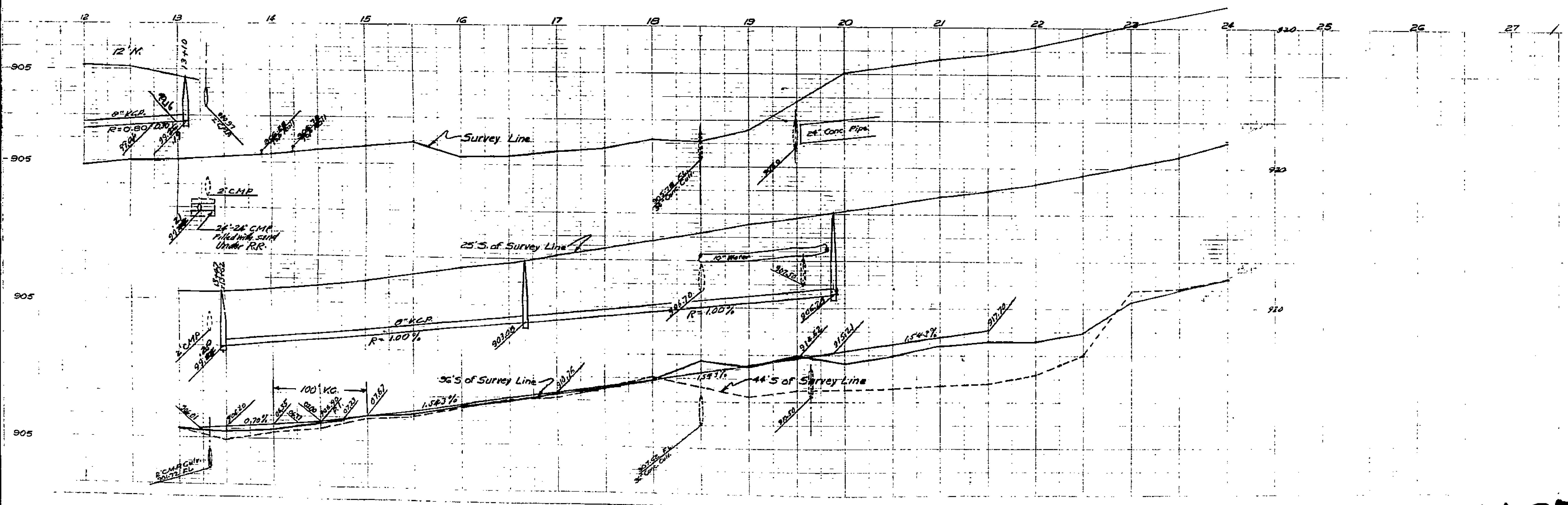

1185