

MAP NO. 1523-A
 SHOWING THE LANDS INCLUDED WITHIN
 THE ASSESSMENT DISTRICT TO BE BENEFITED
 BY THE CONSTRUCTION OF SANITARY SEWERS
 IN THE MATTER OF
CORTEZ-VERDE
SANITARY SEWER DISTRICT

RIVERSIDE CALIFORNIA
 DISTRICT BOUNDARY SHOWN THUS _____
 SCALE: 1"=100 FT. APRIL 1955

APPROVED: *M. H. Irvine*
 M. H. IRVINE - REG. C.E. NO. 3011
 CITY ENGINEER

R. L. & I. CO.

BLOCK 21

16

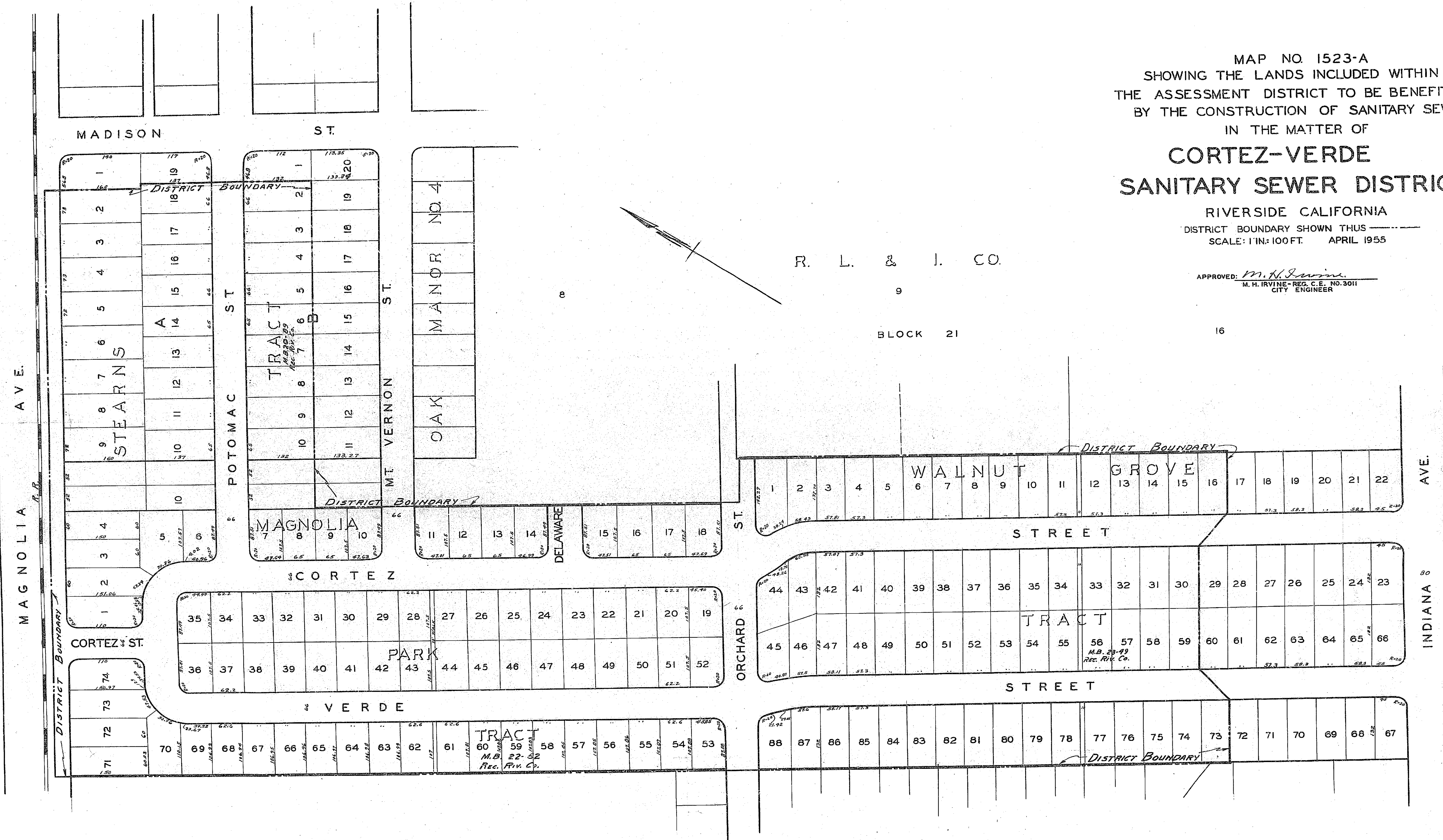

1523A