

DEXTER DRIVE REDWOOD DR. TO DAM			
Drawing Number	Sheet Number	Total Sheets	Field Book
159	1	1	388
Drawn	Checked	Approved	

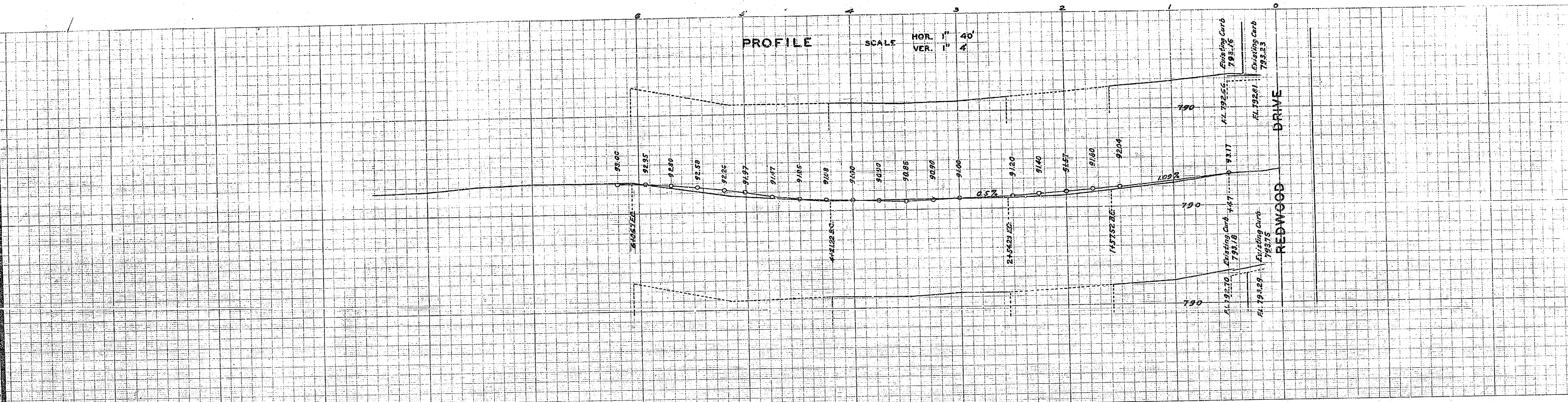

PLAN AND PROFILE
OF THE PROPOSED IMPROVEMENT ON
DEXTER DRIVE

REDWOOD DRIVE TO DAM
ENGINEER DEPT. RIVERSIDE CALIF. 1939.
CITY (U.S.G.S.) DATUM PLANE
FIELD BOOK 300 PAGE A-11
APPROVED _____
CITY ENGINEER.

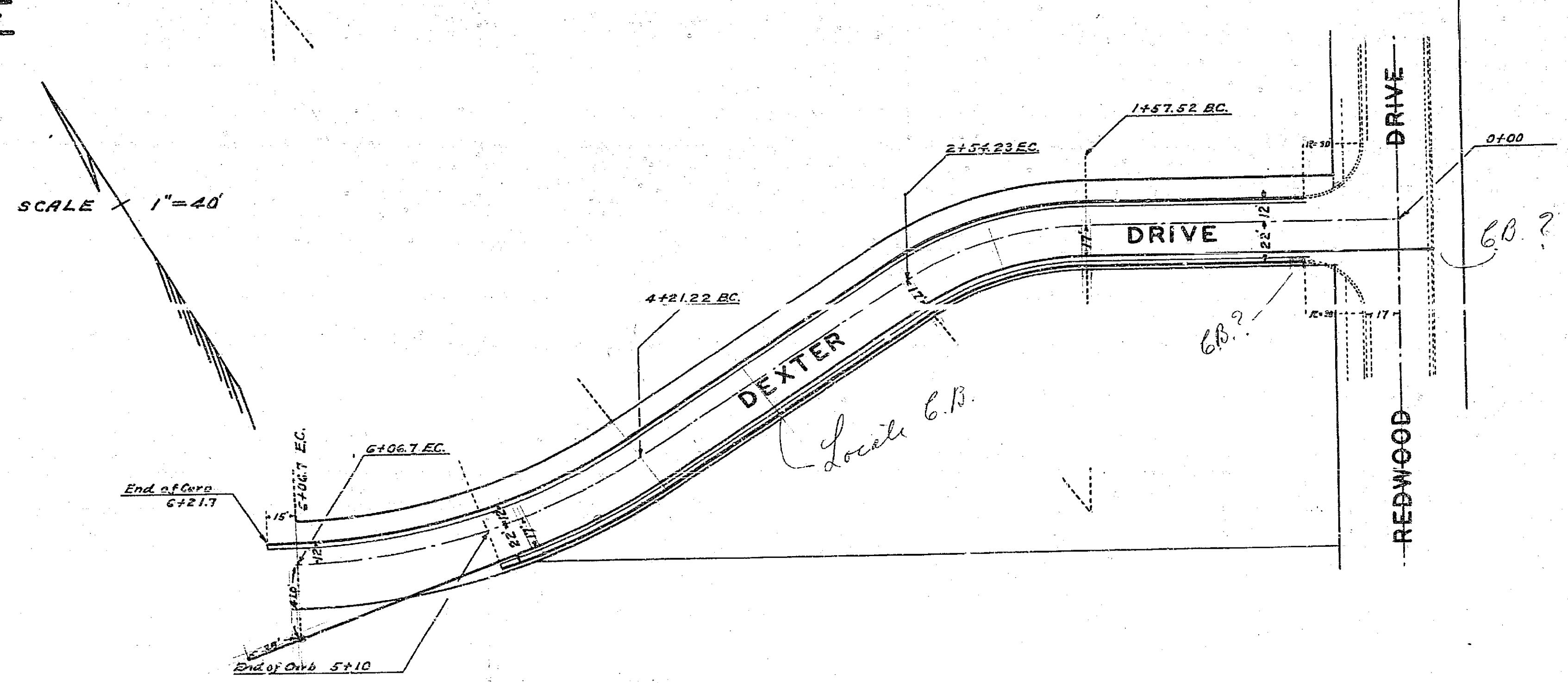

APPROVED AND ADOPTED BY THE MAYOR
AND COUNCIL OF THE CITY OF RIVERSIDE
THIS DAY OF 1939.
CITY CLERK, CITY OF RIVERSIDE.

159