

Magnolia Ave - Myers St to Harrison St			
Drawing Number	Sheet Number	Total Sheets	Field Books
17	1	1	239-243-244
Drawn	Checked	Approved	
Arthur R. Risley			
January 27, 1939			

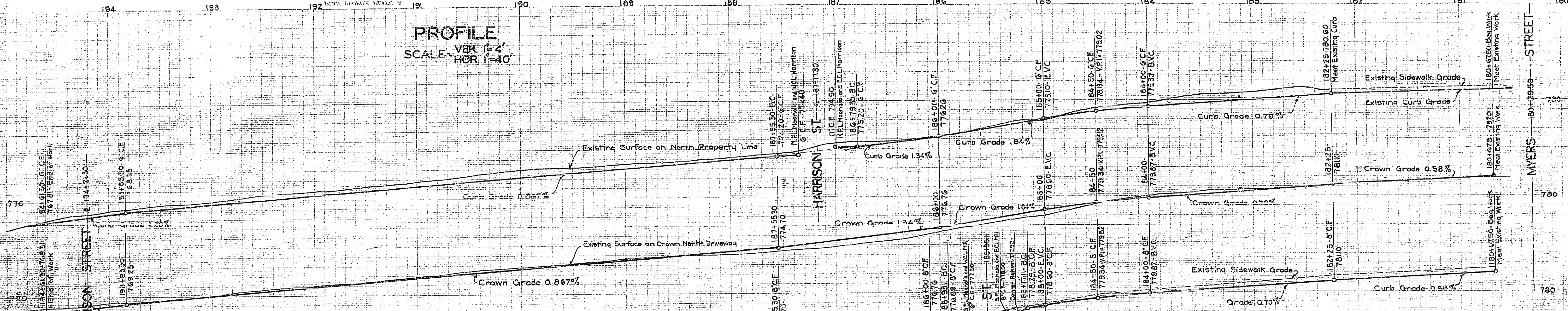

PROFILE
SCALE - VER. 1" = 4'
HOR. 1" = 40'

PLAN AND PROFILE OF THE PROPOSED STREET IMPROVEMENT OF MAGNOLIA AVENUE

FROM
MYERS STREET *Harrison St.*
TO
HARRISON STREET *Old Route*
BEING A PORTION OF
STATE HIGHWAY - ROUTE NO. 43
ENGINEERING DEPT. JANUARY 1939

APPROVED *[Signature]*
CITY ENGINEER

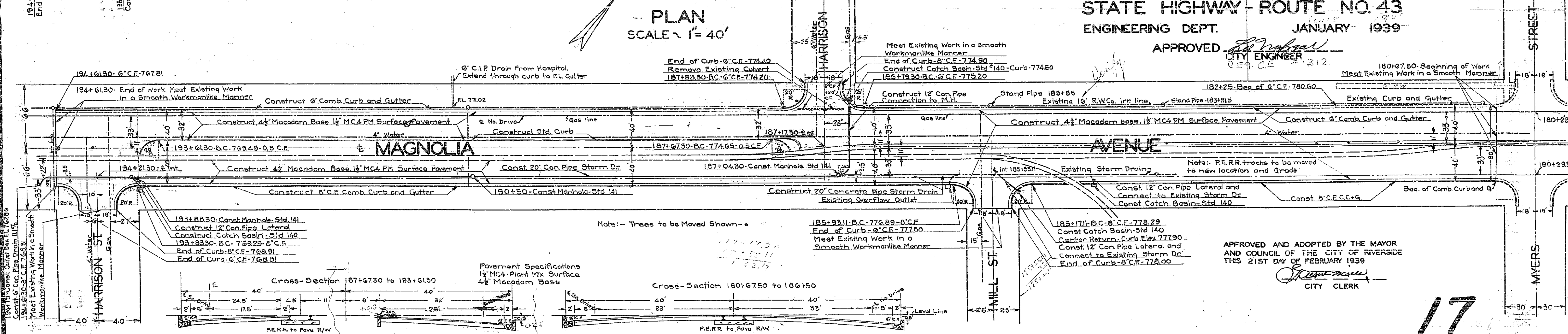

PLAN
SCALE - 1" = 40'

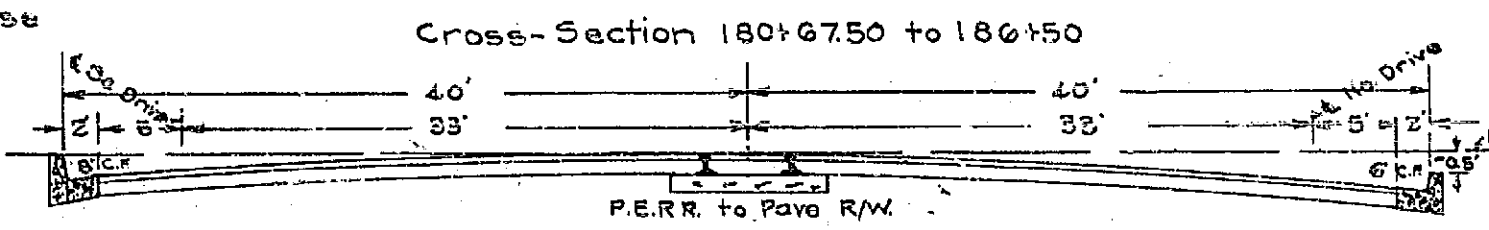
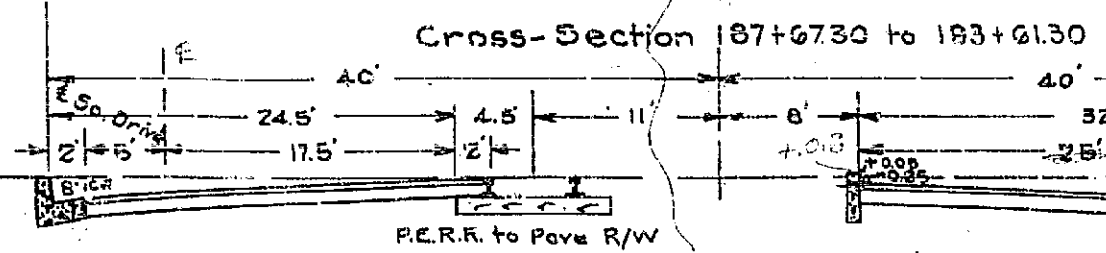

APPROVED AND ADOPTED BY THE MAYOR
AND COUNCIL OF THE CITY OF RIVERSIDE
THIS 21ST DAY OF FEBRUARY 1939
[Signature]
CITY CLERK