

CROSS GUTTER

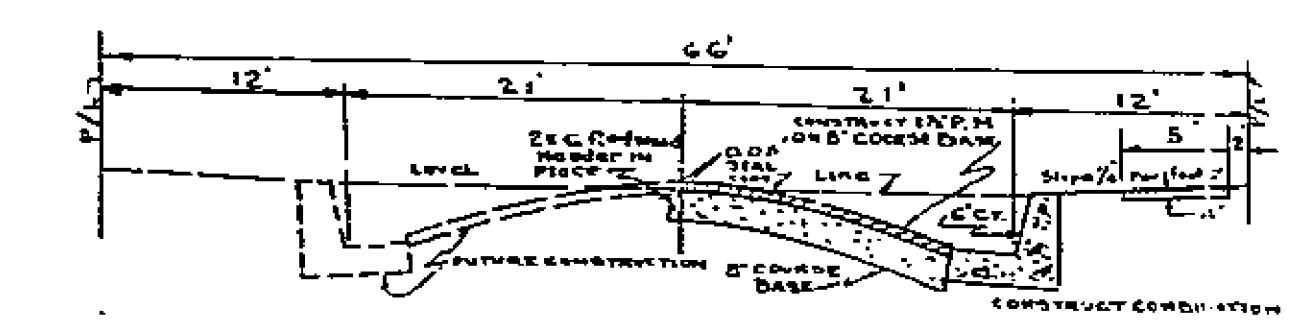

TYPICAL SECTION OF BRANIGAN WAY

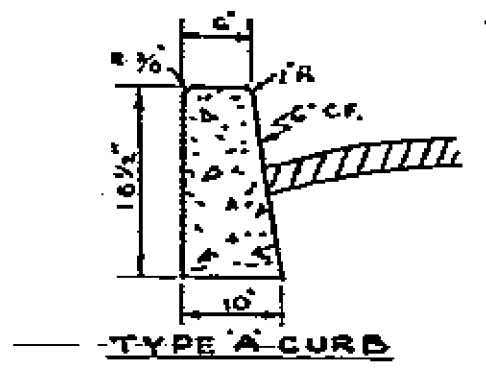

TYPE A CURB

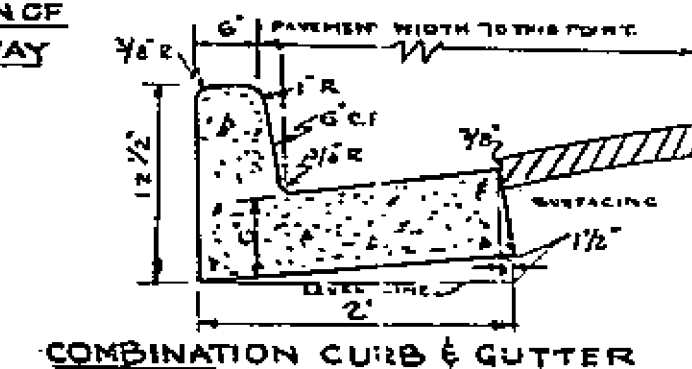

COMBINATION CURB & GUTTER

NOTE: WORK ON THESE PLANS ARE NOT
 FINAL UNLESS STAMPED BY RIVERSIDE COUNTY
 ROAD COMMISSIONERS.
 WORK ON THIS STREET PLAN TO BE DONE ON ALTER-
 NATE 6' WALKWAY FROM STATION 2425.06 TO 2428.25
 UNLESS OTHERWISE NOTED.

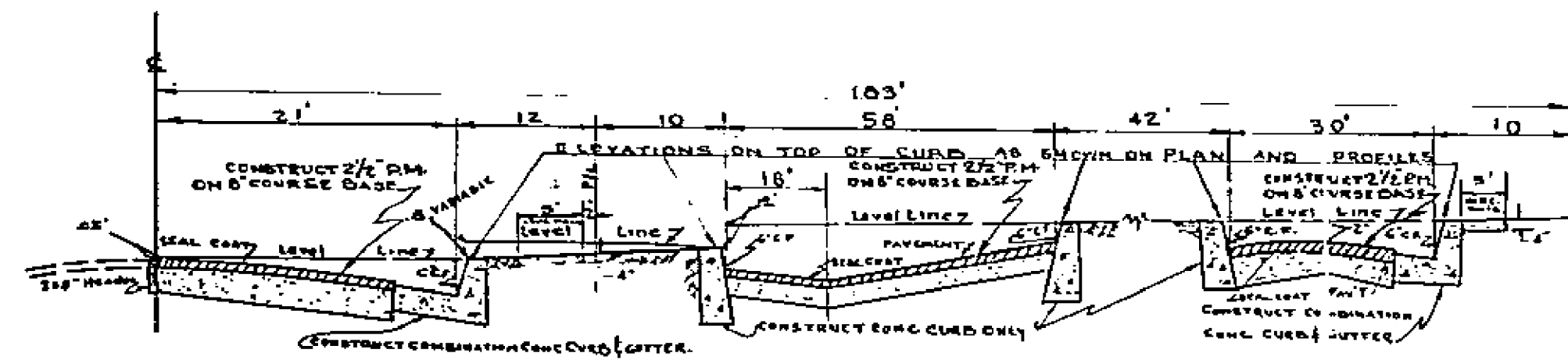

TYPICAL SECTION OF BRANIGAN WAY & PARKING AREA
 FROM STATION 2425.06 TO 2428.25.

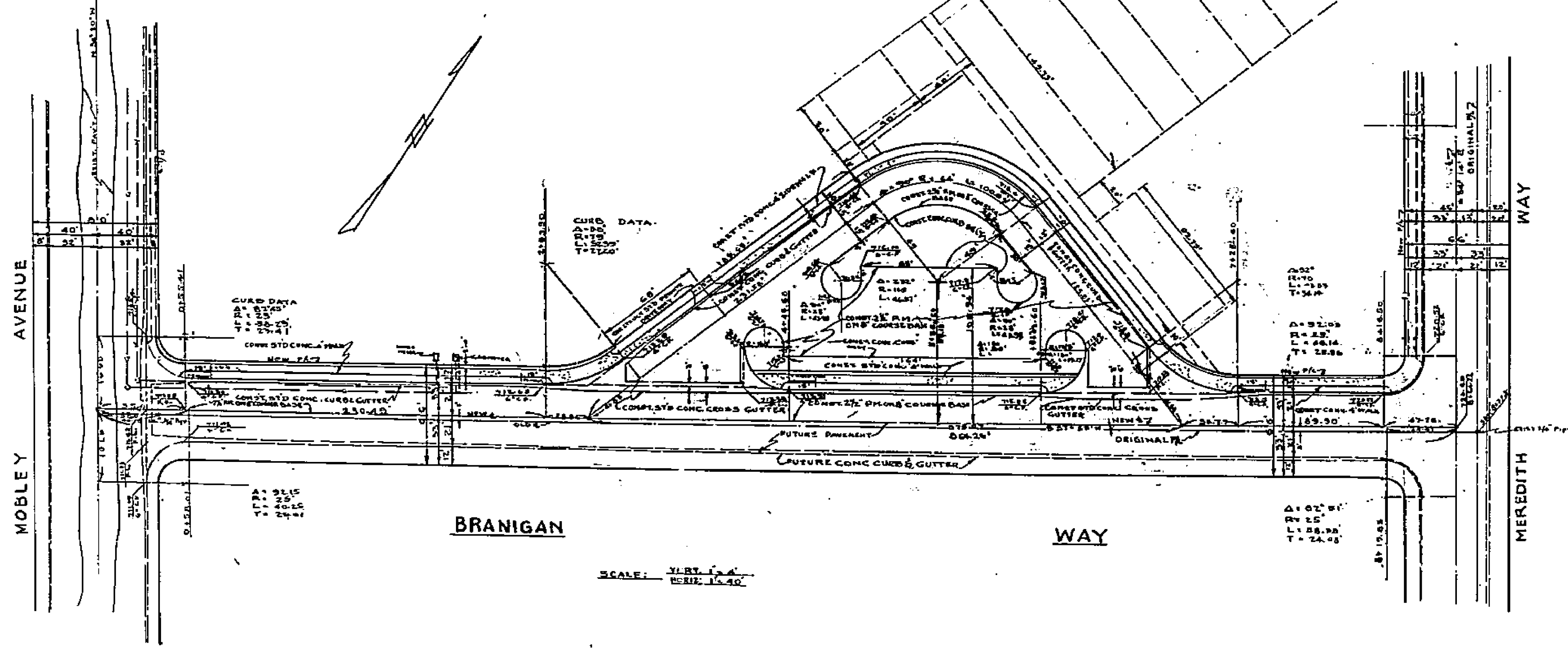

BRANIGAN

WAY

SCALE: 1/4" = 1'-0"

David Gimeno, P.E.
 Member Engineers and Architects Institute
 1416 So Main St. Berkeley 2, CALIF.
David Gimeno

PLANS, ALIGNMENT & PROFILE FOR STREET
 IMPROVEMENTS ON BRANIGAN WAY
 FOR ALVORD SCHOOL DISTRICT, ARLINGTON, CALIFORNIA.
 ENGINEER: *David Gimeno*
 RE: 65-0
 APPROVED: *[Signature]*
 COUNTY ROAD COMMISSIONER, RIVERSIDE COUNTY, CALIFORNIA

JOB NO.	9608
DATE:	6-15-50
REVISED	
DRAWN BY	
M.C.S.	
SHEET NO.	40

1703

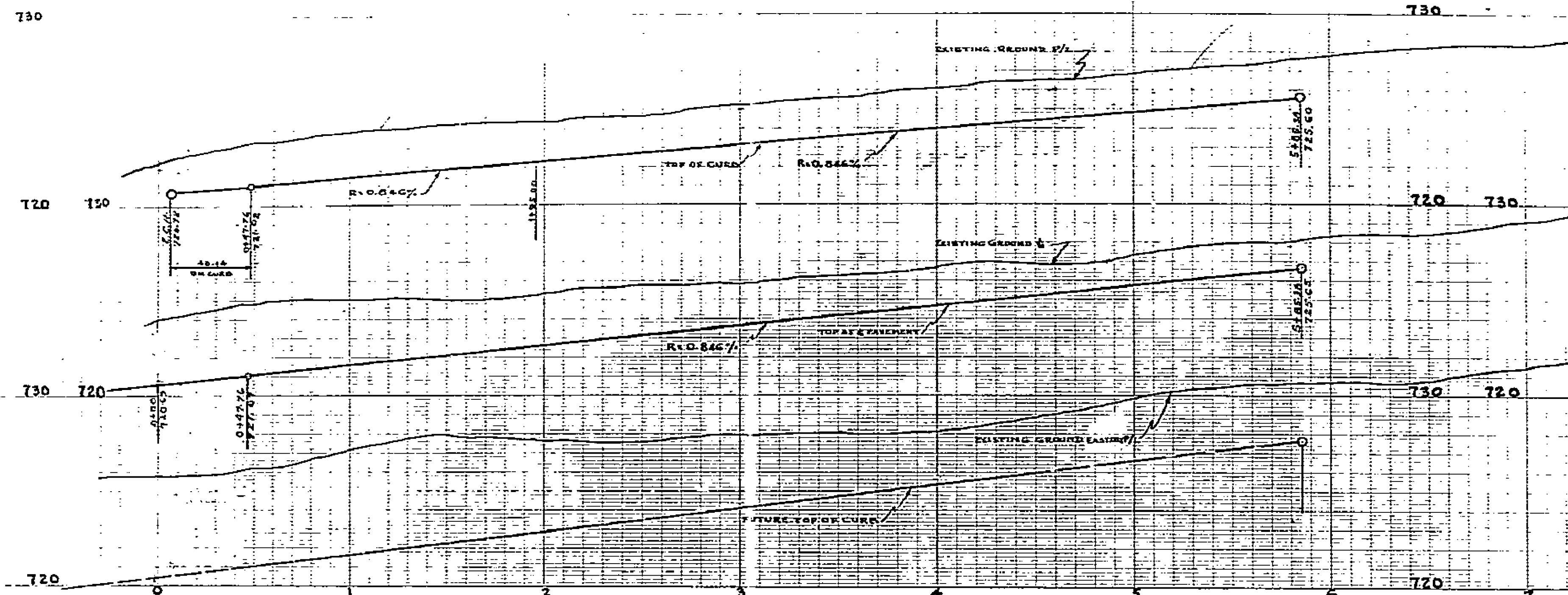

B.M. 5199 RIVERSIDE COUNTY ROAD DEPT. 50 1/2 W. N. 1/4 1/4 OF HOLY AVE. OR HOLY AVE. 5PK IN P.P. 5 CORNER 2 FEET ABOVE GROUND, ELEV. 713.13.

- NOTES:
- (1) ALL WHEN DONE SHALL CONFORM TO RIVERSIDE COUNTY ROAD DEPT. STANDARDS AND SPECIFICATIONS.
 - (2) IF DRIVEWAY DEPRESSIONS ARE MADE, DRIVEWAY APPROACH SHALL BE CONSIDERED A PART OF THIS PLAN AND SHALL BE CONSTRUCTED AS PER RIVERSIDE COUNTY STANDARDS.
 - (3) STATIONING REFERS TO 1/4 OF STREET.

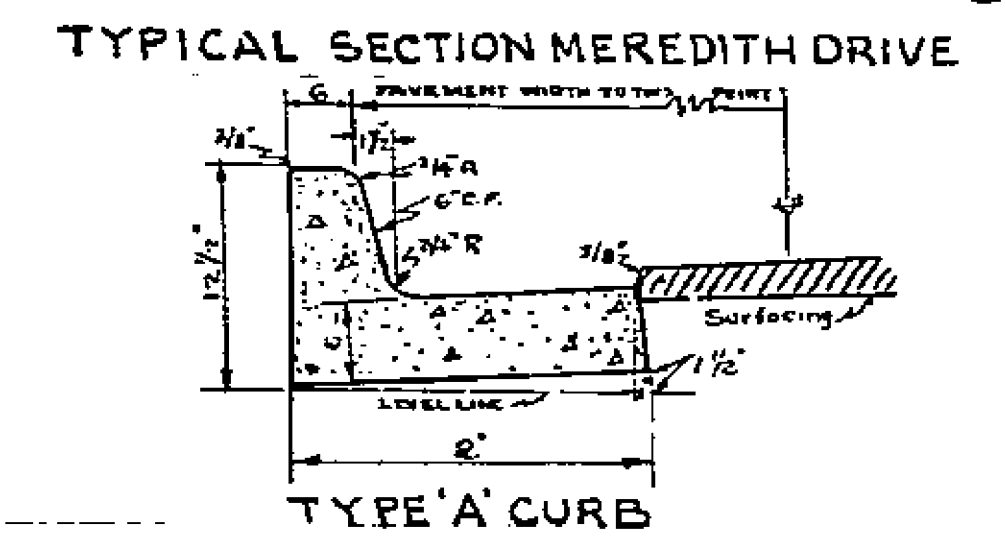
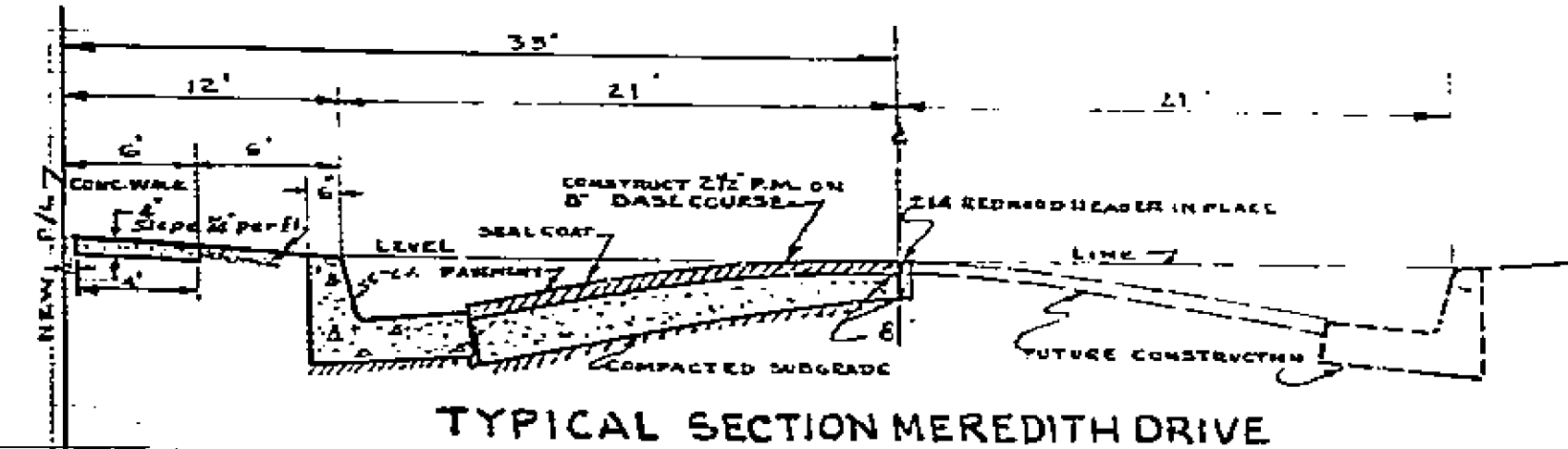

NOTE: WORK ON THESE PLANS ARE NOT FINAL UNLESS SIGNED BY RIVERSIDE COUNTY ROAD COMMISSIONER.
 WORK ON THIS STREET PLAN TO BE DONE ON ALTERNATE (A) IN TWO FROM STATION 0+42.00 TO 5+88.00 SPREAD PORTION ONLY.

SCALE HORIZ: 1"=40'
 VERT: 1"=4'

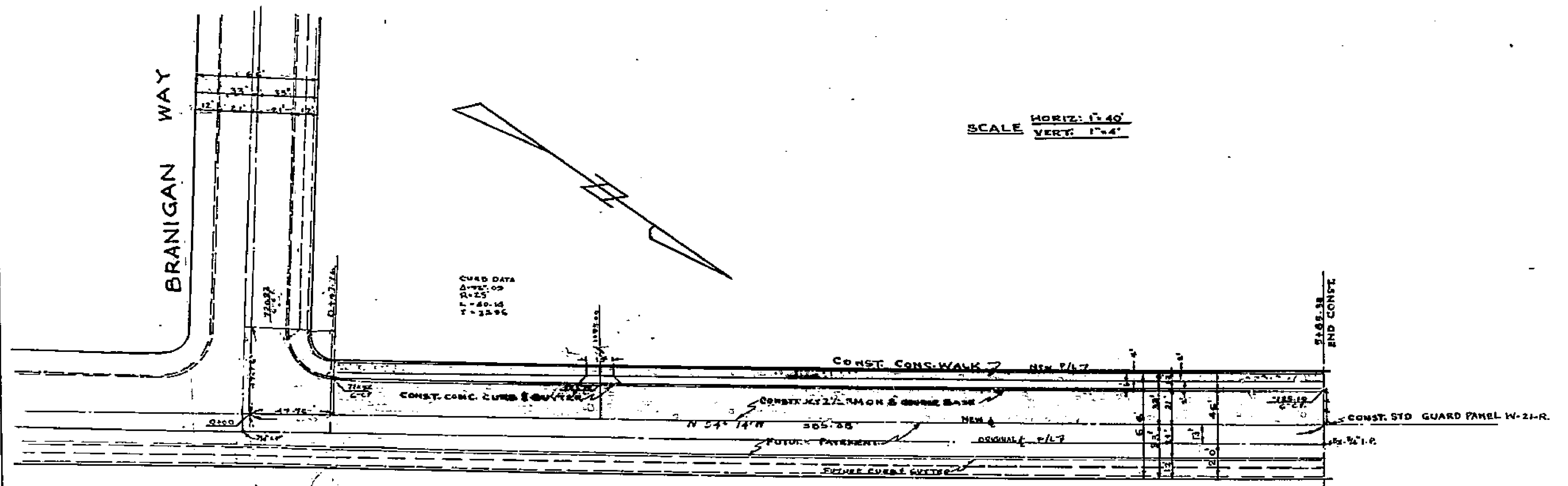

GRID DATA
 1-10-14
 1-10-14
 1-10-14

MEREDITH DRIVE

PROPERTY OF
 COUNTY OF RIVERSIDE
 1111 1/2 N. G Street, Riverside, California

Harold Gimeno, A.I.A.
 Member Engineers and Architects Institute
 1410 1/2 No. Main St. Bldg. 2000
 Santa Ana, California
Harold Gimeno

1703

REVISED DATE: JUNE 25 1956

STATE OF CALIFORNIA - DEPARTMENT OF PUBLIC WORKS
 DIVISION OF ARCHITECTURE
 14 & 30 APPROVED MAY 11 1956

PLANS, ALIGNMENT & PROFILE FOR STREET
 IMPROVEMENTS ON MEREDITH DRIVE
 FOR ALVARO SCHOOLS DISTRICT - ARLINGTON, CALIFORNIA.
 ENGINEER: *H. J. Noddy*
 R.E. 6380
 APPROVED: *H. D. Powell*
 COUNTY ROAD COMMISSIONER - RIVERSIDE COUNTY, CALIFORNIA.

JOB No.	5698
DATE:	5-14-56
DRAWN BY	M.C.S.
SHEET No.	(41)

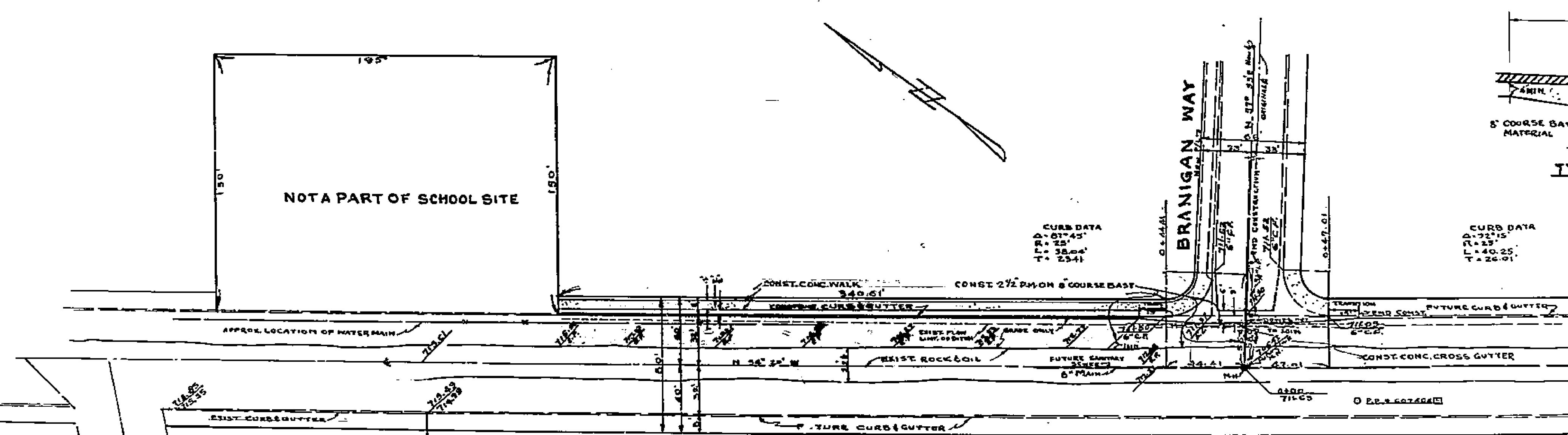
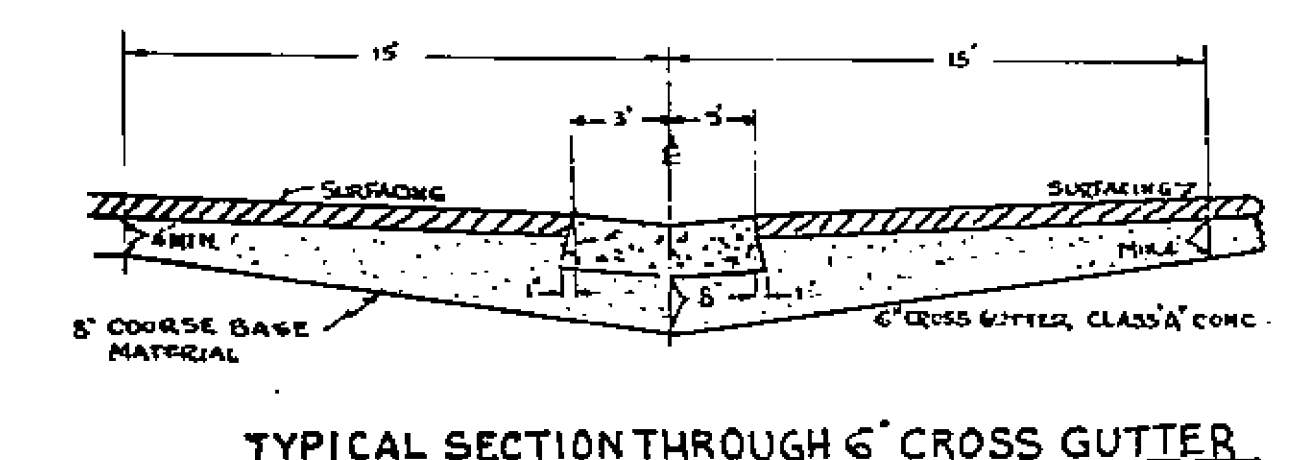
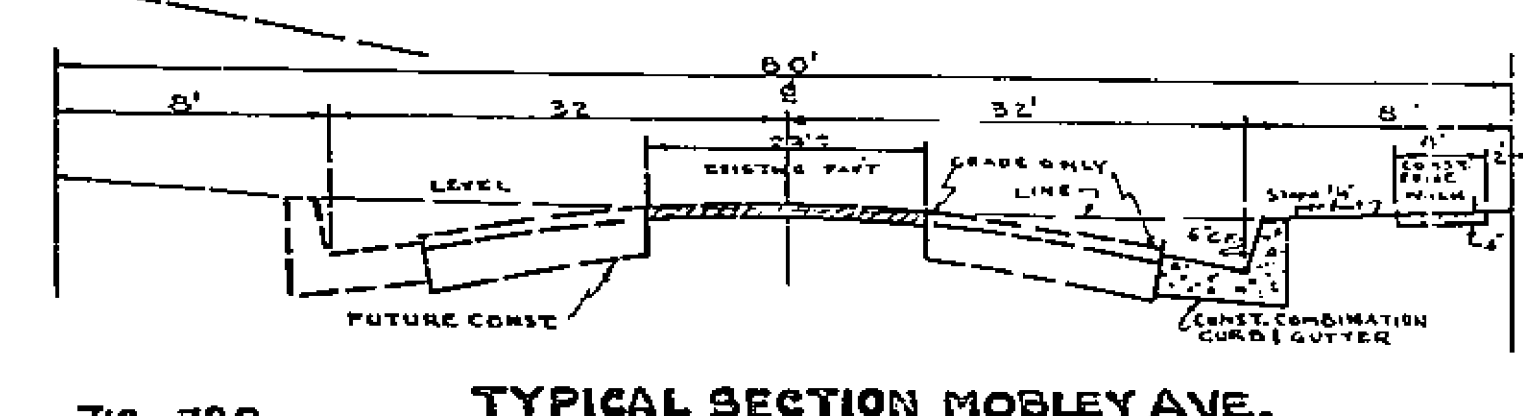
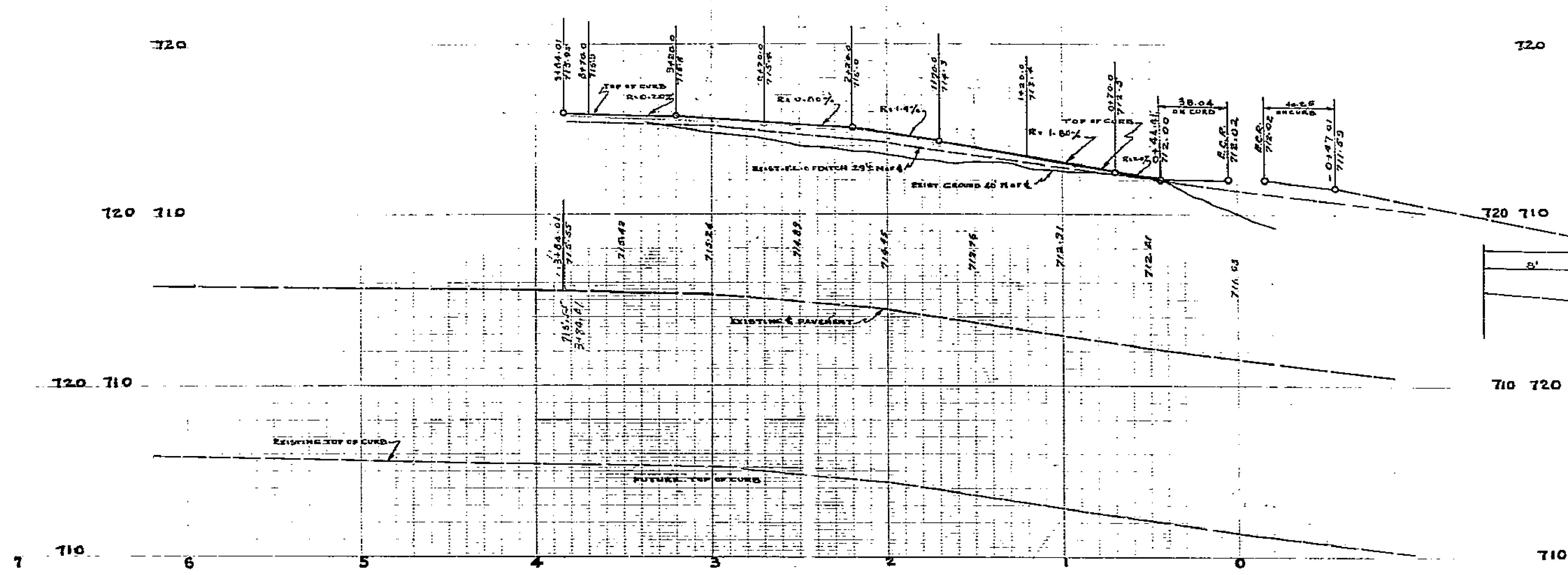

NOTE: WORK ON THESE PLANS ARE NOT FINAL UNLESS SIGNED BY RIVERSIDE COUNTY ROAD COMMISSIONER.
 WORK ON THIS STREET PLAN TO BE DONE ON ALTER-NATE (A) FOUR FROM STATION 0+42.04 TO 3+00.00 SHOWN FOR TION ONLY.

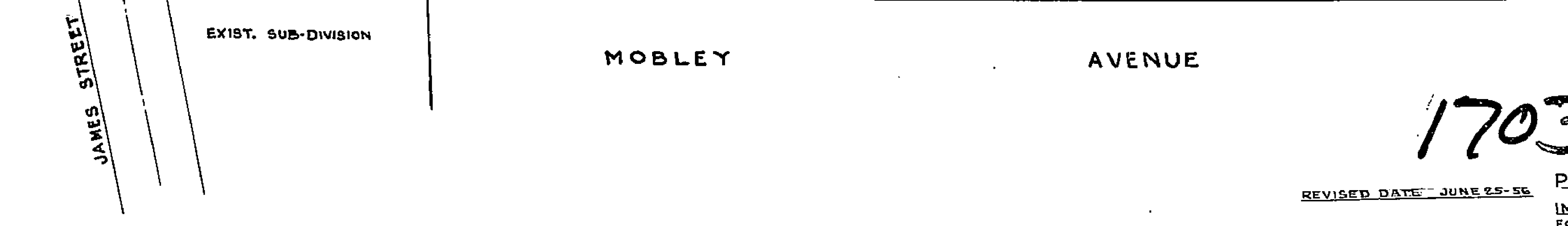

1703

REVISED DATE: JUNE 25-56
 14432 MAY 1955

PROPERTY OF
 COUNTY OF RIVERSIDE
 Office of the Road Commissioner

Harold Gimeno, A.I.A.
 Member Engineers and Architects Institute
 1416 So. Main St. Escondido 20000
 Santa Ana, California

PLANS, ALIGNMENT & PROFILE FOR STREET IMPROVEMENTS ON MOBLEY AVENUE FOR ALVORD SCHOOL DISTRICT, ARLINGTON, CALIFORNIA.

ENGINEER: *H. Gimeno*
 R.E. 2380
 APPROVED: *E. J. Smith*
 COUNTY ROAD COMMISSIONER RIVERSIDE COUNTY, CALIFORNIA

JOB No.	5 C O B
DATE	5 14 -56
DRAWN BY	
P. C. S.	
SHEET No.	42