

PLAN
 NOTES:
 1. REMOVE EXISTING CURB & GUTTERS
 2. CONSTRUCT NEW CURB & GUTTERS AS SHOWN
 3. SEE SPECIFICATIONS FOR DETAILS

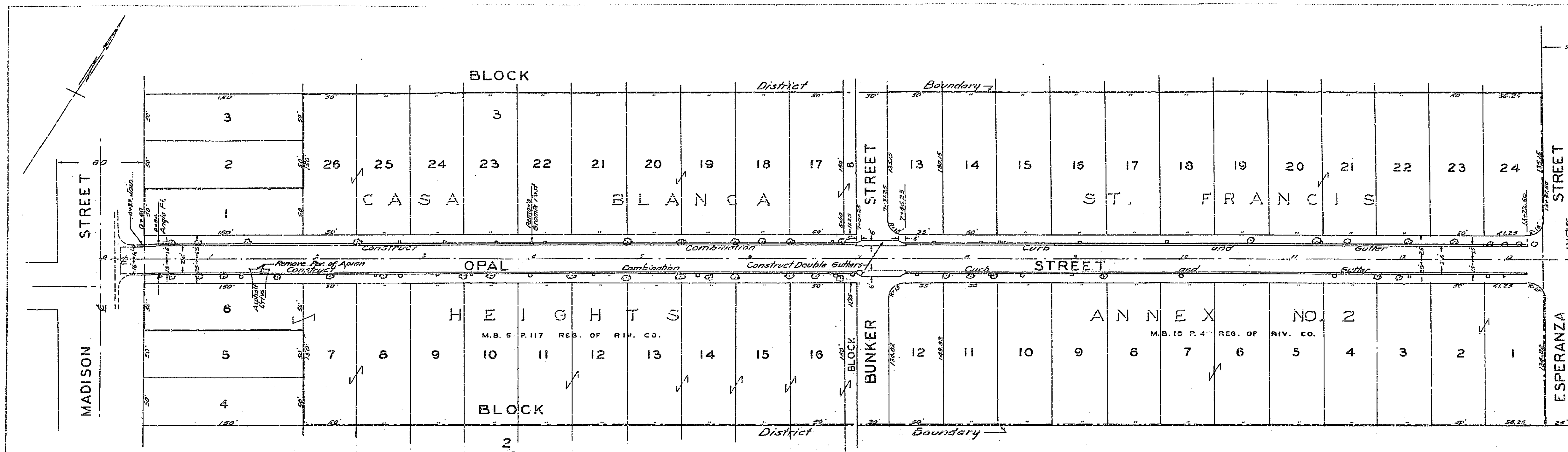

MARGUERITA AVENUE

PLAN AND PROFILE
 NO. 199
 FOR THE CONSTRUCTION OF
 CONCRETE CURBS & GUTTERS ON
 OPAL STREET
 CITY OF RIVERSIDE
 F.B. 513-24 MAY 1952

SCALES HOR. 1 IN. = 50 FT.
 VERT. 1 IN. = 5 FT.

APPROVED *M.H. Irvine*
 M.H. IRVINE, REG. C.E. NO. 3011
 CITY ENGINEER

THESE PLANS APPROVED AND ADOPTED
 BY THE MAYOR AND COUNCIL OF THE
 CITY OF RIVERSIDE, STATE OF CALIFORNIA,
 ON THIS 22ND DAY OF *May*, 1952.

W. J. ...
 CITY CLERK

PROFILE
 NOTES:
 1. SEE PLAN FOR LOCATION OF CURB & GUTTERS
 2. SEE SPECIFICATIONS FOR DETAILS

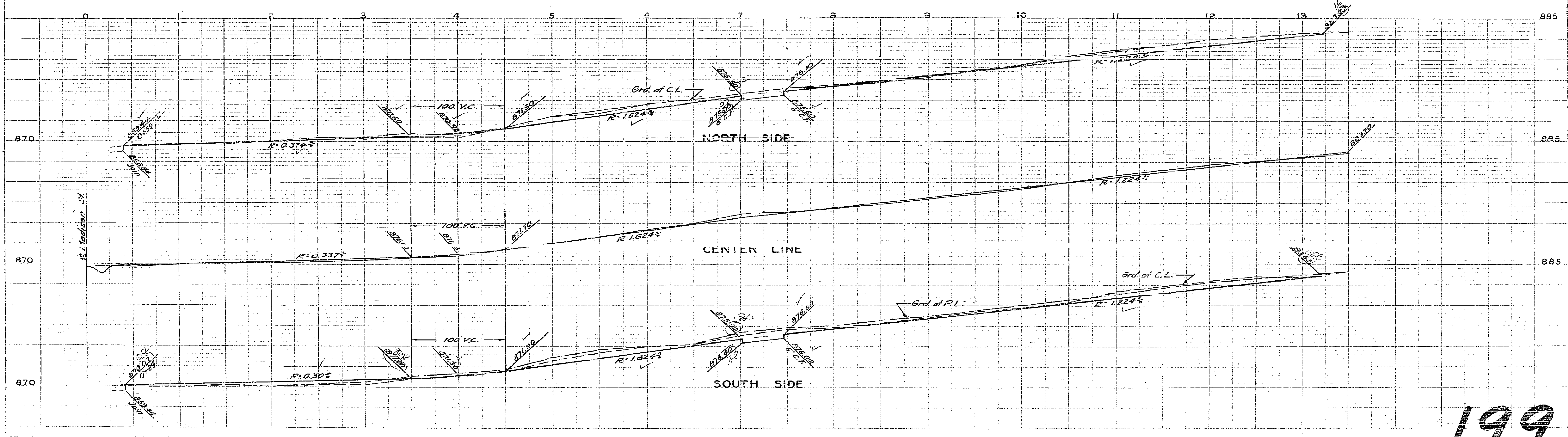

199