

EIGHTH STREET	
MARKET ST. TO PACHAPPA AVE.	
Drawing No.	Sheet No.
215	1
Plan Book	Field Book
348	348
Checked	Checked
W. E. M. C-22-37	

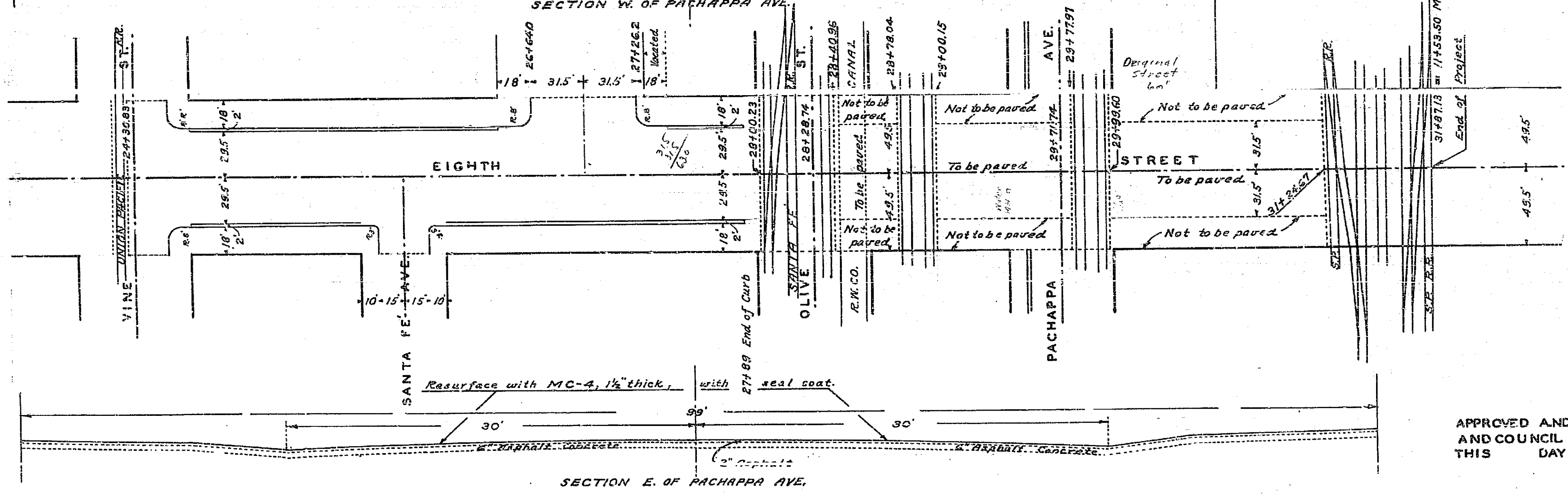
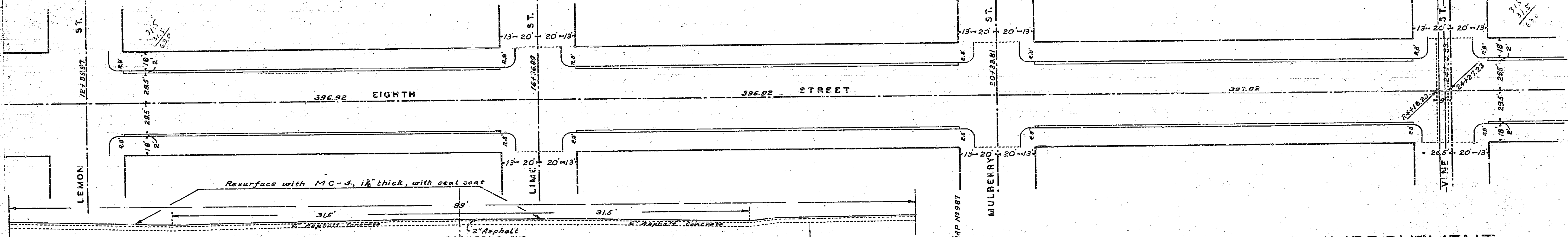
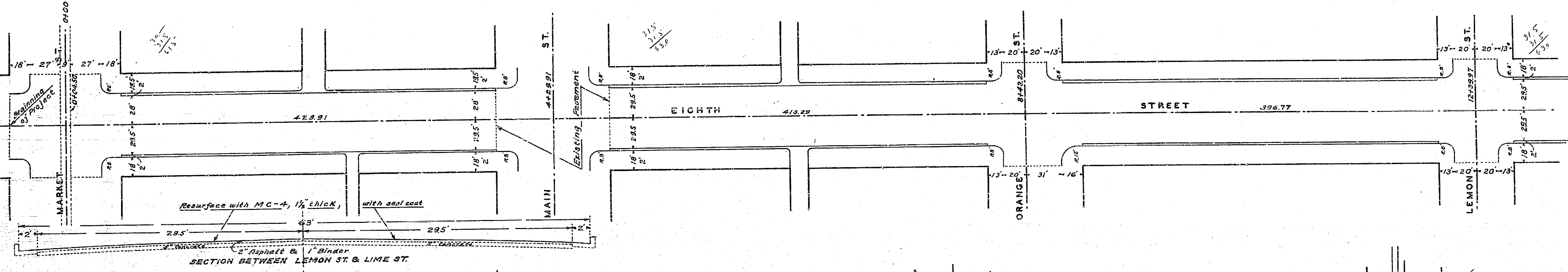
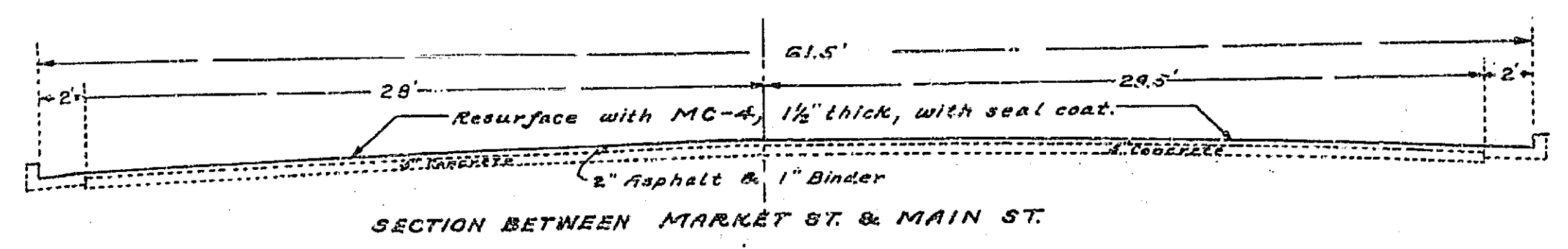

PROPOSED IMPROVEMENT  
ON  
EIGHTH STREET  
MARKET ST. TO PACHAPPA AVE.  
STATE HIGHWAY ROUTE NO. 19

ENGINEER DEPT. RIVERSIDE, CALIF. 1937.  
CITY (U.S.G.S.) DATUM PLANE  
FIELD BOOK 348 PAGES 2-15  
Plant Mix Surfaces By E. Yeager  
1937

SCALE 1" = 40'

APPROVED *[Signature]*  
CITY ENGINEER.

APPROVED AND ADOPTED BY THE MAYOR  
AND COUNCIL OF THE CITY OF RIVERSIDE.  
THIS DAY OF 1937.

CITY CLERK, CITY OF RIVERSIDE.

215

EIGHTH STREET		MARKET ST TO RACHARIA AVE.	
Drawing No.	Sheet No.	Total Sheets	Field Book
R.15	2	2	348
Plotted		Checked	
C.P.E. No. 8-3-37			
Revision 10/6/37			
BK 355 Pp. 79			

*1.5% slope  
43 2 1/2 ft. high in place*

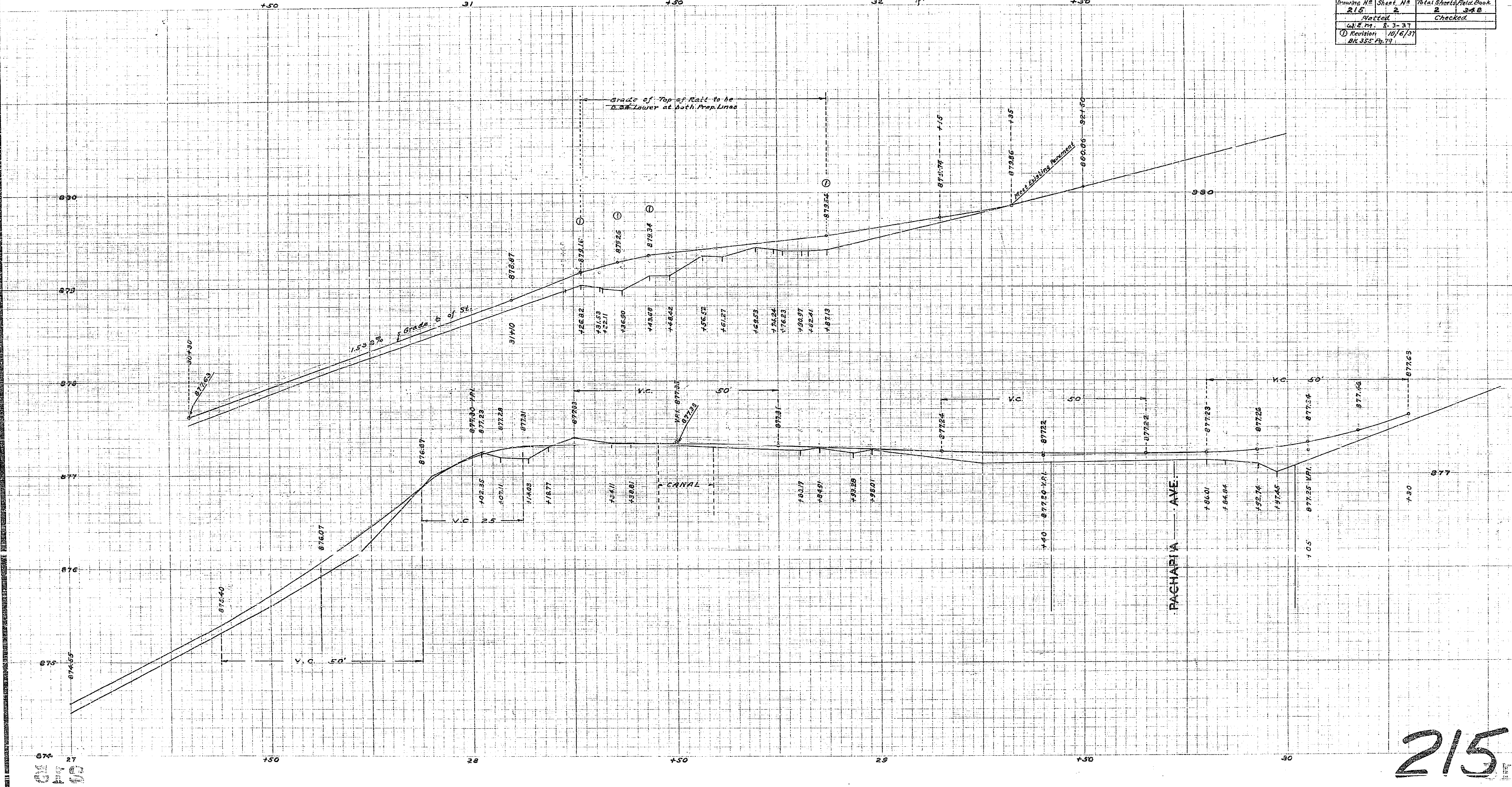

215