

Lincoln Ave. Storm Drain			
Drawing Number	Sheet Number	Total Sheet	Total Books
219-A	1	1	174, 249
Drawn	Checked	Approved	
Mar. 31, 1941	W.L.		

PROFILE
SCALE VER. 1"=4'
HOR. 1"=100'

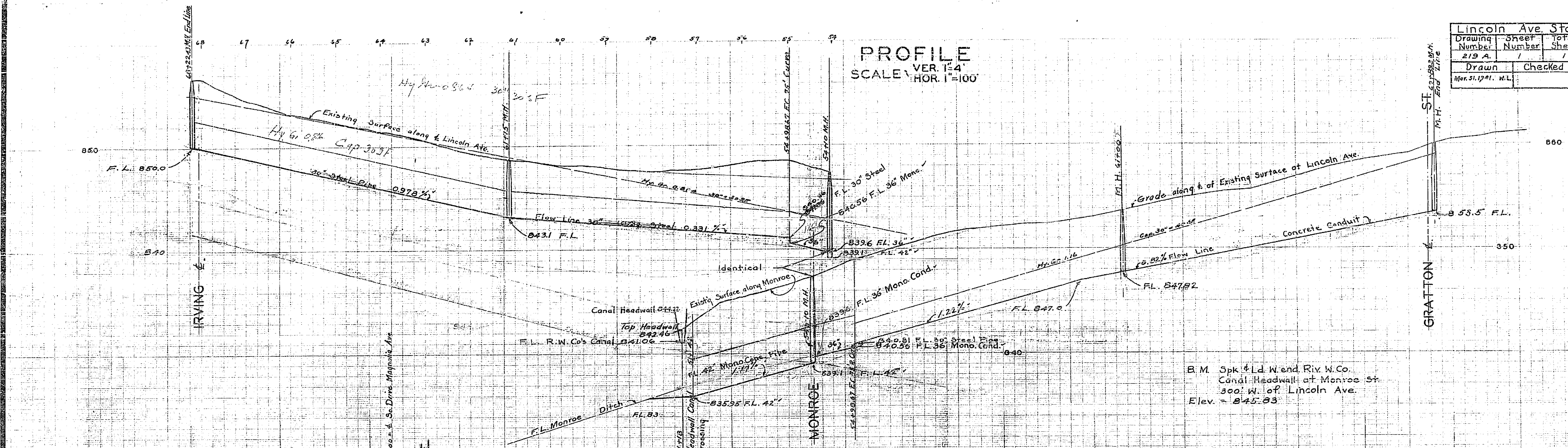

PLAN
SCALE 1"=100'

PLAN AND PROFILE OF THE PROPOSED STORM DRAIN ON LINCOLN AVENUE BETWEEN IRVING ST. & GRATTON ST.

ENGINEERING DEPT. RIVERSIDE CALIF. 1941.

APPROVED _____
CITY ENGINEER
REGISTERED ENGINEER NO. 1312

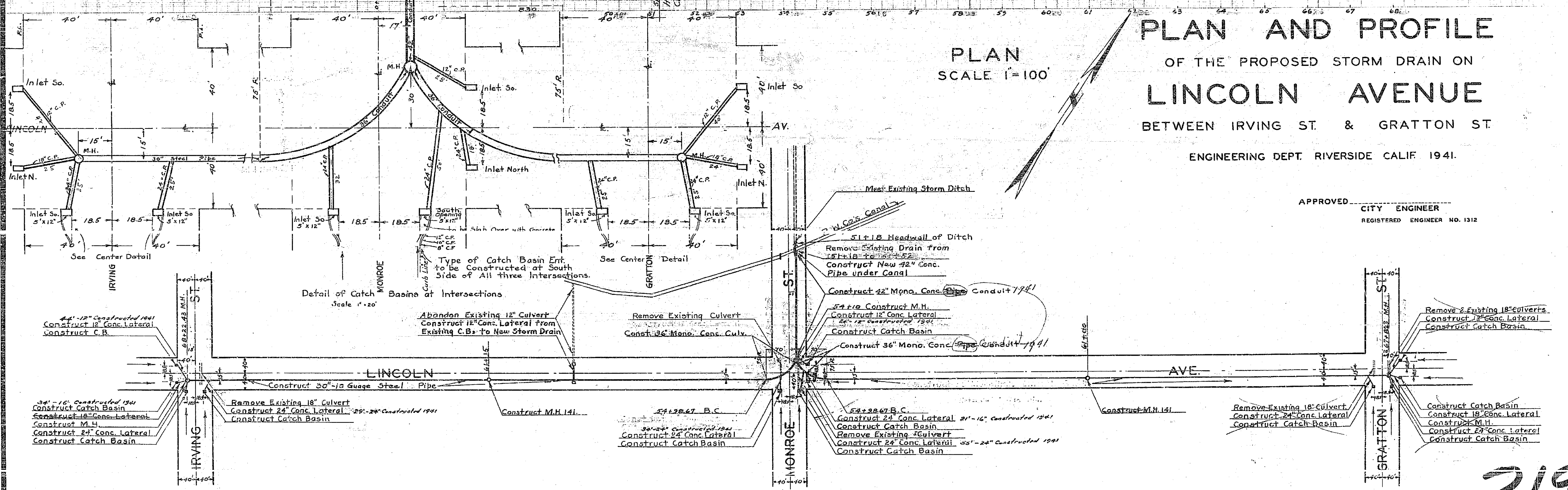

219-A