

PLAN AND PROFILE

OF THE PROPOSED IMPROVEMENT OF

KANSAS AVENUE

BETWEEN FIFTH ST. & BLAINE ST.

ENG. DEPT. CITY OF RIVERSIDE 1935.

CITY (U.S.G.S.) DATUM PLANE *Quads 229/28*

FIELD BOOK 208 PAGES 1 2 60

Constructed by Street Dept 1935

See Tracing No 227-B

APPROVED AND ADOPTED BY THE MAYOR
AND COUNCIL OF THE CITY OF RIVERSIDE
THIS 4TH DAY OF JUNE 1935.

Street Comm
CITY CLERK. CITY OF RIVERSIDE.

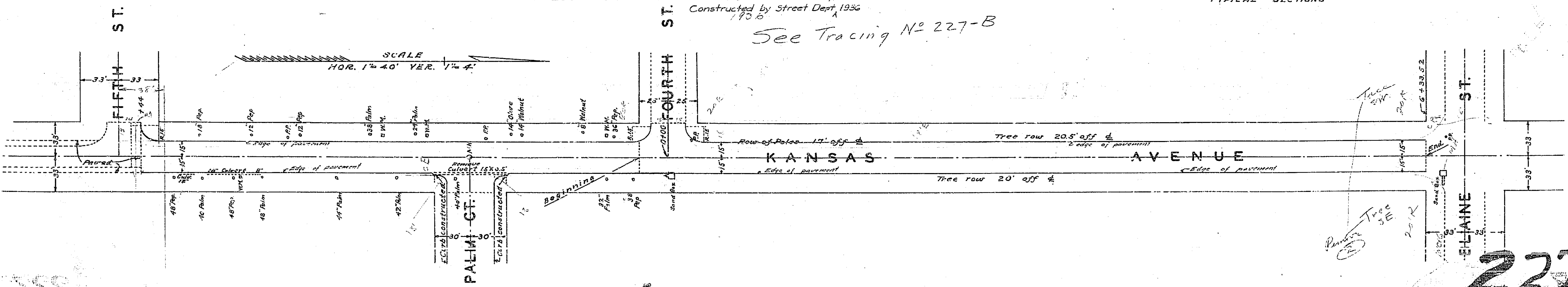
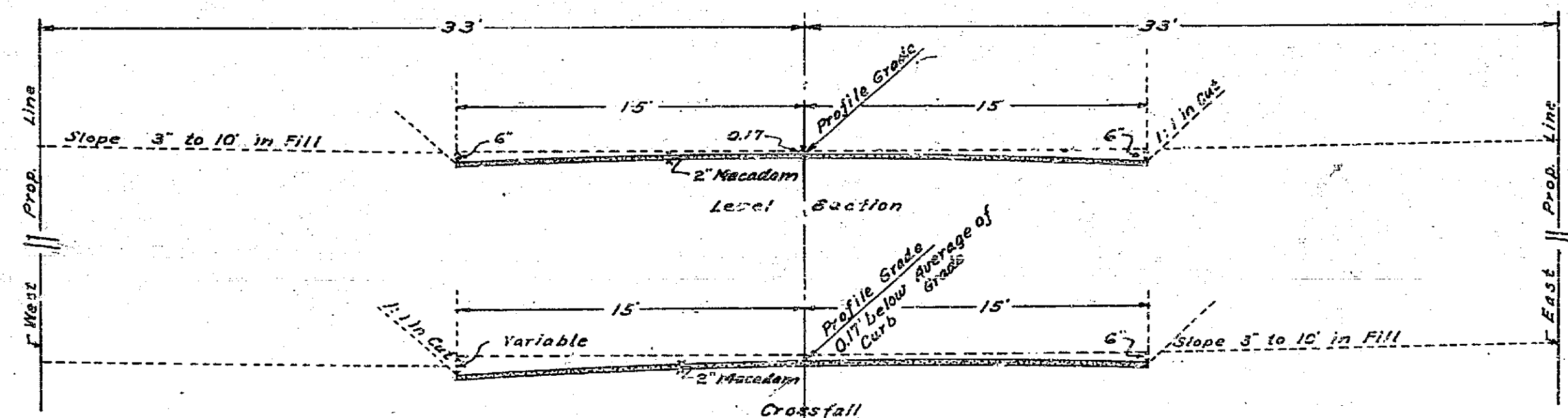

227-A