

PLAN AND PROFILE
 NO. 229
 FOR THE CONSTRUCTION OF SANITARY SEWER IN
GRAND AVENUE
 BETWEEN RUBIDOUX AVENUE AND BANDINI AVENUE
 AND IN
CHARLOTTE WAY
 RIVERSIDE, CALIFORNIA

APPROVED: *M. H. Irvine*
 M.H. IRVINE, REG. C.E. NO. 301
 CITY ENGINEER

THESE PLANS APPROVED AND ADOPTED BY THE
 MAYOR AND COUNCIL OF THE CITY OF RIVERSIDE,
 STATE OF CALIFORNIA ON THIS
 DAY OF _____ 1950

 CITY CLERK

F.E. 459, PG. 00-07

SCALE: HORIZ. 1"=100'
 VERT. 1"=5'

Y Locations
 inspectors cards in black leather
 folder
 and PB 499/35

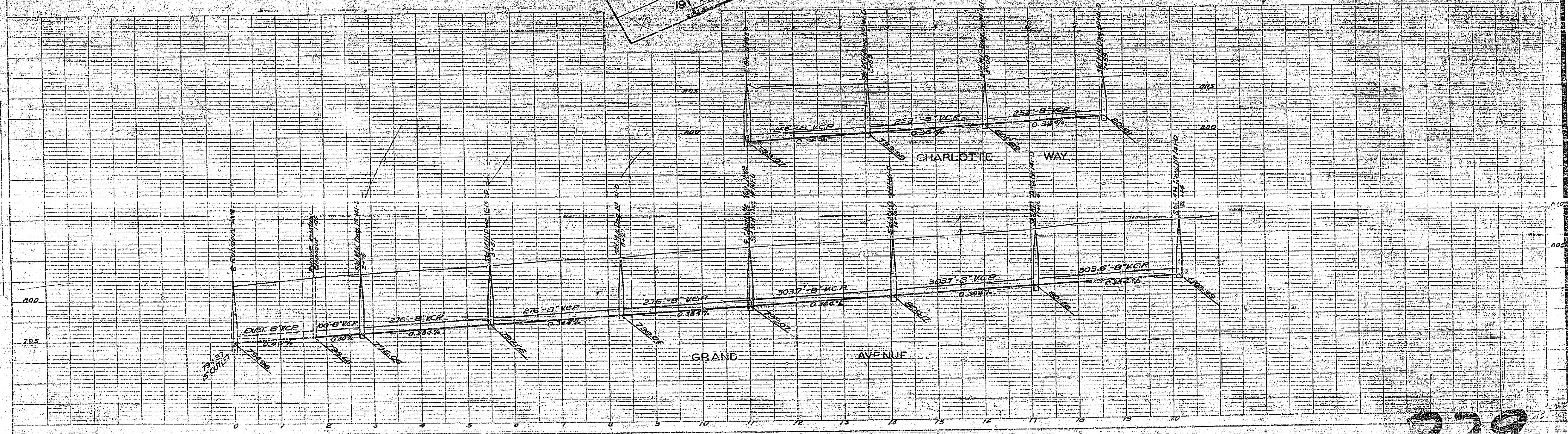
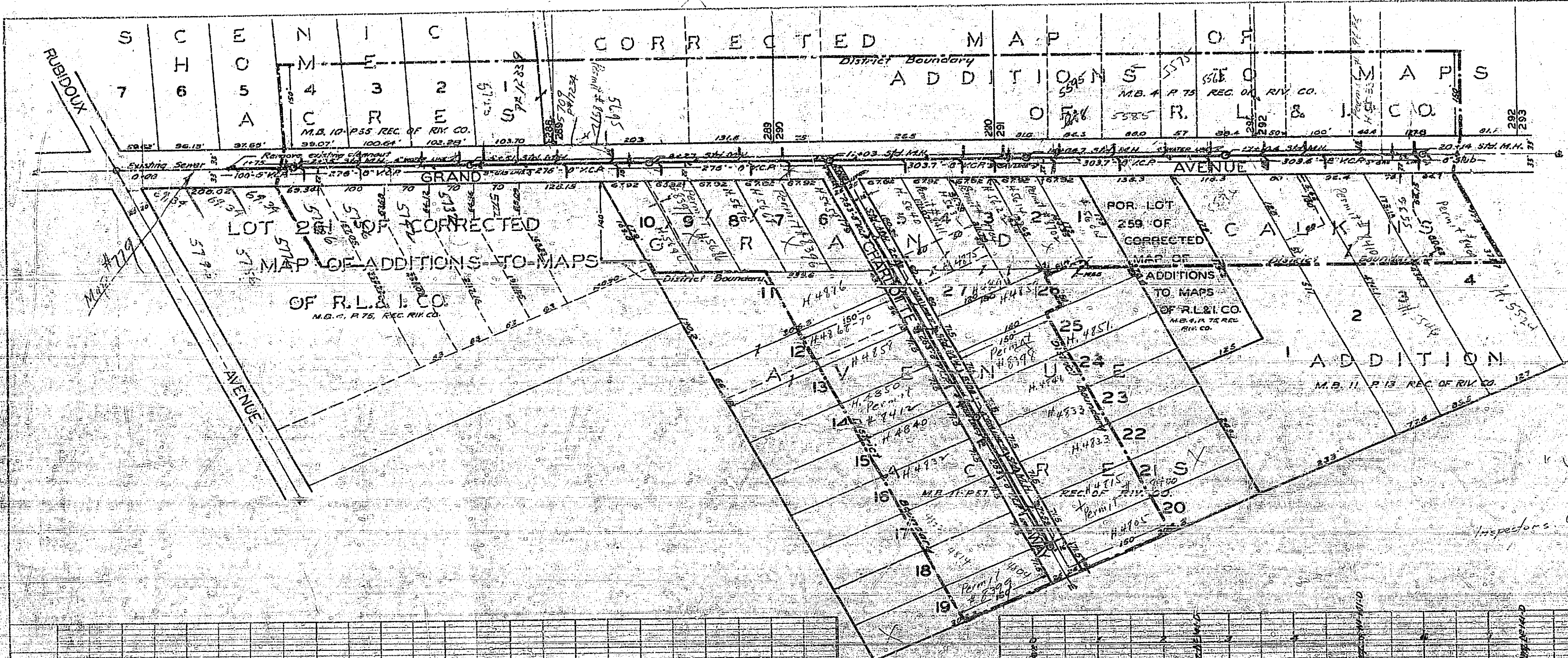

229