

CITY OF RIVERSIDE ENG. DEPT.
 PLAN AND PROFILE OF
RUDICILL STREET
 FROM VAN BUREN ST. TO MYERS ST.

SCALE 1"=40'

APPROVED *[Signature]*
 CITY ENGINEER.
Const. by St. Dept. 1935

ADOPTED BY THE MAYOR AND COUNCIL OF THE CITY
 OF RIVERSIDE THIS 11th DAY OF JUNE 1935.
[Signature]
 CITY CLERK.

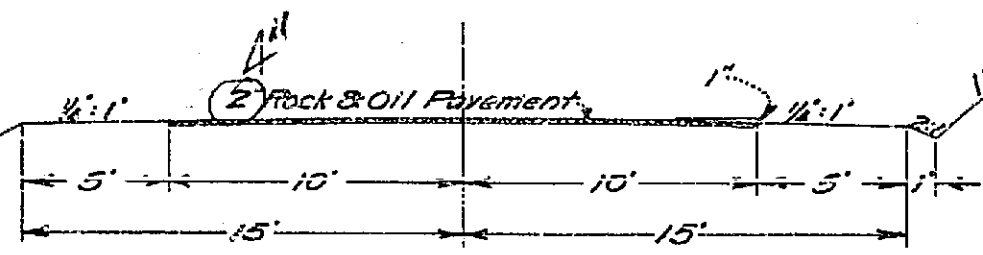
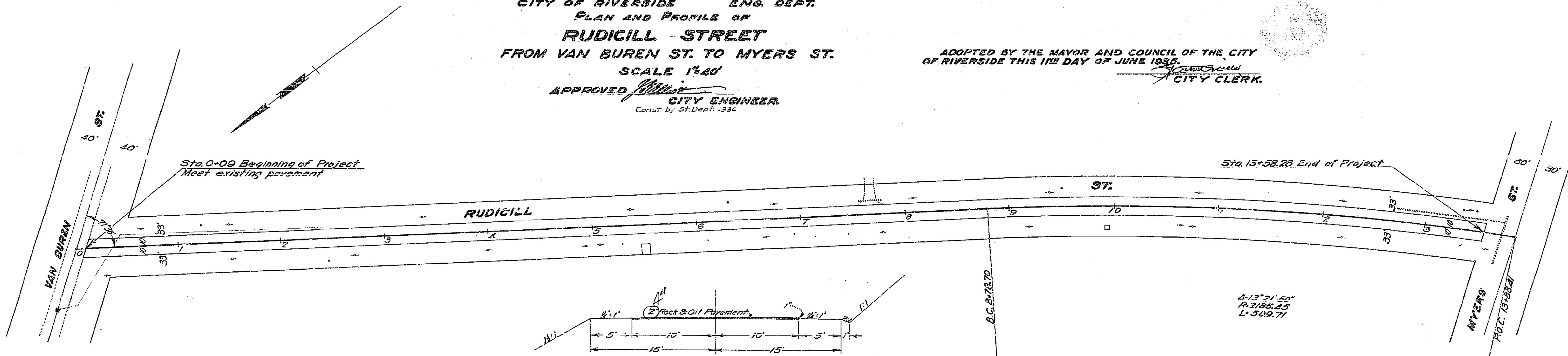

Δ-13°21'50"
 R-2185.45
 L-509.71

254-B