

PROFILE
 NORTH MARKET STREET
 BETWEEN
 HENRY ST & R.R. TRACKS
 ENGINEERING DEPT. - CITY OF RIVERSIDE
 P.B. 265, Pg. 53 OCTOBER, 1932
 Surveyed By Butler
 Plotted By Wright
 Datum: Plans - M.S.C.R.
 So. Calif. Preliminary Adjustment of 17"

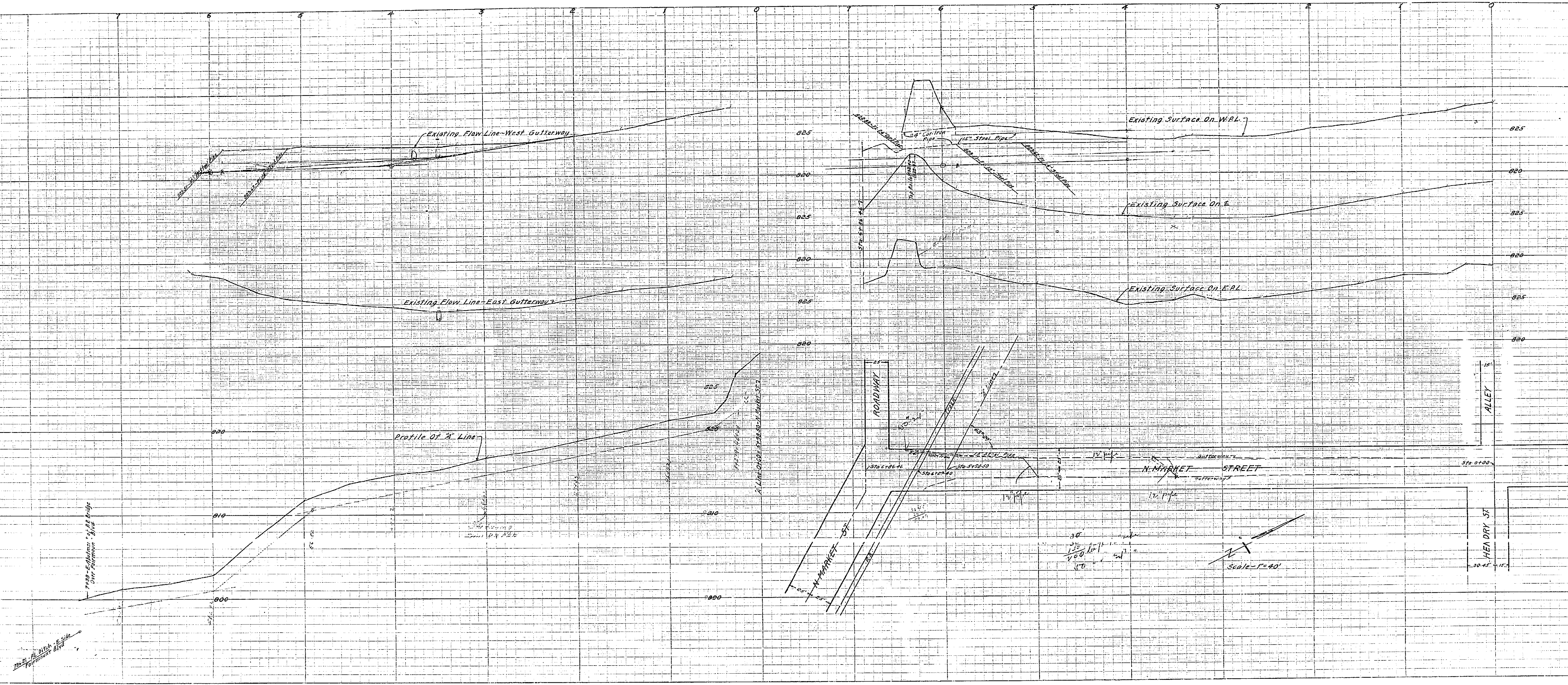

255-A