

SEWER
for
GAYLAN CITRUS ASSN.

(Permit by resolution of City Council
April 13, 1943 for construction as a
private line)

Line parallels d of Rudicill St and is
25' off on South of d . (Sewer BK 4, Pp. 32)

391/47

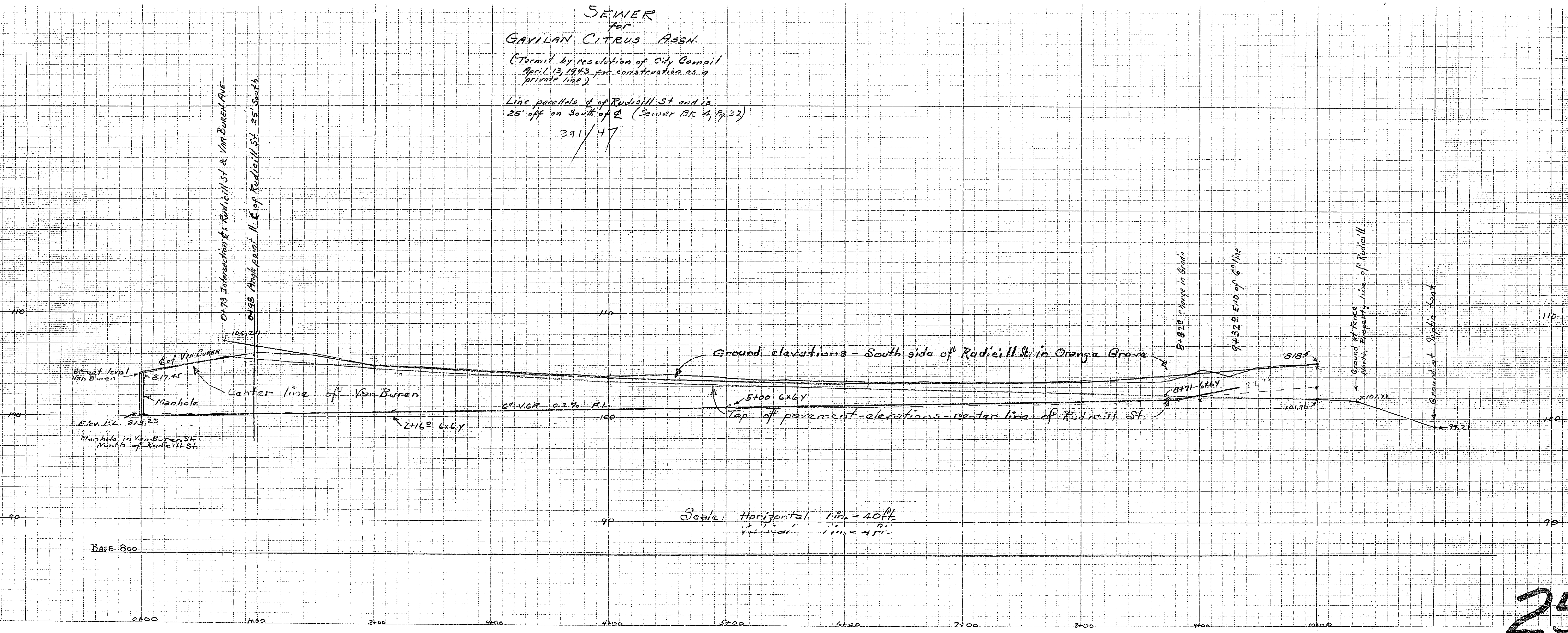

Scale: Horizontal 1 in. = 40 ft.
Vertical 1 in. = 4 ft.

258-1