

PALM AVENUE BANDINI AV. TO OAKWOOD PL.			
Drawing Number	Sheet	Total Sheets	Book
268	13	1	
Drawn by	Checked	Approved	

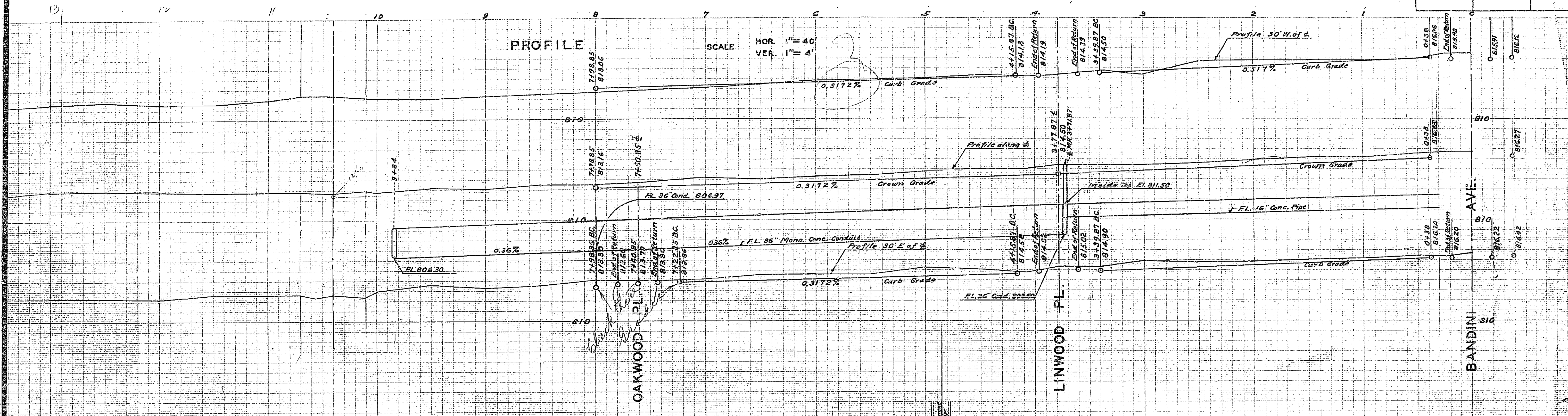

## PLAN AND PROFILE OF THE PROPOSED IMPROVEMENT ON PALM AVENUE BANDINI AVE. TO OAKWOOD PL.

ENGINEER DEPT. RIVERSIDE CALIF. 1940.  
CITY (U.S.G.S.) DATUM PLANE  
FIELD BOOK 231 PAGES 51 - 62

SCALE 1"=40'

APPROVED \_\_\_\_\_  
CITY ENGINEER,  
REG. ENG. 1312

APPROVED AND ADOPTED BY THE MAYOR  
AND COUNCIL OF THE CITY OF RIVERSIDE  
THIS \_\_\_\_\_ DAY OF \_\_\_\_\_ 1940.

\_\_\_\_\_  
CITY CLERK, CITY OF RIVERSIDE.

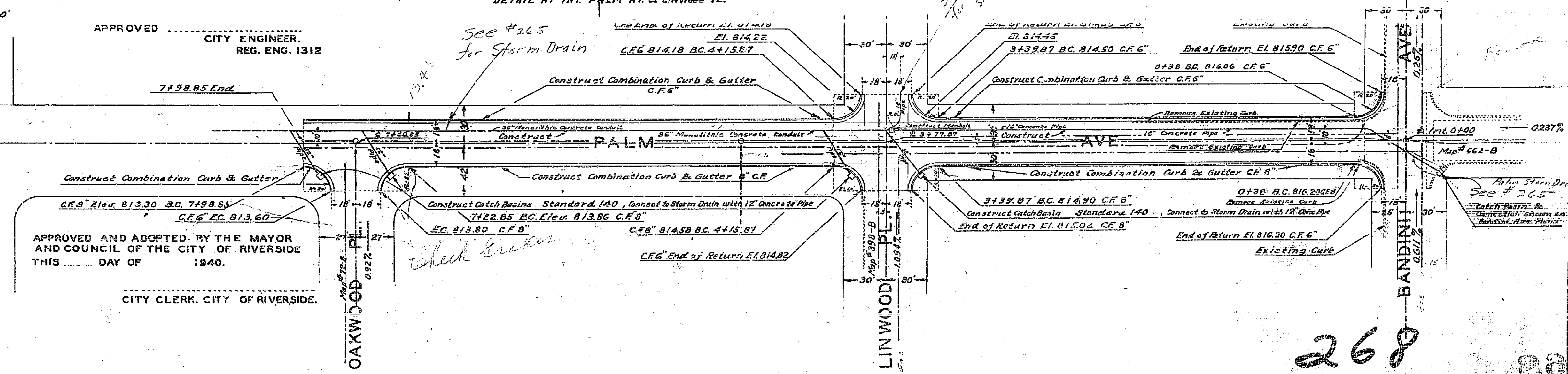
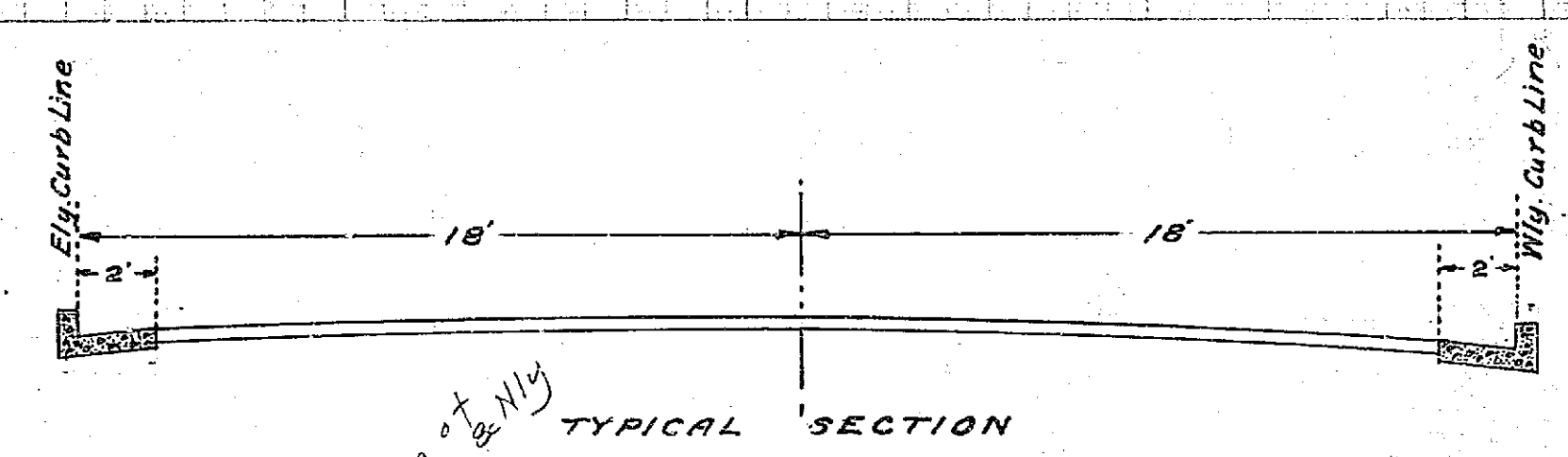
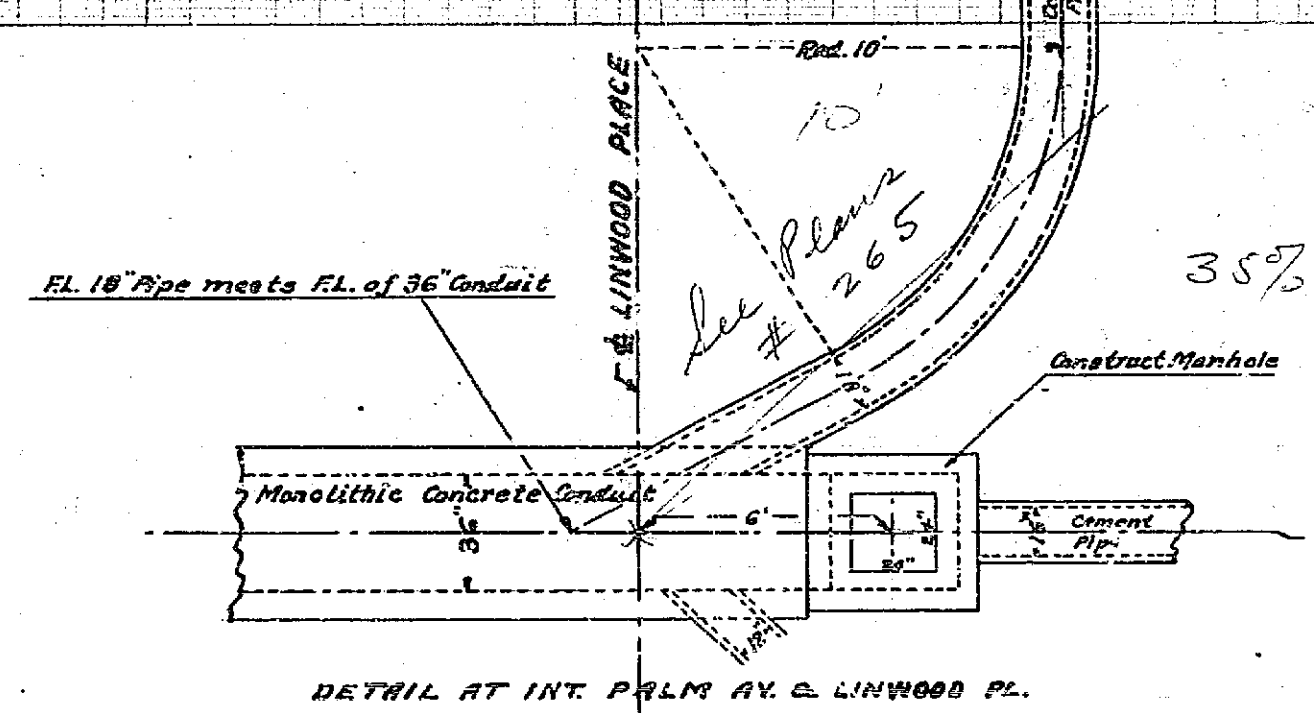

268