

MAP SHOWING PROPOSED
 INSTALLATION OF
 ELECTRIC LIGHTS
 ON
 FAIRFAX AVE
 RIVERSIDE CALIF.
 A.P. Campbell, City Engineer. Sept. 1913

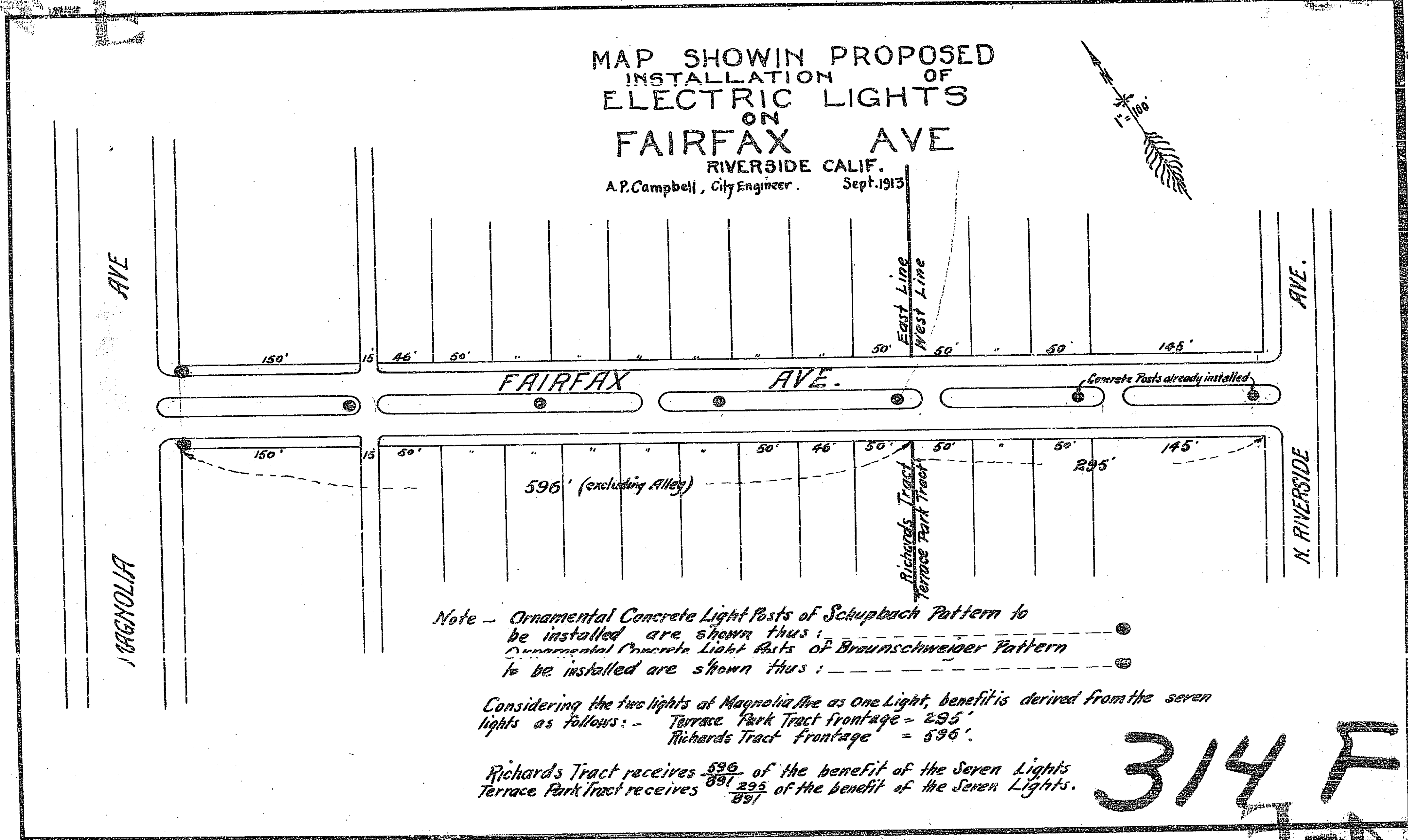
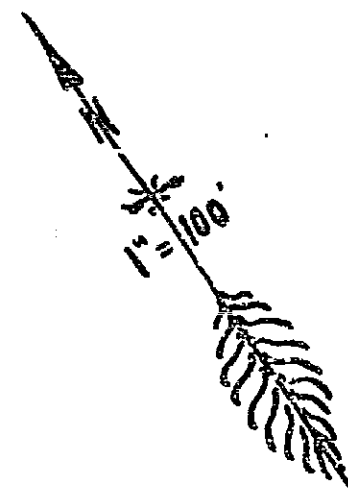
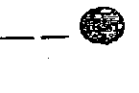
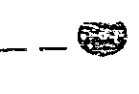

Note - Ornamental Concrete Light Posts of Schupbach Pattern to be installed are shown thus: 
 Ornamental Concrete Light Posts of Braunschweiger Pattern to be installed are shown thus: 

Considering the two lights at Magnolia Ave as One Light, benefit is derived from the seven lights as follows: - Terrace Park Tract frontage = 295'
 Richards Tract frontage = 596'

Richards Tract receives $\frac{596}{891}$ of the benefit of the Seven Lights
 Terrace Park Tract receives $\frac{295}{891}$ of the benefit of the Seven Lights.

314 F