

3171

EXHIBIT "B"

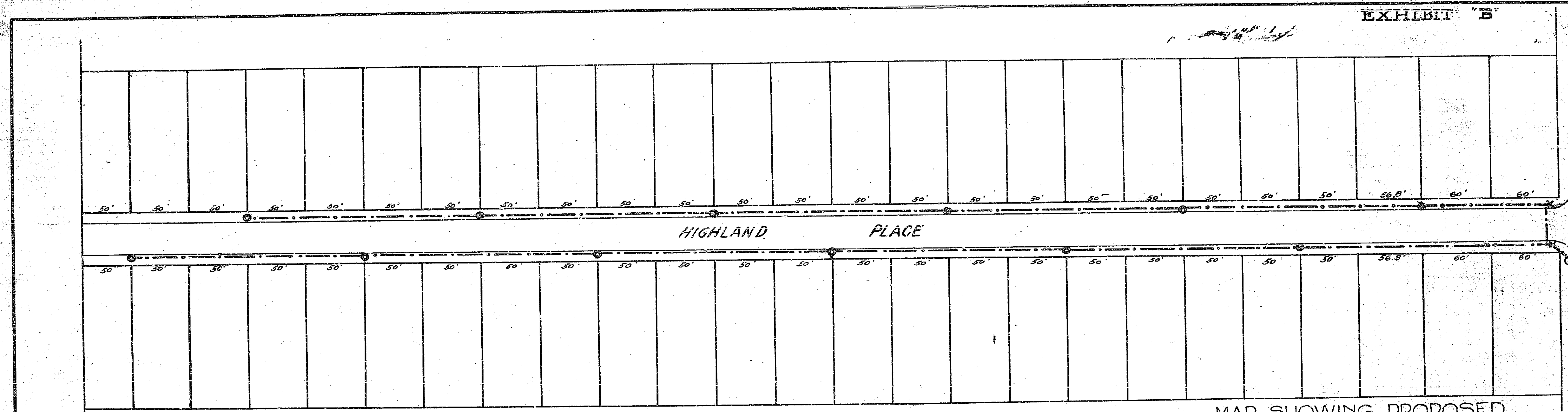

Note -
 Concrete light standards, four lamp design to be installed are shown thus: x
 Concrete light standards, one lamp design to be installed are shown thus: o
 Conduit to be laid is shown thus: ————
 Poles where boxes will be located are shown thus: ————

C 5 67



(card)

MAP SHOWING PROPOSED
 ORNAMENTAL ELECTRIC LIGHTING SYSTEM
 TO BE INSTALLED ON
 HIGHLAND PLACE

1916
 A. P. CAMPBELL, CITY ENGINEER

418

3141

418