

30 E

35

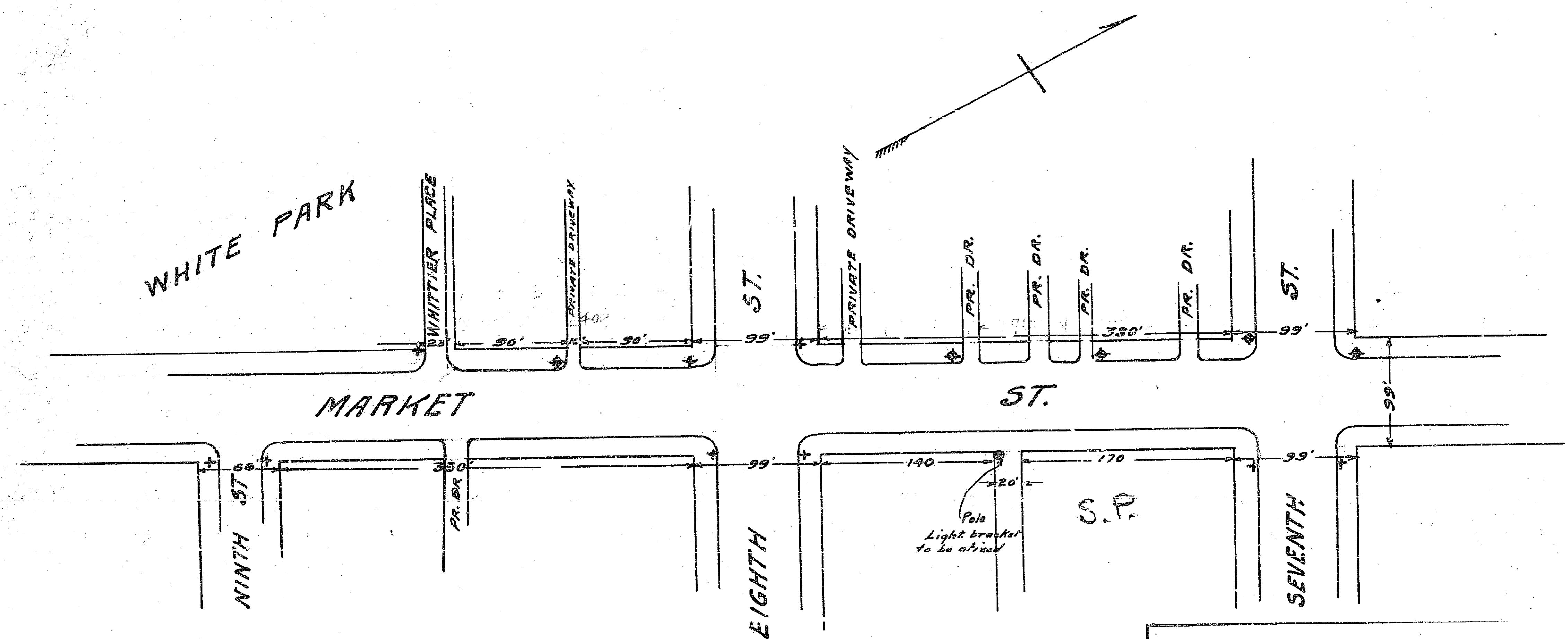

Note: Posts now in are shown thus +
 " to be placed " " " ⊕

5 posts to be placed
 1-bracket 3-light to be " as shown-

CITY OF RIVERSIDE
MAP
 Showing proposed location of Concrete three-light
 Posts, Conduit system & connecting lead lines on
MARKET ST. between 7TH & 9TH ST.
 Scale 1" = 100 Ft.
 A.P. Campbell
 City Engineer
 4/17/13

320 F

30