

PLAN & PROFILE  
NO. 342

FOR THE CONSTRUCTION OF A  
SANITARY SEWER IN THE

MISSION STREET  
SANITARY SEWER DISTRICT

CITY OF RIVERSIDE - CALIFORNIA

FB. 367/70 SCALES HORIZ 1"=50'  
VERT 1"=5'

APPROVED *M. H. Deering*  
CITY ENGINEER

THESE PLANS APPROVED AND ADOPTED BY THE  
BOARD AND COUNCIL OF THE CITY OF RIVERSIDE,  
STATE OF CALIFORNIA, ON THIS 21st DAY OF  
FEBRUARY, 1953.  
*William J. ...*  
CITY CLERK

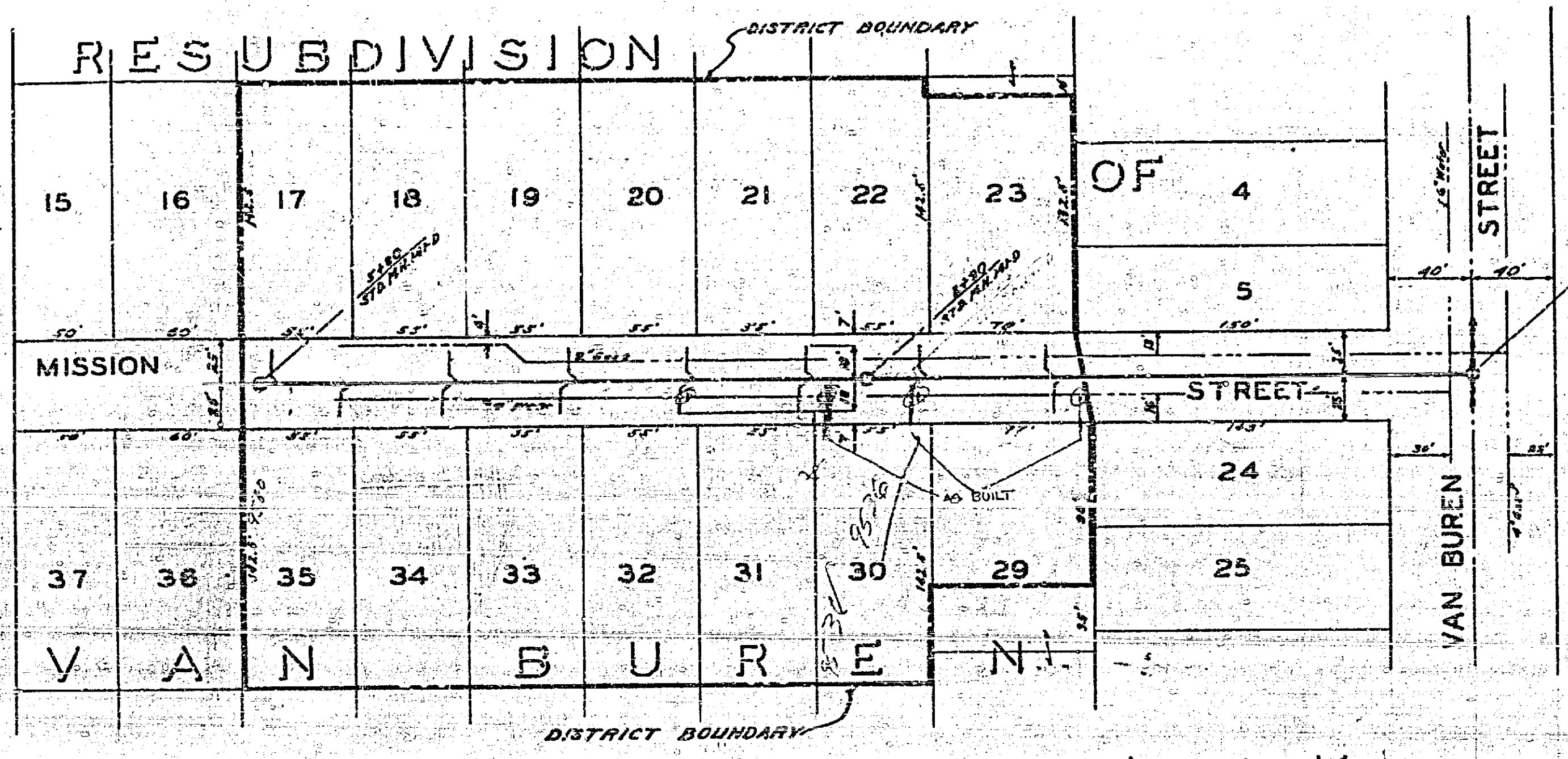

|              |      |     |
|--------------|------|-----|
| PLAN         | DATE | BY  |
| DATE CHECKED | BY   | NO. |
| REVISIONS    |      |     |

|              |      |     |
|--------------|------|-----|
| PROFILE      | DATE | BY  |
| DATE CHECKED | BY   | NO. |
| REVISIONS    |      |     |

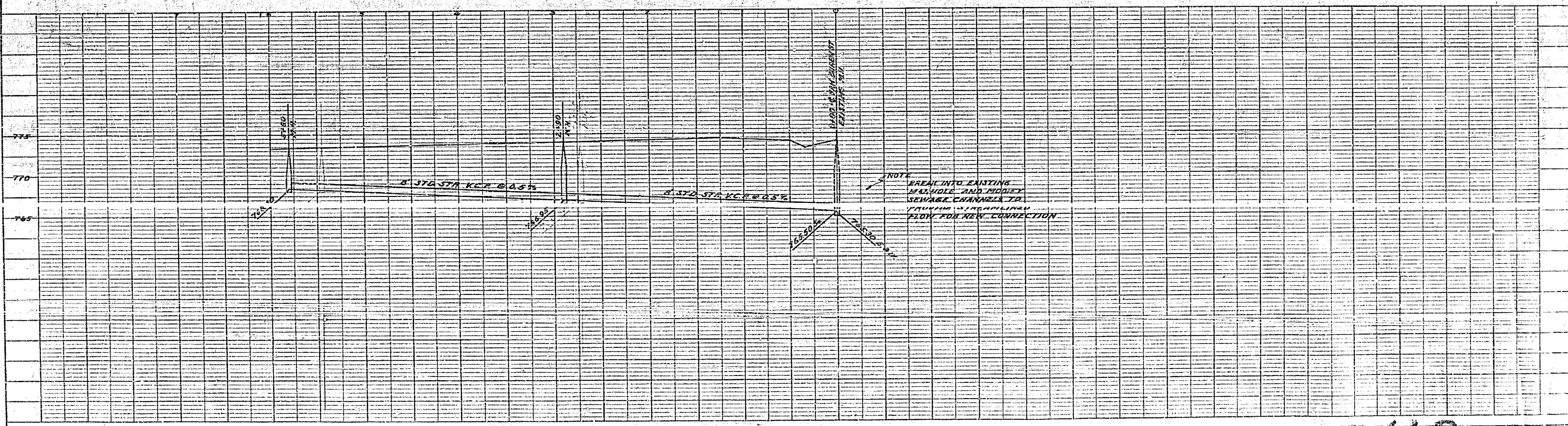

342 3/12/52