

PLAN No. 344-C  
 GRADE FOR CURBS & GUTTERS  
 ON  
**TERRACINA DRIVE**  
 RIVERSIDE, CALIFORNIA  
 Oct. 1954

APPROVED:  
 M. H. IRVING - Reg. C.E. #3011  
 CITY ENGINEER

F.B. 564-1

Scales: Hor. 1" = 50'  
 Vert. 1" = 5'

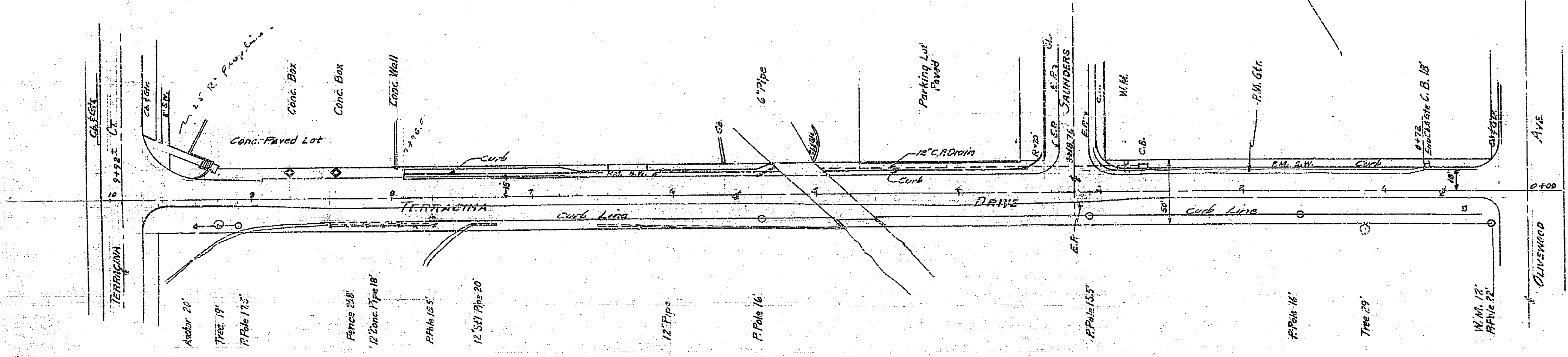

B.M. EL. 808.14 Spike in P. Pole Opp. Saunders on S.W. Side of Terracina  
 F.B. 522-63

B.M. Spike in pole on S. Side Terracina opp. Saunders  
 El. = 808.14

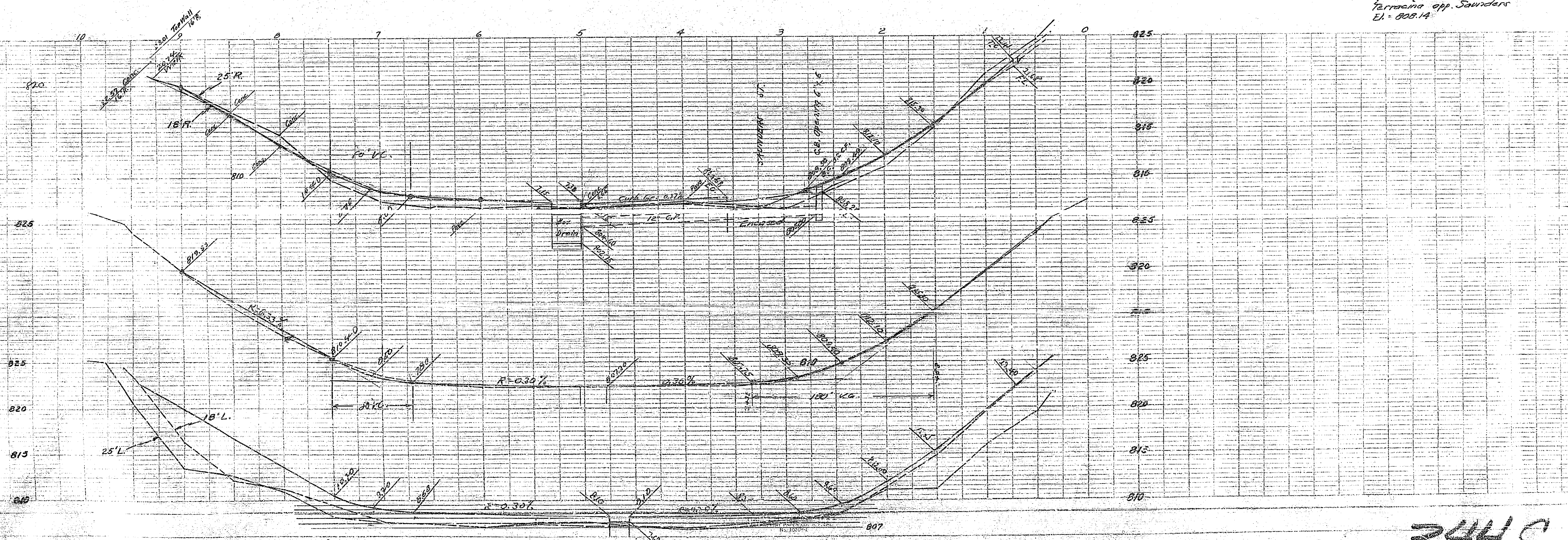

F.B. 564-1 **344C**

