

City of the  
**GRANT SUBURB DRAINAGE SEWER**

DISTRICT BENEFITED BOUND BY A GREEN LINE THUS--  
 DRAINAGE SEWER TO BE CONSTRUCTED IN ACCORDANCE WITH SPECIFICATIONS NO. 16 FOR THE  
 CONSTRUCTION OF PIPE SEWERS IN THE CITY OF KANSAS CITY, MO. AS ADOPTED BY THE BOARD OF TRUSTEES  
 OF SAID CITY AT ITS MEETING OF SEP. 23, 1913 SHOWN BY A BLUE LINE THIS:

Approved by the Mayor and  
 Council of the City of  
 Kansas City, Mo., this 10th day of  
 March, 1914.  
 Mayor  
 Council

SCALE OF MAP, 1 IN. = 200 FT.

See Book 4, Page 27, for description of  
 street and lots.

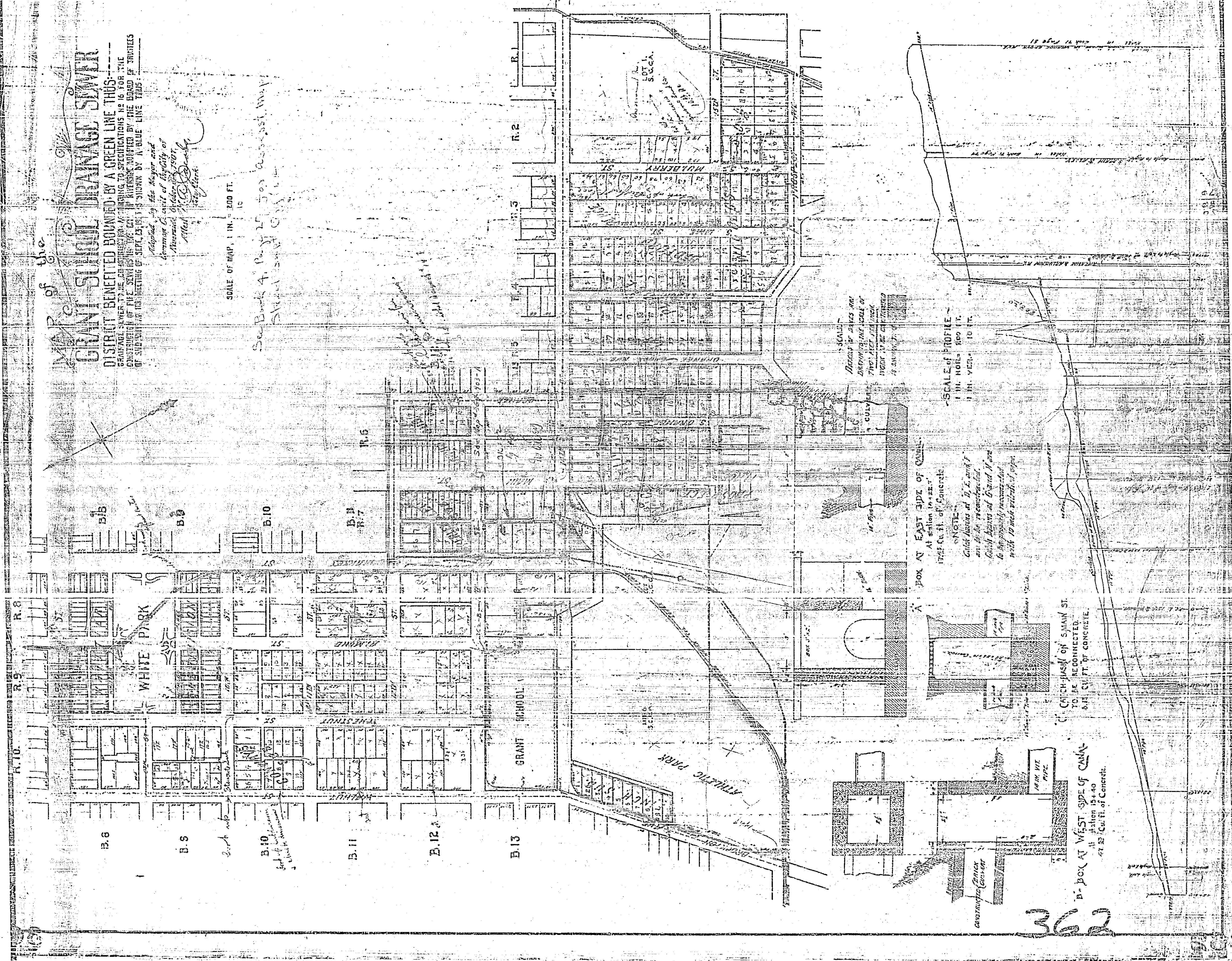

SCALE  
 DETAILS OF MANHOLE AND  
 CATCH BASIN TO BE  
 CONSTRUCTED IN  
 ACCORDANCE WITH  
 SPECIFICATIONS NO. 16

SCALE OF PROFILE  
 1 IN. HORIZ. = 100 FT.  
 1 IN. VERT. = 10 FT.

MANHOLE  
 At station 15+22.7  
 17 1/2' Cu. Ft. of Concrete  
 Catch basins of 12' x 12' and 8' x 8' are to be constructed. Catch basins at Grant and White Park are to be constructed with 10 inch vitrified pipe.

CATCH BASIN ON SHANN ST.  
 TO BE RECONNECTED  
 6 1/2' Cu. Ft. of Concrete.

B. BOX AT WEST SIDE OF CANAL  
 At station 15+45.0  
 47.53' Cu. Ft. of Concrete.

362