

Adopted
Approved by the Mayor and Common
Council of the City of Riverside
this 26th day of May 1926.
Attest: *[Signature]*
City Clerk.

Approved: *[Signature]*
Superintendent Electric Light Dept.

MAP SHOWING PROPOSED
ORNAMENTAL ELECTRIC LIGHTING SYSTEM
TO BE INSTALLED ON
WALNUT ST., ELEVENTH ST. & FIRST ST.
H. R. CAMPBELL,
CITY ENGINEER
1926.

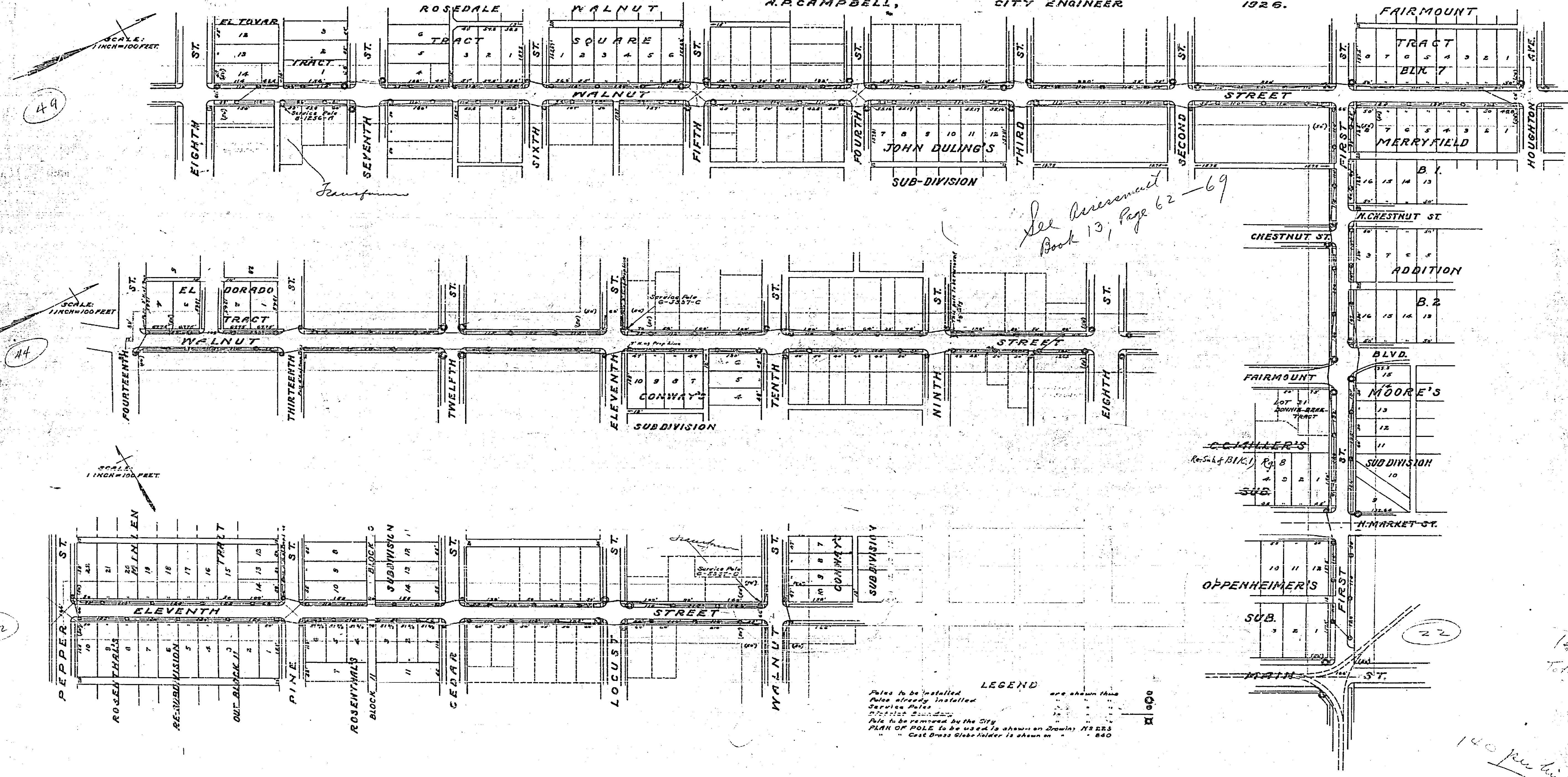

SCALE: 1 INCH = 100 FEET
49

SCALE: 1 INCH = 100 FEET
44

SCALE: 1 INCH = 100 FEET
32

LEGEND
Poles to be installed
Poles already installed
Service Poles
Poles to be removed by the City
PLAN OF POLE to be used, is shown on drawing No. 223
" Cost Brass Glass Holder is shown on " 840

41
24
32
147
Total 147

140 per block
368 B