

**MULBERRY ST.,
BETWEEN EIGHTH AND FIRST ST.**

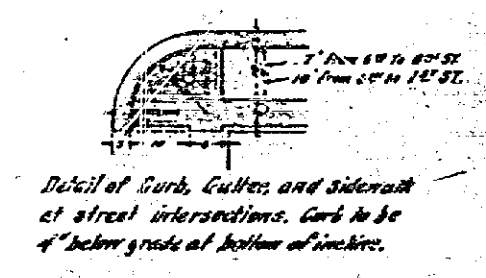

SCALDS
1 inch for - 60 feet
1 inch for - 6 feet

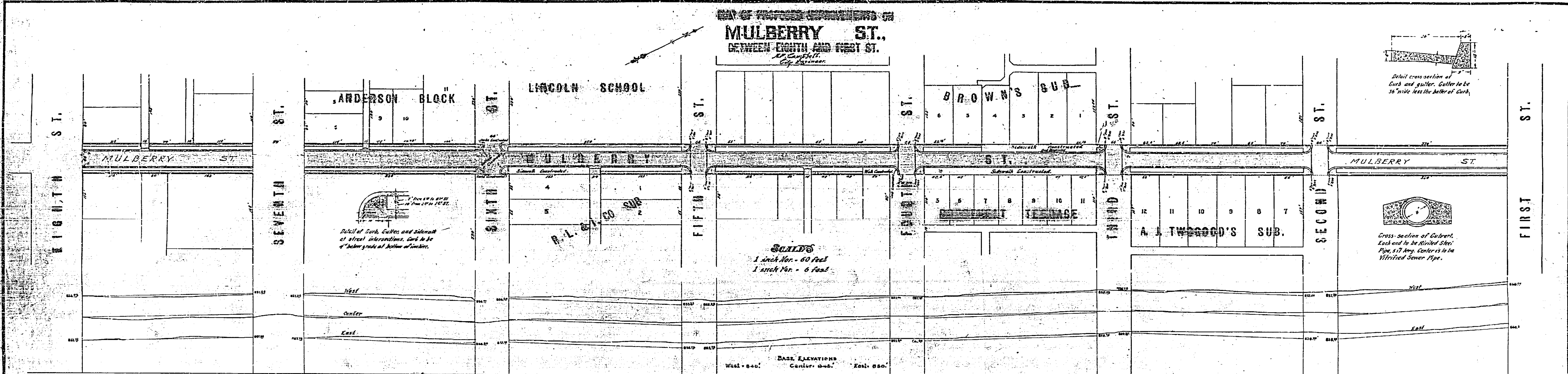
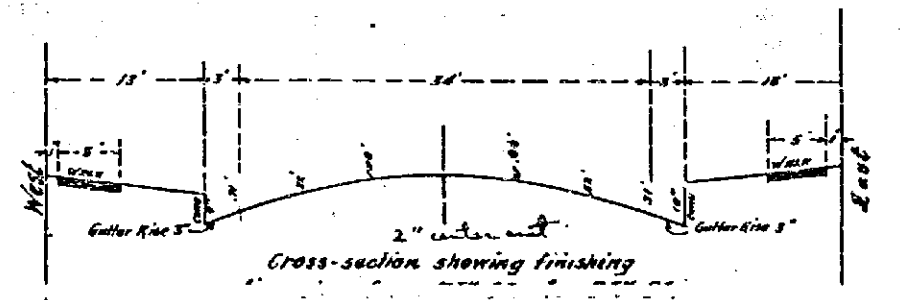
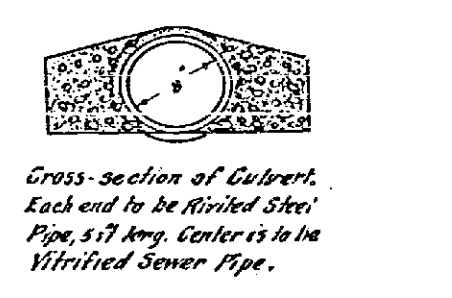
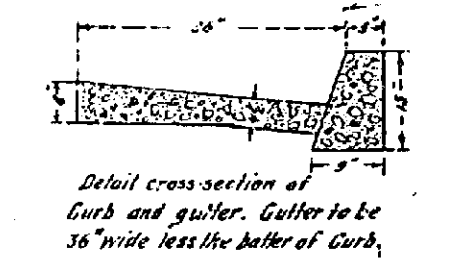

Note -
Roadway to be paved with rock, with alioed surface is shown thus [Symbol] 10
Concrete gutter to be constructed is shown thus [Symbol] 12
Concrete curb to be constructed is shown thus [Symbol] 14
Concrete sidewalk to be constructed is shown thus [Symbol] 16
Steel & iron pipe culverts to be constructed of 24" diameter [Symbol] 18
Catch basins to be lowered are shown thus "A" "B"

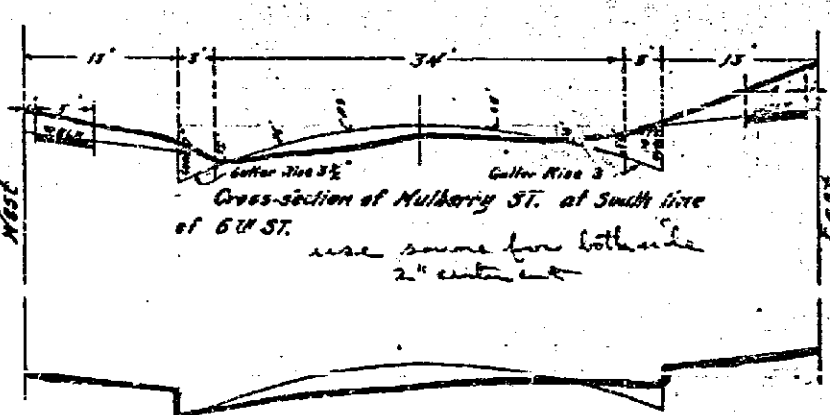

North line of 7th St. Same cross-section dimensions as at South line of 6th St.

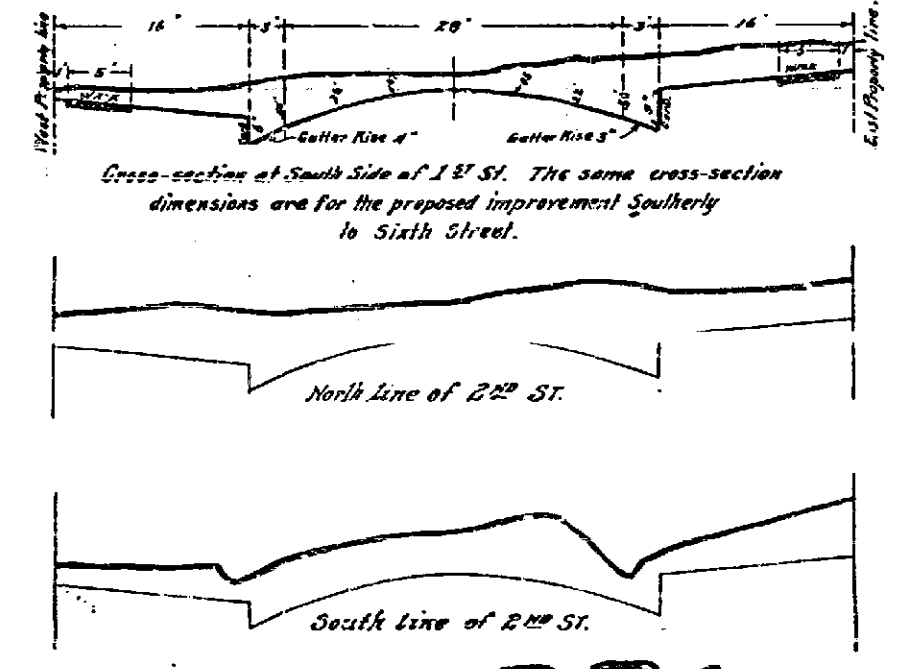
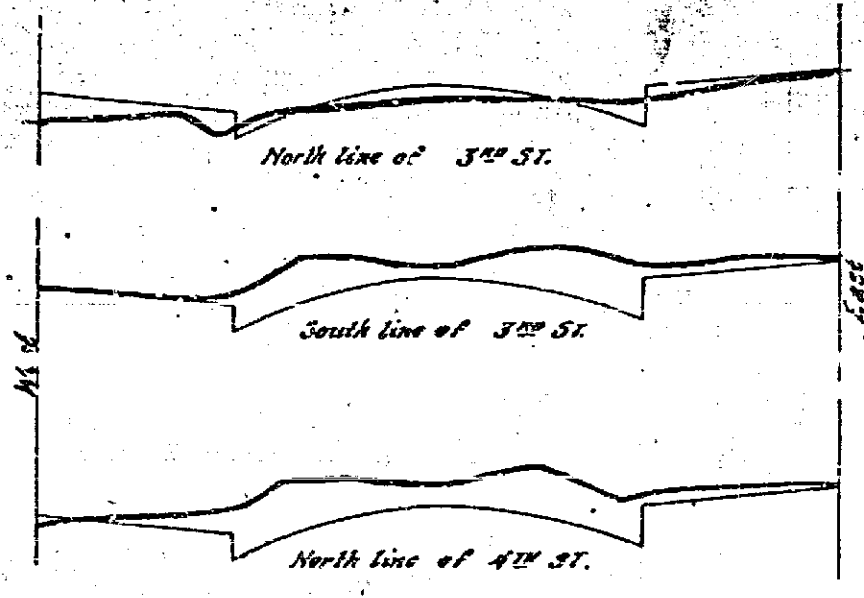
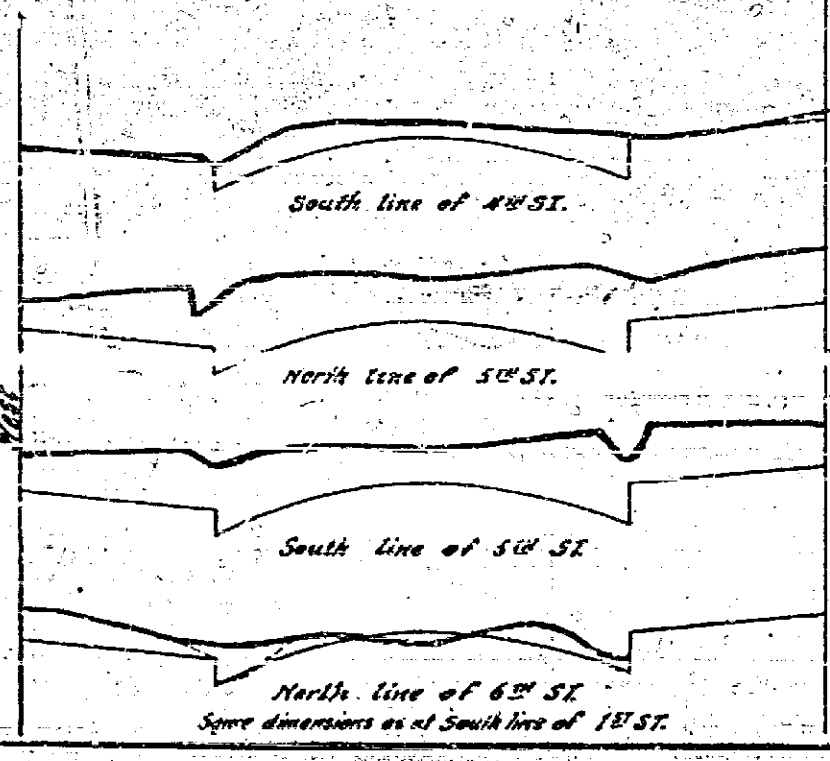

Approved by the Mayor and Common Council of the City of Riverside, June 25, 1900.
City Clerk

Notes, Book 86, Page 20