

# PROPOSED IMPROVEMENTS ON THIRD ST. FROM WALNUT TO VINE ST.

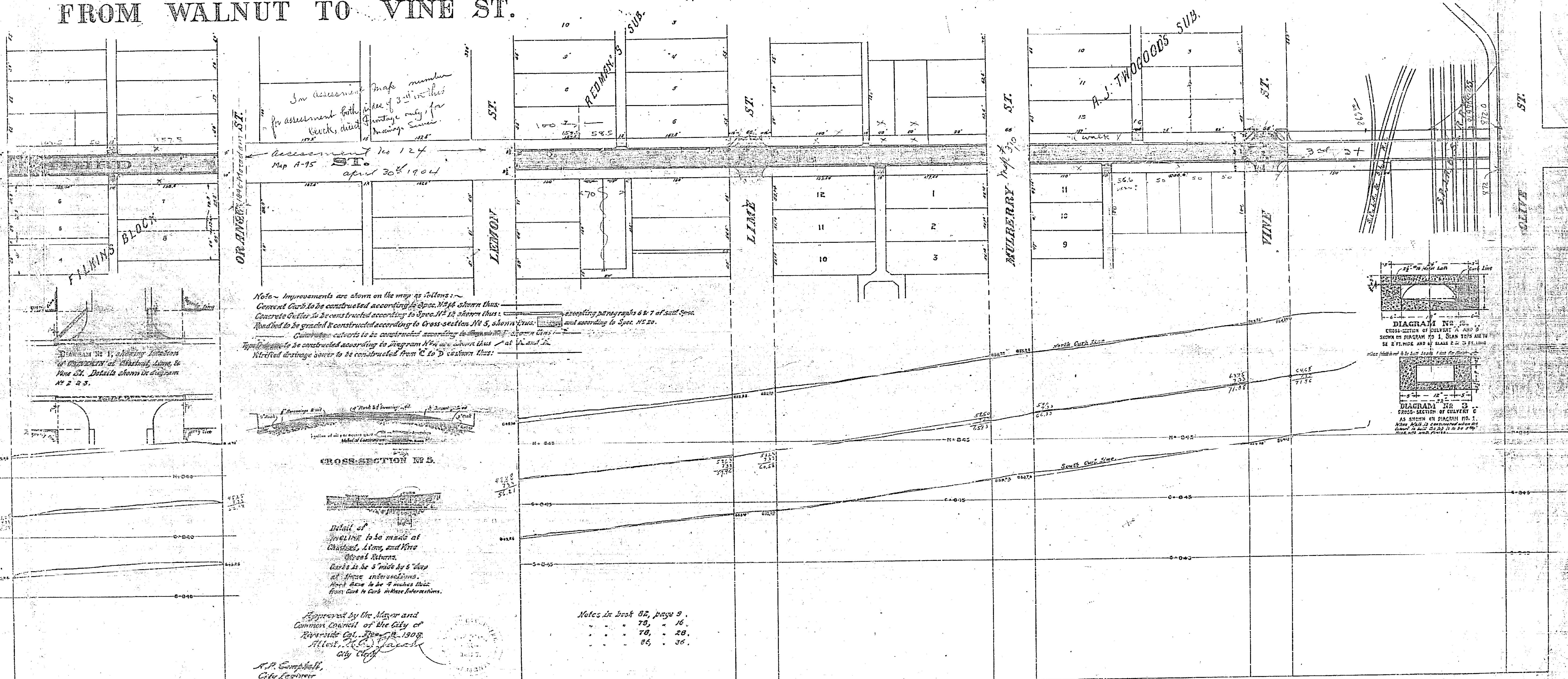

In assessment made number for assessment both sides of 3rd st this blocks street frontage only for drainage sewer.

Assessment No 124  
Map A-95  
April 30th 1904

Note - Improvements are shown on the map as follows:  
 Concrete Curb to be constructed according to Spec. No 12 shown thus:  
 Concrete Curb to be constructed according to Spec. No 12 shown thus:  
 Road to be graded & constructed according to Cross-section No 5, shown thus:  
 Concrete culverts to be constructed according to diagram No 1 shown thus:  
 Type of culverts to be constructed according to diagram No 2 shown thus:  
 Riffled drainage sewer to be constructed from C to D shown thus:

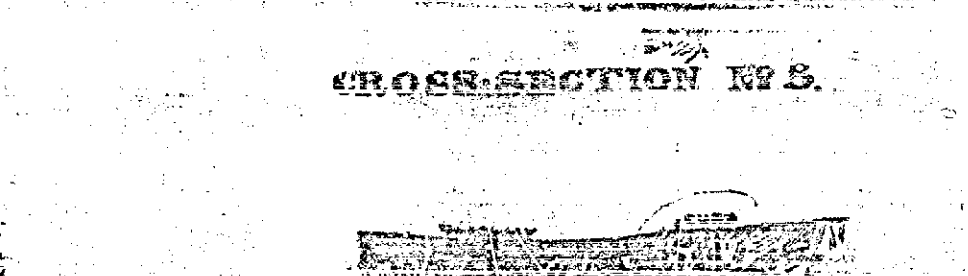
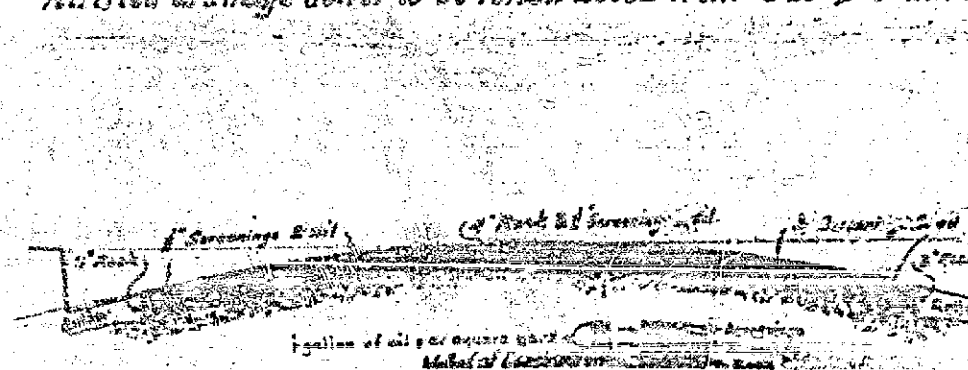

Detail of  
 to be made at  
 Clarks, Lime, and Pine  
 Street Returns.  
 Curb to be 5' wide by 6" deep  
 at these intersections.  
 Road base to be 7' inches thick  
 from Curb to Curb at these intersections.

Approved by the Mayor and  
 Common Council of the City of  
 Riverside Cal. Jan. 11, 1904.  
 Attest, H.C. J. [Signature]  
 City Clerk

Notes in book 87, page 9.  
 78, " 16.  
 78, " 28.  
 86, " 36.

