

PLAT SHOWING  
 TOPO. & ELEVATIONS AT  
 INTERSECTION OF  
 EVANS & GRACE STREETS  
 CITY OF RIVERSIDE - CALIFORNIA  
 SCALE: HOR. - 1/4" = 20 FT.  
 VERT. - 1/4" = 4 FT.  
 P.B. 540-1

3-20-53  
 LSW

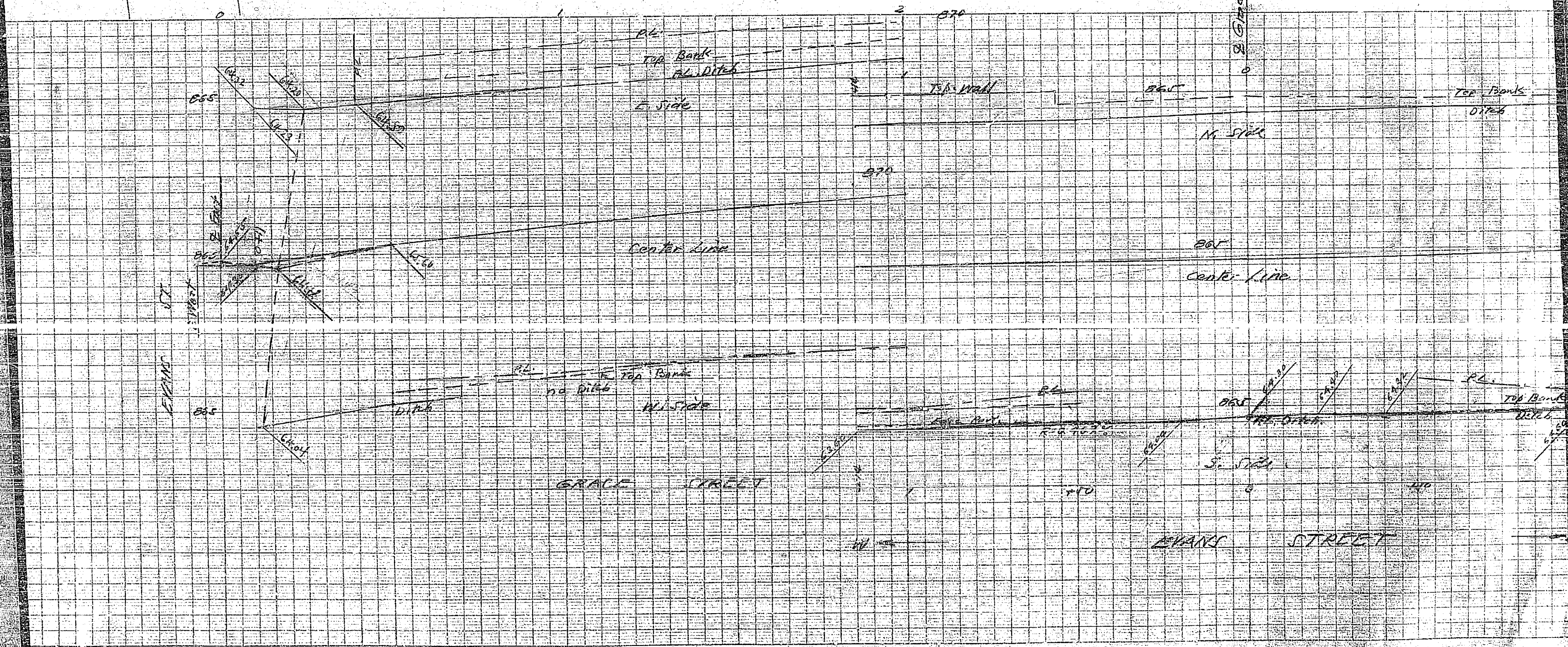

MADE IN U.S.A.  
 LITHOGRAPHED AND PRINTED BY  
 THE RIVERSIDE PRINTING CO.  
 RIVERSIDE, CALIFORNIA

373 B