

MAP OF PROPOSED IMPROVEMENTS ON E. SEVENTH ST.

Scale, 1 in. = 60 ft.
1st Ed. - 1908.

J. P. Campbell,
City Engineer.

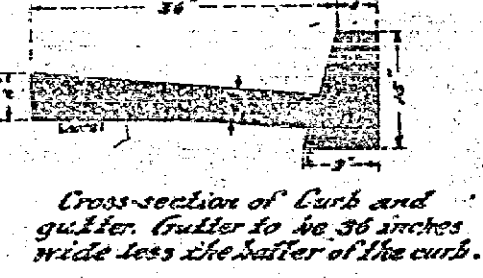
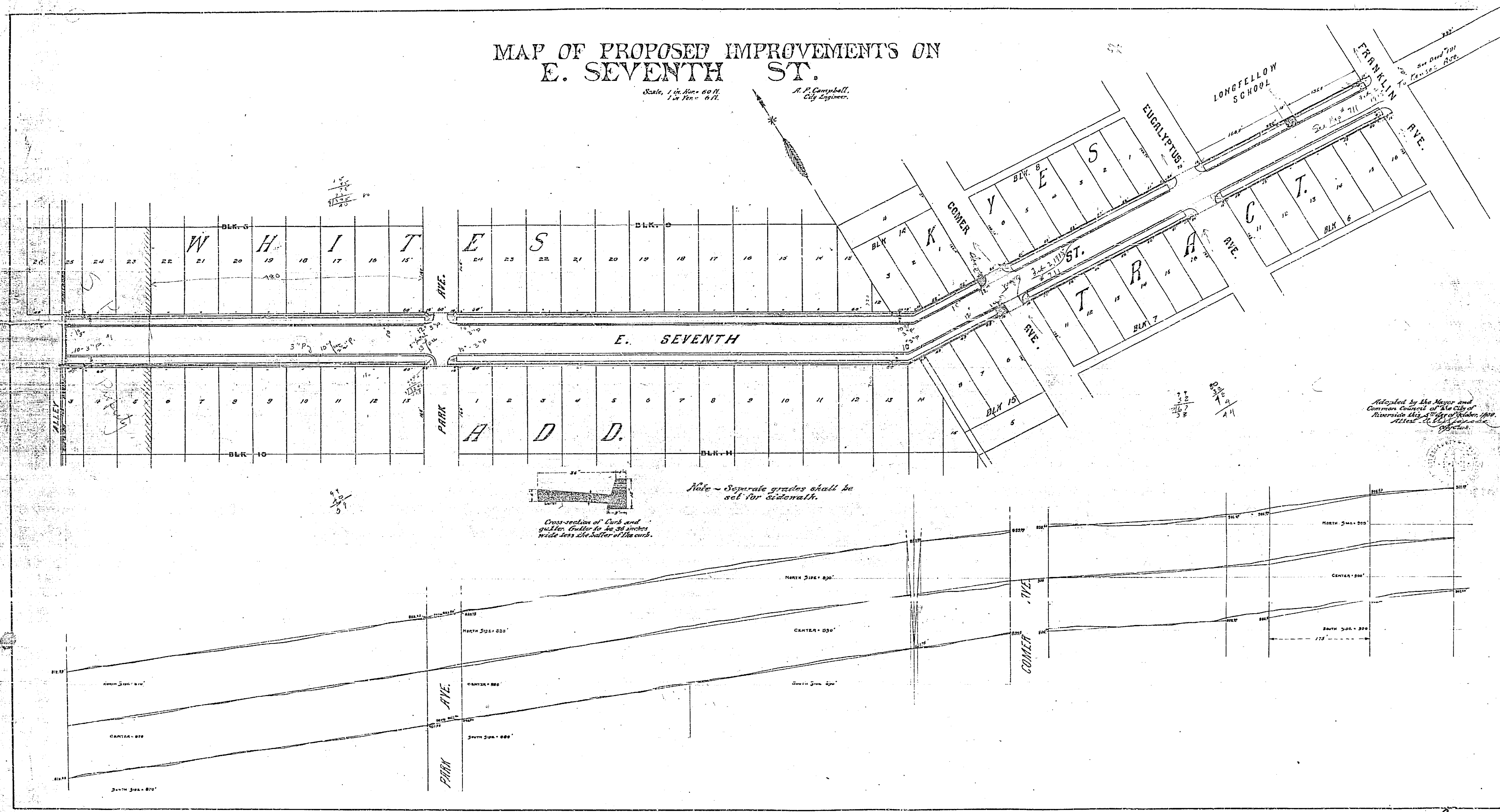
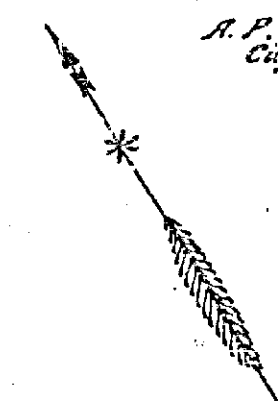

Cross-section of Curb and gutter. Gutter to be 36 inches wide less the gutter of the curb.

Note - Separate grades shall be set for sidewalk.

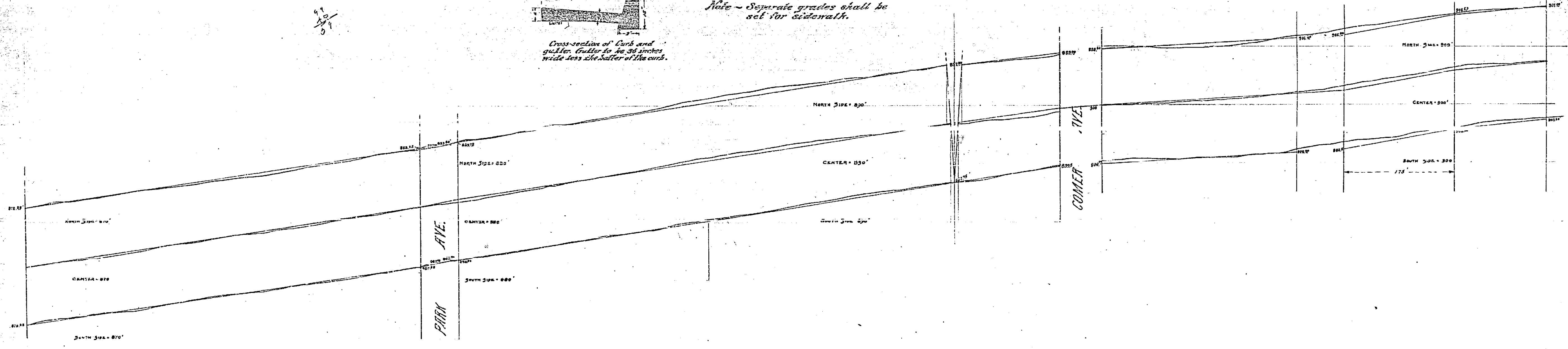

Adopted by the Mayor and Common Council of the City of Riverside this 27th day of October, 1908.
Attest: J. P. Campbell, City Engineer.

376A