

PLAN AND PROFILE
 NO. 408
 FOR THE CONSTRUCTION OF CURBS & GUTTERS ON
TWELFTH STREET
 BETWEEN PARK AVENUE AND HIGH STREET
 ENGINEERING DEPT CITY OF RIVERSIDE

BK 471 PG. 21
 APPROVED: *M. M. [Signature]*
 A CIVIL ENGINEER REGISTERED UNDER
 THE LAWS OF THE STATE OF CALIFORNIA
 EXP. 10-31-11

SCALE: HORIZ. 1"=40'
 VERT. 1"=4'
 THESE PLANS APPROVED AND ADOPTED BY THE MAYOR AND
 COUNCIL OF THE CITY OF RIVERSIDE, COUNTY OF RIVERSIDE, STATE OF CALIFORNIA
 ON THIS 10TH DAY OF [Month] 1911
[Signature]
 CITY ENGINEER

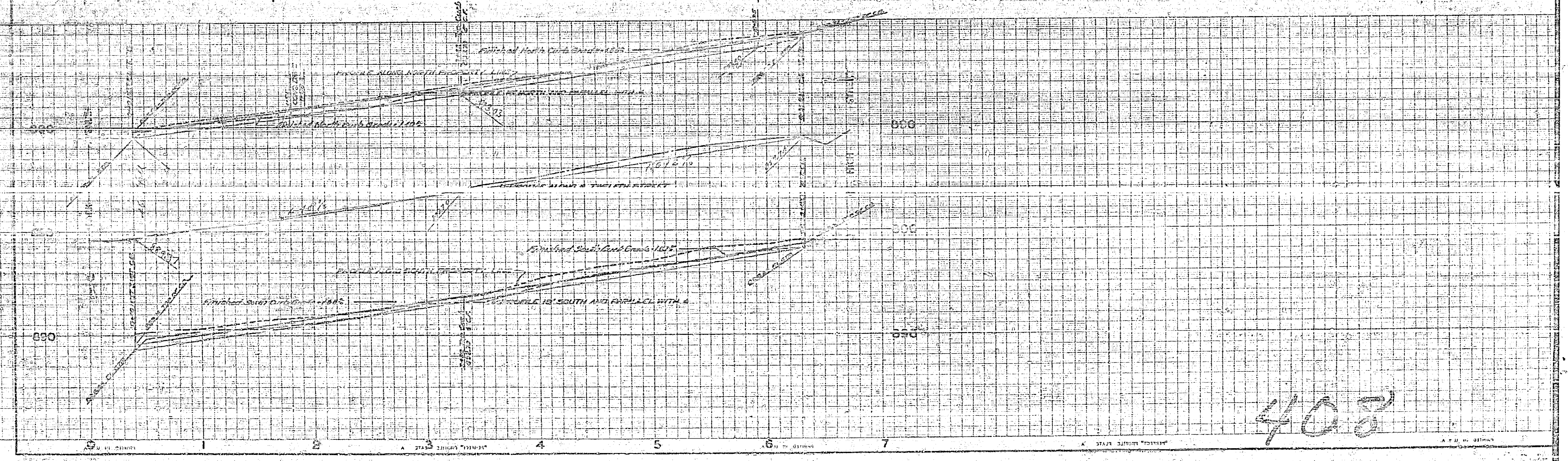

408