

# MAP SHOWING IMPROVEMENTS TO BE MADE ON ELEVENTH ST.

A. P. Campbell,  
City Engineer.

Scales - Vertical 1" = 8ft.  
Horizontal 1" = 66ft.

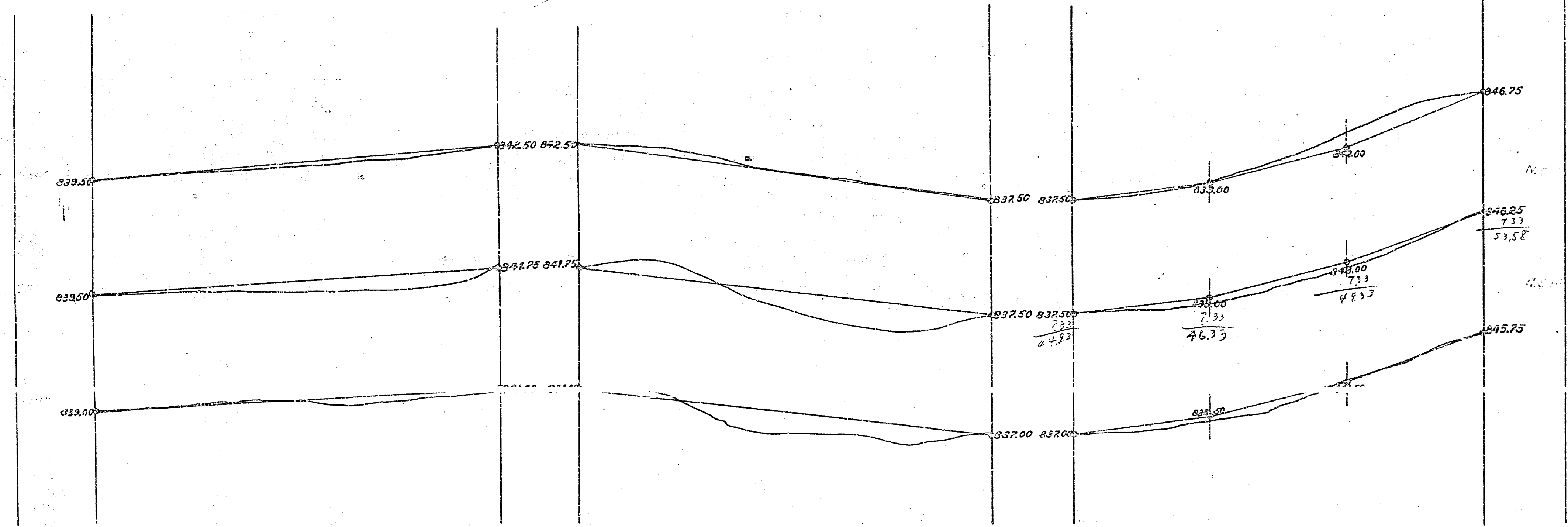
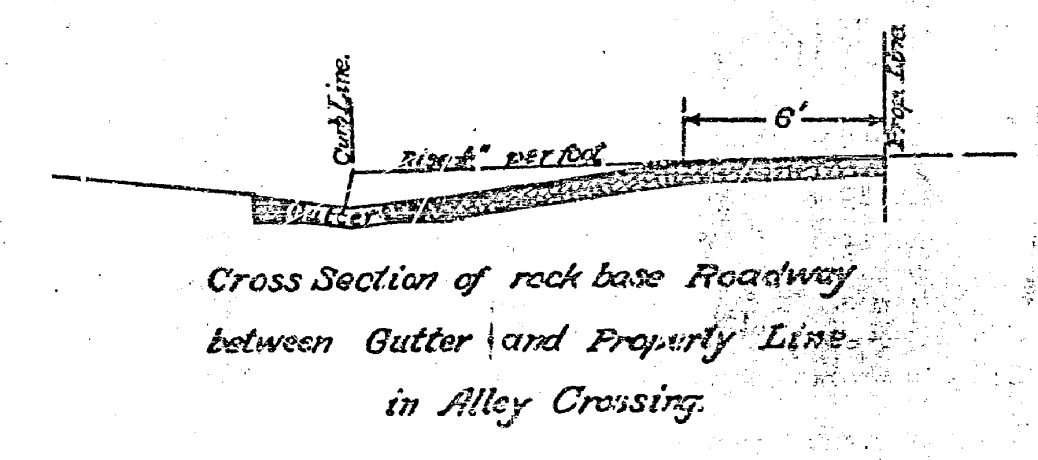
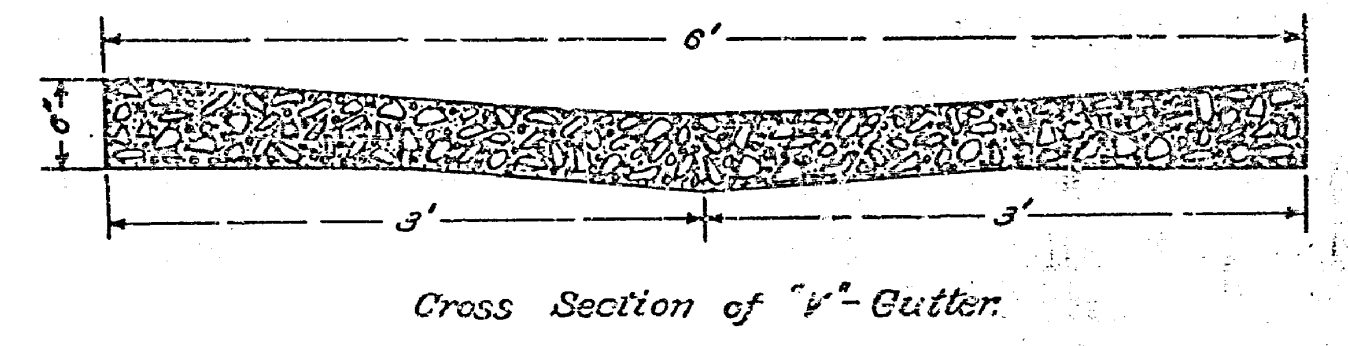
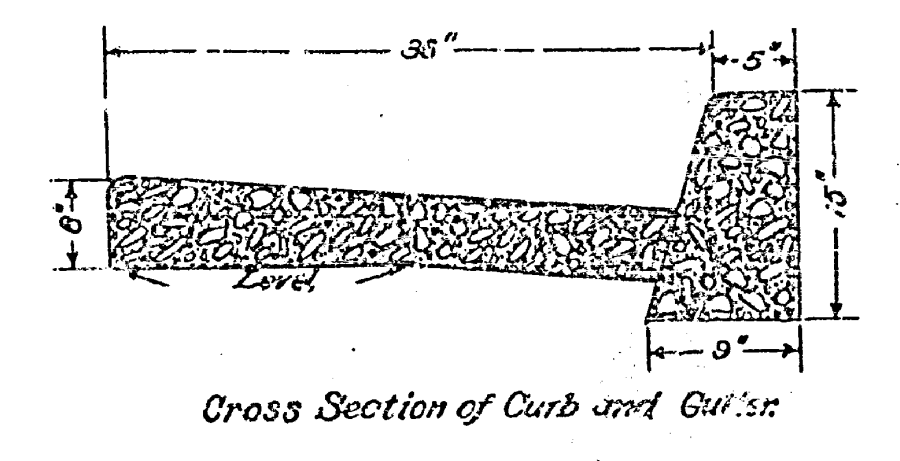
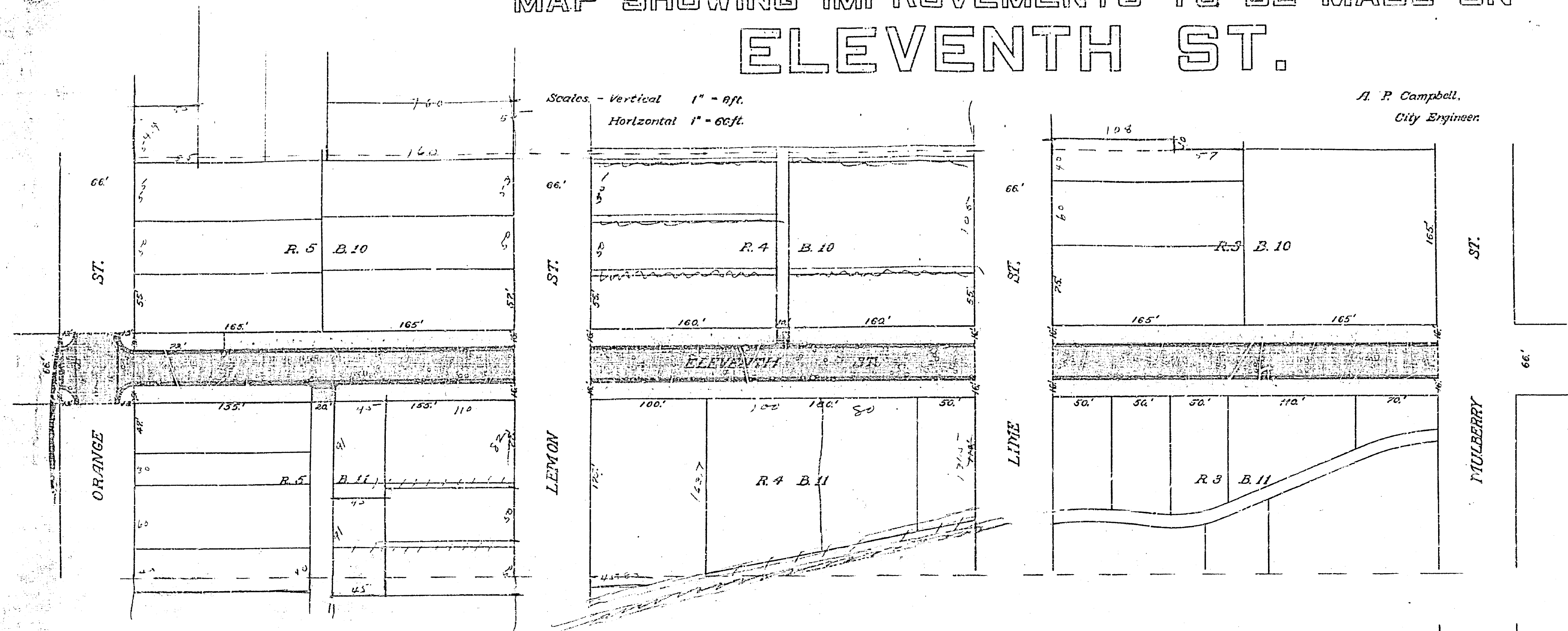
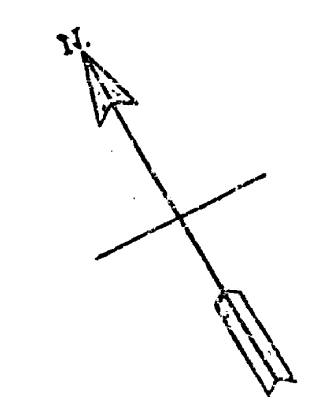

**NOTE** - Improvements to be made are shown on the Map as follows: -

- Macadam Roadway is shown thus
- Concrete Gutters are shown thus
- Concrete Curb is shown thus
- Parking and Sidewalk Space to be graded -
- 16" Corrugated-iron Culverts are shown thus

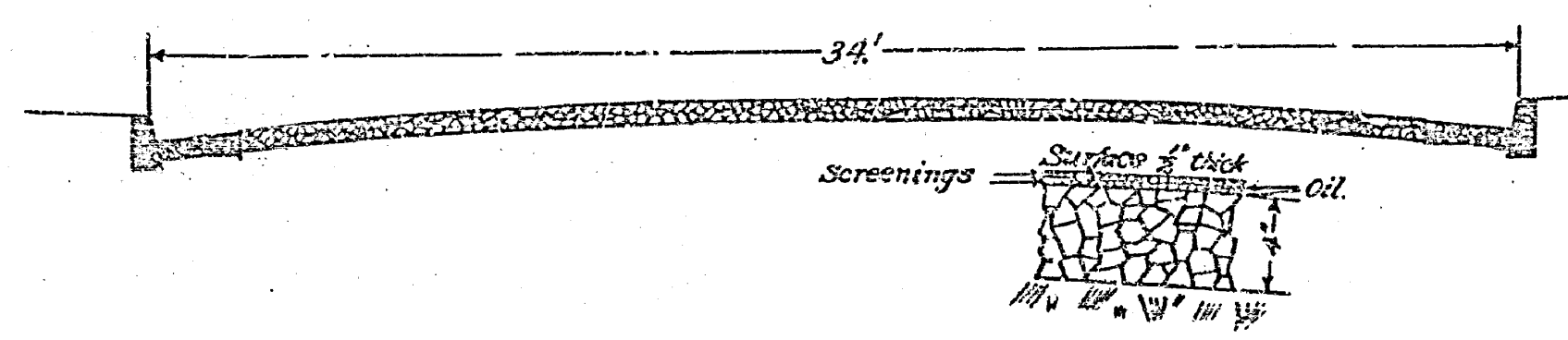
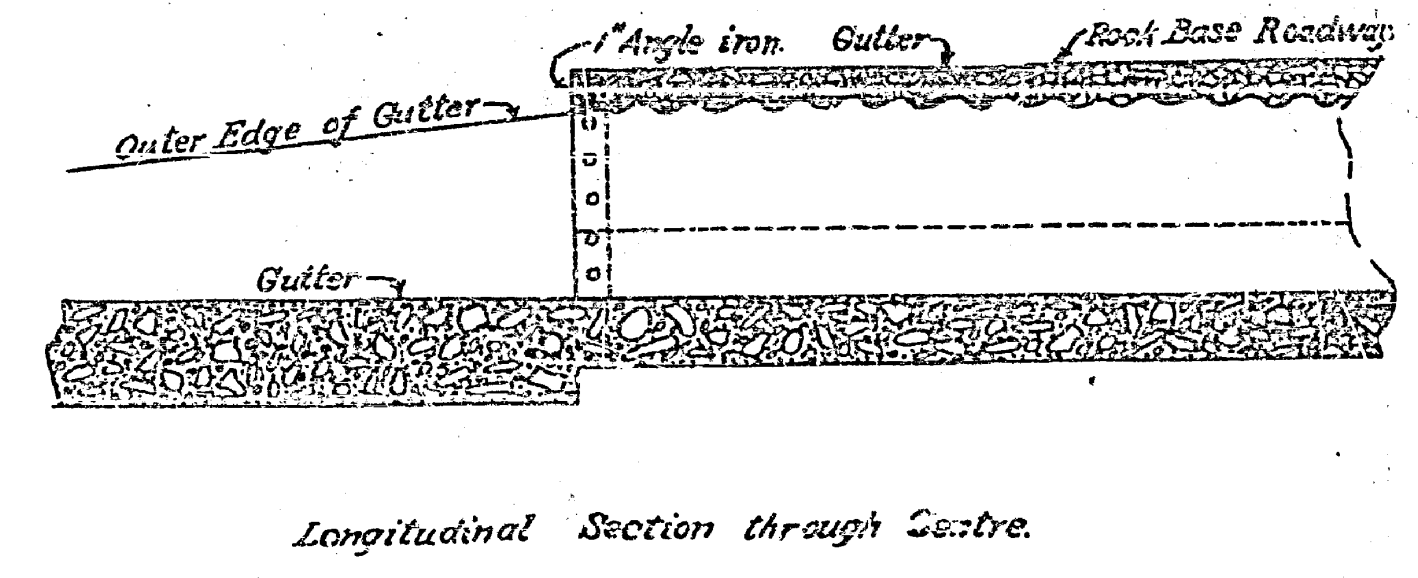
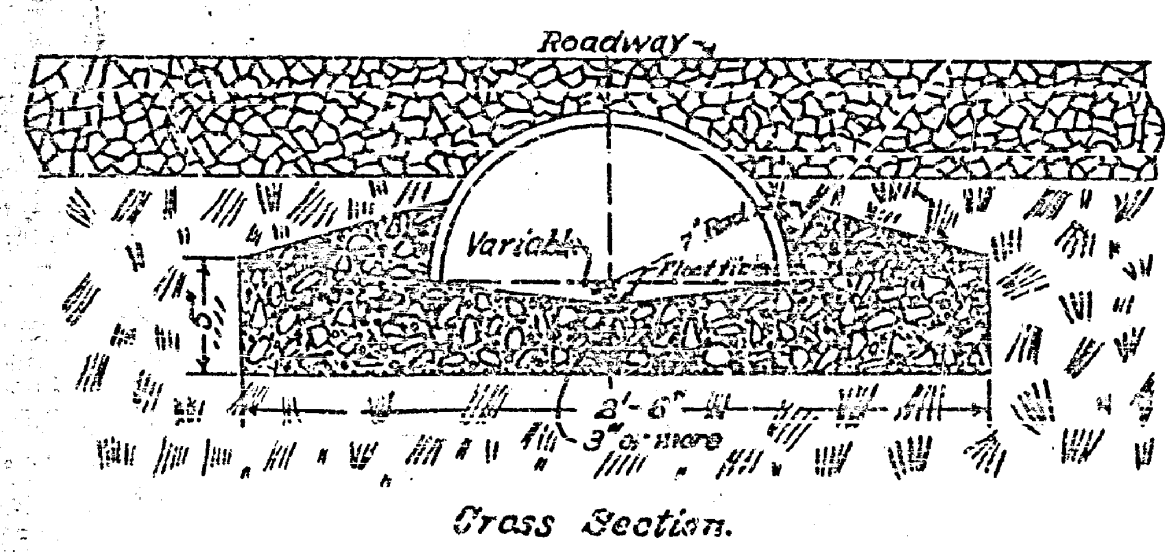

Adopted by the Mayor and  
Common Council of the City  
of Riverside March 28, 1911.  
Attest City Clerk.

Sections of Galvanized Corrugated-iron Culverts.

432