



**MAP SHOWING
ALLEY TO BE IMPROVED
IN BLOCK 7 RANGE 8**

5 Inch concrete pavement to be constructed shown thus, 
 Curb to be constructed shown thus, 
 District to be assessed bounded by a yellow line thus, 



Scale 1 in. = 60 Ft.

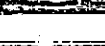
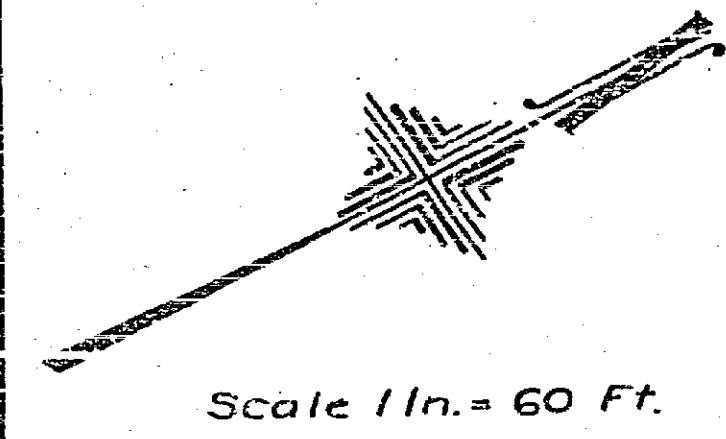
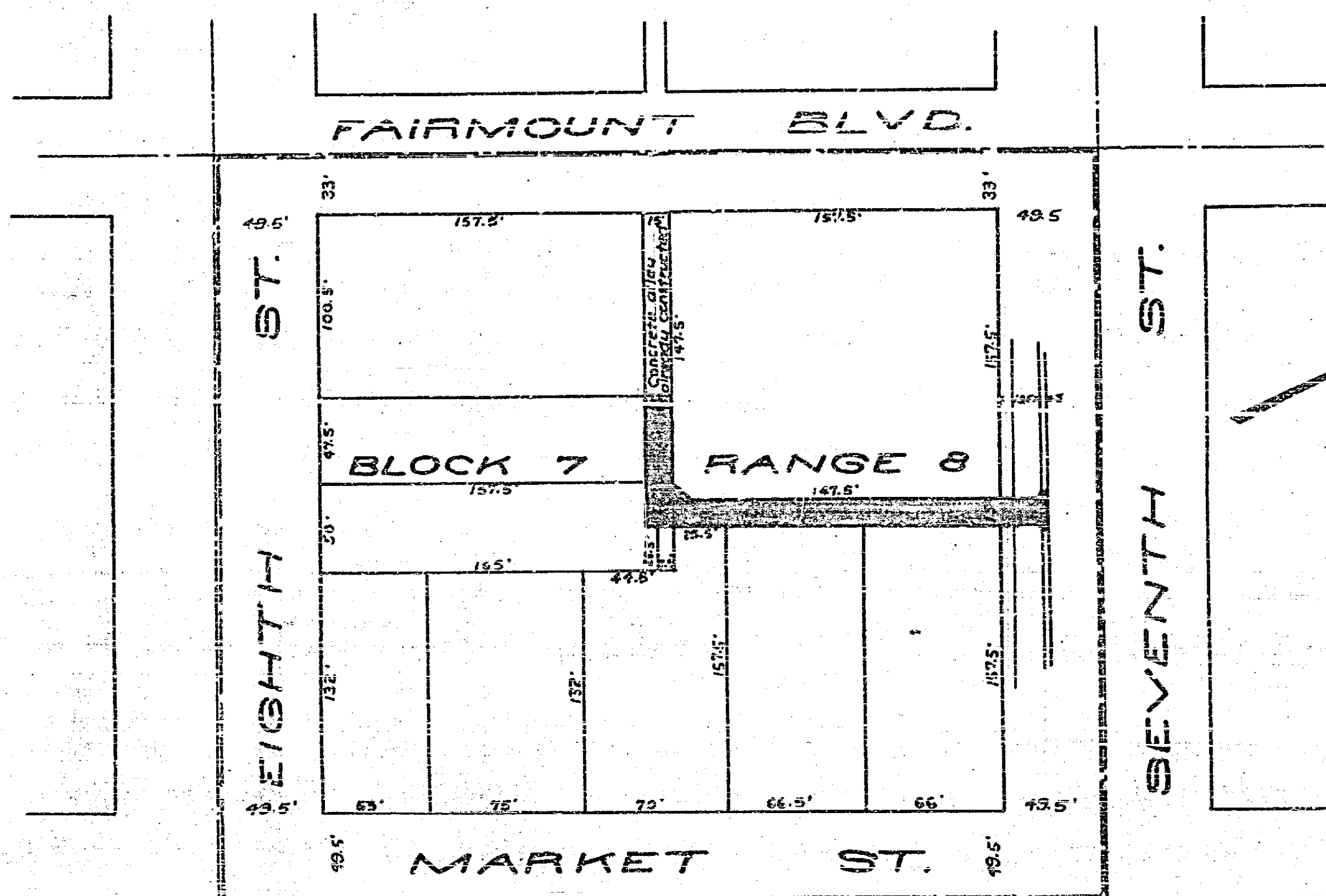
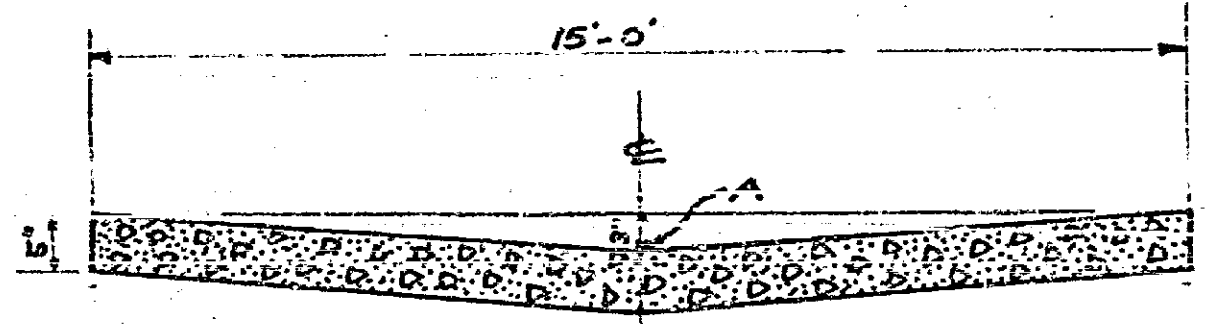

SECTION OF ROADWAY
 Scales: Horizontal 1 in. = 3 Ft.
 Vertical 3/4 in. = 1 Ft.

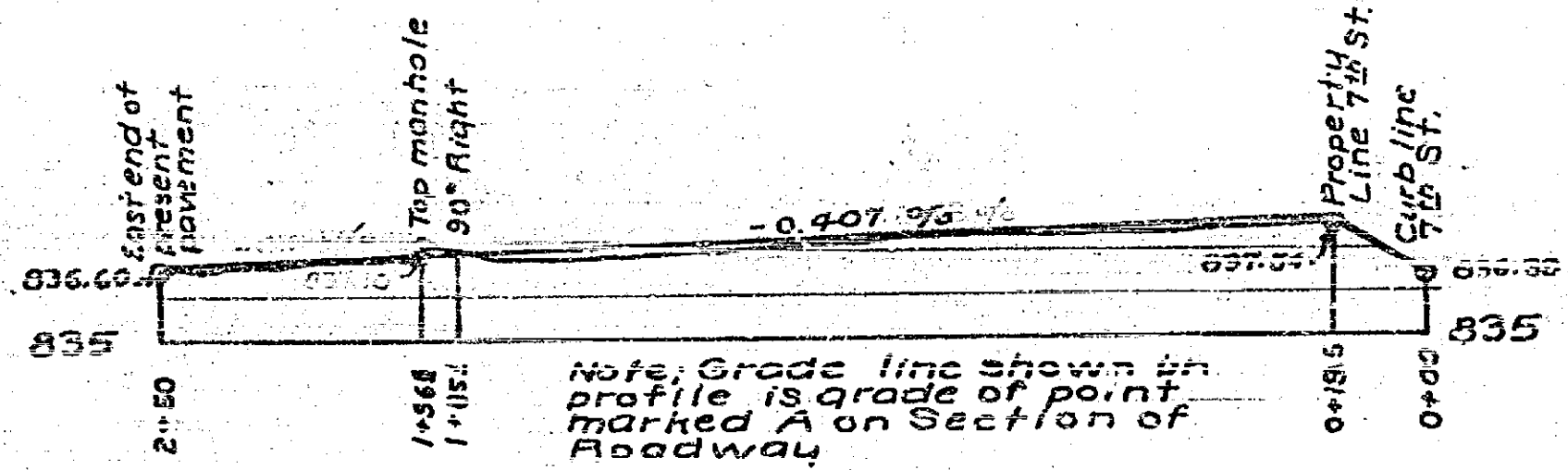

CENTER LINE PROFILE
 Scales: Horizontal 1 in. = 40 Ft.
 Vertical 1 in. = 4 Ft.

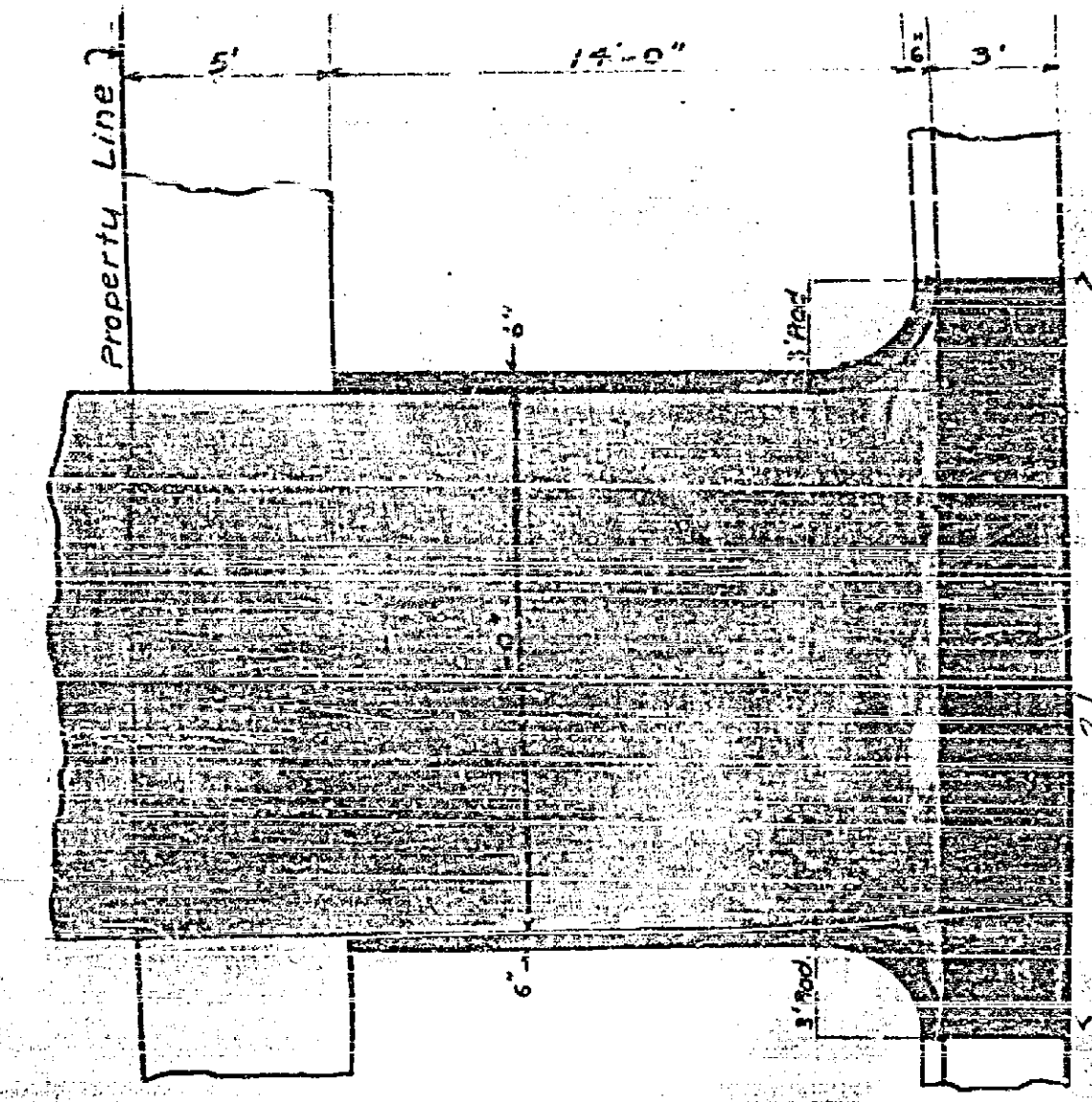

**DETAIL OF ALLEY
RETURN AT 7TH ST.**
 Scale 1 in. = 5 Ft.

Approved by the Mayor and Common Council of the City of St. Paul, Minnesota this 9th day of October, 1923.
 Attest *C. R. Burns*
 City Clerk

4380

MAP No 789

MISSING