

Original Pavement - Curbs & Sidewalks  
 as shown on Plat 2  
 P. 129  
 of R. 1027

Civ. Eng. R. P. 5027  
 Arch.  
 1903

County Court House  
 -Block-

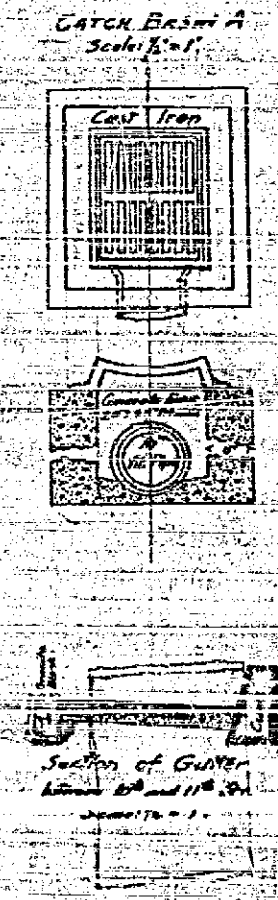
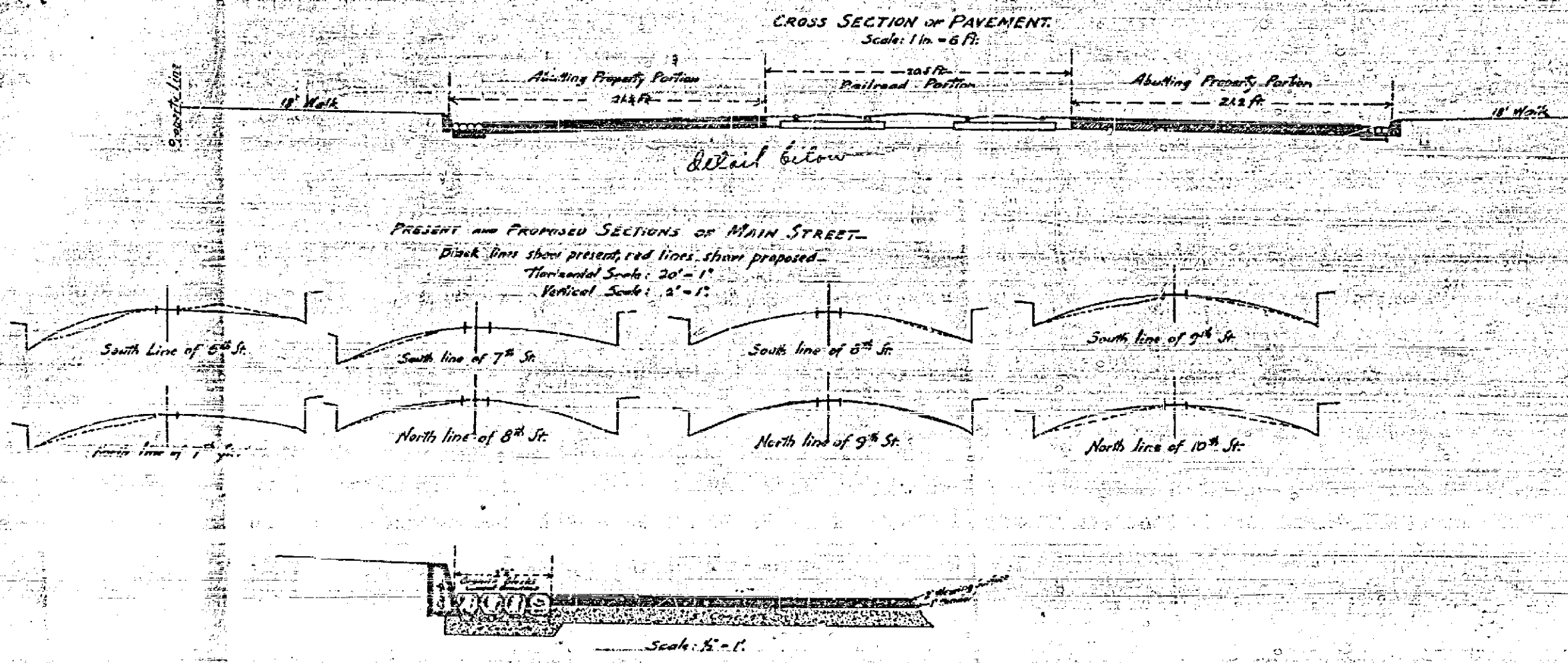
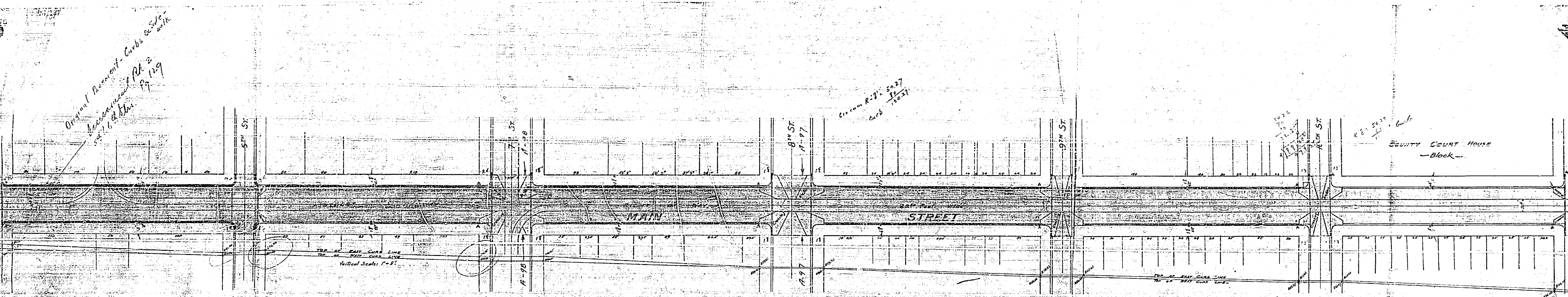

**MAP OF MAIN STREET**  
 From the Southern Curb Line of 5th Street  
 To the Northern Curb Line of 11th Street

The portion to be paved with asphalt is colored thus: [shaded area]  
 The gutters to be reset are colored thus: [dashed line]  
 The gutters to be built are colored thus: [solid line]  
 The gutters already built are colored thus: [dotted line]  
 The catch basins to be built are marked thus: [square symbol]  
 The catch basins already built are marked thus: [circle symbol]

SCALE: 50 FEET = 1 INCH.

Riverside, California, June 20, 1903.

W. A. [Name]  
 City Engineer.

Adopted by the Board of Trustees of the City  
 of Riverside, June 23rd A.D. 1903.

Attest: G. R. Stillman  
 City Clerk

439