

MAIN ST. RUSSELL ST. to N. City Limit			
Drawing Number	Sheet Number	Title	Field Book
441	1	PLAN	304
Drawn	Checked	Approved	
July 1941.			

**PLAN**  
 OF THE PROPOSED IMPROVEMENT OF  
**MAIN STREET**  
 BETWEEN RUSSELL ST & NORTH CITY LIMITS  
 BEING A  
**STREET OF MAJOR IMPORTANCE**  
 ENGINEERING DEPT. RIVERSIDE CALIF. 1941.

SCALE: 1" = 100'

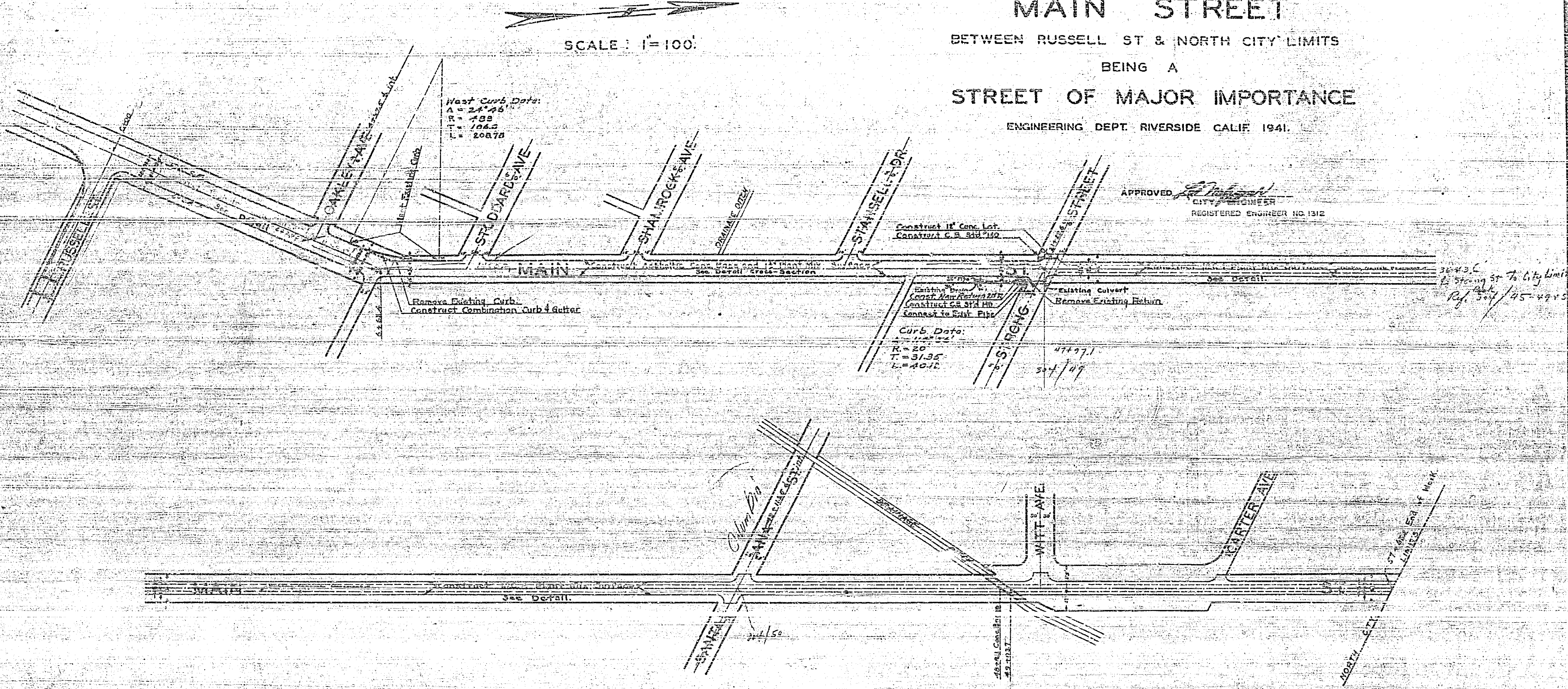

APPROVED *[Signature]*  
 CITY ENGINEER  
 REGISTERED ENGINEER NO. 1312

3643 L  
 Strong St. to City Limit  
 Ref. 304/45-47

**TYPICAL CROSS SECTION**  
 RUSSELL ST. to Angle

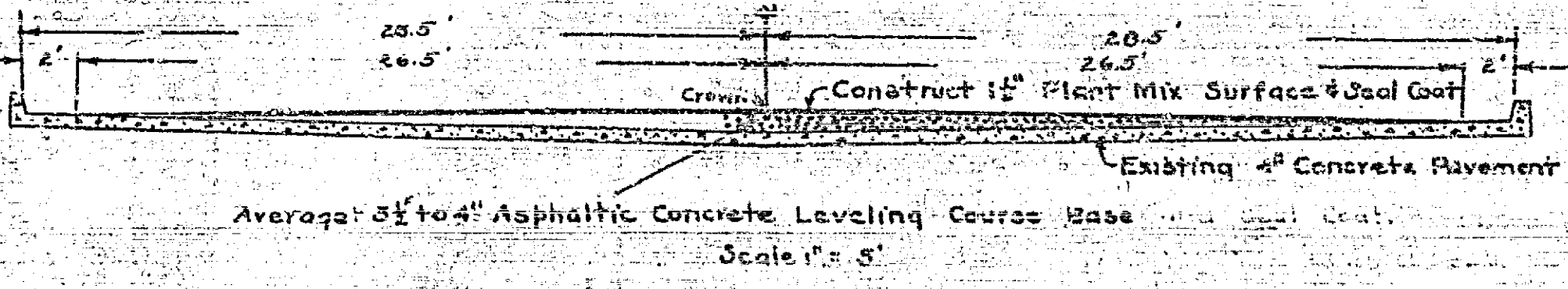

Finish Crown 0.35 Above edge of Pavement.

**TYPICAL CROSS SECTION**  
 Angle to STRONG ST.

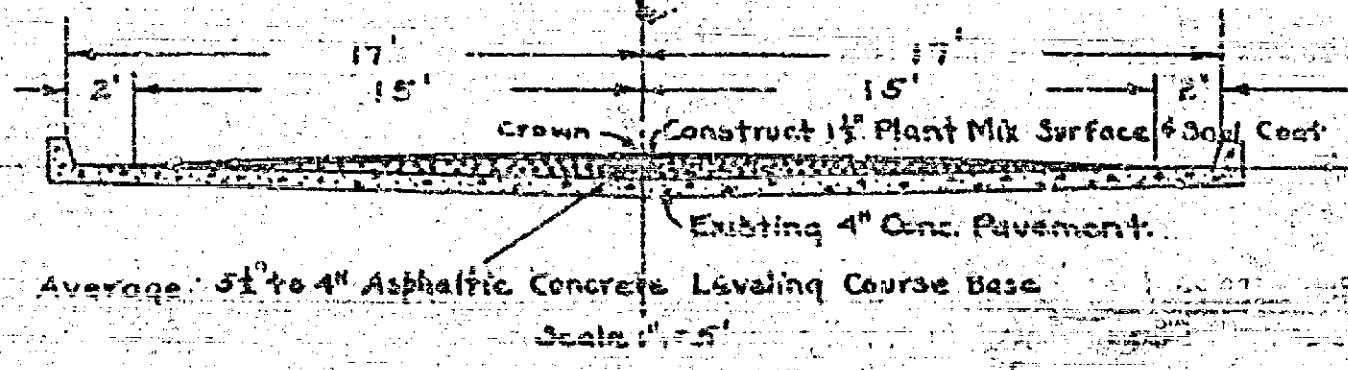

Finish Crown 0.25 Above edge of Pavement.

**TYPICAL CROSS SECTION**  
 STRONG ST. to North City Limits

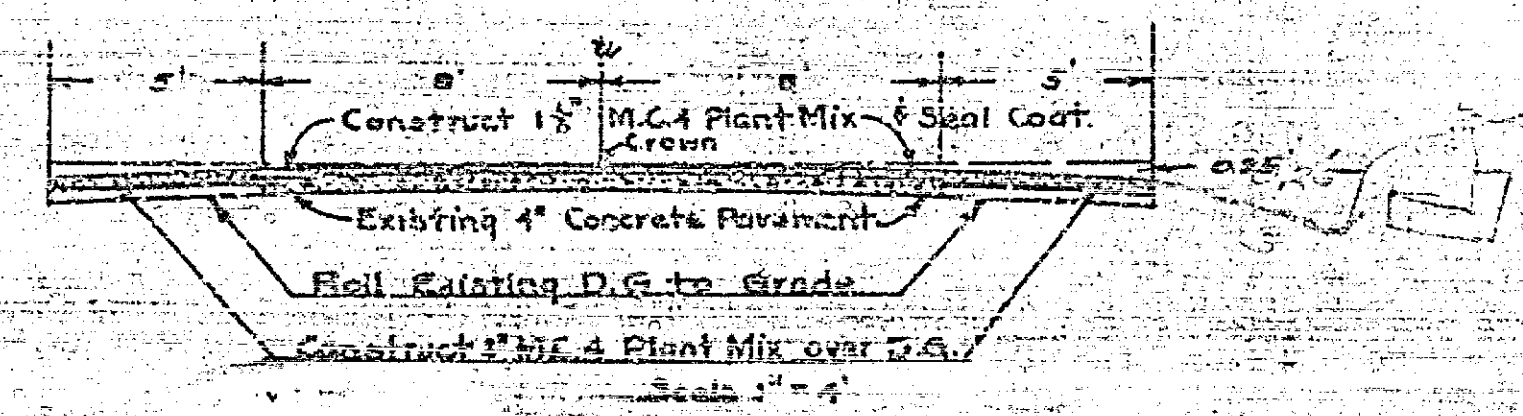

441