

MAP OF PROPOSED IMPROVEMENTS TO BE MADE ON DATE ST. FROM NORTH ST. TO VICTORIA AVE.

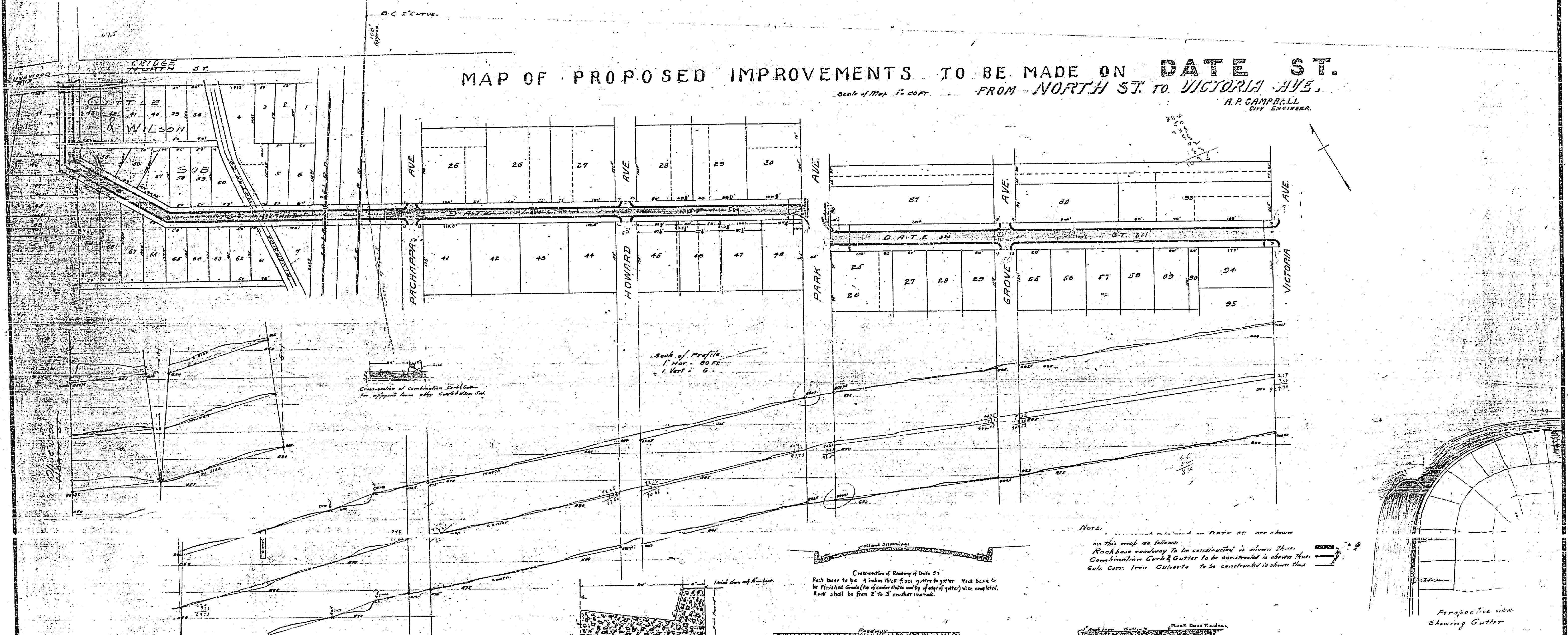

Scale of Map 1" = 50 FT

A.P. CAMPBELL
CITY ENGINEER.



Scale of Profile
1" Horiz = 50 FT
1" Vert = 6'

Cross-section of combination curb & gutter
as opposite from other cross-section

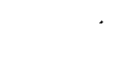
NOTE:
On this map as shown on DATE ST are shown
Rock base roadway to be constructed is shown thus: 
Combination Curb & Gutter to be constructed is shown thus: 
Galv. Corr. Iron Culverts to be constructed is shown thus: 

Cross-section of Roadway of Date St.
Rock base to be 4 inches high from gutter to gutter. Rock base to
be finished grade (top of curb) to center of gutter when completed.
Rock shall be from 2" to 3" crusher run rock.

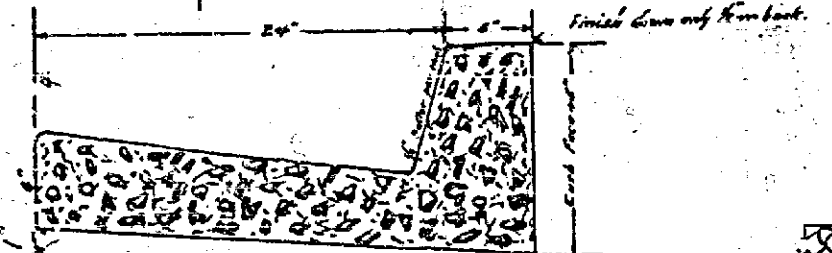

Cross-section of Combination Curb & Gutter.
Proportion of materials in the concrete shall be
1 bag of cement, 2 1/2 cu feet of sand and 3 1/2 cu feet of rock

Approved by the Mayor and Common Council
of the City of Riverside March 20th 1918
Mayor *[Signature]*
City Clerk *[Signature]*

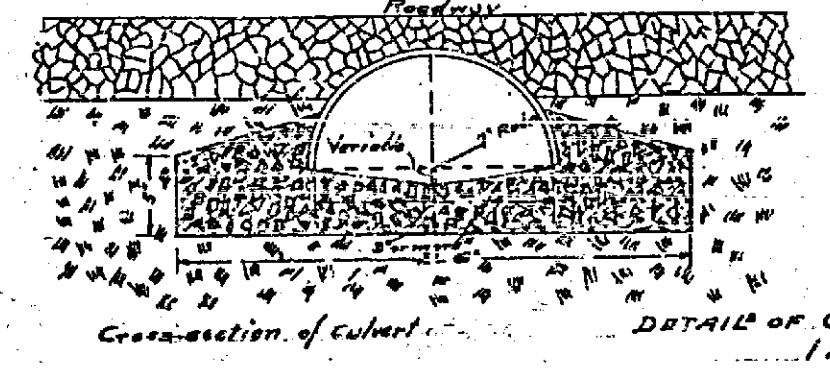

DETAIL OF GALVANIZED CORRUGATED
IRON CULVERTS

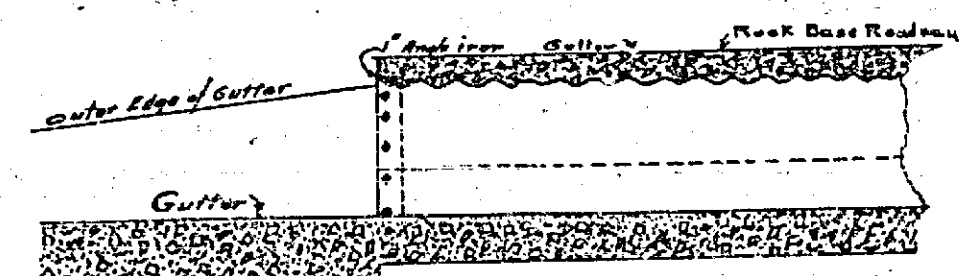

Longitudinal section through center

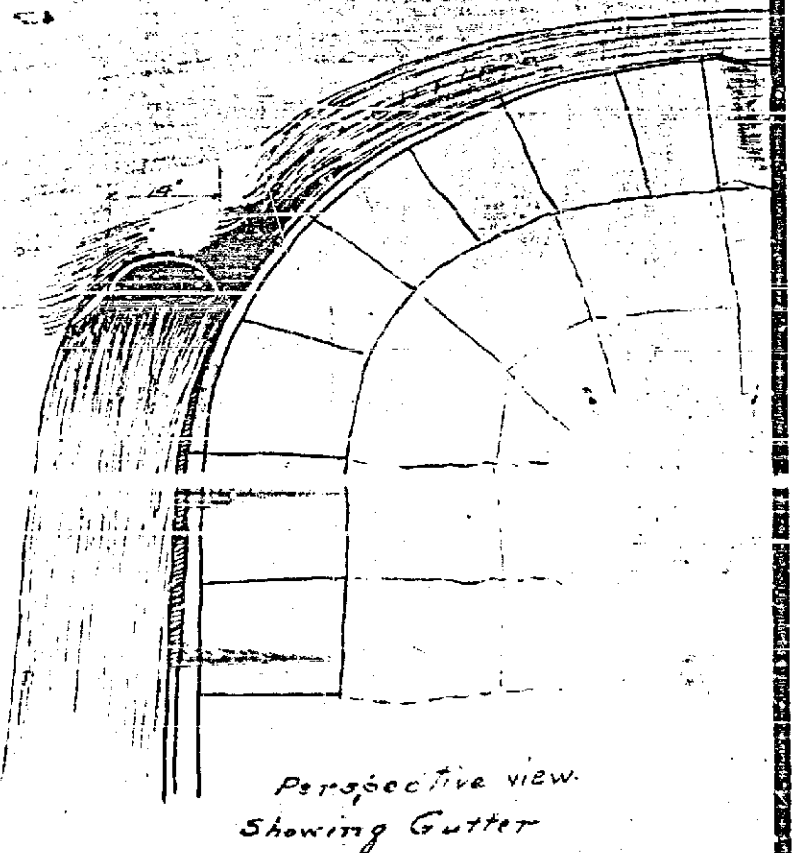

Perspective view
Showing Gutter

Approved by the Mayor and
Common Council of the City
of Riverside October 26th 1911
Mayor *[Signature]*
City Clerk *[Signature]*

446