

MAP SHOWING LOCATION, PROFILE & GRADE LINE OF A PORTION OF THE

MAGNOLIA AVENUE EXTENSION

SCALE OF MAP, 1 INCH = 60 FEET.

A.P. CAMPBELL
CITY ENGINEER

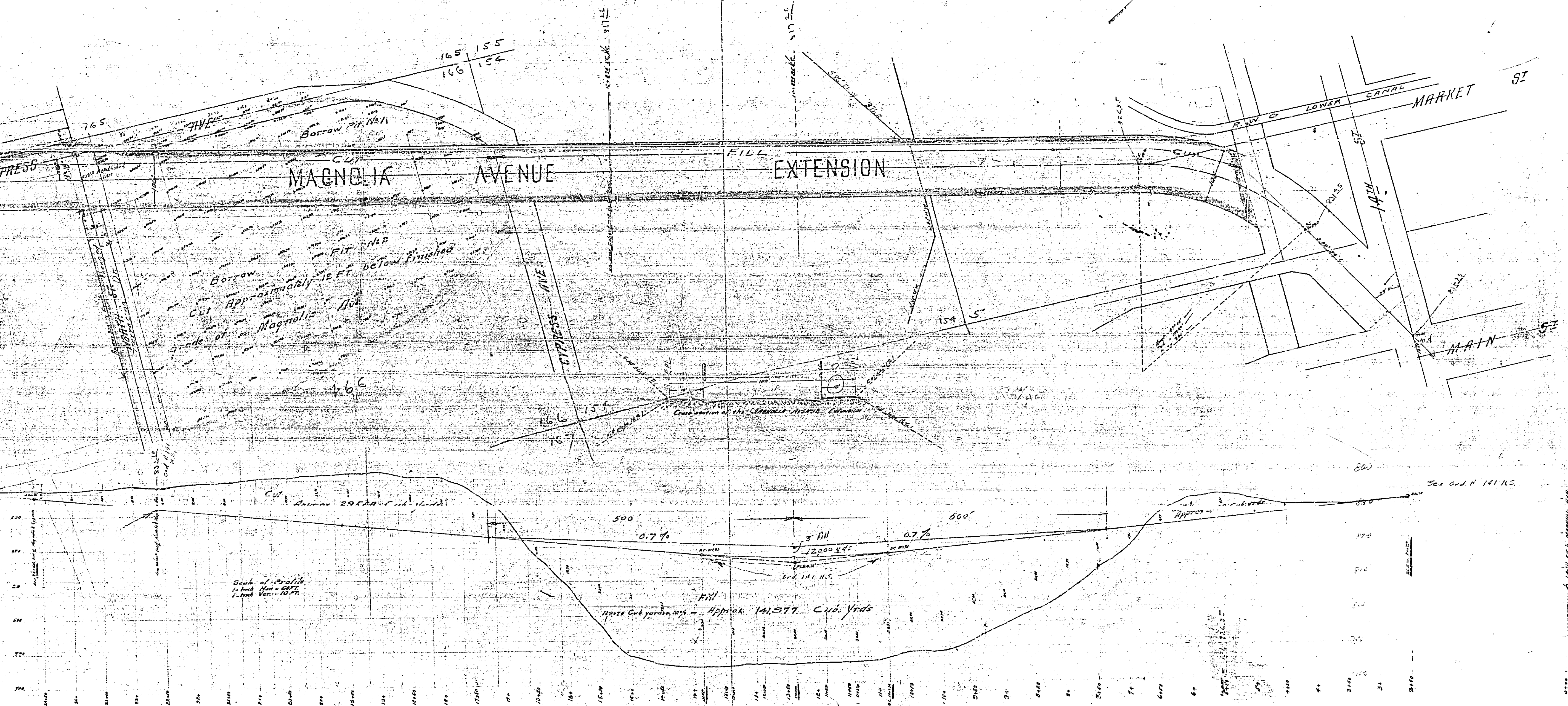

Borrow Pit No. 1
Borrow Pit No. 2
CUT Approximately 125 FT. below finished grade of Magnolia Ave.

Fill
Approx. 141,577 Cu. Yds.

458B

Approved by the Mayor and Common Council of the City of Riverside this 15th day of December 1911
Attest: [Signature]

1881

1881