

DIAGRAM

EXHIBITING ADAMS STREET IMPROVEMENT DISTRICT

IN THE CITY OF RIVERSIDE ON WHICH WORK HAS BEEN DONE UNDER MY OFFICIAL CONTRACT AS SUPERINTENDENT OF STREETS OF SAID CITY WITH CO. BRAND DATED FEB. 9 1953

FOR THE CONSTRUCTION OF COMBINATION CURB AND GUTTER AND CONCRETE SPILLWAY APRON AS IS MORE PARTICULARLY DESCRIBED IN SAID CONTRACT TO WHICH REFERENCE IS HEREBY MADE FOR FURTHER PARTICULARS; SAID DIAGRAM ALSO SHOWS THE RELATIVE LOCATION OF EACH LOT, PIECE OR PARCEL OF LAND ASSESSED FOR THE WORK DONE NUMBERED IN CIRCLES TO CORRESPOND TO THE RED INK NUMBERS IN THE ASSESSMENT HEREIN FIGURES NEXT TO PROPERTY LINES SHOW LENGTH OF SAID LINES IN FEET. THE MARK (X) MEANS FEET. PROPERTY LINES THAT DIFFER FROM THE RECORDED SUBDIVISIONS ARE SHOWN BY BROKEN LINES. THE DISTRICT BENEFITED IS BOUNDARY BY A HEAVY DASHED LINE. PROPERTY COVERED BY THIS ASSESSMENT IS SHOWN ON THE FOLLOWING RECORDED MAPS:

R. L. & I. CO. LANDS M.B. 1, PG. 70, REC. S.B. CO.

I HEREBY CERTIFY THAT THIS ASSESSMENT DIAGRAM WAS APPROVED BY THE CITY COUNCIL OF THE CITY OF RIVERSIDE AT A MEETING THEREOF HELD ON THE 19

CITY CLERK OF THE CITY OF RIVERSIDE.

HEREIN THE LEGEND OF THE DIFFERENT KINDS OF WORK PERFORMED IS SHOWN AS FOLLOWS:

COMBINATION CURB & GUTTER



SUPERINTENDENT OF STREETS OF THE CITY OF RIVERSIDE THE FOLLOWING IS A STATEMENT OF AMOUNTS OF DIFFERENT KINDS OF WORK DONE BY CO. BRAND UNDER

CONTRACT DATED FEB. 9 1953 PURSUANT TO RESOLUTION OF INTENTION NO 5432 ADOPTED BY THE CITY COUNCIL OF THE CITY OF RIVERSIDE ON THE 2ND DAY OF SEPTEMBER 1952

COMBINATION CURB & GUTTER
CONCRETE SPILLWAY APRON

643.50 LIN. FT.

AT SAID CITY OF RIVERSIDE THIS DAY OF

I HEREBY CERTIFY THAT THE ABOVE WORK WAS DONE IN ACCORDANCE WITH LINES AND GRADES FURNISHED BY ME AND THAT THE DIAGRAM OF THE ASSESSMENT DISTRICT FOR THE SAME IS CORRECT.

SUPERINTENDENT OF STREETS
OF THE CITY OF RIVERSIDE.

CITY ENGINEER
OF THE CITY OF RIVERSIDE.

RECORDED AT O'CLOCK M. 19
THIS DAY OF

SUPERINTENDENT OF STREETS
OF THE CITY OF RIVERSIDE.

462

Sheet 3
542/21

Arlington Ave.

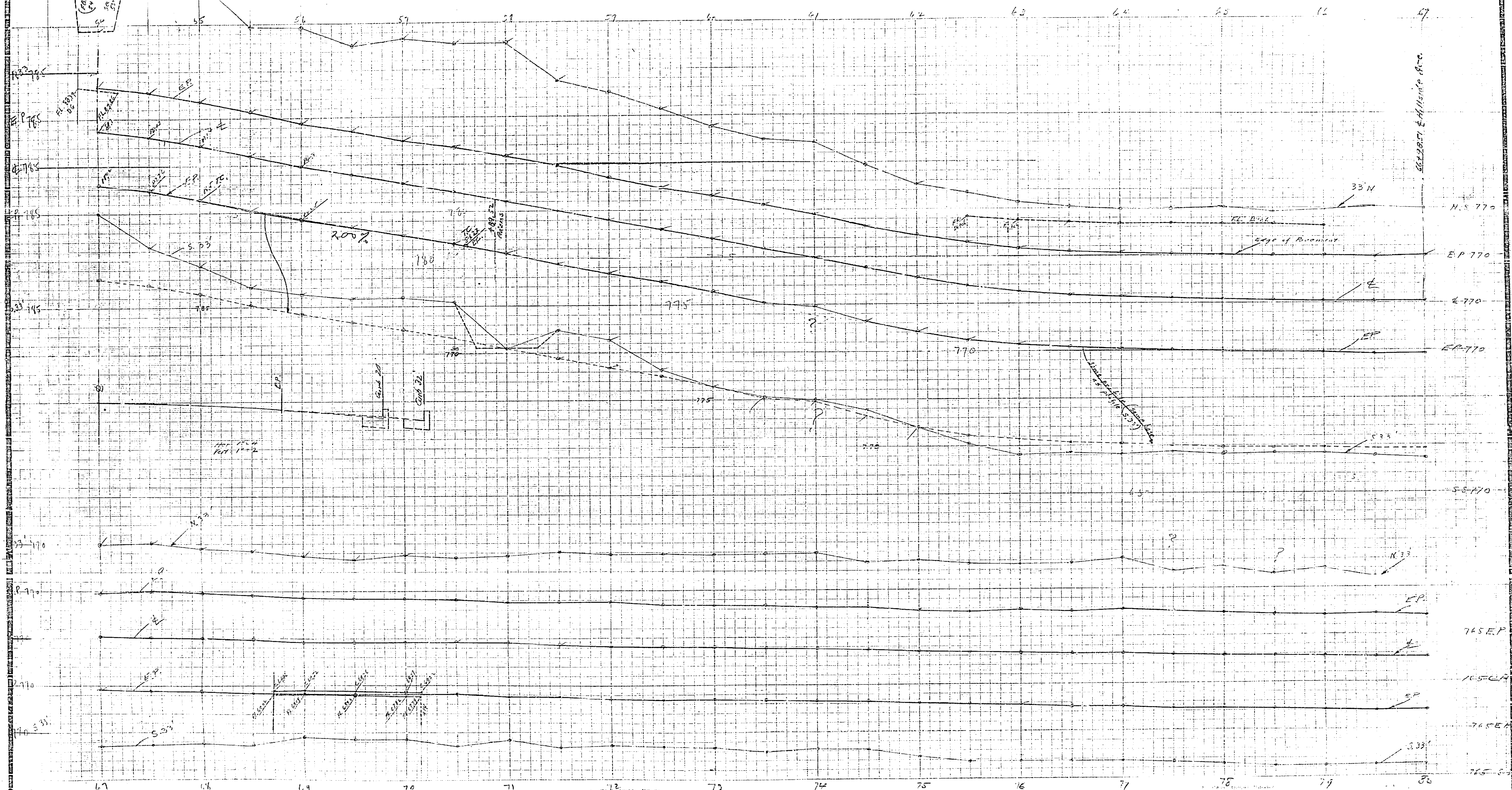

542/23

542/24

462

U.S. GEOLOGICAL SURVEY
WATER RESOURCES DIVISION
WASHINGTON, D.C. 20540